

型号：A301    开门方式：一固一移

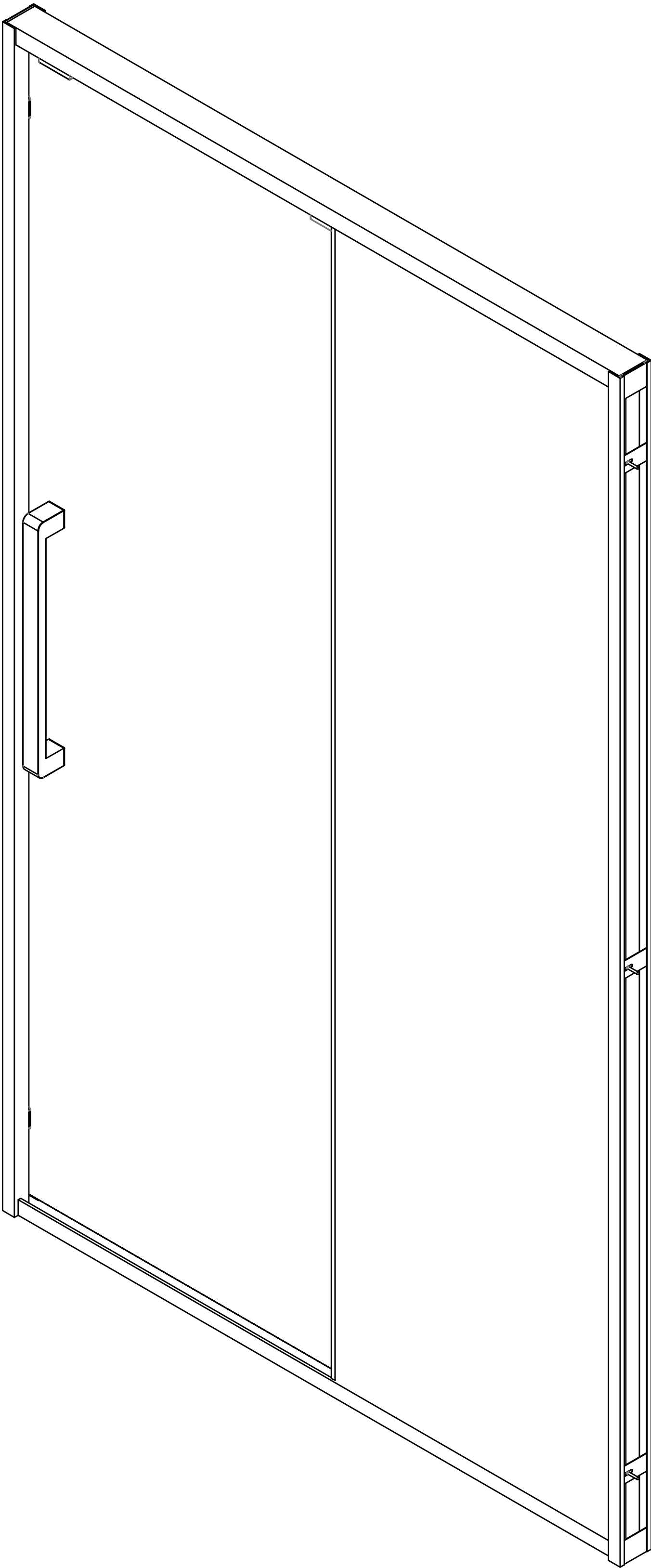

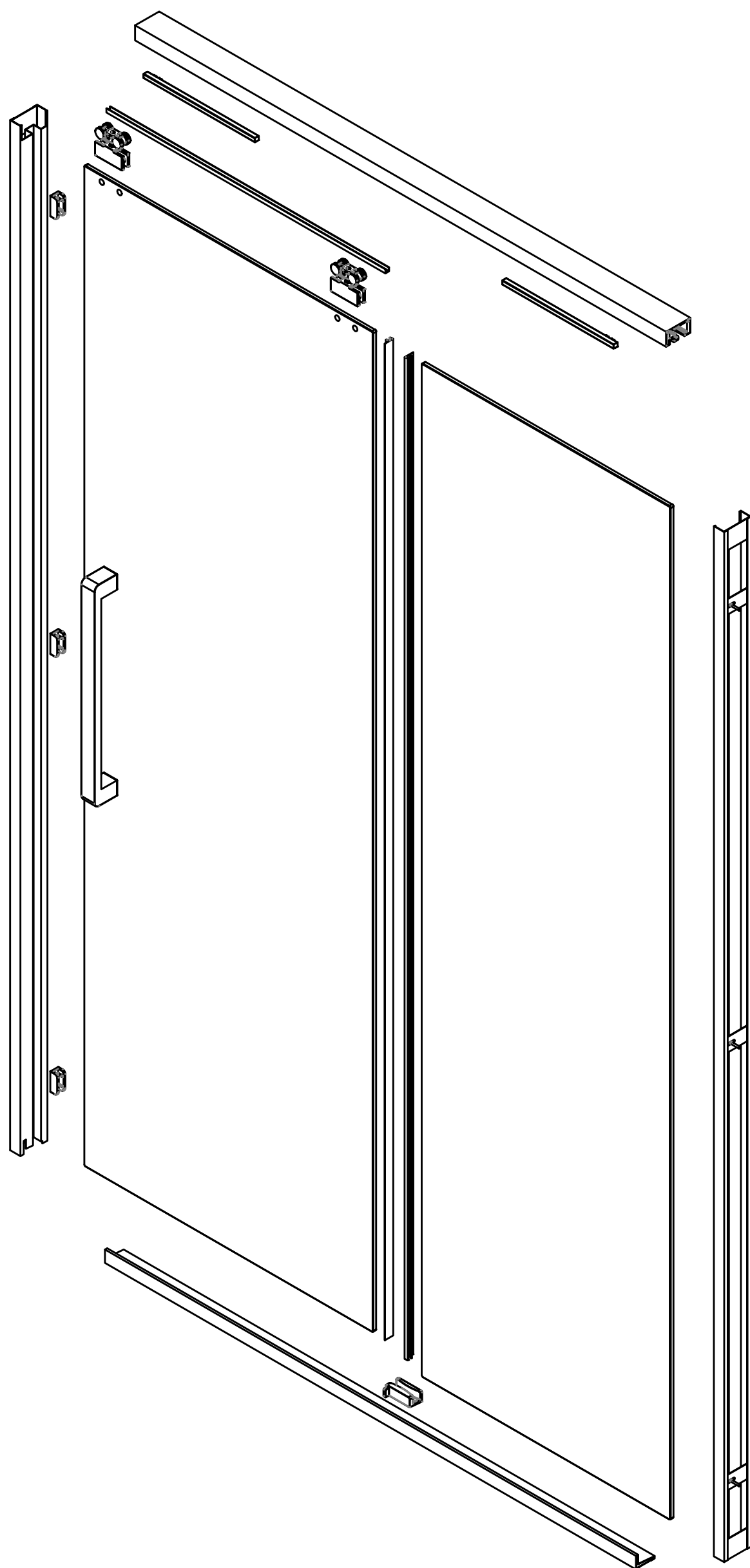

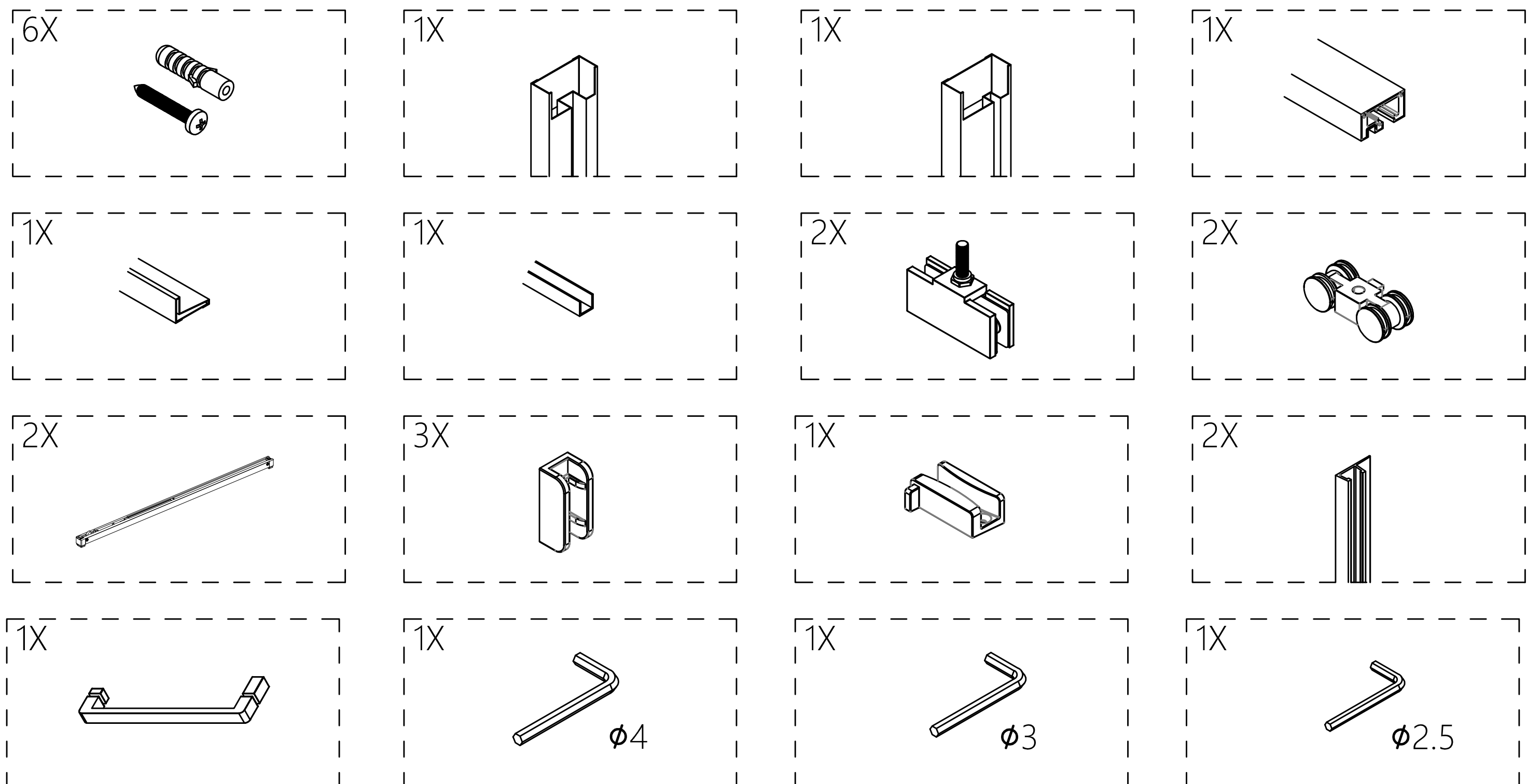
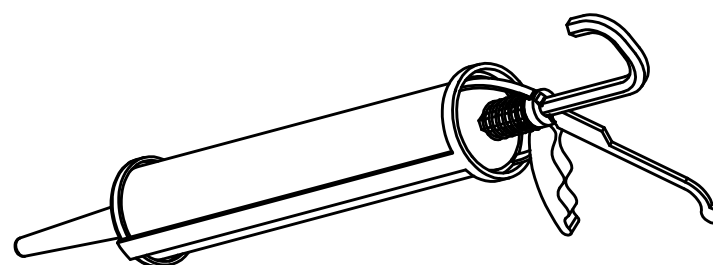
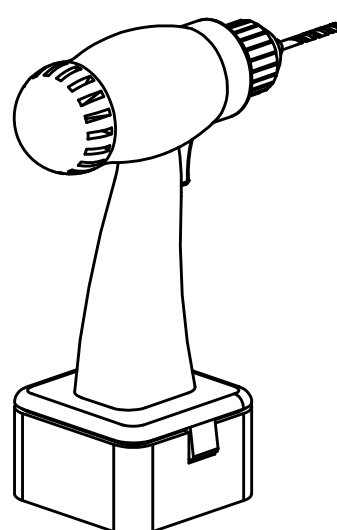
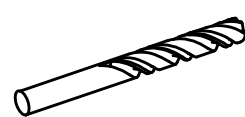
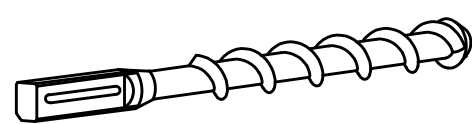
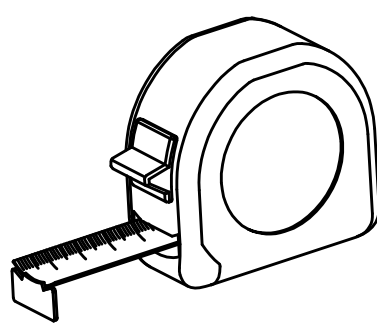
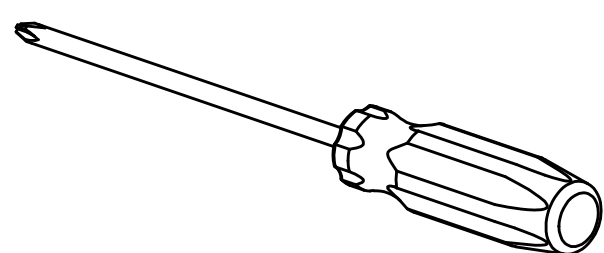
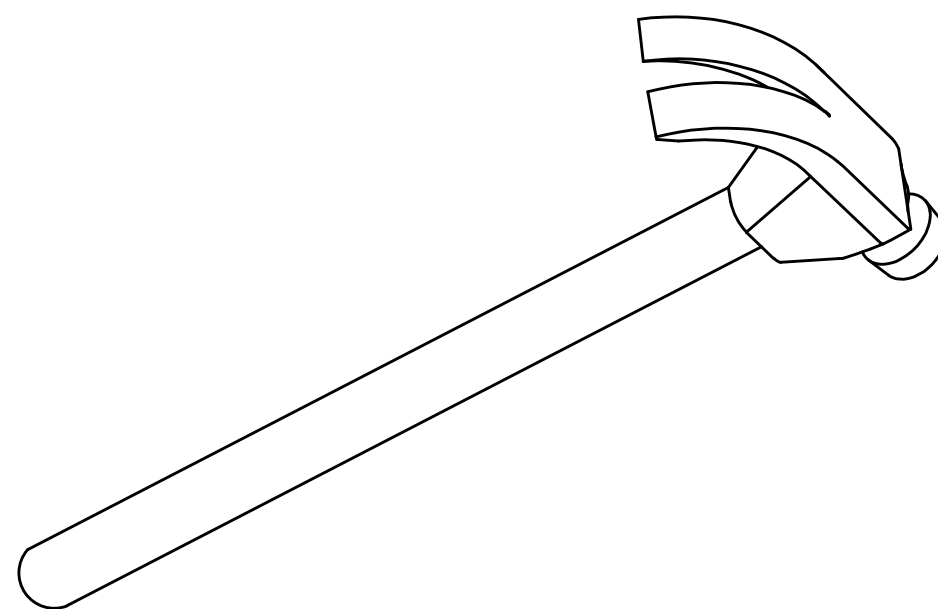
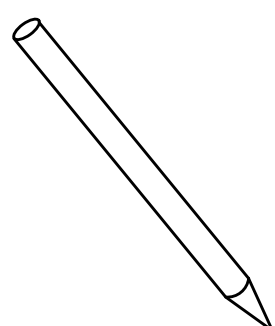
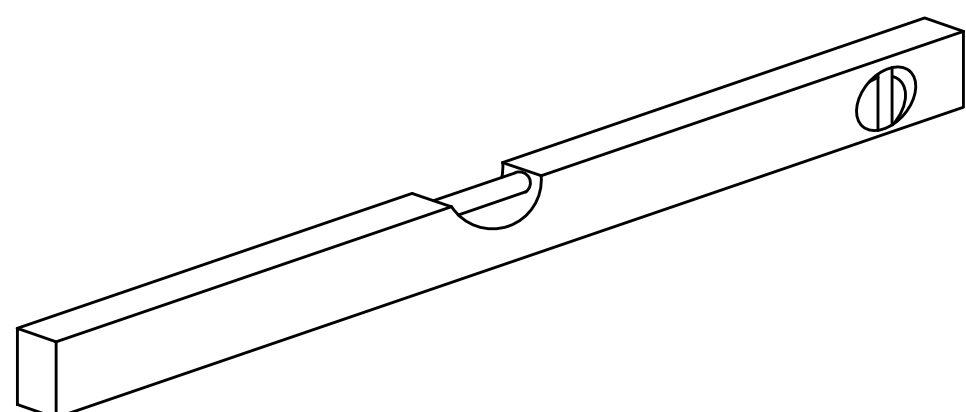

- 1.下轨道居中,石基确保放置水平
- 2.放置连墙立柱,画线打孔
- 3.立柱与墙面用螺丝固定

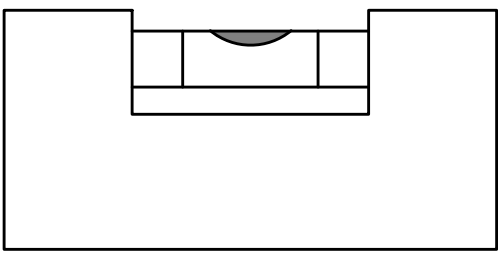
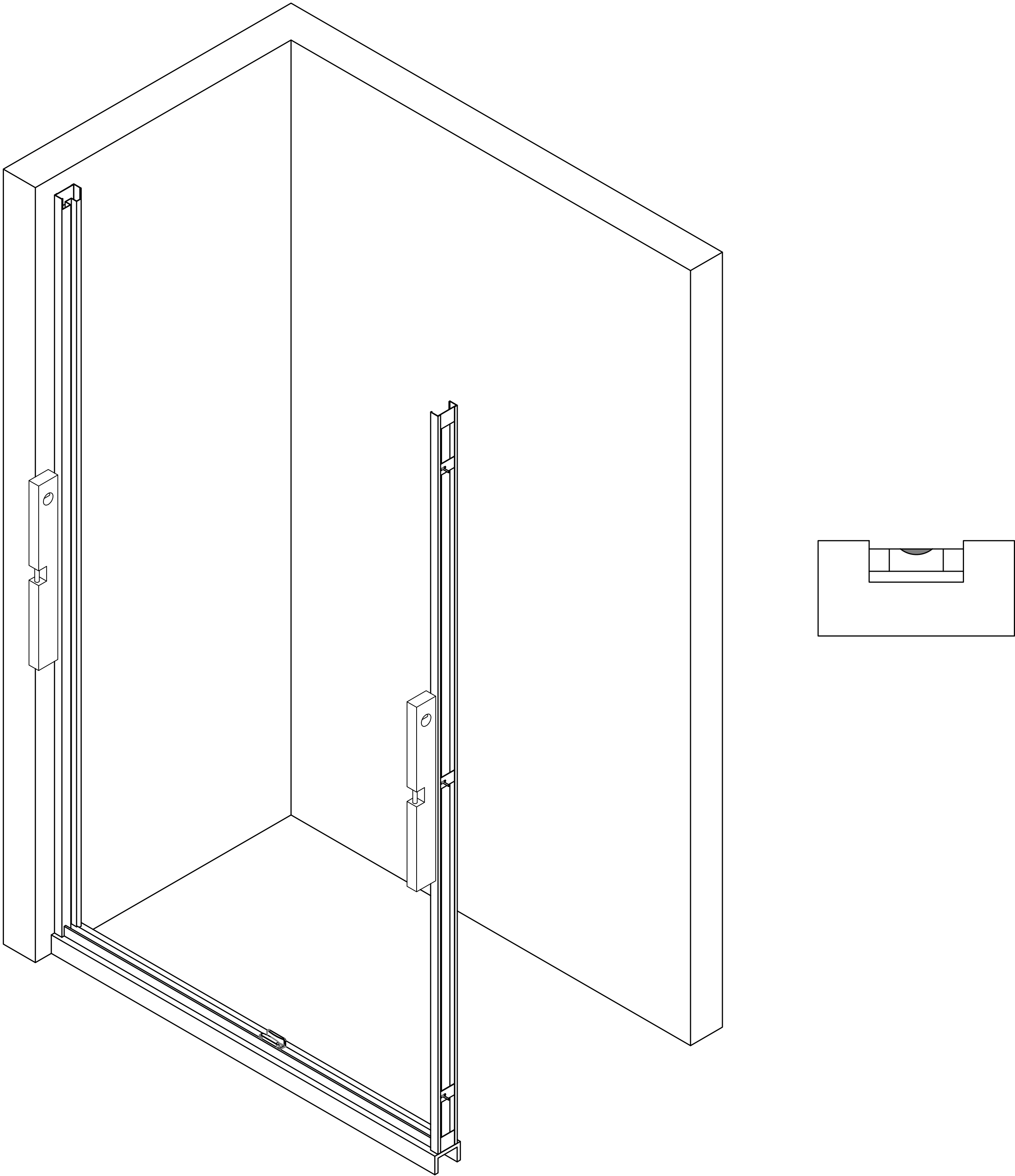
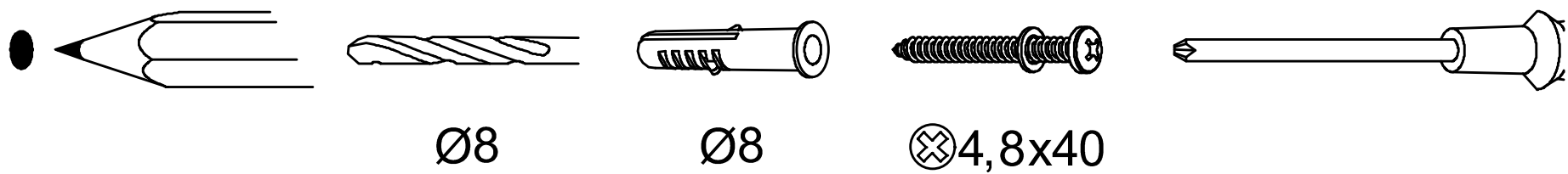

1.放置固玻

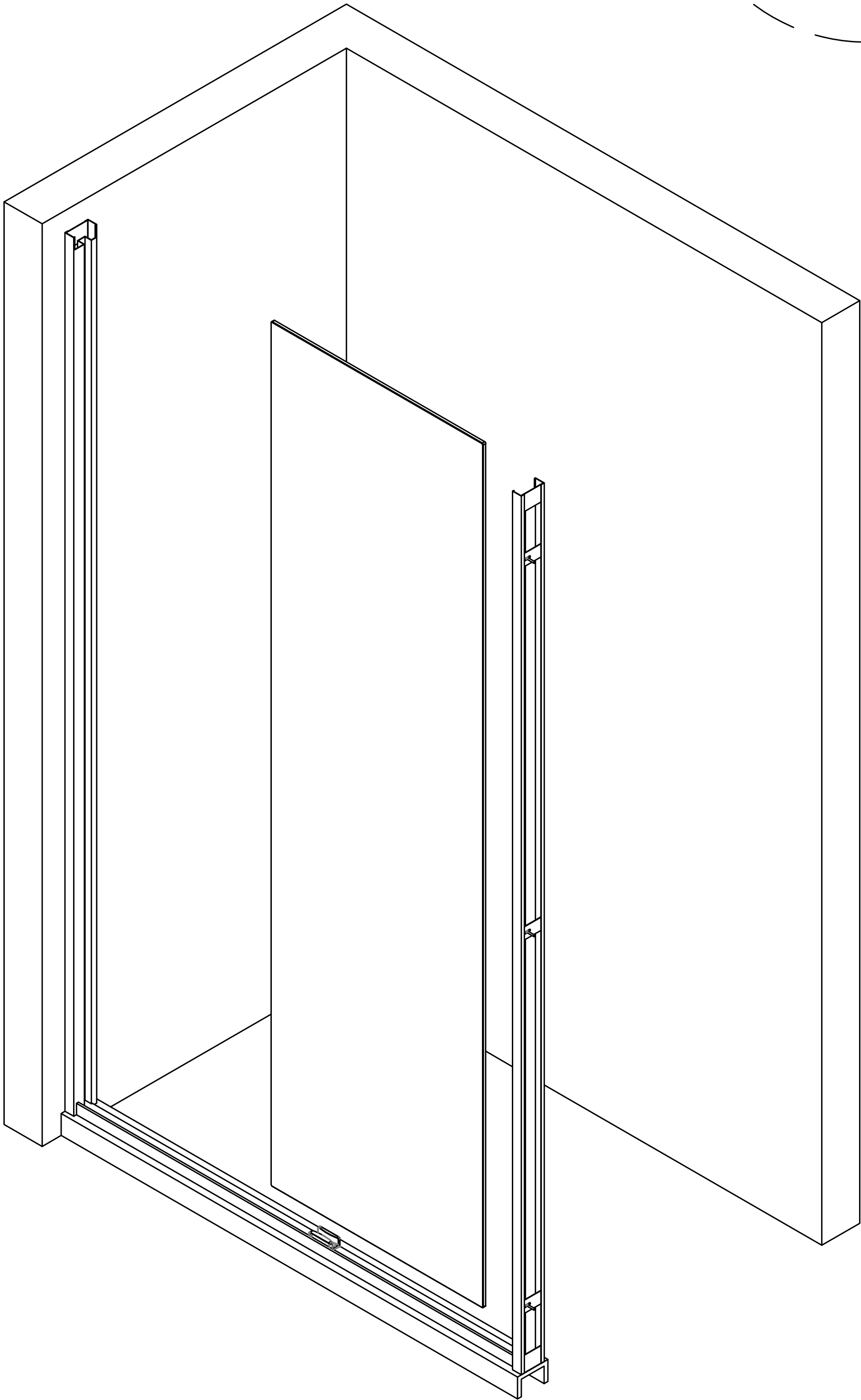
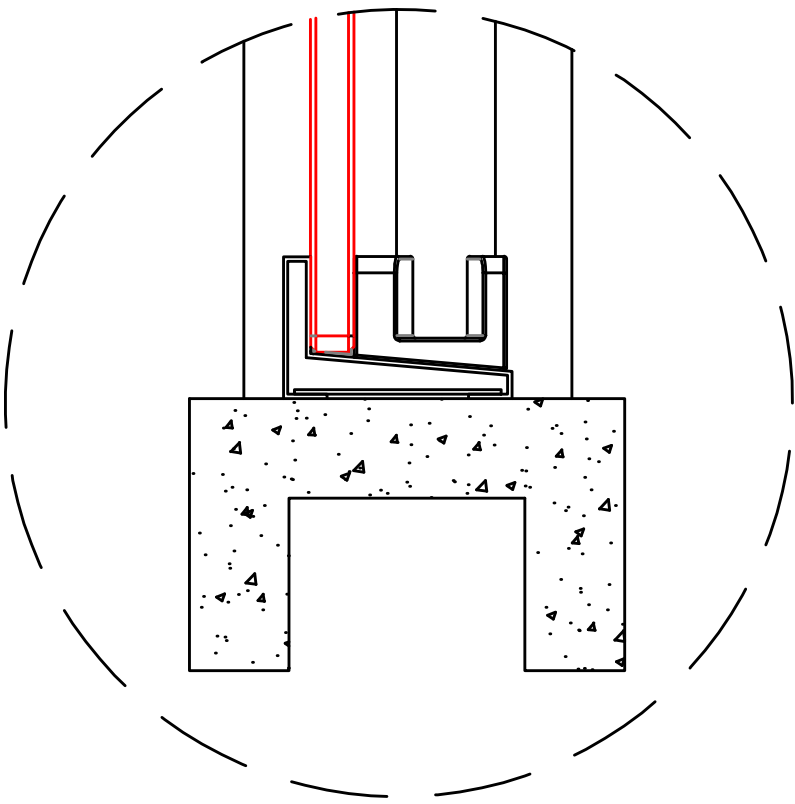

- 1.缓冲器需手动开启
- 2.预装缓冲器与滑轮

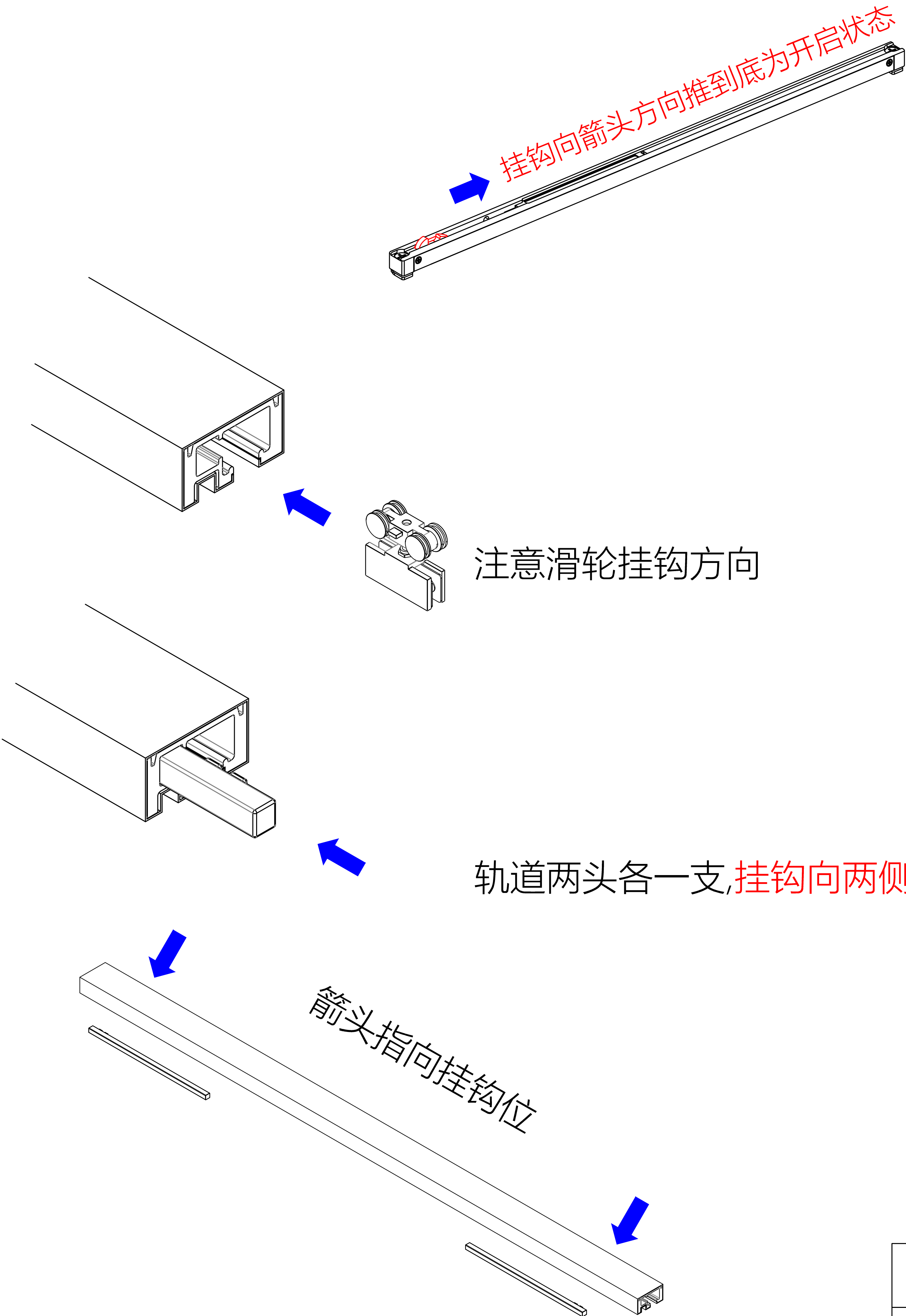

1.安装门玻

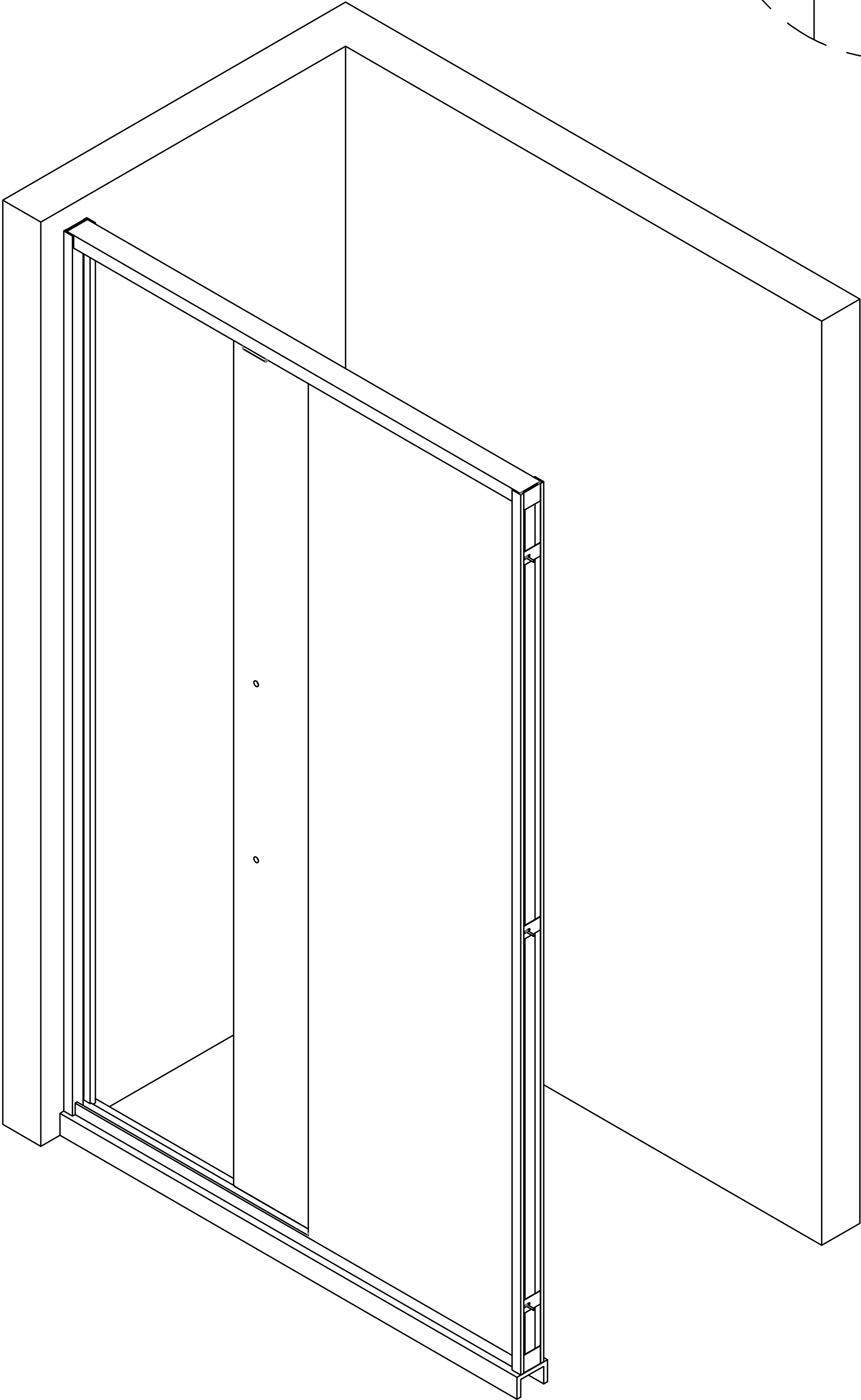
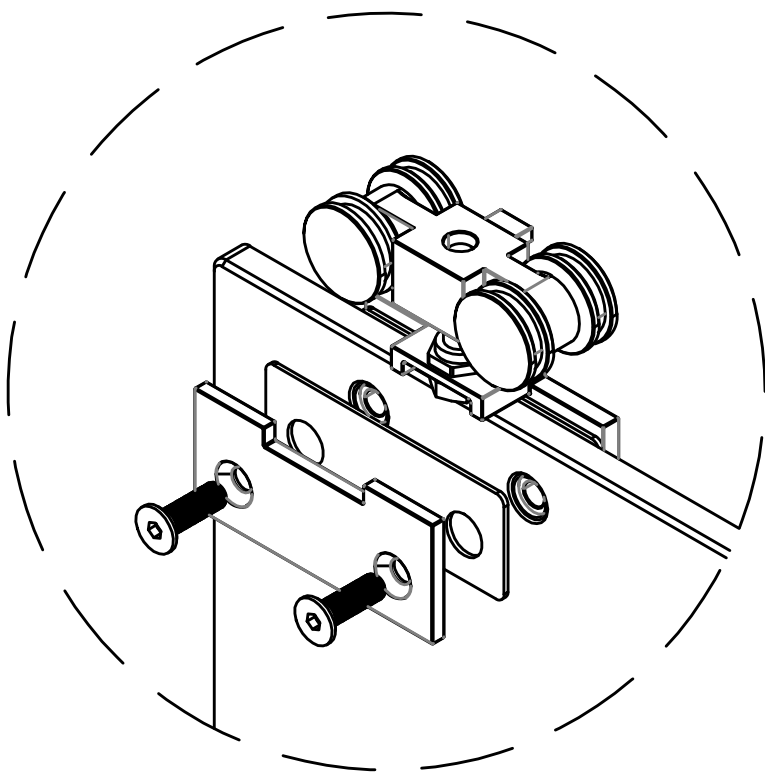

- 1.安装上轨装饰U槽
- 2.安装防撞块
- 3.安装挡水胶条
- 4.安装拉手

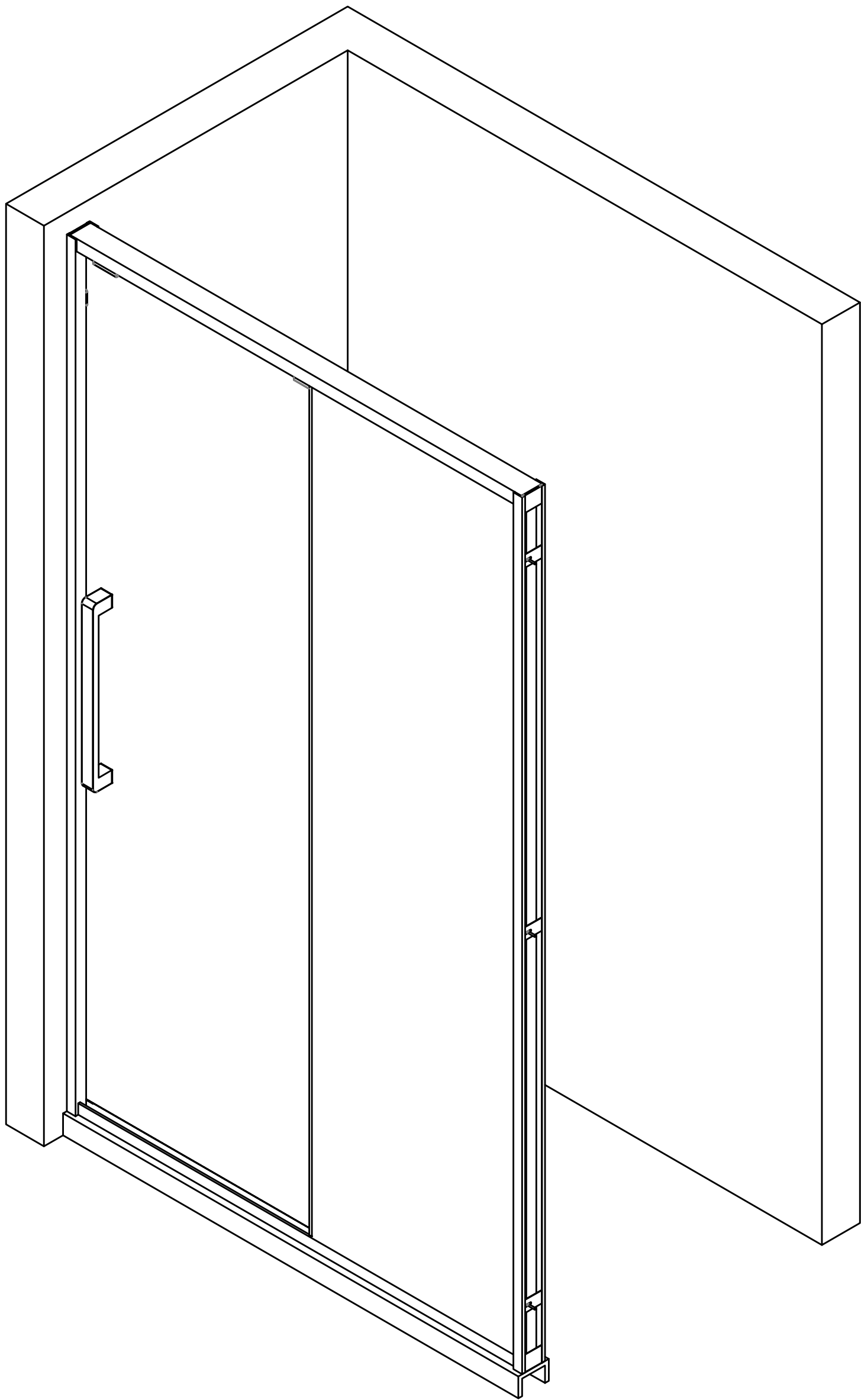
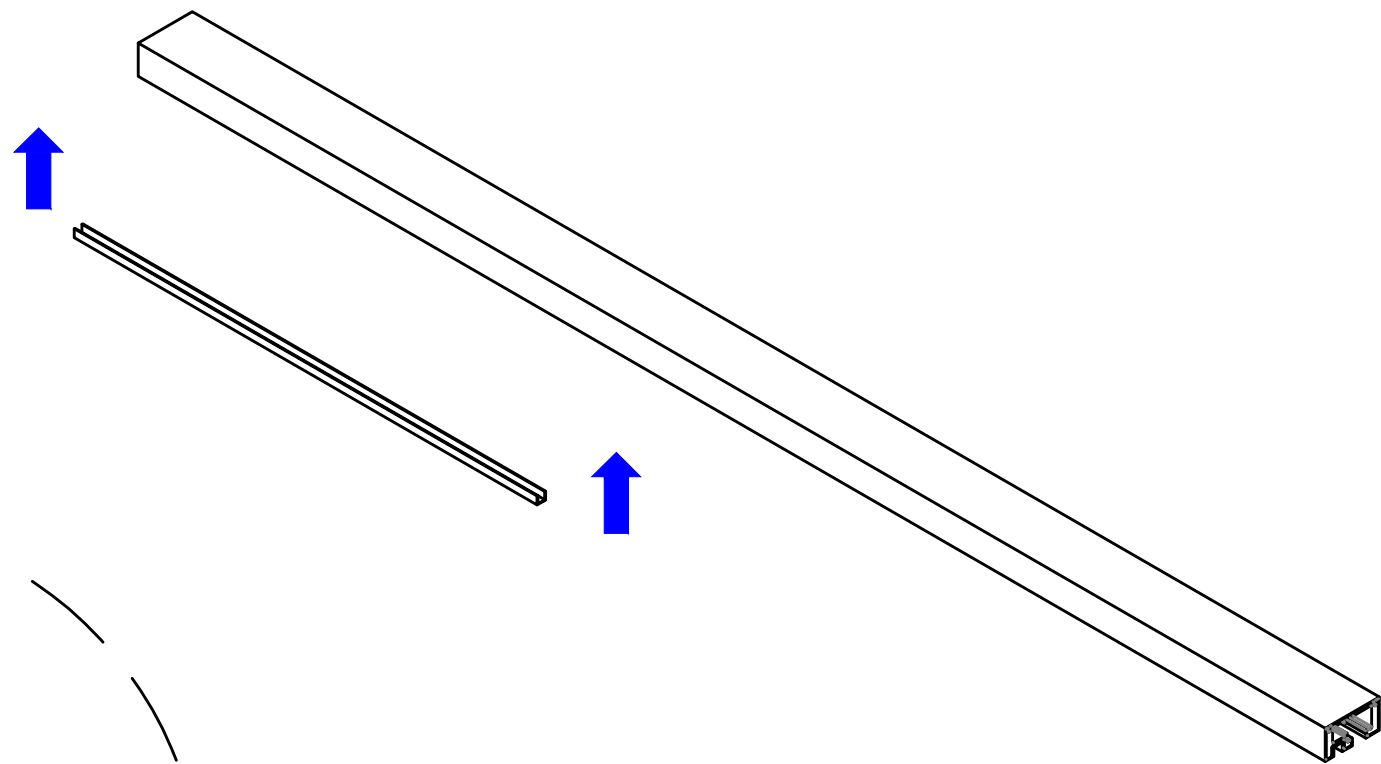
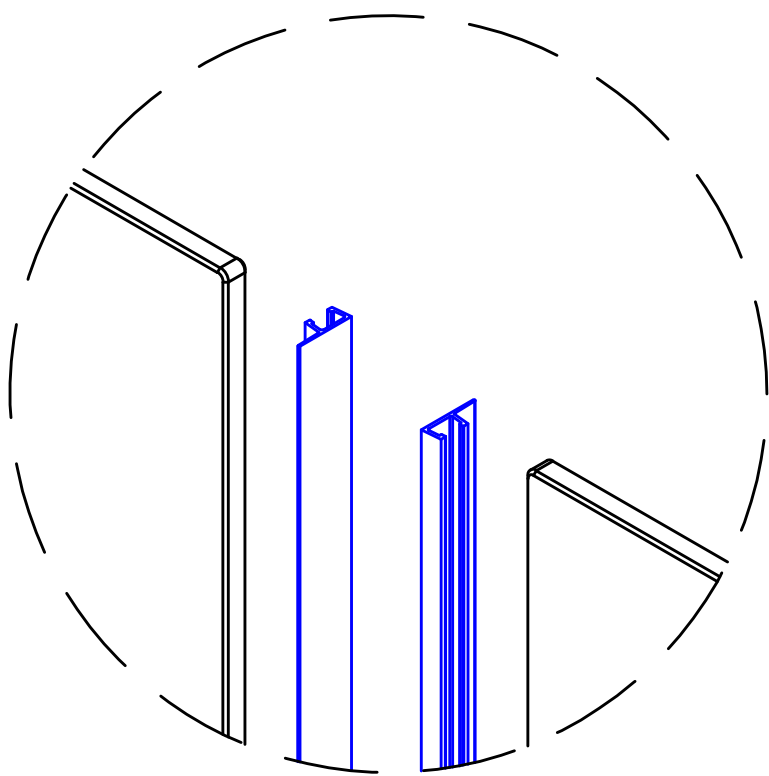
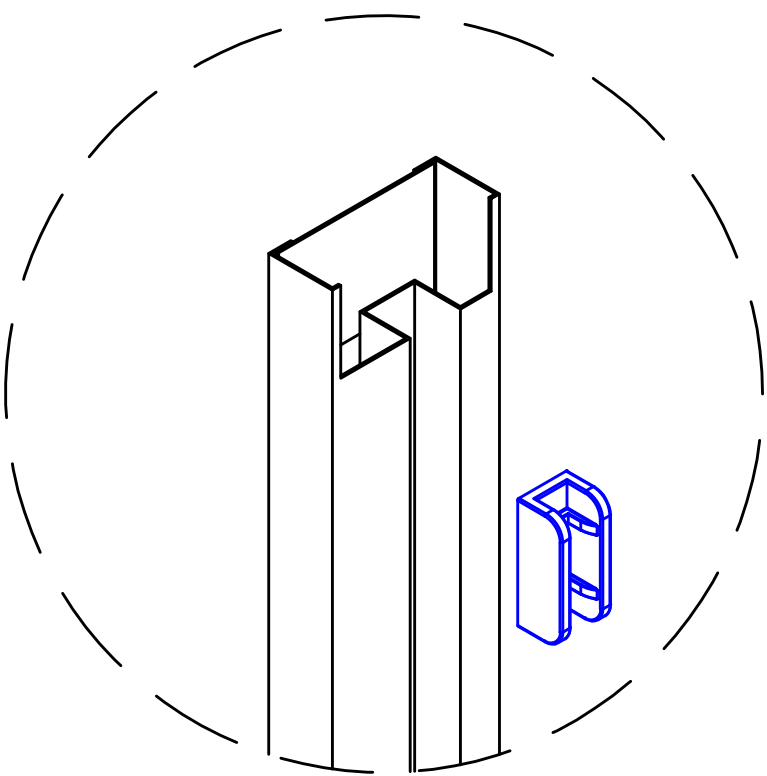



1.调节缓冲器,以便门玻推拉顺畅

此为缓冲器安装理论数据，以实际安装为准



1.打防水胶

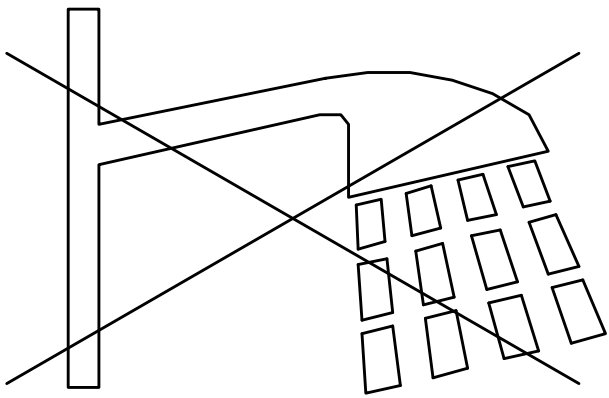

24 H

