

## MP-02

Modular Shelving System designed to seamlessly integrate with any space. Flush mounted brass plates mate beveled hard wood shelves to steel monoposts for a minimal, floating aesthetic.

Single and double sided posts with incremental mount locations facilitate perpetual customization and limitless modularity.

On-Center post width increment // 6 (152.5)  
 Vertical location increments // 7 (178)  
 Levelling feet fasten to framing / blocking in wall  
 Feet fastened / adhered to floor below

Submit request for exact pricing

designed by // matt diaz

## SHELVES + INSERTS

SOLID HARD WOOD  
 WALNUT | MAPLE



### WOOD SHELF

W | 12 (305) - 42 (1067)  
 D | 12 (305) + 15 (381)  
 T | 1 (25.5)



### CORNER SHELF

W | 24 (610)  
 D | 12 (305) + 15 (381)  
 T | 1 (25.5)



### GLASS SHELF

W | 12 (305) - 42 (1067)  
 D | 12 (305) + 15 (381)  
 T | 1/2 (12.7)



### BOTTLE SHELF

W | 12 (305) - 42 (1067)  
 D | 12 (305) + 15 (381)  
 T | 1 (25.5)



### STEMWARE SHELF

W | 12 (305) - 42 (1067)  
 D | 12 (305) + 15 (381)  
 T | 1 (25.5)



### BOTTLE BRACKET

W | 22-1/4 (565)  
 D | 3 (76)



### SHOE SHELF

W | 12 (305) - 42 (1067)  
 D | 12 (305) + 15 (381)  
 T | 1 (25.5)

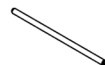

### HANG ROD

D | 1-1/4 (32)  
 L | 12 (305) - 48 (1219)

## CASE GOODS

VENEERED  
 WALNUT | MAPLE

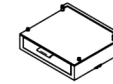

### GLASS TOP CADDY

W | 12 (305) - 48 (1219)  
 D | 12 (305) + 15 (381)  
 T | 1 (25.5)

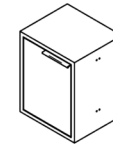

### DOOR CASE SINGLE

H | 22 (559) - 43 (1092)  
 W | 12 (305) - 48 (1219)  
 D | 12 (305) + 15 (381)  
 T | 1 (25.5)

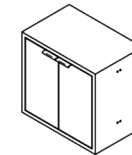

### DOOR CASE DOUBLE

H | 22 (559) - 43 (1092)  
 W | 24 (610) - 48 (1219)  
 D | 12 (305) + 15 (381)  
 T | 1 (25.5)

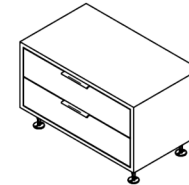

### DRAWER BASE DOUBLE

H | 23 (584)  
 W | 24 (610) - 48 (1219)  
 D | 18 (457) + 21 (553)  
 T | 1 (25.5)

## SPECIALTY INSERTS

### MIRROR BACK CABINET

H | 43 (1092)  
 W | 24 (610) - 48 (1219)  
 D | 12 (305) + 15 (381)  
 T | 1 (25.5)

### SWIVEL MIRROR

H | 43 (1092)  
 W | 24 (305)  
 D | 2 (51)

