

Filmterm PET Prepreg

Single-layer PET film coated on the sides, used as interlayer insulation in dry type transformers - thermal class B (130 °C).



Electrical
insulation
product

Characteristics

Filmbase PET Prepreg is a single layer PET film coated on both sides with a B-stage epoxy resin not completely cured. The resin is reactivated at the time of manufacturing at the customer's side by following the appropriate curing process. This leads the product to achieve a solid bonding with the layers it is in contact with.

Suggested curing conditions: 3 hours at 150°C or 5 hours at 130°C

Shelf life: 6 months - temperature between 5°C and 30°C

Formats

The product can be supplied in tapes from 8 mm width upwards, in rolls until 1800 mm, cut in sheets or die-cut according to customer's specifications.

Core internal diameter 76 or 152 mm (3 or 6 inches).

Available colors: dark red or natural.

Structure

■ Coated PET film

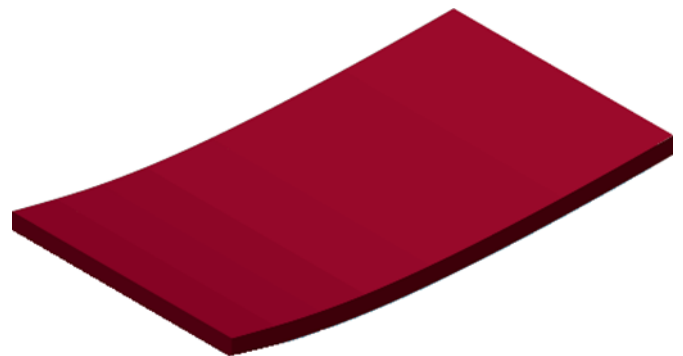

Technical Data

Properties	Unit	Tolerance	Values				
Film Thickness	µm	±10%	50	75	100	125	190
Total Thickness	µm	±10%	70	95	120	145	210
Yield	m ² /Kg	±10%	11,11	8,00	6,25	5,13	3,49
Weight	g/m ²	±10%	90	125	160	195	286
Breakdown Voltage	kV	min	9	11	13	16	16

Last revision: 09.2019

