

BELGRAVIA

# STRATEGIC SUSTAINABILITY PLAN

Create quality living

**Disclaimer**

The information provided by Belgravia Collection is for general informational purposes only and does not constitute legal, financial or professional advice. All projects, services and plans are subject to regulatory approvals, market conditions and other factors beyond our control. Belgravia Collection makes no warranties or representations regarding the accuracy or completeness of the information provided and any reliance placed on such information is strictly at your own risk. Belgravia Collection reserves the right to modify or discontinue services or offerings without prior notice. Always consult with relevant professionals before making decisions based on this content.

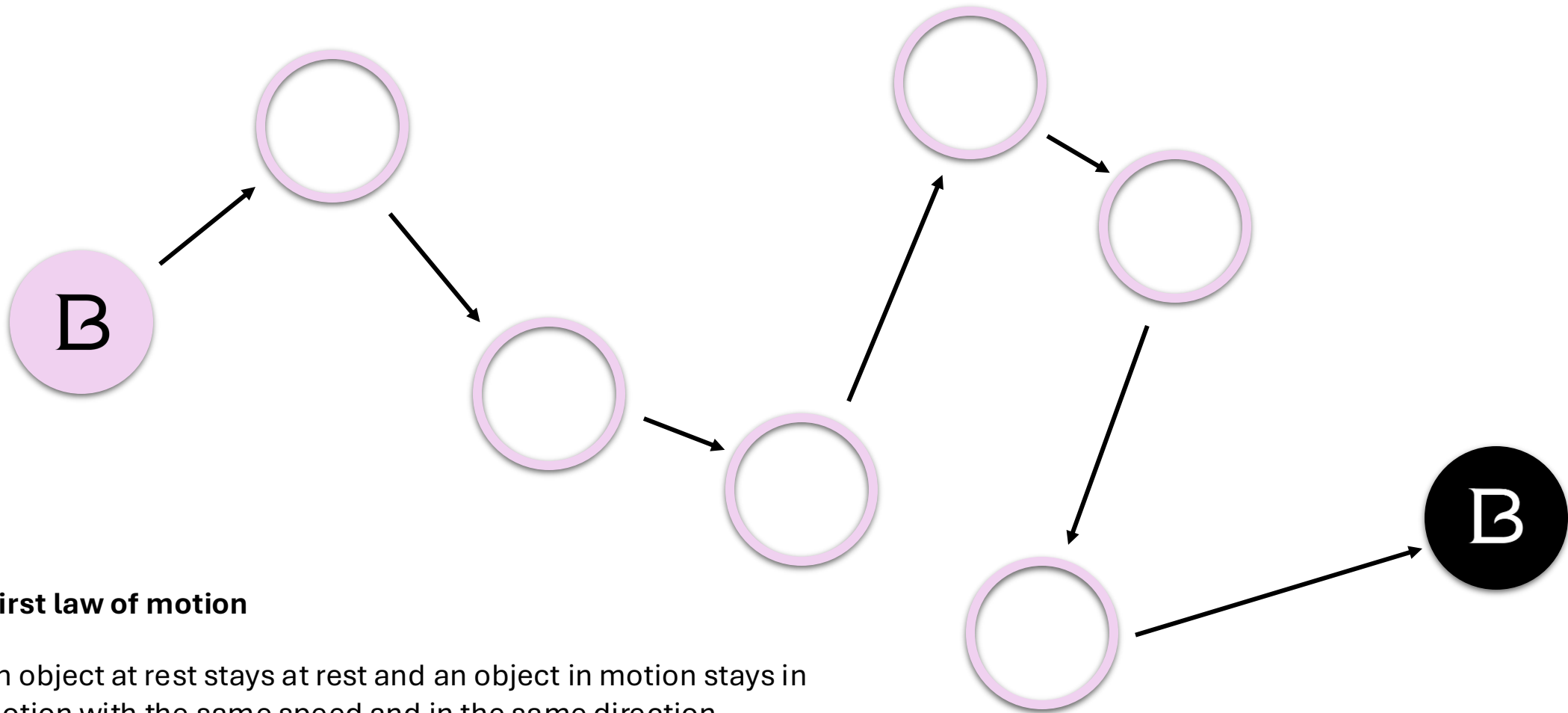
**First law of motion**

An object at rest stays at rest and an object in motion stays in motion with the same speed and in the same direction unless acted upon by an external force.

*Isaac Newton*



BELGRAVIA





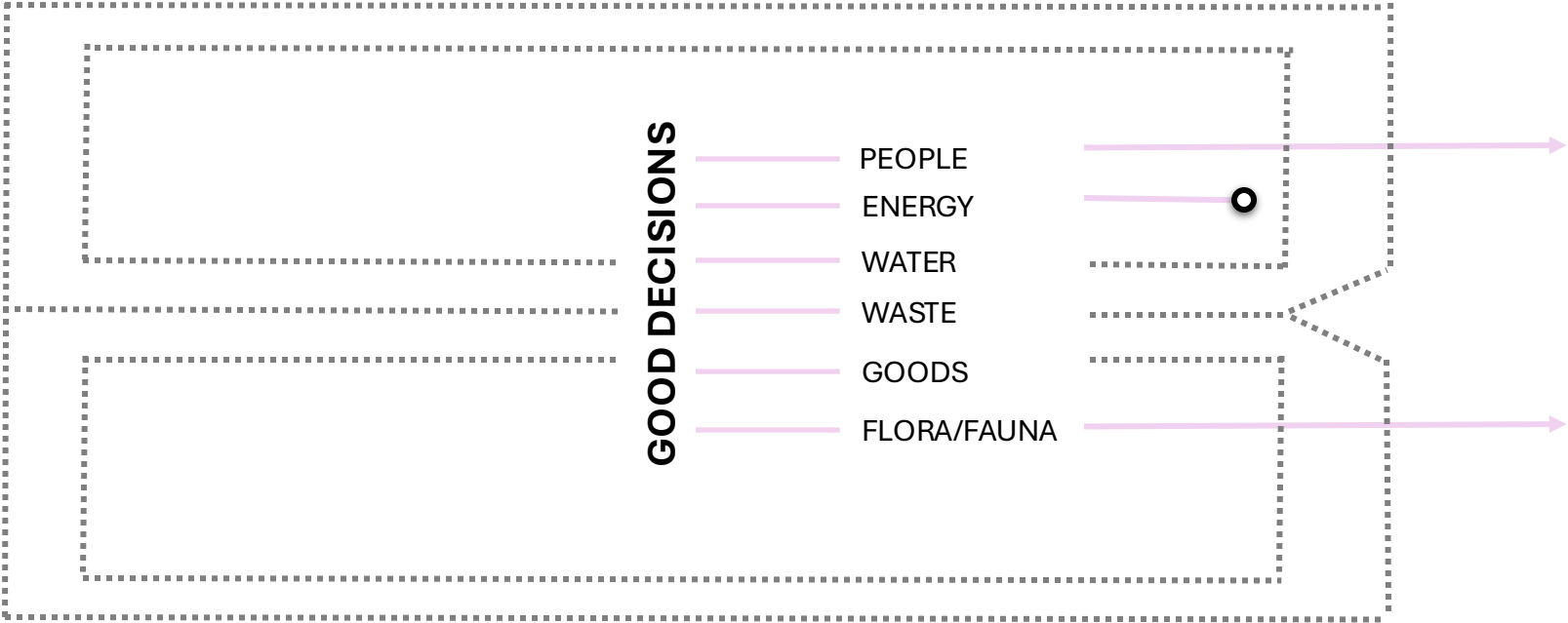
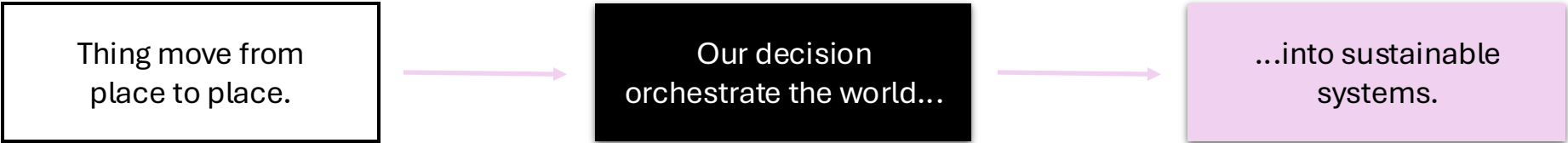

Sustainable environment  
by employing practices  
and solutions

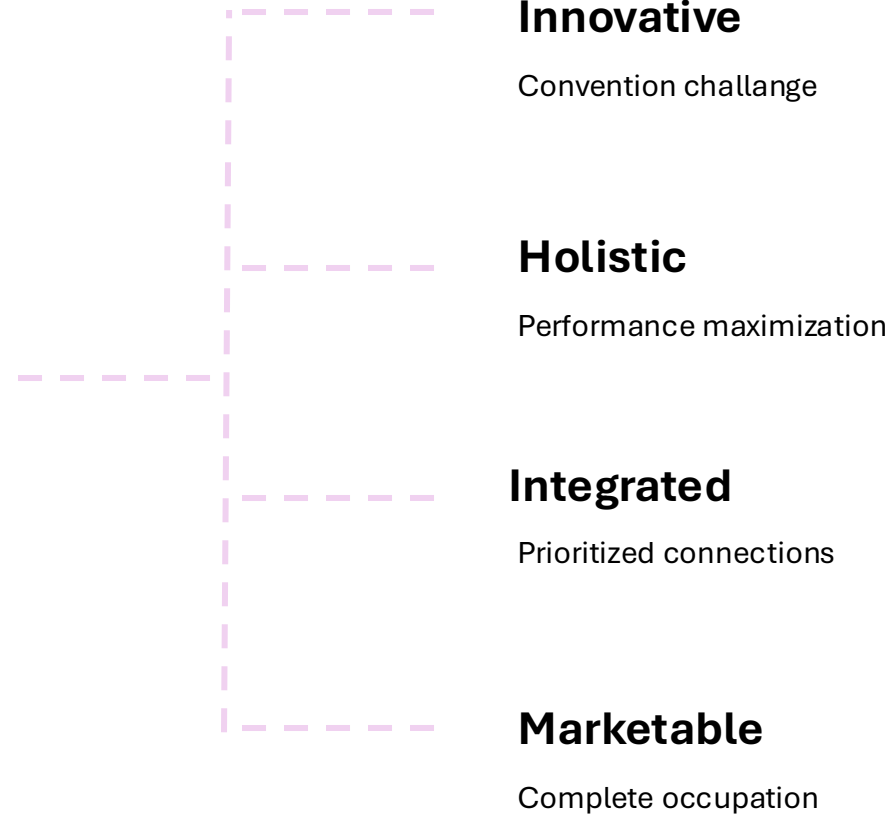

System.....Sources.....Uses.....Strategies..... Targets.....

<div><div>PEOPLE</div></div>				
<div><div>ENERGY</div></div>				
<div><div>WATER</div></div>				
<div><div>WASTE</div></div>				
<div><div>GOODS</div></div>				
<div><div>FLORA/ FAUNA</div></div>				

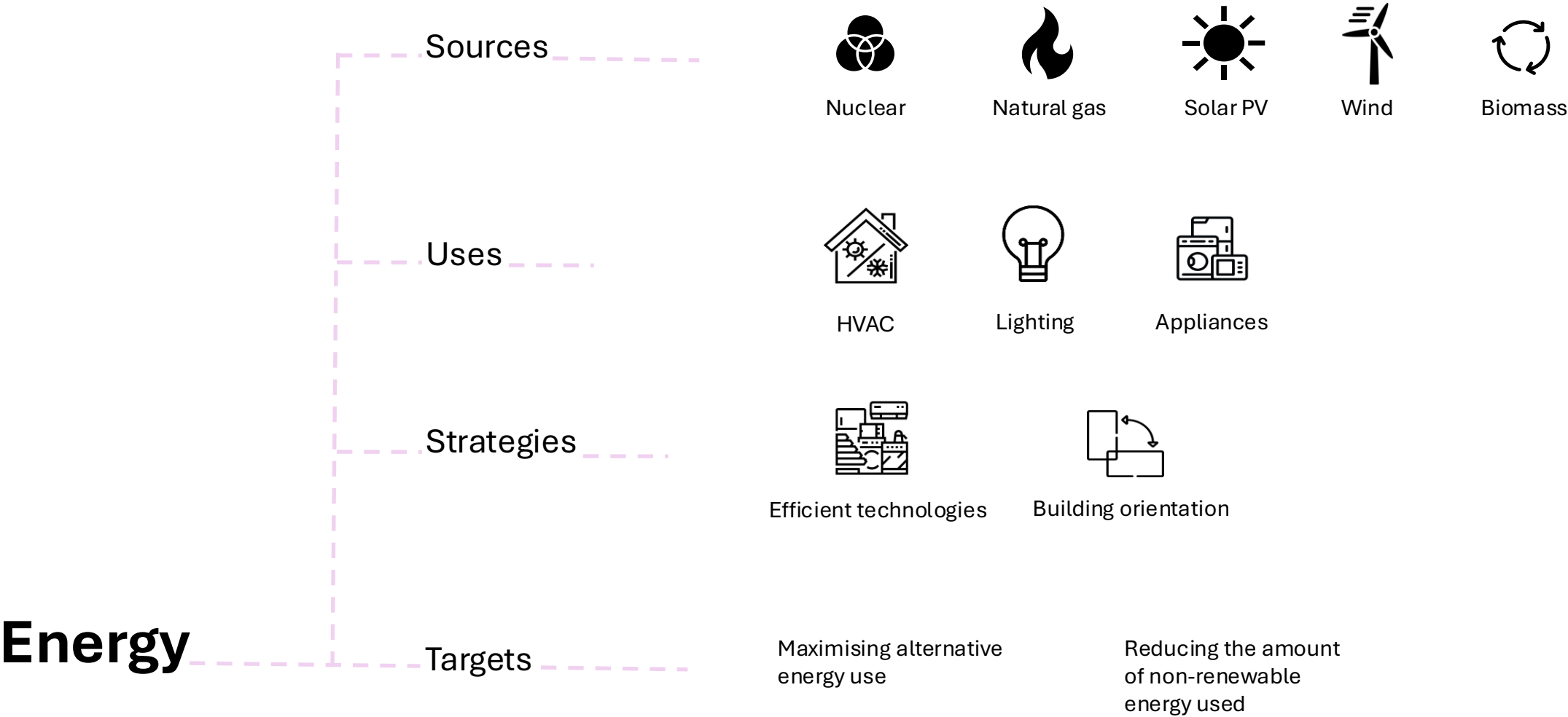

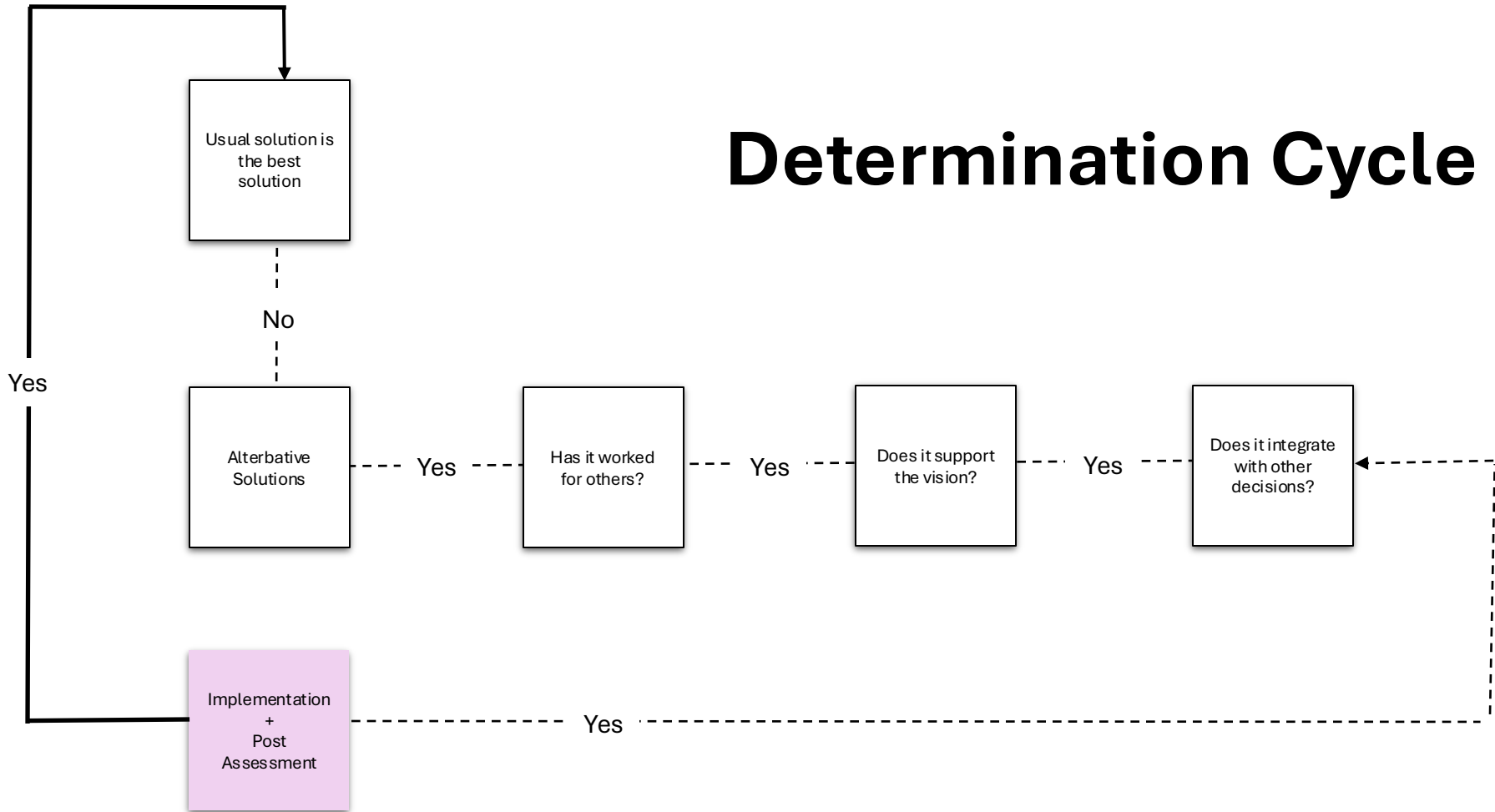



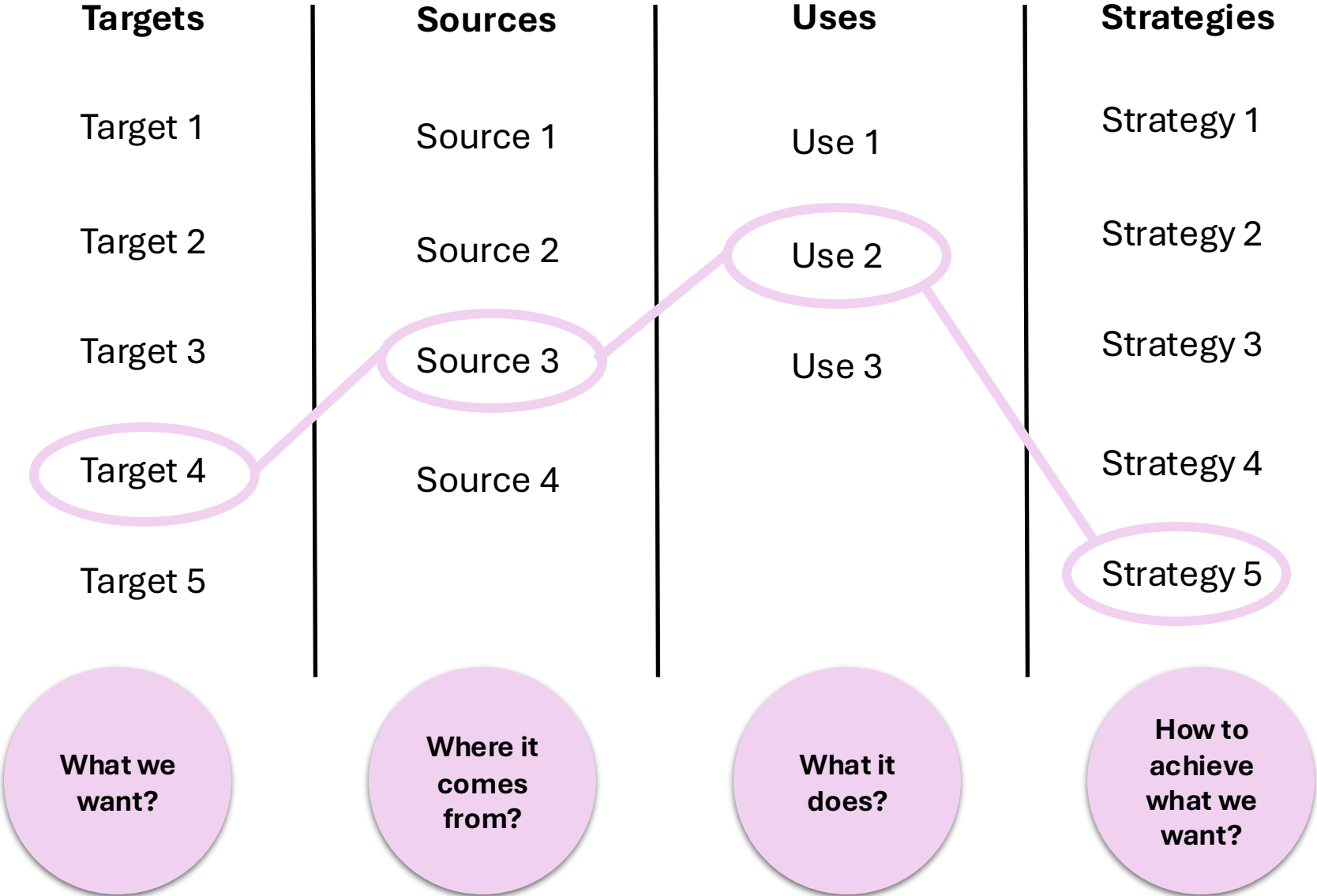

# BELGRAVIA



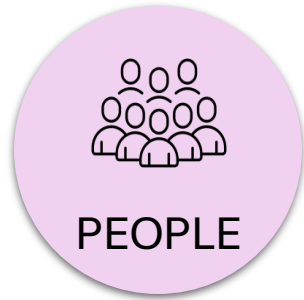

## Targets

Sociable communities  
Vibrant, active communities  
Happy people  
Healthy environment  
Productive cities

## Sources

Streets  
Parks + public open spaces  
Gardens  
Yards  
Porches  
Houses  
Retail + restaurants  
Offices + Job Sites

## Uses

Walking  
Biking  
Blading  
Laughing  
Talking  
Playing  
Meeting  
Sleeping  
Eating  
Loving  
Jogging  
Reading  
Fishing

## Strategies

Parks with purpose  
Complete + active streets  
Very private outdoor spaces  
Open play + relaxation space  
Networks of sidewalks + pathways  
Interaction with nature  
Transition between public + private space  
Efficient homes  
Social space in homes  
Nooks

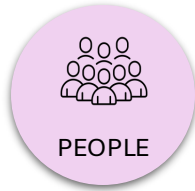

## People features

- 01 social destinations
- 02 very private outdoor spaces
- 03 nooks
- 04 semi-public private spaces
- 05 networks of sidewalks + pathways
- 06 bicycle infrastructure
- 07 complete + active streets
- 08 parks with playgrounds
- 09 open play + space for relaxation
- 10 social activities in community space
- 11 interaction with nature
- 12 efficient homes with spacious feel

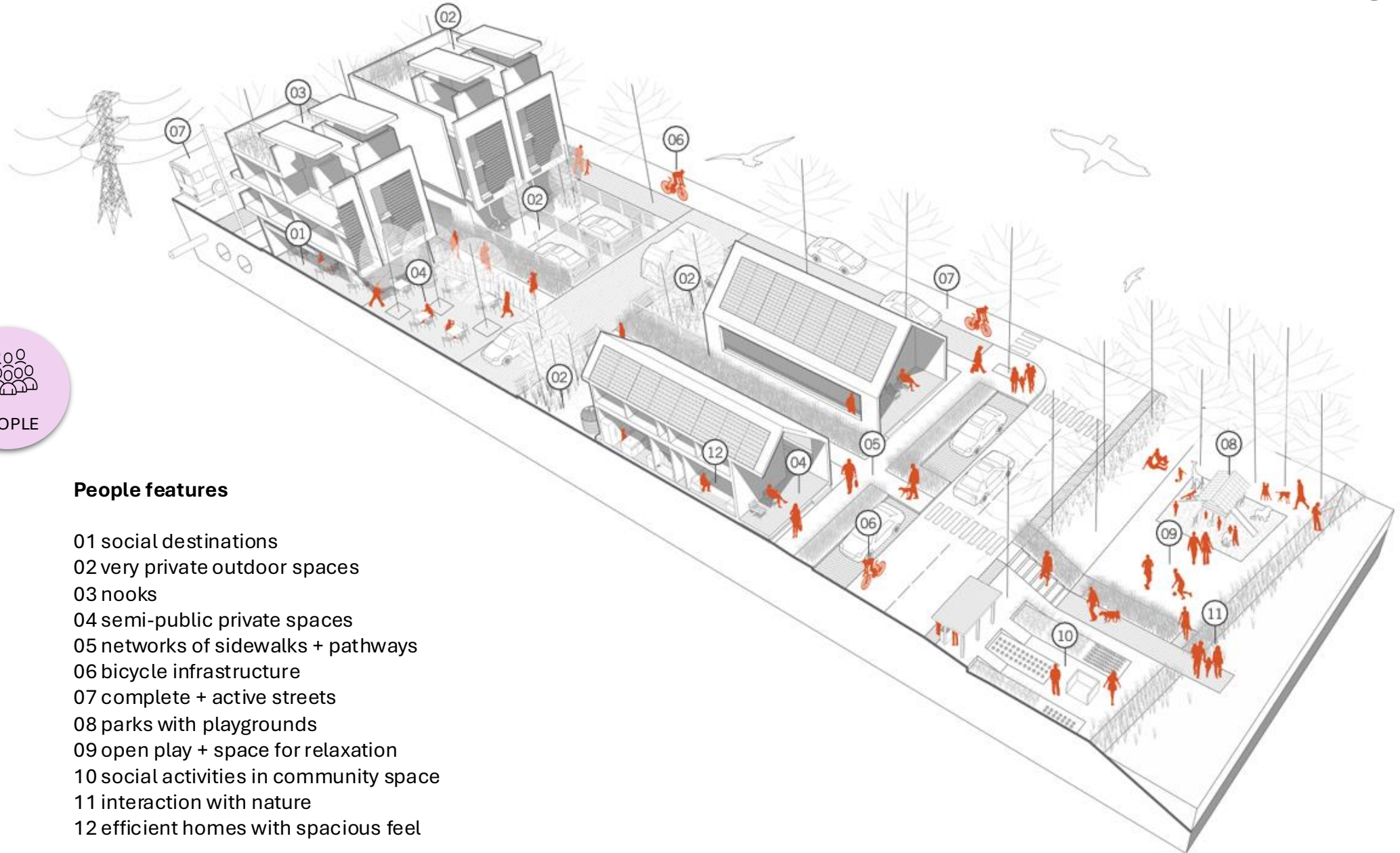





Targets

Maximize use of renewable energy  
Maximize use of clean energy

Sources

Coal (Non-renewable)  
Natural gas (Non-renewable)  
Petroleum (Non-renewable)  
Solar (Renewable)  
Wind (Renewable)  
Geothermal (Renewable)  
Biomass (Renewable)  
Food (Non-renewable + Renewable)

Uses

Building systems  
Site infrastructure  
Transportation  
People

Strategies

Passive heating + cooling  
On-site power generation  
Alternative fuel vehicles  
Mixed-model transportation  
Building solar orientation  
Efficient building systems + appliances  
On-site food production

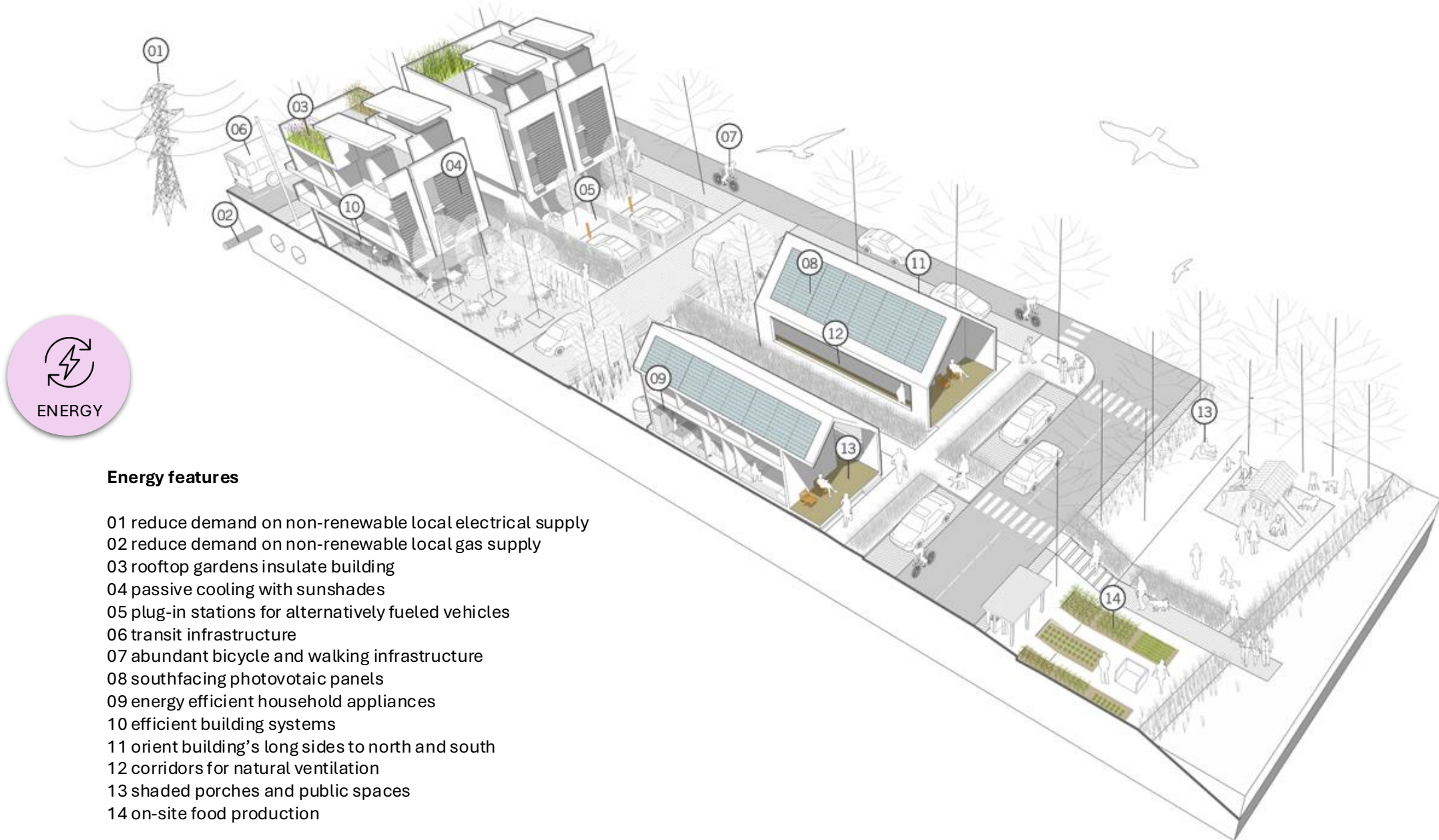

## Energy features

- 01 reduce demand on non-renewable local electrical supply
- 02 reduce demand on non-renewable local gas supply
- 03 rooftop gardens insulate building
- 04 passive cooling with sunshades
- 05 plug-in stations for alternatively fueled vehicles
- 06 transit infrastructure
- 07 abundant bicycle and walking infrastructure
- 08 southfacing photovoltaic panels
- 09 energy efficient household appliances
- 10 efficient building systems
- 11 orient building's long sides to north and south
- 12 corridors for natural ventilation
- 13 shaded porches and public spaces
- 14 on-site food production



Targets

Maximize use of non-potable water  
Release only clear water  
Recharge groundwater

Sources

Municipal water (potable)  
Groundwater  
Stormwater (non-potable)  
Greywater (non-potable)  
Blackwater (non-potable)

Uses

People (drinking, household, recreation)  
Irrigation  
Building systems  
Manufacturing  
Agriculture

Strategies

Clean water on site  
Eliminate waterborne pollutants  
Reuse greywater  
Efficient fixtures  
Infiltrate stormwater on site  
Slow water's movement across site  
Only non-potable water for irrigation  
Monitor flow and usage



## Water features

- 01 reduce demand on municipal potable water supply
- 02 rain garden in streetscape
- 03 vegetated roofs slow the movement of stormwater
- 04 rainwater collection for irrigation and building systems
- 05 micro-grading directs stormwater movement
- 06 water monitoring systems
- 07 pervious paving or soft paving for drives and alleys
- 08 bio-swales clean and infiltrate stormwater
- 09 greywater irrigation
- 10 low flow water fixtures
- 11 pervious paving or gravel parking stalls
- 12 collect and clean street run-off
- 13 reduce impervious paving width of street to minimum
- 14 water is a public space and recreational amenity







## Targets

Maximize use of non-biodegradables  
Use biodegradables as food + fuel  
Emit clean air

## Sources

Households + building occupancies  
Building systems  
Food preparation + disposals  
Landscape  
Transportation  
Building and site material production

## Uses

Recycling on or off site  
Composting biodegradables  
Reuse materials for construction

## Strategies

Low emission vehicles  
Divert waste for off-site reuse  
Waste treating building systems  
Organic fertilizers  
Composted soils  
Waste management program



## Waste features

- 01 low emission transportation
- 02 reduce impact on local sewer
- 03 recyclable building materials
- 04 low embodied carbon materials
- 05 waste treating building systems
- 06 community recycling program
- 07 in-home waste sorting
- 08 municipal rubbish collection in alleys
- 09 waste to fuel = community composting for agriculture

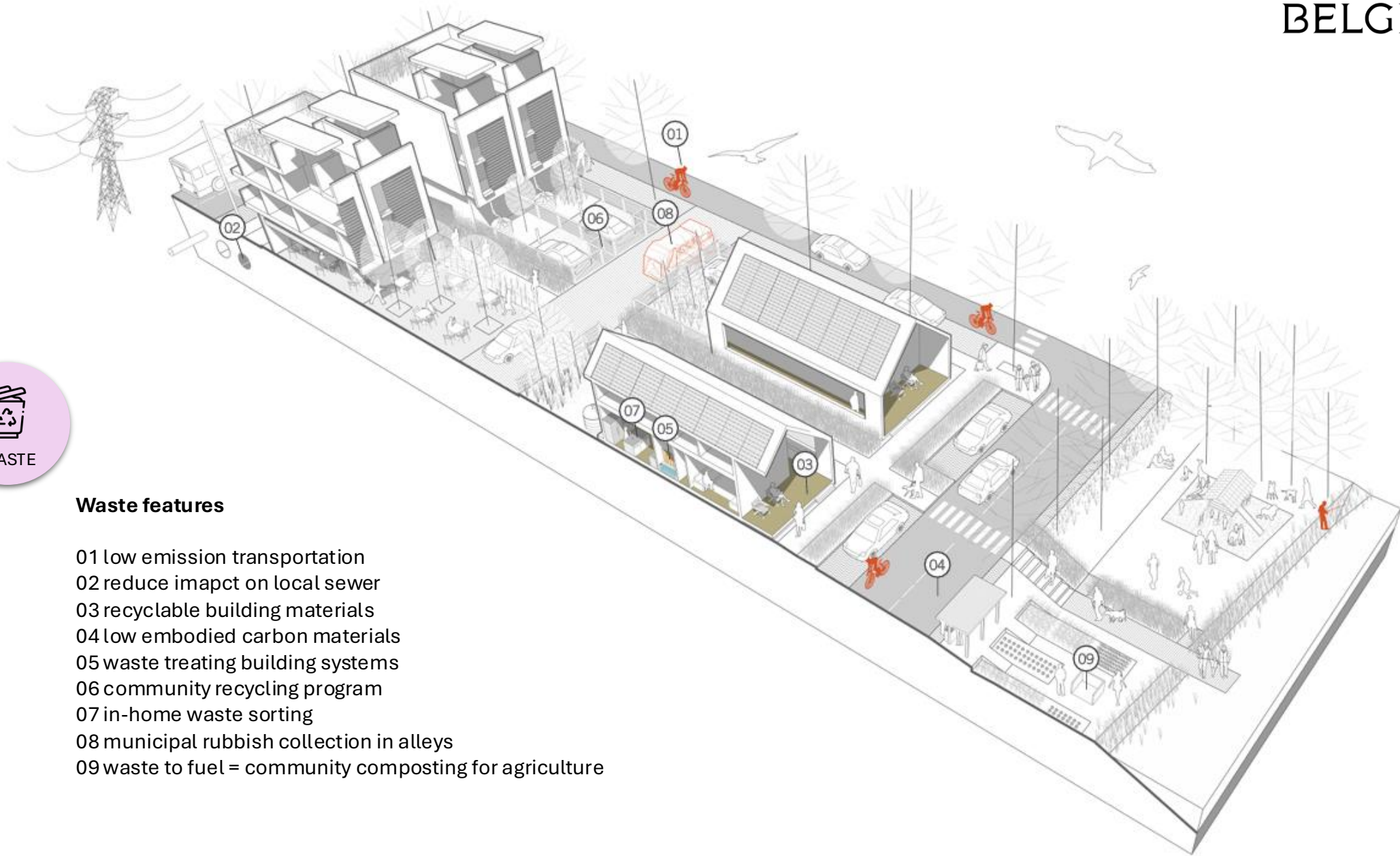



Targets

Buy goods with low impact  
Maximize local economic self-sufficiency

Sources

Manufactured goods  
Agricultural goods

Uses

People (food)  
Consumer goods + appliances  
Building + site materials + systems

Strategies

Produce consumer goods on site  
Buy goods produced + grown locally  
Use recycled goods

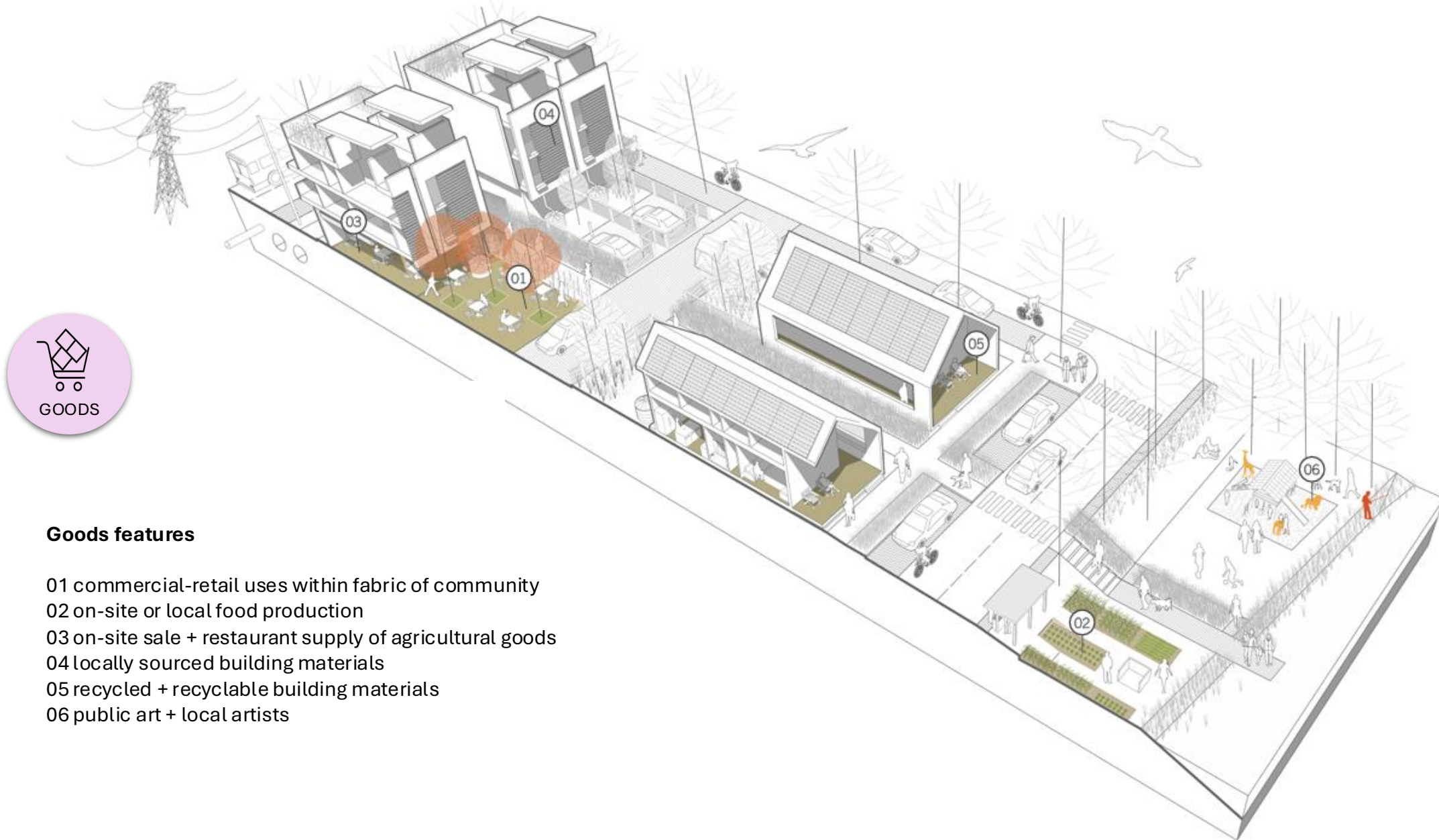

## Goods features

- 01 commercial-retail uses within fabric of community
- 02 on-site or local food production
- 03 on-site sale + restaurant supply of agricultural goods
- 04 locally sourced building materials
- 05 recycled + recyclable building materials
- 06 public art + local artists



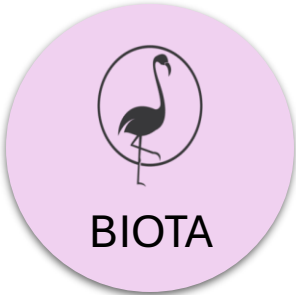

Targets

Maximize biodiversity  
Build natural habitats or corridors  
Maximum potential of on-site resources

Sources

Flora  
Fauna

Uses

Patches  
Edges  
Corridors  
Mosiacs

Strategies

Sizable naturally vegetated areas  
Construct varying natural edges  
Create vegetated corridors for movement  
Make corridor networks across site  
Native/naturalized landscape plants

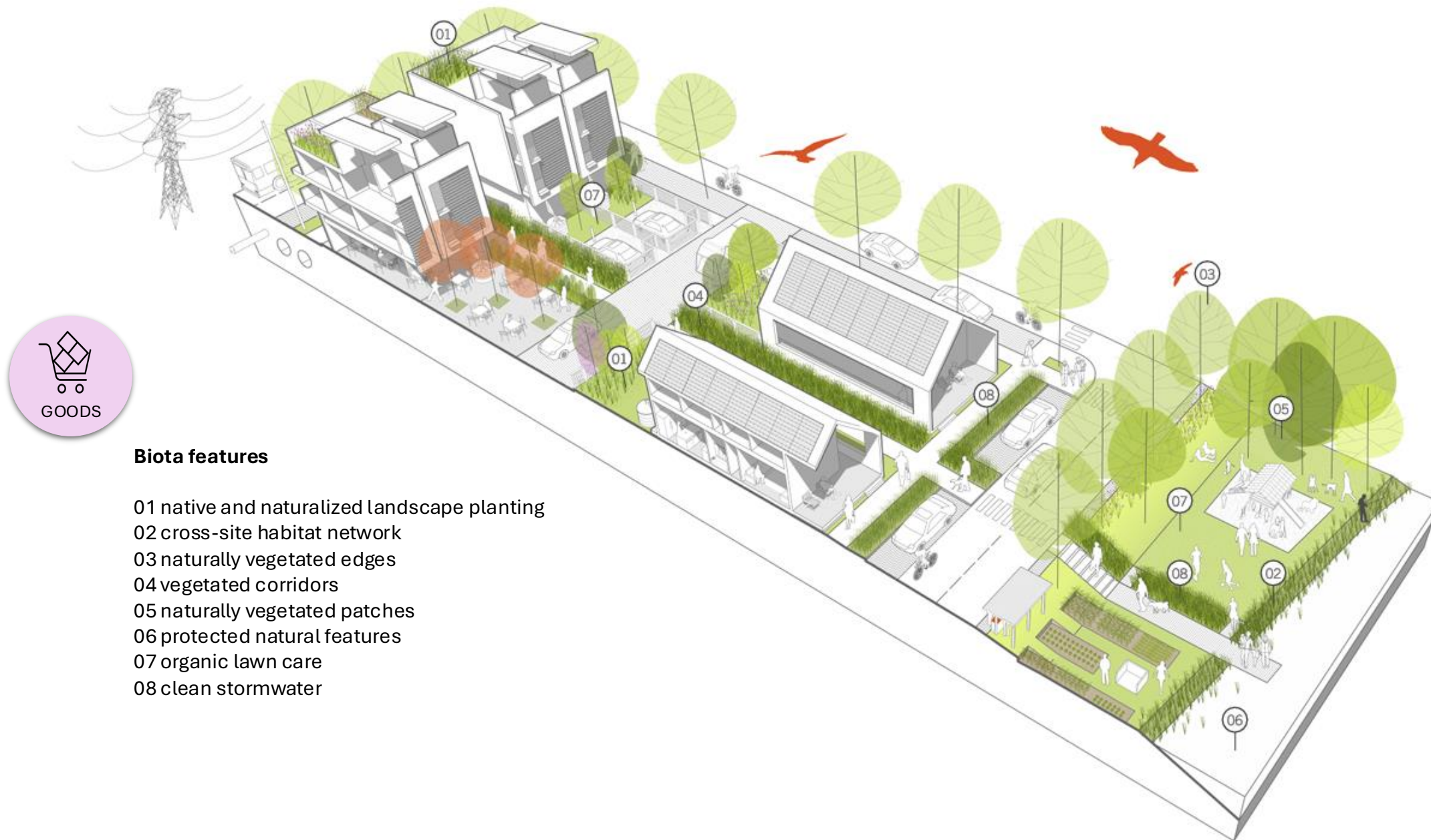

## Biota features

- 01 native and naturalized landscape planting
- 02 cross-site habitat network
- 03 naturally vegetated edges
- 04 vegetated corridors
- 05 naturally vegetated patches
- 06 protected natural features
- 07 organic lawn care
- 08 clean stormwater

B