

»» Seamless integration
with your **full arch**
Digital Workflow! ««



MedentiBASE®

- for polynomial customised bar and bridge designs
- compatible with 15 implant systems
- available in 5 gingiva heights
- conventional or CAD-CAM manufactured
- bonded or screwed into place
- different prosthesis components for maximum material diversity (zirconium, non-ferrous metal, titanium, stainless steel, plastics)

With the MedentiBASE® Abutment you have the option of producing the most diverse, polynomial, conventional bar and bridge designs or produce them using CAD/CAM in the upper and lower jaw. You can directly choose between screw bar and bridge construction or bar and bridge designs that are screwed in place with the aid of the MedentiBASE® adhesive bases for a passive fit. MedentiBASE® abutments and MedentiBASE® prosthesis components consist of pre-manufactured components that are precisely tailored to one another, which standardise the clinical and technical action. Precise and efficient working results in practice and in the dental laboratory result from this.

MedentiBASE® goes CAD/CAM

With the MedentiBASE® Abutment and the MedentiBASE® Library you have the option of producing the most diverse, polynomial bar and bridge designs using CAD/CAM in the upper and lower jaw.

You can scan and digitalise the model situation with the MedentiBASE® Scanbody. Of course you can receive the MedentiBASE® Library required for the design of the frame free of charge from Medentika. This is currently available for 3shape, Dentalwings and Exocad.

MedentiBASE® Abutments are available to you in 5 different gingiva heights.



The MedentiBASE® prosthesis component range comprises:

- MedentiBASE®-Implant Pick up for open tray (4620)
- MedentiBASE®-Lab Analog (4630)
- MedentiBASE®-Cover Cap (4610)



burn-out MedentiBASE® - Plastic Caps (4710)
 angussfähige MedentiBASE®- Gold Caps Castable (4720)
 MedentiBASE®-Titanium Caps for provisorische und definitive Versorgungungen (4700)

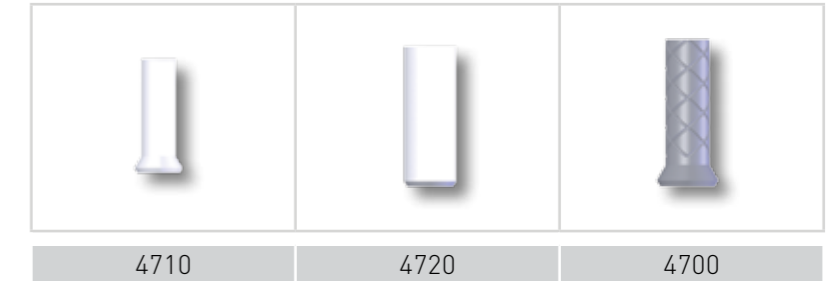

MedentiBASE®-Adhesive Caps for Passive-Fit (4800 u. 4810)
 MedentiBASE®-bridgescrew (4600)
 MedentiBASE®-Scanbody (4900)



Insertion of the abutment

The MedentiBASE®-Abutment is inserted in the implant using the MedentiBASE®-Screw Driver/Ratched (M 11-6). The Screw Driver is fixed on top of the MedentiBASE®-Abutment.

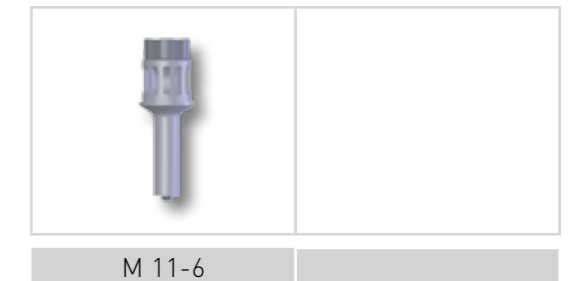

MedentiBASE® glue panel procedure for passive fit:

Preparation of the modelling

The burn-out plastic flap or the plastic flap that can be cast on is screwed on to the MedentiBASE® Abutment with the bridge screw, which is placed as centrally as possible in the model.

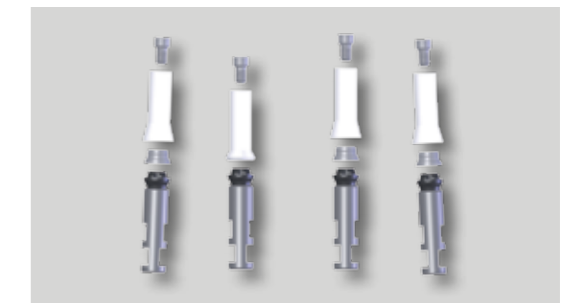

After the casting, this base can be directly applied to the MedentiBASE® Abutment and acts as a starting point and guidance base in this way.

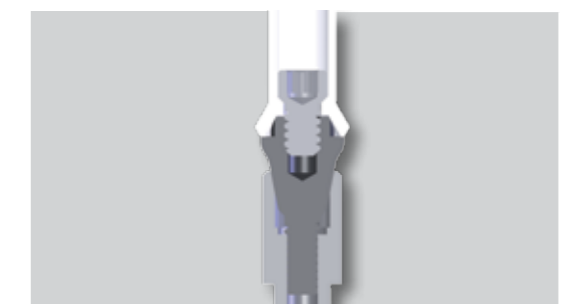

After this the burnout plastic adhesive cap is placed over the adhesive bases and both are attached to the MedentiBASE Abutment, using the slightly tightened bridge screw. In this way the head of the bridge screw is on the temporary screw base of the plastic adhesive casings and centred in the middle on the adhesive base.

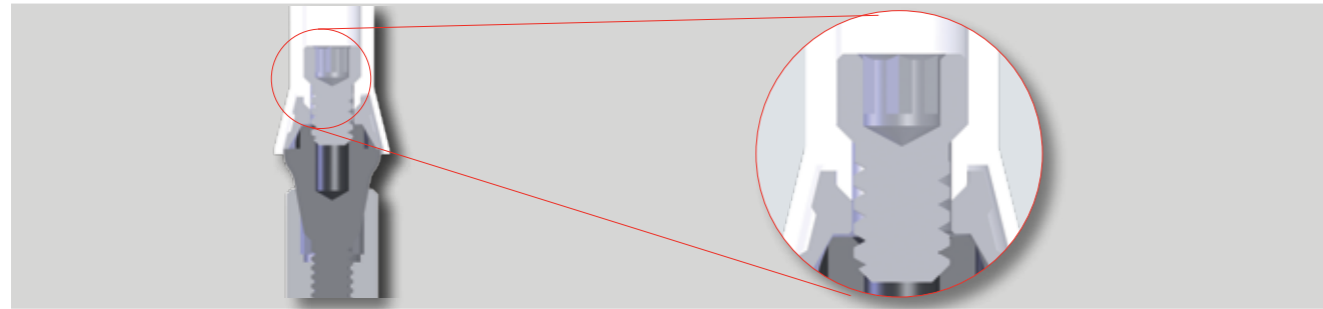

Modelling of the frame

The vertical space that is available defines the necessary length of the burn-out plastic adhesive casings and the guiding base. In the case of the dimensioning of the fitting proportions the general guidelines for the achievement of optimal stability and hygiene capability of the fitting must be observed.

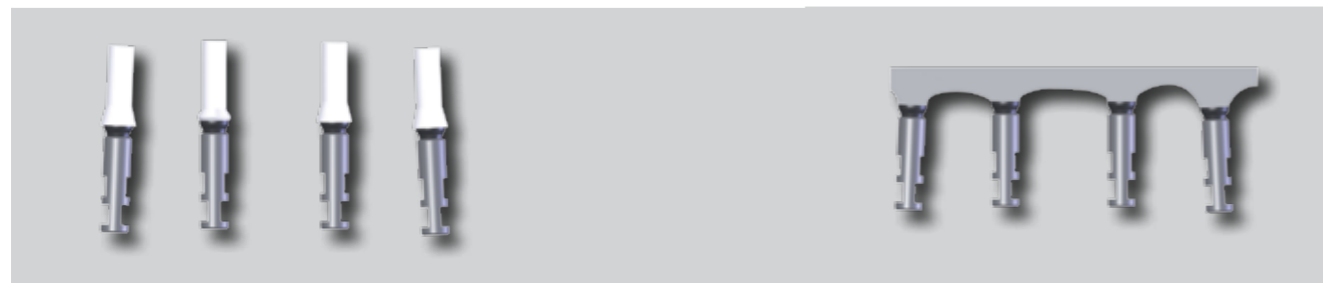

The temporary screw support in the plastic adhesive casings that can be burned out must be removed with a round burr (2.4 mm) before embedding the model.

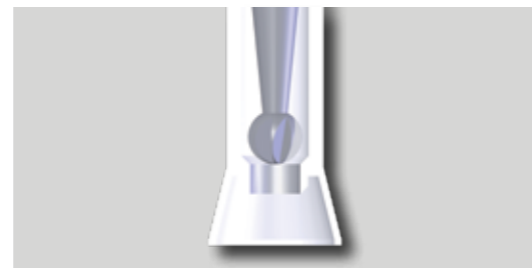

You must check that the bridge screw can pass through the entire length of the adhesive casing unhindered.

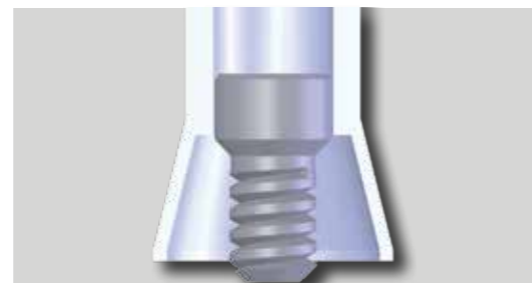

The bridge screw is always positioned directly in the final construction of the fitting and affixes this securely upon the MedentiBASE® Abutment at the stated torque level (15 Ncm).

The finishing and placement of the fitting upon the MedentiBASE® Abutments

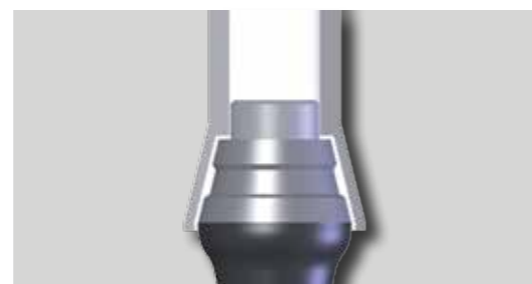

It is important that a circular evenly dimensioned glue adhesive gap is guaranteed after the pouring and devesting of the fitting. To do this, place the cast fitting on the MedentiBASE® Abutment. In this process it is either guided through the plastic panel that can be burned out or the HSL panel that can be cast on. Fix it in place with the bridge screw to this end.

The cylindrical amount that protrudes (see diagram) is subsequently manually removed.

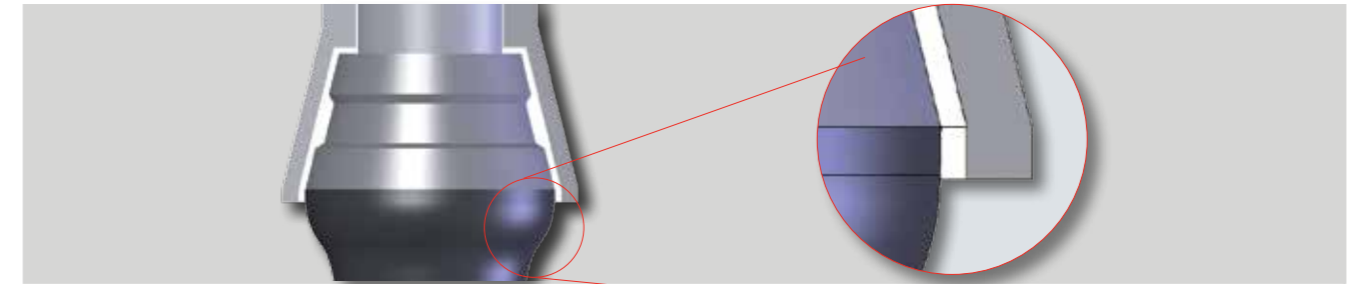

Now all the bonding bases are attached to the MedentiBASE® Abutments with the bridge screws.

If you place the fitting that has been cast on the MedentiBASE® Abutments with the plastic adhesive casing that have now been cast these should reveal a circular adhesive gap between the adhesive base and the plastic adhesive casings cast. If this is not the case and disruptive contacts prevent placement in the correct position then they must be removed with appropriate tools. The application of paint or matting on the contact surfaces helps to localise the contact points.



Bonding in place of the MedentiBASE® adhesive bases

„Passive fit“ means nothing else than a completely tension-free positioning of the fitting. The fulfilment of the „Sheffield test“ criteria is imperative here.

If fit differences emerge through interfering contacts between the model and mouth situation then these interfering contacts must be completely removed. Prior to the subsequent machining in the laboratory the interfering MedentiBASE® Abutment (MedentiBASE laboratory analogue) will be removed from the model. This guarantees the same fitting position on the model as in the mouth.

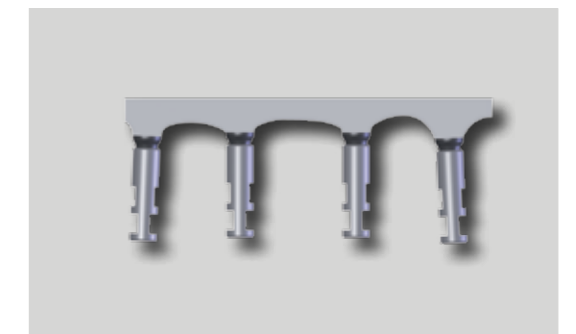

The bonding surfaces must be prepared according to the manufacturer's instructions to guarantee a reliable bond of the adhesive base with the fitting. Grooves are ground into the fitting that has been cast to optimise the bonding. The components prepared in this way are now attached to the MedentiBASE® abutments with the bridge screws whilst observing the recommended torque levels. The hexagon socket of the screw head is covered with modelling wax. However, the bonding surfaces must remain clean here.

After this, apply the glue to the bonding surfaces. Then the fitting is to be placed on all the MedentiBASE® abutments and the guiding base is to be fixed in place with the bridge screw. Please observe the cure time of the glue used!

Excess glue in the screw channels should be removed immediately. If the glue has completely cured remove the bridge screws and the fitting. Now all the excess glue is removed. In this process the fit surfaces between the bonding base and the MedentiBASE® Abutment should not be damaged.

MedentiBASE abutment straight

- Titanium grade 5 KV
- Recommended torque: 35 Ncm

Implant connection	NP 3.5	NP 3.5	NP 3.5	NP 3.5	NP 3.5
Gingiva height	0.5	1.5	2.5	3.5	4.5
Article Number	E 4000	E 4100	E 4200	E 4300	E 4400

MedentiBASE abutment straight

- Titanium grade 5 KV
- Recommended torque: 35 Ncm

Implant connection	RP 4.3	RP 4.3	RP 4.3	RP 4.3	RP 4.3
Gingiva height	0.5	1.5	2.5	3.5	4.5
Article Number	E 4010	E 4110	E 4210	E 4310	E 4410

MedentiBASE prosthetic components

- E 7600 MedentiBASE bridge screw UG
- E 4700 MedentiBASE titanium cap includes bridge screw
- E 4710 MedentiBASE plastic cap includes bridge screw
- E 4720 MedentiBASE gold cap, castable incl. bridge screw
- E 4840 MedentiBASE titanium base includes bridge screw
- Recommended torque: 15 Ncm

Material	Titanium grade 5 KV	Titanium grade 5 KV	PMMA	"[AU 60%; Pd 20%; Pt 19%; Ir 1%]"
Article Number	E 7600	E 4700	E 4710	E 4720

MedentiBASE scanbody

- Titanium grade 5 KV specially coated
- incl. bridge screw

Article Number	E 4900
Please note:	The Scanbody is sterilisable and for intra-oral scanning.

MedentiBASE adhesive cap for passive-fit

- E 4800 MedentiBASE adhesive cap Short, 3mm height, includes bridge screw
- E 4810 MedentiBASE adhesive casing Short
- E 4820 MedentiBASE adhesive cap Long, 4mm height includes bridge screw
- E 4830 MedentiBASE adhesive casing Long

Version	Short	Short	Long	Long
Article Number	E 4800	E 4810	E 4820	E 4830

MedentiBASE accessories

- M 11-6 Placement instrument MedentiBASE abutment
- E 4620 MedentiBASE implant pick up
- 4630 MedentiBASE laboratory implant
- 80 MedentiBASE laboratory implant CAD/CAM

Article Number	E 4620	4630	M 11-6	80

MedentiBASE abutment straight

- Titanium grade 5 KV
- Recommended torque: 35 Ncm

Implant connection	NP 3.5	NP 3.5	NP 3.5	NP 3.5	NP 3.5
Gingiva height	0.5	1.5	2.5	3.5	4.5
Article Number	F 4000	F 4100	F 4200	F 4300	E 4400

MedentiBASE abutment straight

- Titanium grade 5 KV
- Recommended torque: 35 Ncm

Implant connection	RP 4.3/5.0	RP 4.3/5.0	RP 4.3/5.0	RP 4.3/5.0	RP 4.3/5.0
Gingiva height	0.5	1.5	2.5	3.5	4.5
Article Number	F 4010	F 4110	F 4210	F 4310	F 4410

MedentiBASE prosthetic components

- F 7600 MedentiBASE bridge screw UG
- F 4700 MedentiBASE titanium cap includes bridge screw
- F 4710 MedentiBASE plastic cap includes bridge screw
- F 4720 MedentiBASE gold cap, castable incl. bridge screw
- F 4840 MedentiBASE titanium base includes bridge screw
- Recommended torque: 15 Ncm

Material	Titanium grade 5 KV	Titanium grade 5 KV	PMMA	"[AU 60%; Pd 20%; Pt 19%; Ir 1%]"
Article Number	F 7600	F 4700	F 4710	F 4720

MedentiBASE scanbody

- Titanium grade 5 KV specially coated
- incl. bridge screw

Article Number	F 4900
Please note:	The Scanbody is sterilisable and for intra-oral scanning.

MedentiBASE adhesive cap for passive-fit

- F 4800 MedentiBASE adhesive cap Short, 3mm height, includes bridge screw
- F 4810 MedentiBASE adhesive casing Short
- F 4820 MedentiBASE adhesive cap Long, 4mm height includes bridge screw
- F 4830 MedentiBASE adhesive casing Long

Version	Short	Short	Long	Long
Article Number	F 4800	F 4810	F 4820	F 4830

MedentiBASE accessories

- M 11-6 Placement instrument MedentiBASE abutment
- F 4620 MedentiBASE implant pick up
- 4630 MedentiBASE laboratory implant
- 80 MedentiBASE laboratory implant CAD/CAM

Article Number	F 4620	4630	M 11-6	80

H-Series

BIOMET 3i®
Certain®

MedentiBASE abutment straight

- Titanium grade 5 KV
- Recommended torque: 20 Ncm

Implant connection	D 3.4	D 3.4	D 3.4	D 3.4	D 3.4
Gingiva height	0.5	1.5	2.5	3.5	4.5
Article Number	H 4000	H 4100	H 4200	H 4300	H 4400

MedentiBASE abutment straight

- Titanium grade 5 KV
- Recommended torque: 20 Ncm

Implant connection	D 4.1	D 4.1	D 4.1	D 4.1	D 4.1
Gingiva height	0.5	1.5	2.5	3.5	4.5
Article Number	H 4010	H 4110	H 4210	H 4310	H 4410

MedentiBASE prosthetic components

- H 7600 MedentiBASE bridge screw UG
- H 4700 MedentiBASE titanium cap includes bridge screw
- H 4710 MedentiBASE plastic cap includes bridge screw
- H 4720 MedentiBASE gold cap, castable incl. bridge screw
- H 4840 MedentiBASE titanium base includes bridge screw
- Recommended torque: 15 Ncm

Material	Titanium grade 5 KV	Titanium grade 5 KV	PMMA	"[AU 60%; Pd 20%; Pt 19%; Ir 1%]"
Article Number	H 7600	H 4700	H 4710	H 4720

MedentiBASE scanbody

- Titanium grade 5 KV specially coated
- incl. bridge screw

Article Number	H 4900
Please note: The Scanbody is sterilisable and for intra-oral scanning.	

MedentiBASE adhesive cap for passive-fit

- H 4800 MedentiBASE adhesive cap Short, 3mm height, includes bridge screw
- H 4810 MedentiBASE adhesive casing Short
- H 4820 MedentiBASE adhesive cap Long, 4mm height includes bridge screw
- H 4830 MedentiBASE adhesive casing Long

Version	Short	Short	Long	Long
Article Number	H 4800	H 4810	H 4820	H 4830

MedentiBASE accessories

- M 11-6 Placement instrument MedentiBASE abutment
- H 4620 MedentiBASE implant pick up
- 4630 MedentiBASE laboratory implant
- 80 MedentiBASE laboratory implant CAD/CAM

Article Number	H 4620	4630	M 11-6	80

I-Series

BIOMET 3i®
External Hex

MedentiBASE abutment straight

- Titanium grade 5 KV
- Recommended torque: 35 Ncm

Implant connection	D 3.4	D 3.4	D 3.4
Gingiva height	2.5	3.5	4.5
Article Number	I 4000	I 4100	I 4200

MedentiBASE abutment straight

- Titanium grade 5 KV
- Recommended torque: 35 Ncm

Implant connection	RP 4.3/5.0	RP 4.3/5.0	RP 4.3/5.0
Gingiva height	2.5	3.5	4.5
Article Number	I 4010	I 4110	I 4210

MedentiBASE prosthetic components

- I 7600 MedentiBASE bridge screw UG
- I 4700 MedentiBASE titanium cap includes bridge screw
- I 4710 MedentiBASE plastic cap includes bridge screw
- I 4720 MedentiBASE gold cap, castable incl. bridge screw
- I 4840 MedentiBASE titanium base includes bridge screw
- Recommended torque: 15 Ncm

Material	Titanium grade 5 KV	Titanium grade 5 KV	PMMA	"[AU 60%; Pd 20%; Pt 19%; Ir 1%]"
Article Number	I 7600	I 4700	I 4710	I 4720

MedentiBASE scanbody

- Titanium grade 5 KV specially coated
- incl. bridge screw

Article Number	I 4900
Please note: The Scanbody is sterilisable and for intra-oral scanning.	

MedentiBASE adhesive cap for passive-fit

- I 4800 MedentiBASE adhesive cap Short, 3mm height, includes bridge screw
- I 4810 MedentiBASE adhesive casing Short
- I 4820 MedentiBASE adhesive cap Long, 4mm height includes bridge screw
- I 4830 MedentiBASE adhesive casing Long

Version	Short	Short	Long	Long
Article Number	I 4800	I 4810	I 4820	I 4830

MedentiBASE accessories

- M 11-6 Placement instrument MedentiBASE abutment
- I 4620 MedentiBASE implant pick up
- 4630 MedentiBASE laboratory implant
- 80 MedentiBASE laboratory implant CAD/CAM

Article Number	I 4620	4630	M 11-6	80

K-Series

Nobel Biocare®
Brånemark®

MedentiBASE abutment straight

- Titanium grade 5 KV
- Recommended torque: 35 Ncm

Implant connection	NP 3.4	NP 3.4	NP 3.4
Gingiva height	2.5	3.5	4.5
Article Number	K 4000	K 4100	K 4200

MedentiBASE abutment straight

- Titanium grade 5 KV
- Recommended torque: 35 Ncm

Implant connection	RP 4.1	RP 4.1	RP 4.1
Gingiva height	2.5	3.5	4.5
Article Number	K 4010	K 4110	K 4210

MedentiBASE prosthetic components

- K 7600 MedentiBASE bridge screw UG
- K 4700 MedentiBASE titanium cap includes bridge screw
- K 4710 MedentiBASE plastic cap includes bridge screw
- K 4720 MedentiBASE gold cap, castable incl. bridge screw
- K 4840 MedentiBASE titanium base includes bridge screw
- Recommended torque: 15 Ncm

Material	Titanium grade 5 KV	Titanium grade 5 KV	PMMA	"[AU 60%; Pd 20%; Pt 19%; Ir 1%]"
Article Number	K 7600	K 4700	K 4710	K 4720

MedentiBASE scanbody

- Titanium grade 5 KV specially coated
- incl. bridge screw

Article Number	K 4900
Please note: The Scanbody is sterilisable and for intra-oral scanning.	

MedentiBASE adhesive cap for passive-fit

- K 4800 MedentiBASE adhesive cap Short, 3mm height, includes bridge screw
- K 4810 MedentiBASE adhesive casing Short
- K 4820 MedentiBASE adhesive cap Long, 4mm height includes bridge screw
- K 4830 MedentiBASE adhesive casing Long

Version	Short	Short	Long	Long
Article Number	K 4800	K 4810	K 4820	K 4830

MedentiBASE accessories

- M 11-6 Placement instrument MedentiBASE abutment
- K 4620 MedentiBASE implant pick up
- 4630 MedentiBASE laboratory implant
- 80 MedentiBASE laboratory implant CAD/CAM

Article Number	K 4620	4630	M 11-6	80

N-Series

Straumann®
Tissue Level®

MedentiBASE abutment straight

- Titanium grade 5 KV
- Recommended torque: 35 Ncm

Implant connection	NNC 3.5	NNC 3.5	NNC 3.5	NNC 3.5	NNC 3.5
Gingiva height	0.5	1.5	2.5	3.5	4.5
Article Number	N 4030	N 4130	N 4230	N 4330	N 4430

MedentiBASE prosthetic components

- NNC 7600 MedentiBASE bridge screw UG
- NNC 4700 MedentiBASE titanium cap includes bridge screw
- NNC 4710 MedentiBASE plastic cap includes bridge screw
- NNC 4720 MedentiBASE gold cap, castable incl. bridge screw
- NNC 4840 MedentiBASE titanium base includes bridge screw
- Recommended torque: 15 Ncm

Material		Titanium grade 5 KV	Titanium grade 5 KV	PMMA
Article Number		NNC 7600	NNC 4700	NNC 4710
				NNC 4720
				"[AU 60%; Pd 20%; Pt 19%; Ir 1%]"

MedentiBASE scanbody

- Titanium grade 5 KV specially coated
- incl. bridge screw

Article Number	NNC 4900
Please note: The Scanbody is sterilisable and for intra-oral scanning.	

MedentiBASE adhesive cap for passive-fit

- NNC 4800 MedentiBASE adhesive cap Short, 3mm height, includes bridge screw
- N 4810 MedentiBASE adhesive casing Short
- N 4820 MedentiBASE adhesive cap Long, 4mm height includes bridge screw
- NNC 4830 MedentiBASE adhesive casing Long

Version	Short	Short	Long	Long
Article Number	NNC 4800	NNC 4810	NNC 4820	NNC 4830

MedentiBASE accessories

- M 11-6 Placement instrument MedentiBASE abutment
- N 4620 MedentiBASE implant pick up
- 4630 MedentiBASE laboratory implant
- 80 MedentiBASE laboratory implant CAD/CAM

Article Number	NNC 4620	4630	M 11-6	80

MedentiBASE abutment straight

- Titanium grade 5 KV
- Recommended torque: 35 Ncm



Implant connection	RN 4.8
Gingiva height	0
Article Number	N 4010

MedentiBASE prosthetic components

- N 7600 MedentiBASE bridge screw UG
- N 4700 MedentiBASE titanium cap includes bridge screw
- N 4710 MedentiBASE plastic cap includes bridge screw
- N 4720 MedentiBASE gold cap, castable incl. bridge screw
- N 4840 MedentiBASE titanium base includes bridge screw
- Recommended torque: 15 Ncm

Material				
	Titanium grade 5 KV	Titanium grade 5 KV	PMMA	"[AU 60%; Pd 20%; Pt 19%; Ir 1%]"
Article Number	N 7600	N 4700	N 4710	N 4720

MedentiBASE scanbody

- Titanium grade 5 KV specially coated
- incl. bridge screw



Article Number	N 4900
----------------	--------

Please note: The Scanbody is sterilisable and for intra-oral scanning.

MedentiBASE adhesive cap for passive-fit

- N 4800 MedentiBASE adhesive cap Short, 3mm height, includes bridge screw
- N 4810 MedentiBASE adhesive casing Short
- N 4820 MedentiBASE adhesive cap Long, 4mm height includes bridge screw
- NNC 4830 MedentiBASE adhesive casing Long

Version				
	Short	Short	Long	Long
Article Number	N 4800	N 4810	N 4820	N 4830

MedentiBASE accessories

- M 11-6 Placement instrument MedentiBASE abutment
- NNC 4620 MedentiBASE implant pick up
- 4630 MedentiBASE laboratory implant
- 80 MedentiBASE laboratory implant CAD/CAM

Article Number				
	N 4620	4630	M 11-6	80

MedentiBASE abutment straight

- Titanium grade 5 KV
- Recommended torque: 30 Ncm



Implant connection	D 3.5	D 3.5	D 3.5	D 3.5	D 3.5
Gingiva height	0.5	1.5	2.5	3.5	4.5
Article Number	R 4000	R 4100	R 4200	R 4300	R 4400

MedentiBASE abutment straight

- Titanium grade 5 KV
- Recommended torque: 20 Ncm



Implant connection	D 4.5	D 4.5	D 4.5	D 4.5	D 4.5
Gingiva height	0.5	1.5	2.5	3.5	4.5
Article Number	R 4010	R 4110	R 4210	R 4310	R 4410

MedentiBASE prosthetic components

- R 7600 MedentiBASE bridge screw UG
- R 4700 MedentiBASE titanium cap includes bridge screw
- R 4710 MedentiBASE plastic cap includes bridge screw
- R 4720 MedentiBASE gold cap, castable incl. bridge screw
- R 4840 MedentiBASE titanium base includes bridge screw
- Recommended torque: 15 Ncm

Material				
	Titanium grade 5 KV	Titanium grade 5 KV	PMMA	"[AU 60%; Pd 20%; Pt 19%; Ir 1%]"
Article Number	R 7600	R 4700	R 4710	R 4720

MedentiBASE scanbody

- Titanium grade 5 KV specially coated
- incl. bridge screw



Article Number	R 4900
----------------	--------

Please note: The Scanbody is sterilisable and for intra-oral scanning.

MedentiBASE adhesive cap for passive-fit

- R 4800 MedentiBASE adhesive cap Short, 3mm height, includes bridge screw
- R 4810 MedentiBASE adhesive casing Short
- R 4820 MedentiBASE adhesive cap Long, 4mm height includes bridge screw
- R 4830 MedentiBASE adhesive casing Long

Version				
	Short	Short	Long	Long
Article Number	R 4800	R 4810	R 4820	R 4830

MedentiBASE accessories

- M 11-6 Placement instrument MedentiBASE abutment
- R 4620 MedentiBASE implant pick up
- 4630 MedentiBASE laboratory implant
- 80 MedentiBASE laboratory implant CAD/CAM

Article Number				
	R 4620	4630	M 11-6	80

S-Series

DENTSPLY Implants®
ASTRA TECH OsseoSpeed TX®

MedentiBASE abutment straight

- Titanium grade 5 KV
- Recommended torque: 25 Ncm

Implant connection	D 3.5/4.0	D 3.5/4.0	D 3.5/4.0	D 3.5/4.0	D 3.5/4.0
Gingiva height	0.5	1.5	2.5	3.5	4.5
Article Number	S 4000	S 4100	S 4200	S 4300	S 4400

MedentiBASE abutment straight

- Titanium grade 5 KV
- Recommended torque: 25 Ncm

Implant connection	D 4.5/5.0	D 4.5/5.0	D 4.5/5.0	D 4.5/5.0	D 4.5/5.0
Gingiva height	0.5	1.5	2.5	3.5	4.5
Article Number	S 4020	S 4120	S 4220	S 4320	S 4420

MedentiBASE prosthetic components

- S 7600 MedentiBASE bridge screw UG
- S 4700 MedentiBASE titanium cap includes bridge screw
- S 4710 MedentiBASE plastic cap includes bridge screw
- S 4720 MedentiBASE gold cap, castable incl. bridge screw
- S 4840 MedentiBASE titanium base includes bridge screw
- Recommended torque: 15 Ncm

Material	Titanium grade 5 KV	Titanium grade 5 KV	PMMA	"[AU 60%; Pd 20%; Pt 19%; Ir 1%]"
Article Number	S 7600	S 4700	S 4710	S 4720

MedentiBASE scanbody

- Titanium grade 5 KV specially coated
- incl. bridge screw

Article Number	S 4900

Please note: The Scanbody is sterilisable and for intra-oral scanning.

MedentiBASE adhesive cap for passive-fit

- S 4800 MedentiBASE adhesive cap Short, 3mm height, includes bridge screw
- S 4810 MedentiBASE adhesive casing Short
- S 4820 MedentiBASE adhesive cap Long, 4mm height includes bridge screw
- S 4830 MedentiBASE adhesive casing Long

Version	Short	Short	Long	Long
Article Number	S 4800	S 4810	S 4820	S 4830

MedentiBASE accessories

- M 11-6 Placement instrument MedentiBASE abutment
- S 4620 MedentiBASE implant pick up
- 4630 MedentiBASE laboratory implant
- 80 MedentiBASE laboratory implant CAD/CAM

Article Number	S 4620	4630	M 11-6	80

T-Series

DENTSPLY Implants®
XiVE S®

MedentiBASE abutment straight

- Titanium grade 5 KV
- Recommended torque: 25 Ncm

Implant connection	D 3.4	D 3.4	D 3.4	D 3.4	D 3.4
Gingiva height	0.5	1.5	2.5	3.5	4.5
Article Number	T 4000	T 4100	T 4200	T 4300	T 4400

MedentiBASE abutment straight

- Titanium grade 5 KV
- Recommended torque: 25 Ncm

Implant connection	D 3.8	D 3.8	D 3.8	D 3.8	D 3.8
Gingiva height	0.5	1.5	2.5	3.5	4.5
Article Number	T 4005	T 4105	T 4205	T 4305	T 4405

MedentiBASE abutment straight

- Titanium grade 5 KV
- Recommended torque: 25 Ncm

Implant connection	D 4.5	D 4.5	D 4.5	D 4.5	D 4.5
Gingiva height	0.5	1.5	2.5	3.5	4.5
Article Number	T 4010	T 4110	T 4210	T 4310	T 4410

MedentiBASE prosthetic components

- T 7600 MedentiBASE bridge screw UG
- T 4700 MedentiBASE titanium cap includes bridge screw
- T 4710 MedentiBASE plastic cap includes bridge screw
- T 4720 MedentiBASE gold cap, castable includes bridge screw
- T 4840 MedentiBASE titanium base includes bridge screw
- Recommended torque: 15 Ncm

Material	Titanium grade 5 KV	Titanium grade 5 KV	PMMA	"[AU 60%; Pd 20%; Pt 19%; Ir 1%]"
Article Number	T 7600	T 4700	T 4710	T 4720

MedentiBASE scanbody

- Titanium grade 5 KV specially coated
- incl. bridge screw

Article Number	T 4900

Please note: The Scanbody is sterilisable and for intra-oral scanning.

MedentiBASE adhesive cap for passive-fit

- T 4800 MedentiBASE adhesive cap Short, 3mm height, includes bridge screw
- T 4810 MedentiBASE adhesive casing Short
- T 4820 MedentiBASE adhesive cap Long, 4mm height includes bridge screw
- T 4830 MedentiBASE adhesive casing Long

Version	Short	Short	Long	Long
Article Number	T 4800	T 4810	T 4820	T 4830

MedentiBASE accessories

- M 11-6 Placement instrument MedentiBASE abutment
- T 4620 MedentiBASE implant pick up
- 4630 MedentiBASE laboratory implant
- 80 MedentiBASE laboratory implant CAD/CAM

Article Number	T 4620	4630	M 11-6	80

MedentiBASE abutment straight

- Titanium grade 5 KV
- Recommended torque: 25 Ncm



Implant connection	D 3.5-7.0	D 3.5-7.0	D 3.5-7.0	D 3.5-7.0	D 3.5-7.0
Gingiva height	0.5	1.5	2.5	3.5	4.5
Article Number	Y 4000	Y 4100	Y 4200	Y 4300	Y 4400

MedentiBASE prosthetic components

- Y 7600 MedentiBASE bridge screw UG
- Y 4700 MedentiBASE titanium cap includes bridge screw
- Y 4710 MedentiBASE plastic cap includes bridge screw
- Y 4720 MedentiBASE gold cap, castable incl. bridge screw
- Y 4840 MedentiBASE titanium base includes bridge screw
- Recommended torque: 15 Ncm

Material	Titanium grade 5 KV	Titanium grade 5 KV	PMMA	"[AU 60%; Pd 20%; Pt 19%; Ir 1%]"
Article Number	Y 7600	Y 4700	Y 4710	Y 4720

MedentiBASE scanbody

- Titanium grade 5 KV specially coated
- incl. bridge screw



Article Number	Y 4900
Please note:	The Scanbody is sterilisable and for intra-oral scanning.

MedentiBASE adhesive cap for passive-fit

- Y 4800 MedentiBASE adhesive cap Short, 3mm height, includes bridge screw
- Y 4810 MedentiBASE adhesive casing Short
- Y 4820 MedentiBASE adhesive cap Long, 4mm height includes bridge screw
- Y 4830 MedentiBASE adhesive casing Long

Version	Short	Short	Long	Long
Article Number	Y 4800	Y 4810	Y 4820	Y 4830

MedentiBASE accessories

- M 11-6 Placement instrument MedentiBASE abutment
- Y 4620 MedentiBASE implant pick up
- 4630 MedentiBASE laboratory implant
- 80 MedentiBASE laboratory implant CAD/CAM

Article Number	Y 4620	4630	M 11-6	80
----------------	--------	------	--------	----

Placement instrument Hex 1.26

- Hardened stainless steel

Version	Contra-angle	Contra-angle	Manual and ratchet	Manual and ratchet
Type	long	short	long	short
Article Number	M 03-1	M 09-1	M 10-1	M 11-1
Suitable for: I-Series, R-Series, S-Series, Medentiloc				

Placement instrument Hex 1.2

- Hardened stainless steel

Version	Contra-angle	Contra-angle	Manual and ratchet	Manual and ratchet
Type	long	short	long	short
Article Number	M 03-2	M 09-2	M 10-2	M 11-2
Suitable for: T-Series, H-Series				

Placement instrument Hex 1.0

- Hardened stainless steel

Version	Contra-angle	Contra-angle	Manual and ratchet	Manual and ratchet
Type	long	short	long	short
Article Number	M 03-3	M 09-3	M 10-3	M 11-3
Suitable for: Y-Series				

Placement instrument Torx T6®

- Hardened stainless steel

Version	Contra-angle	Contra-angle	Manual and ratchet	Manual and ratchet
Type	long	short	long	short
Article Number	M 03-4	M 09-4	M 10-4	M 11-4
Suitable for: N-Series				

Placement instrument UG

- Hardened stainless steel

Version	Contra-angle	Contra-angle	Manual and ratchet	Manual and ratchet
Type	long	short	long	short
Article Number	M 03-5	M 09-5	M 10-5	M 11-5
Suitable for: E-Series, F-Series, K-Series				

Placement instrument MedentiLOC abutment, angled

- Hardened stainless steel
- Ball Hex

Version	Contra-angle	Manual and ratchet
Article Number	M 03-7	M 10-7

Placement instrument MedentiBASE abutment

- Stainless steel

Version	Manual and ratchet
Type	2-piece
Article Number	M 11-6

Torque ratchet

- With infinitely variable torque setting
- 10-40 Ncm
- Hardened stainless steel



Article Number

M 12

Adapter ISO shank

- Ratchet M12
- Hardened stainless steel



Article Number

M 14

Processing holder, prosthetics

- Fits all inserts
- Stainless steel



Article Number

M 04

MedentiBASE finisher Connection geometry

- Tungsten carbide



Version

Connection geometry

Screw head

Connection ge-

Article Number

M 17

M 18

M 19

Please note: This is used to finish the fitting surfaces of the MedentiBASE plastic cap 4710 after casting. For the MedentiBASE plastic cap N 4710 the Finisher M 19 is required. The Finishers are used in the Processing holder prosthetic M 04.

Screw channel block-out pin Titanium base

- Aluminium



Version

blue coated

Article Number

M 05-1

Suitable for: H 1000 - H 1020, H 1100 - H 1120, H 1500 - H 1520, H 800 - H 820, K 1100, K 1500, K 800, K 1000, N 1100, N 800, N 1000, S 1030, S 1130, S 1530, T 1000 - T 1020, T 1100 - T 1120, T 1500 - T 1520, T 800 - T 820

Screw channel block-out pin Titanium base

- Aluminium



Version

black coated

Article Number

M 05-2

Suitable for: F 1100, F 1200, F 1300, F 1500, F 800, F 1000, S 1100, S 1200, S 1300, S 1500, S 800, S 1000

Screw channel block-out pin Titanium base

- Aluminium



Version

red coated

Article Number

M 05-3

Suitable for: S 1020, S 1220, S 1120, S 1320, S 1520, S 820

Screw channel block-out pin Titanium base

- Aluminium



Version

yellow coated

Article Number

M 05-4

Suitable for: E 1000 - E 1030, E 1100 - E 1130, E 1500 - E 1520, E 800 - E 830, F 1110, F 1210, F 1310, F 1510, F 810, F 1010, I 1000 - I 1020, I 1100 - I 1120, I 1500 - I 1520, I 800 - I 820, K 1110, K 1510, K 810, K 1010, N 1010, N 1020, N 1110, N 1120, N 1510, N 1520, N 810, N 820, R 1000 - R 1020, R 1100 - R 1120, R 1500 - R 1520, R 800 - R 820

Wooden tool box Placement instrument Manual and ratchet

- Without contents



Need photo

Article Number

MB 02

Wooden tool box Placement instrument Manual and ratchet

Version

long

Article Number

MB 04K

Contents: M 10-1, M 10-2, M 10-3, M 10-4, M 10-5



Need photo

Wooden tool box Placement instrument Manual and ratchet

Version

short

Article Number

MB 05K

Contents: M 11-1, M 11-2, M 11-3, M 11-4, M 11-5



Need photo

Wooden tool box Processing holder prosthetic

Article Number

MB 05

Contents: Processing holder prosthetic M 04 and Allen key



Need photo

Compartment box Abutments and scanbodies

- 30 compartments
- Polystyrene

Version

without contents

Article Number

MB 04



Need photo



Medentika is distributed by:

Instradent USA, Inc.
60 Minuteman Road
Andover, MA 01810

Phone: 855-412-8883
Fax: 885-412-8884
info.us@instradent.com
www.instradent.us

»» Passion for
Precision ««

 **MEDENTIKA**[®]
A Straumann Group Brand



www.medentika.us 855-412-8883 toll free

DISTRIBUTED BY
 **INSTRADENT**

Products indicated with ® are registered brand names of respective manufacturers.