

Anatomical Abutment

BUCCAL CEMENTABLE AREA: 6 mm

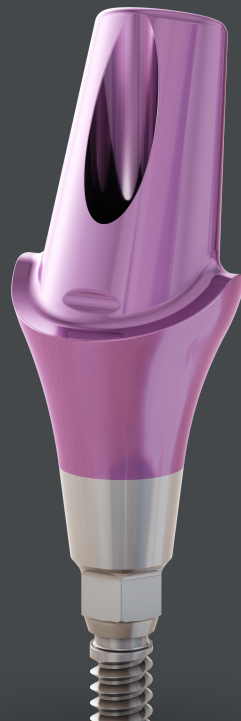

GM ANATOMICAL ABUTMENT



GM ANATOMICAL ABUTMENT 17°

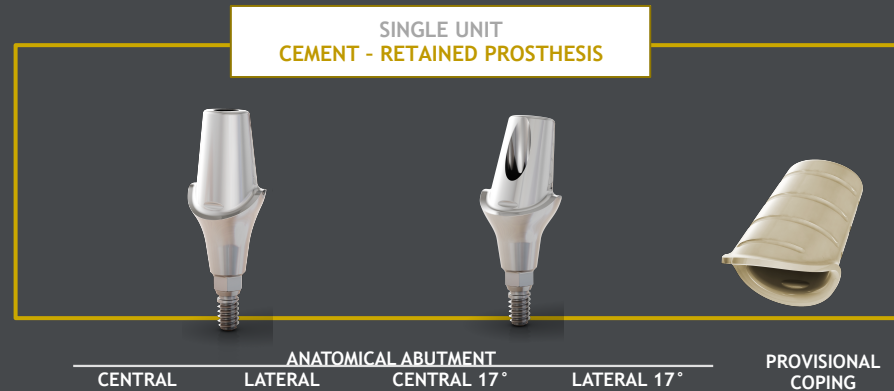

| | |
|---------|---|
| 118.334 | Provisional Coping for Click Anatomic Abutment |
| 118.335 | Provisional Coping for Narrow Click Anatomic Abutment |