

Dimensions in inches

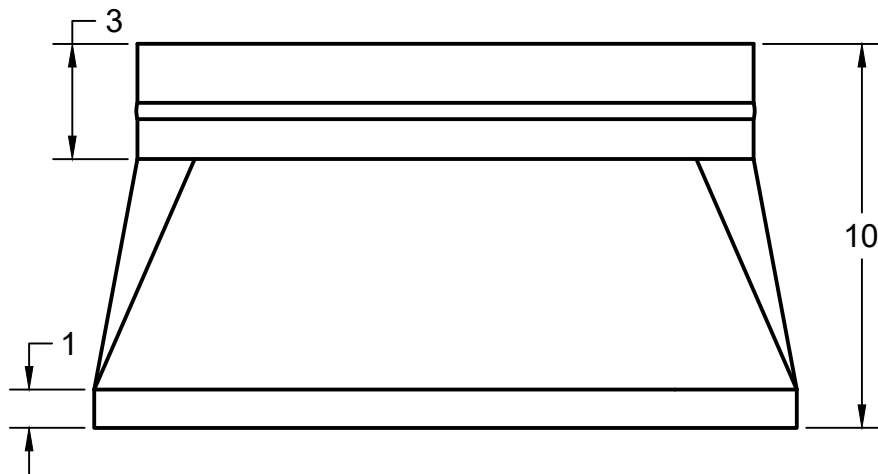
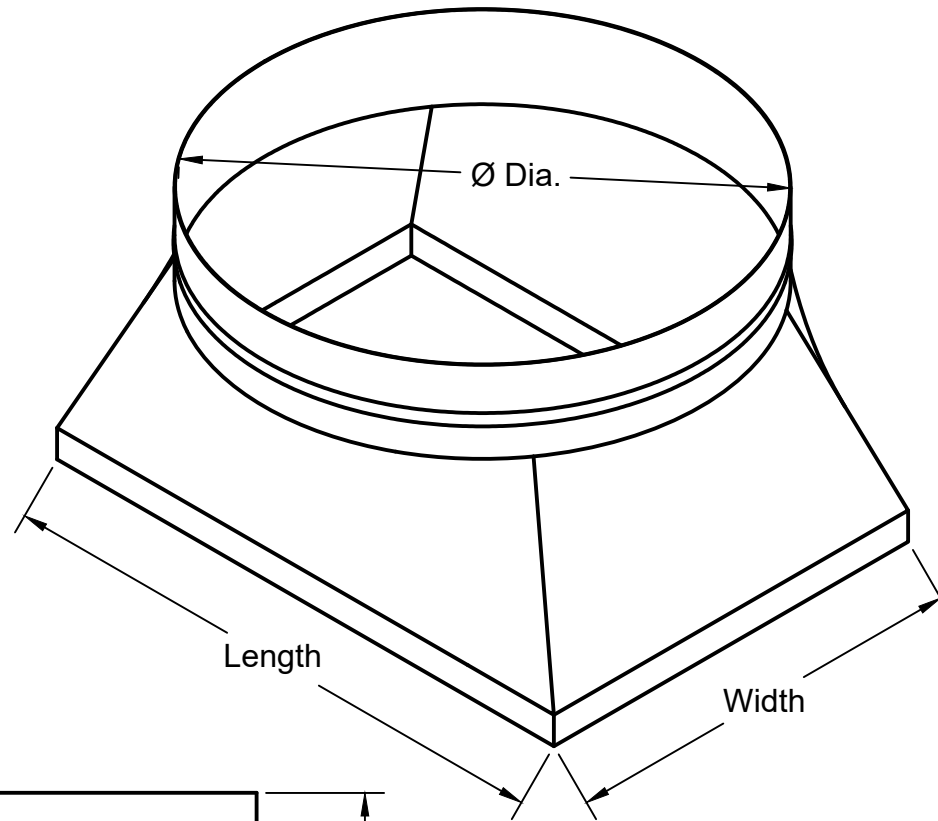

Product:
Tapered Plenum

PRODUCT
DESCRIPTION:

Connects your Flex Duct directly to the AHU eliminating the need for rigid board.

PRODUCT DATA:

Standard Features:

- 26 Gauge G90 Galv. Steel
- 3" Beaded Collar for Duct Connection
- All Plenums 10" High
- Collar Sealed to Body
- Sized to fit your Equipment

THE METAL SHOP

APPROVED	SIZE	REV	SHEET
CHECKED	A		1/1
DRAWN Colton Hunt 11/5/2019	SCALE	N/A	