



MILLER HATCHER COMMERCIAL REAL ESTATE

1511 S. STRATFORD RD. WINSTON-SALEM, NC 27103

FOR SALE

GREAT VISIBILITY

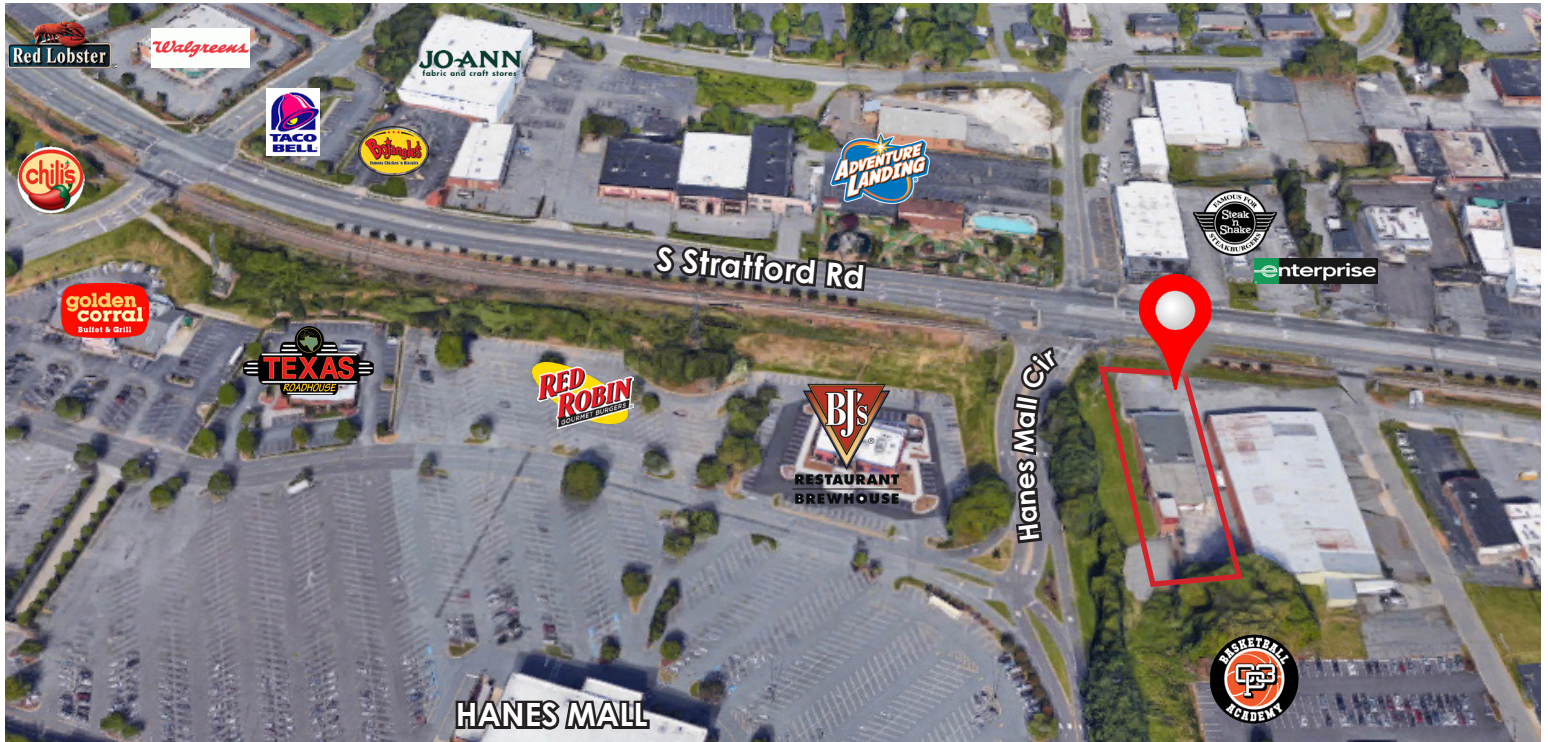

Retail | 17,688 SF

- Approximately .71 Acres
- Zoned GB (General Business)
- Great Visibility
- Great Access
- Wide range of uses allowed

Demographics (2019)

	1 Mile	3 Miles	5 Miles
Total Population:	4,287	65,937	155,537
Average HH Income:	\$52,021	\$82,838	\$79,519

Sales Price: \$1,100,000



PHILIP PRICE

Direct: 336.283.0643 | Mobile: 336.558.7015
Email: Phil@millerhatcher.com

visit us online at
www.millerhatcher.com

MillerHatcherRealEstate

millerhatcherinc

miller_hatcher

MillerHatcherCommercialRealEstate



MILLER HATCHER COMMERCIAL REAL ESTATE

NCDOT Annual Average Daily Traffic (AADT) Mapping Application



Custom Map

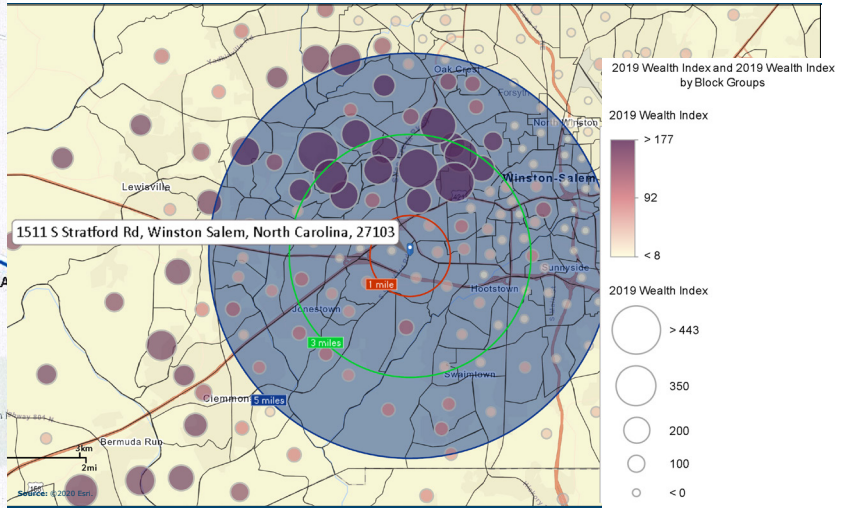
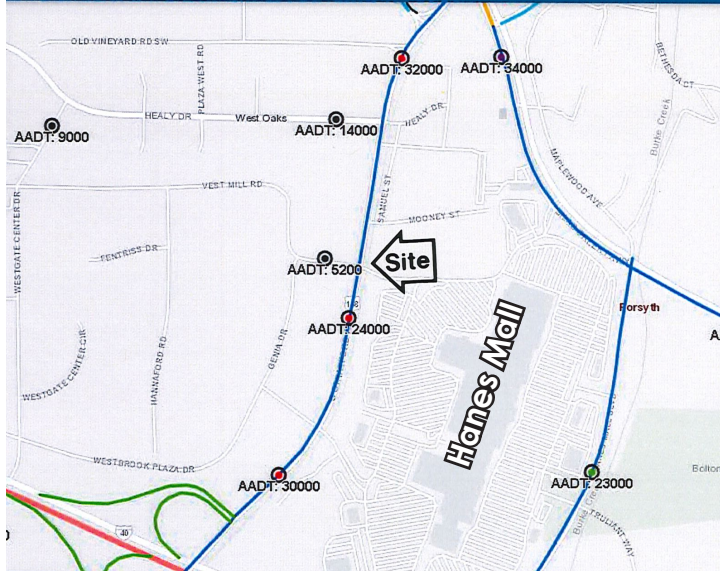

April 26, 2020

PROPERTY DETAILS

Property Type	Retail	Acres ±	.71	Dimensions ±	
Available SqFt ±	17,688	Floors	1	Ceiling Height ±	
Office SqFt ±		Restrooms	2	Parking	
Building SqFt ±	17,688	Flooring	Concrete/Wood	Drive-in's	2
Year Built	1969	Roof	Built up/Metal	Docks	2

UTILITIES

Electrical	Duke Energy	Sewer	City	Water	City
Air	Heat Pump/Forced Air	Heat	Space Heaters	Gas	Natural

TAX INFO

Tax PIN	6814-57-0941	Zoning	GB	County	Forsyth
---------	--------------	--------	----	--------	---------

PRICING

Price	\$1,100,000	Price SqFt ±	\$62.19	Tax Value	\$191,000
-------	-------------	--------------	---------	-----------	-----------

COMMENTS

Former Hauser Rental Building. Located beside entrance to Hanes Mall in Winston-Salem. Direct exposure to Stratford Rd on lighted corner. 17,688 SF building complete with a drive-in basement. Easy access to Greensboro, High Point, Burlington, Hickory and Virginia. High Traffic counts.

No warranty or representation is made for the accuracy or assumptions of the information contained herein. All information is subject to omissions, errors, price changes, prior sale, and/or withdrawal without notice. No liability is assumed for any inaccuracy of the information contained herein.

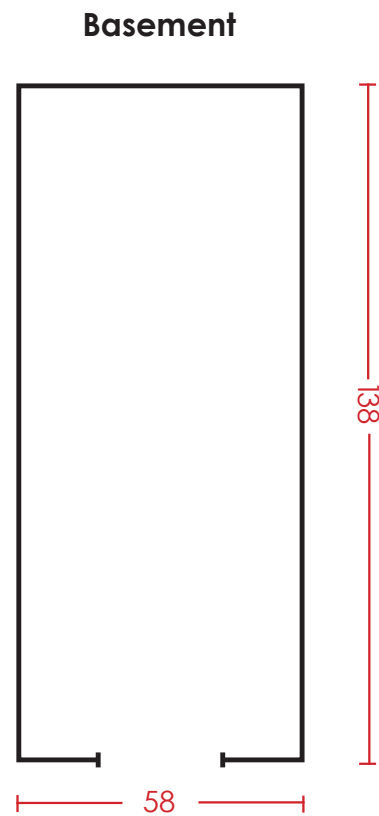
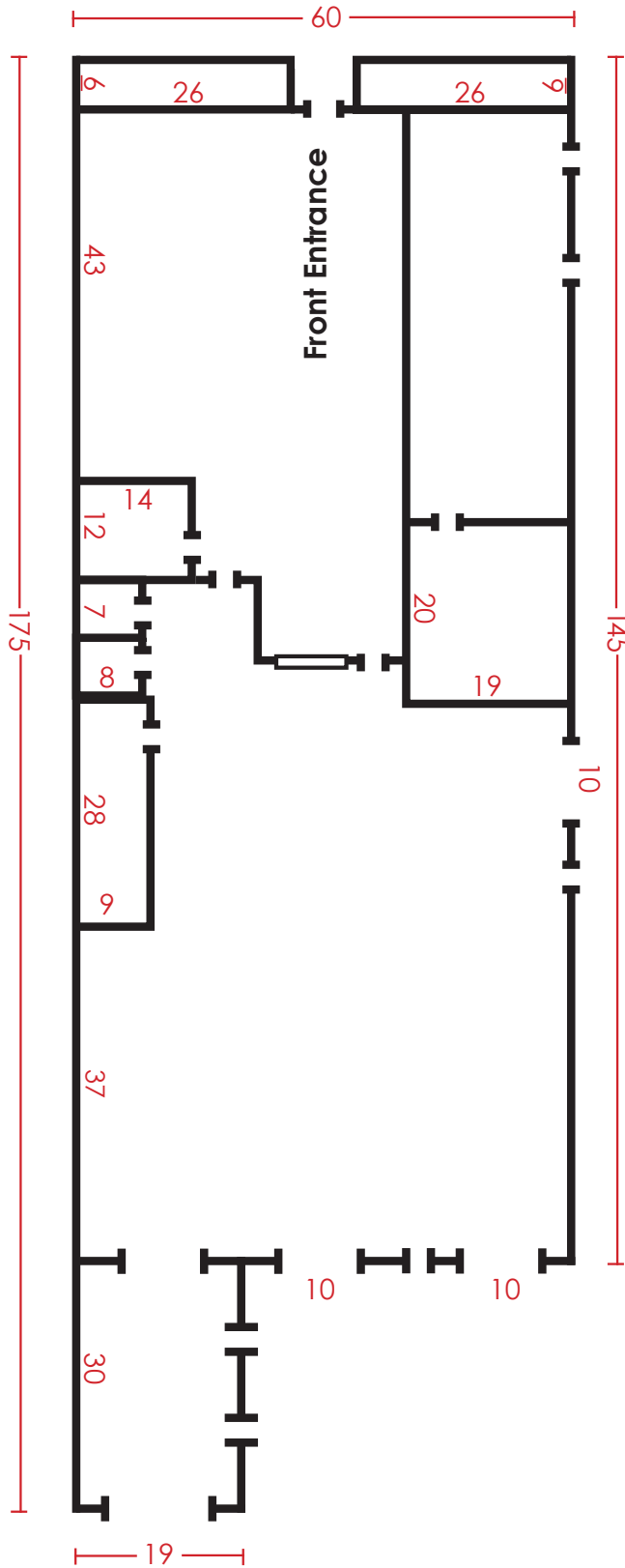

Floorplan - Not to Scale