

HOME FOR LIFE™

1. Entrance

A zero-step entrance OR space for a ramp or vertical platform lift to be installed inside an attached garage (having both is better)

2. Kitchen

A kitchen with a 60” diameter turning circle in the work area.

3. Bathroom

At least one three-piece bathroom somewhere in the home that contains a 60” diameter turning circle by the toilet, a shower space with no threshold, and walls reinforced with plywood. If it is on the second floor of a two-story house, then there must be the option to make it accessible according to the details in #4 (steps and stairs).

4. Door

36” wide doors.

5. Hallways

42” wide hallways.

6. Steps & Stairs

No steps or stairs on the main or upper floors of the home. If there are stairs they must be 40” wide and straight-run. Another option is 5 ft x 5 ft stacking closets that can be converted to an elevator shaft in the future.

7. Bedroom

At least one bedroom on the main or upper floor that has a 60” diameter turning circle on one side of the bed.

8. Powder room

At least one bathroom on the main floor with a 60” diameter turning circle by the toilet and walls reinforced with plywood.

9. Laundry room

A laundry area with a 60” diameter turning circle on the main or upper floor OR an area that has been roughed in so that the laundry area can be moved if required.

Main floor

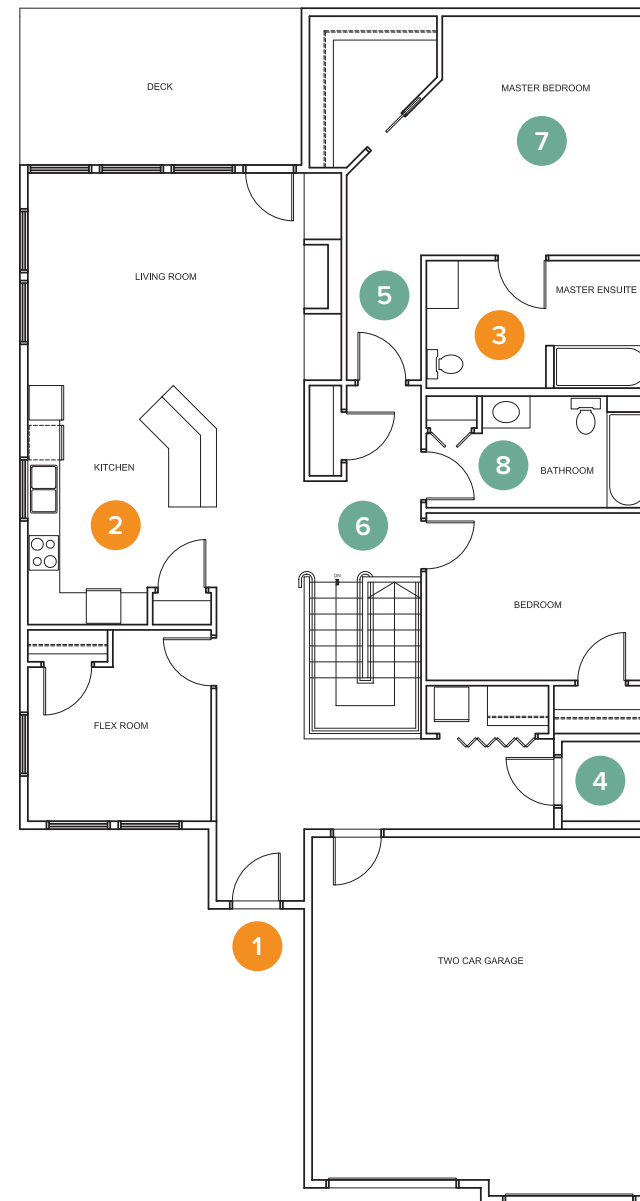

Basement floor

