



TR PLUS

RELIEF PRODUCTS CATALOG

TR PLUS EXPORT



www.trplusexport.com



INTRODUCTION

Our mission at TR PLUS is to provide high-quality, reliable shelter solutions that empower humanitarian and emergency organizations to respond effectively in times of crisis. Through innovation, dedication, and a commitment to excellence, we design and deliver products that offer safety, comfort, and resilience to those in need, wherever and whenever they need it most.

We strive to be a trusted partner for the global aid community, constantly evolving to meet the challenges of a changing world and to support life-saving missions worldwide.



Our Core Values

1. Deliver Excellence: Create reliable, high-quality products that provide safety, comfort, and dignity to individuals affected by crises.
2. Empower Communities: Support humanitarian and emergency organizations with innovative solutions that enable efficient and effective responses.
3. Adapt to Challenges: Continuously evolve to meet the needs of a rapidly changing world and address the complexities of global crises.
4. Build Trust: Establish long-term partnerships with aid organizations by consistently delivering on promises and exceeding expectations.
5. Promote Sustainability: Design and manufacture products with a focus on environmental responsibility and long-term impact.

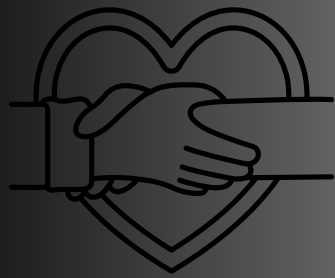
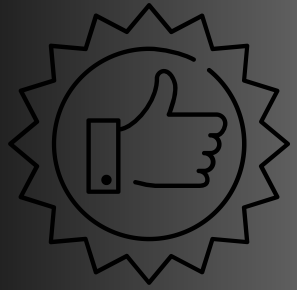

PRODUCTS

DISASTER TENTS

DIMENSIONS

4X4 M

5X4 M

6X4 M



Tent Specifications

TENT DIMENSIONS

MIDDLE HEIGHT 210 cm

SIDE HEIGHT 160 cm

DOOR HEIGHT 200 cm

WIDTH x LENGHT 400 x 600 cm

FLOOR AREA 24 m²

INTERNAL VOLUME 48 m³

OTHER DIMENSIONS & QUANTITY

DIMENSIONS QTY

WINDOW 35x40 cm 4 (Four) EA

DOOR Height 200 cm 1 (One) Zippered

CHIMNEY Ø32 cm 1 (One) EA

MAIN PIPE Ø38 mm 16 (Sixteen) EA

FITTING PIPE Ø32 mm 21 (Twentyone) EA

MATERIAL TECHNICAL SPECIFICATION

MAIN PIPE Ø38mm pipe produced according to TS EN 10219 DX51 standard. The parts forming the main carrier are assembled together with steel apparatus, not plastic.

FITTING PIPE Ø32mm pipe produced according to TS EN 10219 DX51 standard. 7 pipes are used between both main carriers. The distance between two main carriers is 2 meters.

INNER LAYER 70 gr/m² (±10%), UV added, Hydrophobic, Anti-Static, Anti-Bacterial 100% polypropylene fabric

INSULATION 210 gr/m² (±10%), foil coated on both surfaces, single layer ballooned polyethylene material in between

FLOOR Polyethylene (PE) tarpaulin that is not affected by water, moisture and humidity

ALL

TENTS

ARE

FIRE

RESISTANT



OUTTER LAYER

1. Flame Resistance (Flame Resistance) according to EN-ISO 6941 Standard
2. Raw Cloth Weight 180 gr/m² (±10%) according to EN-ISO 2286-2 Standard
3. PVC Coating Weight, 370 gr/m² (±10%) according to EN-ISO 2286-2 Standard
4. Total Weight 550 gr/m² (±10%) according to EN-ISO 2286-2 Standard
5. Thickness at least 0.45mm according to EN-ISO 2286-3 Standard
6. Raw Fabric Type PES High Strength Yarn according to EN-ISO 2076 Standard
7. Yarn Size 1100 dtex according to EN-ISO 2076 Standard
8. Yarn Density (Weft/Warp) 8x8 n°/cm according to EN-ISO 4602 Standard
9. Tensile Strength: 2500 for warp and 2250 N/5cm for weft according to EN-ISO 1421 Standard
10. Tear Strength According to EN-ISO 4674 Standard: 250 N/5cm for warp, 225 N/5cm for weft
11. Dimensional Consistency 1% according to EN-ISO 7771 Standard
12. Resistance to Cold -30°C, Resistance to Heat +70°C according to ISO 4675 Standard
13. Light Fastness 7 (seven) according to EN-ISO 105B-02 Standard
14. Water dimension is 1500 mmSS according to TS 1974 EN-1734 Standard
15. Adhesion Strength 50 N/5cm according to EN-ISO 2411 Standard

PRODUCTS

DISASTER TENTS

DIMENSIONS

4X4 M

6X4 M



Tent Specifications

It is an economical structure consisting of a single row of profiles.

It is a detachable tent structure with a steel frame and a single row of profiles.

Side Height: 1.60m, Middle Height: 2.49m

The outer tarpaulin has 550 (± 50) gr/m² and 650 (± 50) gr/m² PVC tarpaulin options.

It is often used to shelter victims in disaster situations such as earthquakes, floods, fires and wars.

Bizofol has ABA insulation.

Lining: It is a special woven polyethylene lining tarpaulin that is effective in eliminating moisture and odors inside the warehouse tents thanks to its air permeability.

Bizofol: Double-sided foil-coated polyethylene with air bubbles in between, 220 (± 20) g/m² weight, insulation material that balances the internal and external temperature of the tent structure (Bizofol ABA) .

Door options include 1x2 profile framed or zippered doors.

1500 units can be produced and shipped per week.

It is light and easy to install as it consists of single row profiles.

FLOOR Polyethylene (PE) tarpaulin that is not affected by water, moisture and humidity



ALL
TENTS
ARE
FIRE
RESISTANT





AREA
34 Squared meters

PRODUCTS

Prefabricated Emergency Disaster Building





Prefabricated Emergency Disaster Building

Features:

Exceptional Durability: Built with a high-quality steel frame and premium materials, it offers outstanding resistance to severe weather conditions and disasters.

Quick and Easy Assembly: Designed for rapid deployment, it minimizes time delays and is ready for immediate use in emergencies.

Versatile Functionality: This prefabricated structure can serve various needs, such as temporary housing, medical facilities, offices, or storage units.

Elegant Design: Featuring a modern, eco-conscious aesthetic, it harmonizes with the environment while ensuring visual appeal.

Eco-Friendly Solution: Constructed with recyclable materials and optimized for energy efficiency, it provides a sustainable and environmentally responsible choice.

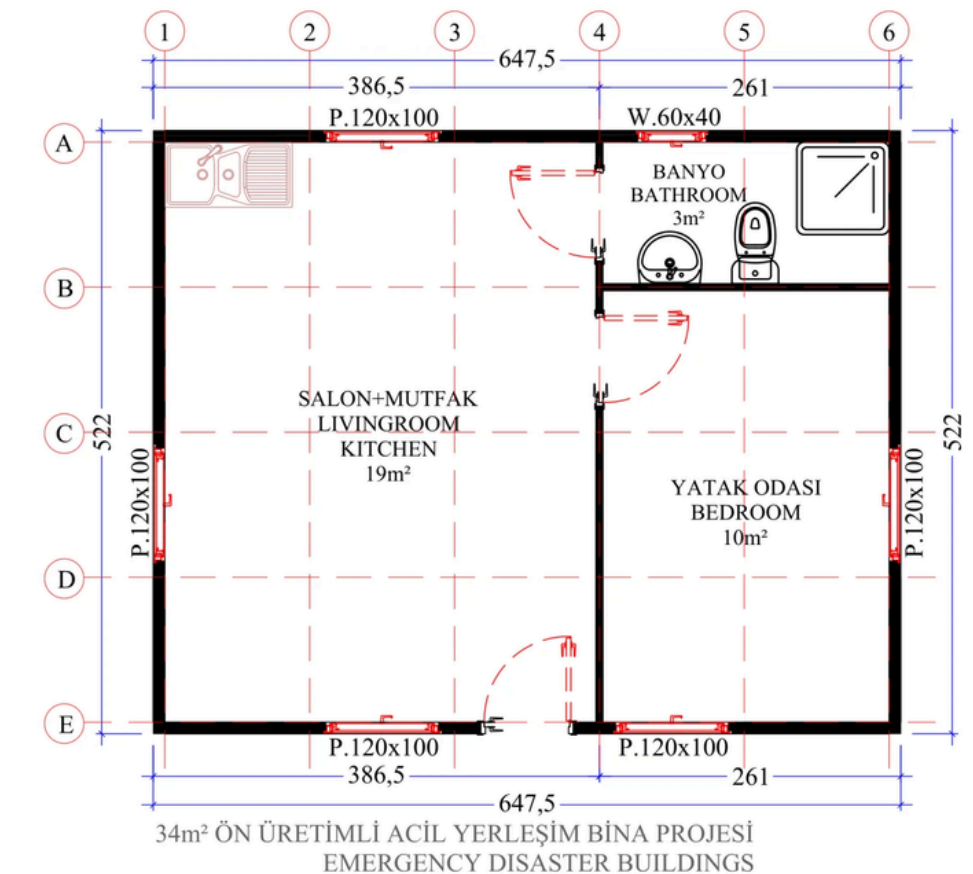



PRODUCTS

SE 200 POWER WHEEL CHAIR

SE 200 POWER WHEEL CHAIR

Chassis	Foldable without battery	Charger	DC24V
Maximum Speed	6 km/h	Charging Time	6-8h
Max. Angle	12°	Motor	24V/250W*2
Max. Distance	15±5km	Joystick	40 A
Carrying Capacity	100-120 kg	Wieght without Bat.	35
Wheel Dimensions	10"(F) 16" (R)	Net Weight	42
Brake	Electromagnetic Brake	Gross Weight	49
Battery	12 Ah Lead Acid	Carton Dimensions	82x41x78 cm





PRODUCTS

SM 112 WHEEL CHAIR

Seat Width	Seat Width	45 cm
Seat Depth,	Seat Depth,	40 cm
Seat Height	Seat Height	50 cm
Backrest Height	Backrest Height	40 cm
Total Width	Total Width	69 cm
Total Height	Total Height	94 cm
Total Length	Total Length	104 cm
Folded Width	Folded Width	29 cm
Armrest Height	Armrest Height	23 cm
Rear Wheel	Rear Wheel	24 " PU Filled
Rear Rim	Rear Rim	Plastic
Front Wheel	Front Wheel	8" Plastic Filled/ Plastic Tong
Armrest	Armrest	Fixed, Sponge Filled Armped
Footrest	Footrest	Fixed / Plastic
Chassis	Chassis	22 mm Steel Chassis / 25 mm Steel Scissors
Weight	Weight	17 kg
Carrying Capacity	Carrying Capacity	120 kg
Carton Dimensions	Carton Dimensions	101x94x34 cm
Loading Pieces	Loading Pieces	75 Pieces 20 DC / 185 Pieces 40 HC /25 Pieces Truck

Extras : Brake, Seat Belt, Calf Tape

Other Options : Anti-tipper / Companion Brake / Cushion / Quick Release / Backrest Folding / 4 mm Steel Front tong / Black Fabtic / colour Option





PRODUCTS

JERRYCANS

Model Number Jerry can CS10L

Capacity 10 Liter (2.5 Gallon)

Expanded Dimensions 17*24*28cm

Folded Dimensions 67*39*44cm (50 pcs*10L)

weight 200g

thickness > 0.3mm

Opening Position Up

Bottle Opening Inner Diameter 3.2cm

Handelfixed

Hot/Cold resisting 85°C/-20°C

Material LDPE





PRODUCTS

TABLEDESK

TABLE DESK SPECIFICATIONS:

A gainst water and rustThe table top is resistant to heat and waterfrom the material werzalitThe most distinctive feature of the wirzaltableis its durable and functional surface.Wirzalite material is formedby combining woodfibers and thermoplastic resins.In addition,the most distinctive feature of thewirzal tableis its durable and functionalsurface.Wirzalite material is formedbycombining wood fibers with thermoplasticresins in addition,this composite material hasa strong structure and is resistant to externalfactors such as influences,temperature andhumidity.At the same time,its surface issmooth,scratch-resistant and easy to clean.This composite material has a strong structureand is resistant to influences,temperature andexternal factors such as moisture.



CONTACT US



00905537027598

www.trplusexport.com

info@trplusexport.com

