

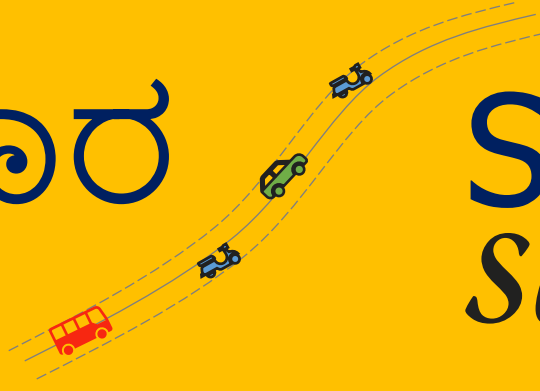

ಸಂಚಾರ ಸುದ್ದಿ

Sanchara Suddi



**BRINGING TO YOU THE LATEST ROAD TRAFFIC NEWS FROM OUR
VERY OWN BENGALURU AND ACROSS THE WORLD**

Fortnightly Newsletter published by SLS Transport Training Institute and Consultancy Pvt Ltd

Excellence in Transportation Consultancy: SLS TTIC Pvt. Ltd.'s Expertise and Services

SLS Transport Training Institute and Consultancy Pvt. Ltd. (SLS TTIC Pvt. Ltd.), a consultancy firm focused on transportation, traffic engineering, and road safety, provides clients with exceptional outcomes through its intelligent, sustainable, and high-value service approach.

Established in 1999, SLS TTIC Pvt. Ltd. boasts a team of expert planners and engineers, headed by Dr. Sanjeeva Kumar B.H, a Ph.D. in Traffic and Road Safety Management.

Dr. Sanjeeva Kumar B H, an entrepreneur with 25 years' experience, has been pivotal in ITMS and Road Safety. As Managing Director of the SLS group, he implemented Bengaluru Central Area TMS and designed the city's Traffic Management Center. His leadership spans traffic initiatives across 2500+ locations in India, covering Local Area Traffic Management Systems, Safe Routes to Schools, and Junction Improvements



We are associated with global organizations such as World Health Organisation, Global Road Safety Partnership and World Bank

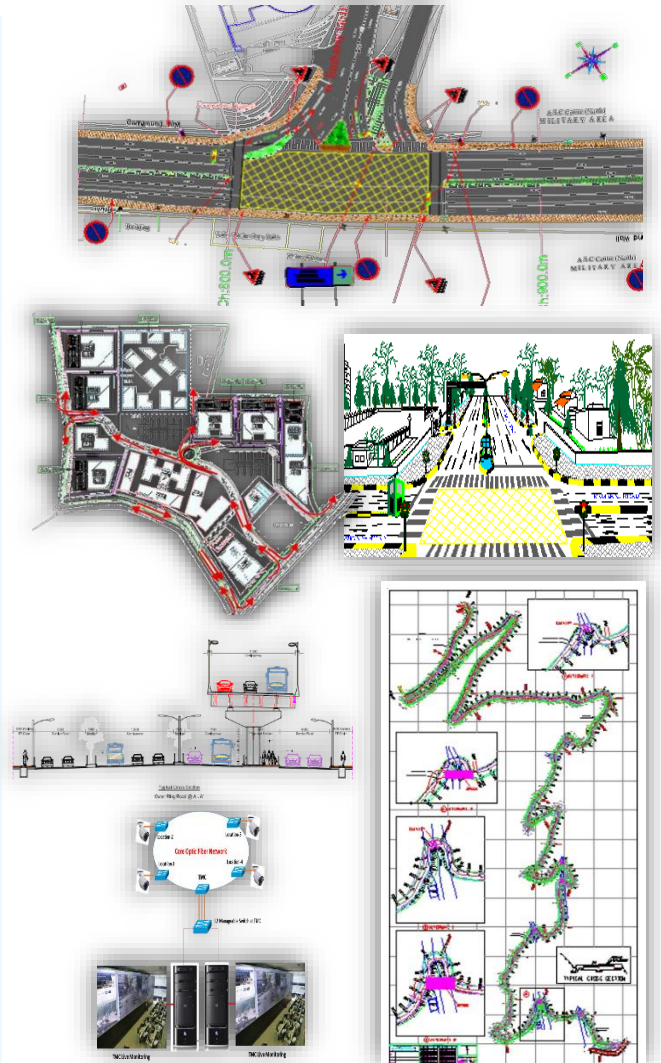

"Insights from the Community: Resident Opinion Survey Shaping Local Traffic Management Strategies"

Conducting a resident opinion survey for a local area traffic management plan is an essential step in understanding the community's perspectives, concerns, and needs regarding traffic issues. In this regard, SLS TTIC on the behest of Bengaluru Traffic Police has taken up the Local Area Traffic Management for Indiranagar and surrounding areas. As a part of this project, resident opinion survey was conducted that aimed to gather valuable insights from residents to enable creating effective and inclusive traffic management strategies that cater to the locality's specific requirements.

Clear and concise questions were crafted on various aspects of traffic management such as traffic congestion, safety, public transportation, pedestrian and cycle movement, parking and the survey was administered through Google forms. More than 375 residents of Indiranagar area filled out the forms and once the data is collected, analysis is crucial. Thoroughly reviewing the responses helps in identifying patterns, common concerns, and priorities among residents. Ultimately, the survey results serve as a cornerstone for the development of a comprehensive local area traffic management plan and we are in the process of developing one for the area. Here are some of the graphical illustrations of the analysis.

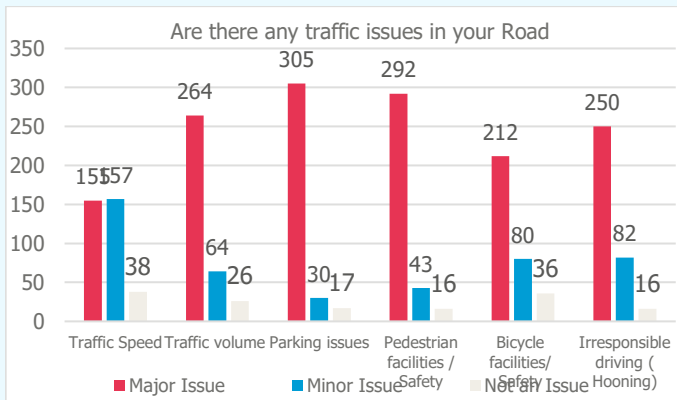
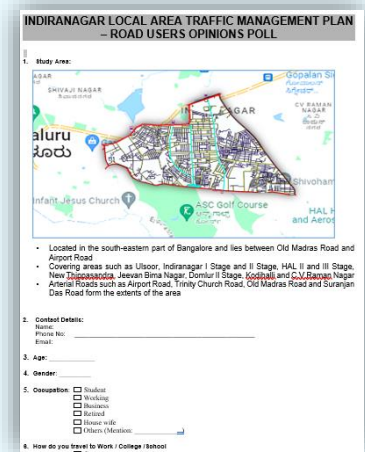

The question on 'Are There Any Traffic Issues in Your Road' provides a clear depiction of the prevalent concerns and issues faced by the surveyed population in their immediate road environment.

Predominantly, the graph highlights pedestrian safety as the most prominent concern among respondents, with 392 people identifying it as a major issue. Following closely behind, parking emerges as a substantial issue, with 305 individuals expressing concerns about it. This signifies a considerable portion of the surveyed population experiencing challenges related to parking availability or regulations in their locality.

Additionally, traffic volume stands out as a major concern, with 264 people highlighting it as a significant issue. This suggests that a substantial portion of the community faces congestion or high traffic flow concerns, impacting the overall mobility and convenience in their area. Speed-related issues, identified by 155 respondents, represent another critical concern. This indicates that a notable portion of the population perceives speeding as a significant safety issue on their roads. Bicycle safety and irresponsible driving, flagged by 212 and 250 individuals respectively, demonstrate additional concerns within the community.

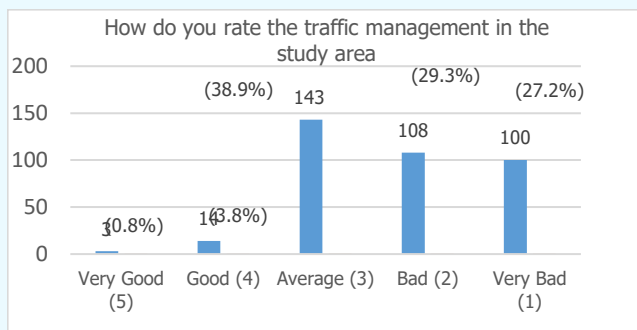

When the Respondents were asked to 'Rate Traffic Management in the Study Area', a significant portion of them perceive the traffic management in the area as neither exceptional nor inadequate but rather as middling or ordinary. Conversely, the 'bad' and 'very bad' categories, collectively comprising 208 votes (108 for 'bad' and 100 for 'very bad'), signify a substantial portion of dissatisfaction within the surveyed population. This suggests that a significant number of residents face notable challenges and frustrations with the current traffic management system.

Traffic Management for Tech Parks - whose responsibility, is it?

Tech parks in Bangalore can significantly contribute to reducing traffic congestion by implementing a comprehensive traffic management strategy. Here are some specific steps that tech parks can take:

- **Promote Flexible Work Arrangements:** Encourage companies to adopt flexible work schedules, such as staggered office hours or telecommuting options. This can help spread out peak traffic patterns and reduce the number of vehicles on the road during rush hour.
- **Implement Carpooling and Ridesharing Programs:** Partner with ridesharing companies to offer discounted rides or incentivize carpooling among employees. Provide designated carpool parking spaces and promote carpooling through internal communication channels.
- **Enhance Public Transportation Access:** Collaborate with public transportation authorities to improve bus or metro connectivity to the tech park. Provide shuttle services between the tech park and nearby public transportation stops.
- **Encourage Non-Motorized Commuting:** Create dedicated cycling lanes and pedestrian walkways within the tech park premises. Provide secure bicycle parking facilities and promote cycling through awareness campaigns.
- **Implement Smart Parking Solutions:** Install intelligent parking systems that guide drivers to available parking spaces, reducing congestion caused by searching for parking. Consider implementing parking fees to discourage unnecessary car usage.
- **Conduct Traffic Impact Assessments:** Before implementing new infrastructure or expanding the tech park, conduct thorough traffic impact assessments to identify potential congestion points and implement mitigation measures. This should be done

To Read More, Visit [drsanjeevakumarbh.blogspot.com](https://www.dr-sanjeevakumarbh.blogspot.com)

Visit: <https://youtu.be/XtO9xGeYXXA>

What's NEWs in Bengaluru?!

^ Congestion tax in Bengaluru

Amid rising traffic problems in Bengaluru, an expert committee along with the Karnataka government has proposed to bring in a congestion tax in the city. A report titled "Karnataka's Decade- Roadmap to a \$1 Trillion Economy" has suggested that a congestion tax should be levied on all non-exempt vehicles entering Bengaluru during peak hours.



The aim behind imposing the congestion tax is to improve travelling times for buses, cars and delivery vehicles. The report stated that revenue collected via congestion tax could be reinvested into improving the city's transport infrastructure. The roads identified for imposing Congestion Tax are Sarjapur Road, Old Airport Road, Old Madras Road, Ballari Road, Bannerghatta Road, Kanakapura Road, Mysore Road, Tumakuru Road, and Hosur Road

However, the BIG questions are,

- **Before implementing congestion tax on roads, several measures should be considered to effectively mitigate congestion that aim to address traffic flow, reduce the number of vehicles on the road, and promote alternative modes of transportation**
- **Should office/home-bound traffic or freight-carrying vehicles be given priority for road space?**



Some Mandatory Signs



STOP



GIVE WAY



ONE WAY



NO ENTRY



ONE WAY



NO ENTRY
BOTH DIRECTION



RIGHT TURN
PROHIBITED



LEFT TURN
PROHIBITED



U TURN
PROHIBITED



OVERTAKING
PROHIBITED



HORNS
PROHIBITED



SPEED LIMIT

To view the video on "Ravana's Heads – A Road Safety Take", please visit https://youtu.be/B_o28E6GIRQ?si=fzdrEMmBp1m3TPzt

Please do visit our webpages by clicking on the following icons!



www.tticblr.com
+91 9611199135

Disclaimer: This fortnightly newsletter, featuring fictional characters, is a work of creative fiction. Any resemblance to real persons, living or deceased, is purely coincidental and unintentional. The contents of this newsletter are prepared by officials of SLS TTIC Pvt. Ltd. and represent their personal views on the subject matter and are protected by copyright law

