



811044

811045

## USE AND CARE GUIDE

---

### 10 FT OFFSET SOLAR UMBRELLA

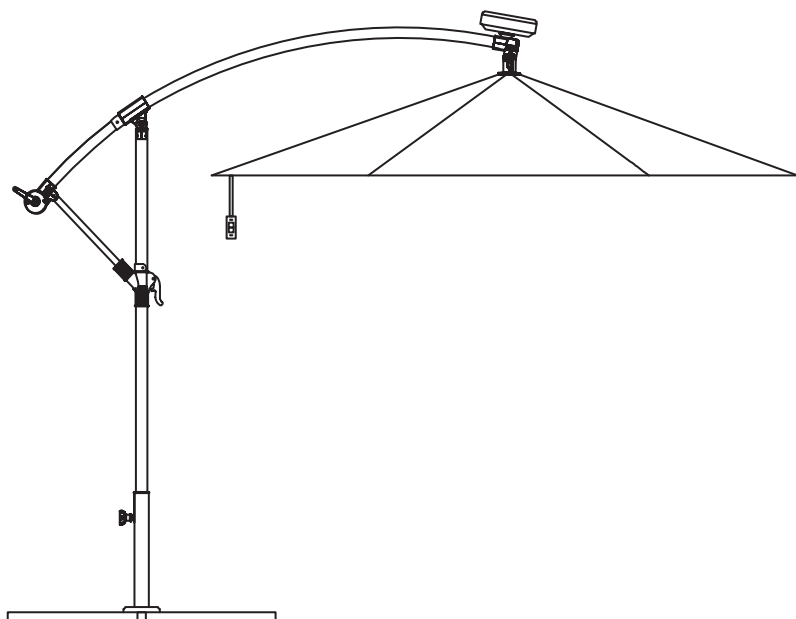

For Manuals, Replacement Parts or Customer Service visit:  
[www.ezreplacement.com](http://www.ezreplacement.com)

---

#### *THANK YOU*

We appreciate the trust and confidence you have placed in SunRay through the purchase of this solar lighted umbrella. We strive to continually create quality products designed to enhance your home. Visit us online at [edenbranch.com](http://edenbranch.com) to see our full line of products available for your home improvement needs. Thank you for choosing SunRay!

# Table of Contents

Table of Contents .....	2
Safety Information .....	2
Warranty .....	2
What is covered .....	2
What is not covered .....	2

Pre-Installation .....	3
Planning Installation .....	3
Assembly .....	4
Operation .....	4
Maintenance .....	6
Care and Cleaning .....	7

## Safety Information

- Always put the umbrella in the down position when not in use.
- Securely fasten the umbrella to an appropriately size umbrella base. Do not install into the ground.
- This seasonal use product is not intended for permanent installation or use.



**DANGER:** Do not use near open flame or other heat sources.



**CAUTION:** Do not use the umbrella in windy conditions. Store the closed umbrella indoors



**CAUTION:** Do not attempt to alter the wiring or operate the umbrella without all LEDs in place



**CAUTION:** Do not use this product for other than its intended purpose.

## BATTERY RECYCLING

Please dispose of used batteries properly. Consult your local telephone listings for a battery recycling center near your area.



Do not dispose batteries in household waste



Do not throw batteries into water



Protect batteries against heat and fire due to risk of explosion



Recycling

## Warranty

### LIMITED WARRANTY

#### WHAT IS COVERED

The manufacturer warrants to the original buyer only, that this product will be free from defects in material and workmanship for a period of one (1) year from date of purchase. The manufacturer's sole obligation and the buyer's exclusive remedy under this limited warranty shall be the repair or replacement of parts, without charge, which are defective in material or workmanship. Any parts as determined by the manufacturer which have been misused; abused or damaged either directly or indirectly from repairs or alterations attempted by unauthorized persons; improper maintenance, neglect or accident are not covered by this limited warranty. This warranty does not apply to damage, heat-induced coloration changes, scratching or alteration due to normal use or weathering. To make a claim under this Limited Warranty, you must return the complete product with proof of purchase, transportation prepaid, to any authorized service center. Contact the Customer Service Team [www.ezreplacement.com](http://www.ezreplacement.com).

#### WHAT IS NOT COVERED

This limited warranty does not apply to accessory or consumable items including batteries related to this product. All implied warranties shall be limited in duration to one year from date of purchase. In no event shall the manufacturer be liable for any incidental or consequential damage, including but not limited to liability for loss of profits, arising from the sale or use of this product. If any provision of this Limited Warranty is for any reason held to be invalid or unenforceable, such provision shall not affect any other provision herein, this Limited Warranty shall be construed as if such invalid and/or unenforceable provision had never been contained herein.

PLANNING INSTALLATION

Carefully remove the contents from the package. If any parts are missing do not attempt to use the product until they have been obtained and correctly installed. If you have any problems or questions concerning this product, do not return to your retailer. Contact the Customer Service Team at [ezreplacement.com](http://ezreplacement.com)

PACKAGE CONTENTS

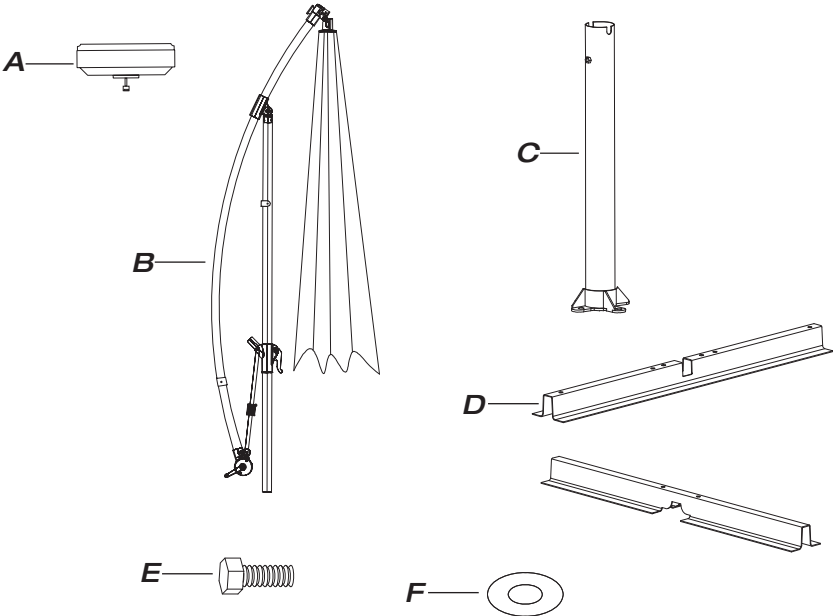

Part	Description	Quantity
A	Solar panel/battery compartment	1
B	Solar umbrella assembly	1
C	Umbrella Pole	1
D	Lower & Upper Bracket	1 SET
E	M8X15MM BOLTS	4
F	FLAT WASHER	4

## 1 Attaching the solar panel

- Position the solar panel (A) on top of the umbrella (B).
- Insert the connector plug (1) attached to the umbrella into the receptacle located on the back of the solar panel (A).
- Insert the solar panel stem (2) into the top of the umbrella. Turn the solar panel (A) clockwise to lock and secure.

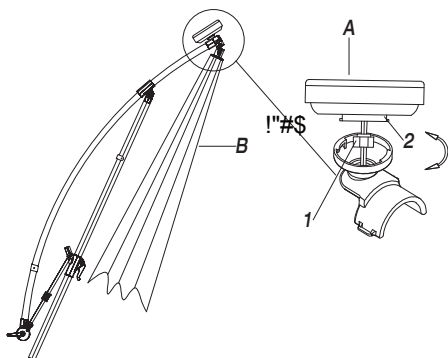

## 2 Attaching the umbrella to the umbrella pole

- Place Upper Bracket onto Lower Bracket as shown. (See Figure 1)
- Line up the bolt holes on the Umbrella Pole (C) with the corresponding bolt holes on the two brackets. Screw the M8X15MM Bolts (E) with Flat Washers (F) into Umbrella Pole. (See Figure 2)
- Place umbrella upright in a heavy weighted stand (not included), and table capable of firmly securing the umbrella.

Figure 1

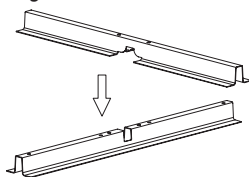
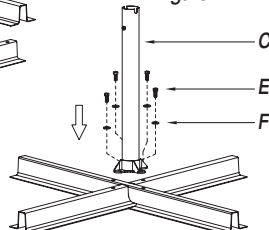
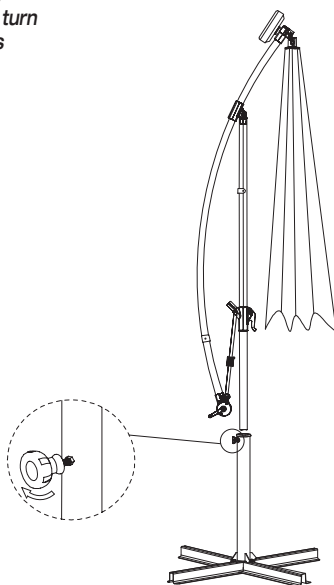

Figure 2



## 3 Inserting the umbrella assembly into lower umbrella pole

- Insert the stem of the Solar Umbrella Assembly (B) into Umbrella Pole (C), turn screw in knob clockwise until tight as shown.



# Operation

## 1 Turning on the solar lights

- Once the batteries are fully charged, press the ON/OFF switch to turn LED lights on and off.

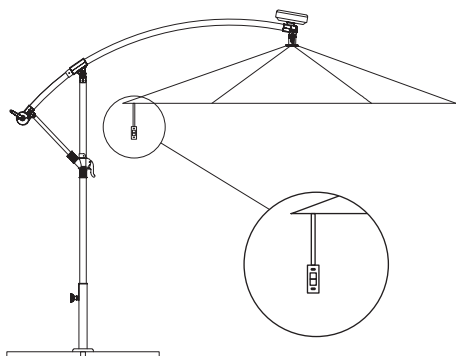

## 2 Adjusting Umbrella Position

- Open the lever (1) and slide up or down to desired position. Close lever to lock into position.

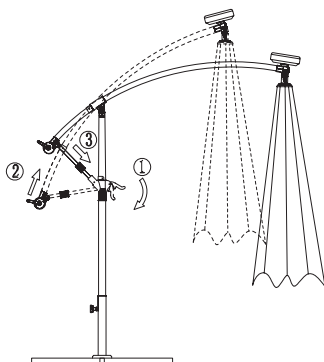

## 3 Opening Umbrella Canopy

- Turn crank (1) clockwise to open umbrella canopy.

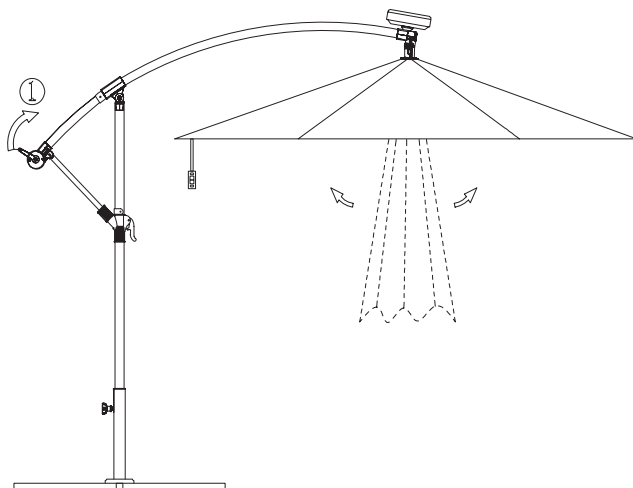

## 1 Replacing the batteries

- ☐ We recommend replacing rechargeable batteries once a year.
- ☐ Lower the solar umbrella, and place it on a flat non-abrasive surface.
- ☐ Remove the solar panel (A) from the top of the umbrella, turn counter-clockwise to unlock and separate.
- ☐ Carefully unplug the connector plug (2) from the solar panel receptacle.
- ☐ Remove both battery compartment covers.
- ☐ Remove and replace old batteries with new rechargeable batteries of the same rating.
- ☐ Install batteries in proper direction, referencing polarity (+/-) markings for correct placement and replace the compartment covers.
- ☐ Insert the umbrella connector plug (2) into receptacle located on the bottom of the battery compartment.
- ☐ Insert the solar panel back into the top of the umbrella.
- ☐ Turn the solar panel clockwise to lock and secure.

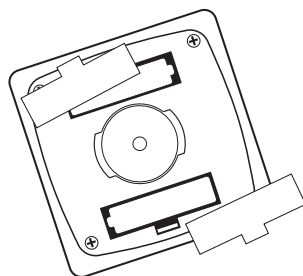
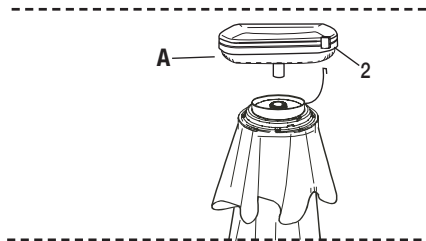

## Care and Cleaning

---

- *Gently clean the solar panel and LEDs with a soft cloth. Do not use abrasives or chemicals to clean the solar panel. Remove dust and debris using a soft cloth or duster.*
- *Rinse the umbrella with clear, clean water. If necessary, use a gentle fabric cleaner, rated safe for polyester fabrics.*

## Limited Warranty

J & J Global (Seller) warrants to the original Buyer only, that each product will be free from defects in material and workmanship for a period of one (1) year from date of purchase. SELLER'S SOLE OBLIGATION AND BUYER'S EXCLUSIVE REMEDY UNDER THIS LIMITED WARRANTY SHALL BE THE REPAIR OR REPLACEMENT OF PARTS, WITHOUT CHARGE, WHICH ARE DEFECTIVE IN MATERIAL OR WORKMANSHIP. ANY PARTS AS DETERMINED BY THE SELLER WHICH HAVE BEEN MISUSED; ABUSED OR DAMAGED EITHER DIRECTLY OR INDIRECTLY FROM REPAIRS OR ALTERATIONS ATTEMPTED BY UNAUTHORIZED PERSON; IMPROPER MAINTENANCE, NEGLIGENCE OR ACCIDENT ARE NOT COVERED BY THIS LIMITED WARRANTY. This warranty does not apply to damage, heat-induced coloration changes, scratching or alteration due to normal use or weathering. To make a claim under this Limited Warranty, email [contact@ezreplacement.com](mailto:contact@ezreplacement.com) or visit [www.ezreplacement.com](http://www.ezreplacement.com) for warranty questions and claims.

### Additional Limitations

THIS LIMITED WARRANTY DOES NOT APPLY TO ACCESSORY OR CONSUMABLE ITEMS RELATED TO THIS PRODUCT. ALL IMPLIED WARRANTIES SHALL BE LIMITED IN DURATION TO ONE (1) YEAR FROM DATE OF PURCHASE. IN NO EVENT SHALL SELLER BE LIABLE FOR ANY INCIDENTAL OR CONSEQUENTIAL DAMAGES, INCLUDING BUT NOT LIMITED TO LIABILITY FOR LOSS OF PROFITS, ARISING FROM THE SALE OR USE OF THIS PRODUCT.

If any provision of this Limited Warranty is for any reason held to be invalid or unenforceable, such provision shall not affect any other provision herein, this Limited Warranty shall be construed as if such invalid and/or unenforceable provision had never been contained herein.

This warranty gives you special legal rights, and you may also have other rights which vary from state to state. This warranty contains the entire agreement between Seller and Buyer and supercedes any and all prior agreements, arrangements, or understandings between the parties relating to product warranty.

U.S. Patents No.: 6,612,713; 7,753,546; 8,069,868; 8,375,966; 8,727,555; 8,794,781

Due to ongoing product development  
the actual product or products may vary from the  
illustrations or photos shown within this manual.

**For Manuals, Replacement Parts or Customer Service visit:**  
**[www.ezreplacement.com](http://www.ezreplacement.com)**

**NOTE:** This product is intended for residential, non-commercial use.

### **WARNING**

This product can expose you to lead, a chemical known to the state of California to cause cancer, birth defects and/or other reproductive harm.  
For more information go to [www.p65warnings.ca.gov/product](http://www.p65warnings.ca.gov/product)

**Made In China**  
©2018 J&J Global, LLC  
Distributed by:  
J&J Global, LLC  
Carrollton, TX 75006