

FERGUSON

Bath, Kitchen & Lighting Gallery

Specifications for Project

FL CONDO

GABI LLC

Salesperson

LES MILTON

LES.MILTON@FERGUSON.COM

13176896714

Indianapolis



REMINDER:

To ensure a smooth project it is the responsibility of the homeowner / purchaser of appliances for this project to share all the attached specifications to ensure the cabinet provider, contractor, or any other tradesperson have all the information required to complete their work accurately.

Specifications are subject to change. If any tradesperson has questions regarding the attached specifications please contact our sales associate.

FL CONDO

GABI LLC

DBA J GREG ALLEN HOMES
997 E COUNTY LINE RD SUITE G
PO BOX 1435
GREENWOOD, IN 46142



Contents	Page no.
CI365PTX4 Fisher & Paykel Cooktop 36" Series 7 Induction Cooktop	4
OB30SD17PLX1 Fisher & Paykel Wall Oven 30" Series 7 Contemporary Self-Cleaning Oven	5
DD24DTX6HI1 Fisher & Paykel Dishwasher Series 11 Integrated Tall Double DishDrawer™ Dishwasher With Water Softener	6-7
RS2484SRHK1 Fisher & Paykel Refrigeration 24" Series 11 Integrated Column Refrigerator with Water (RH)	8
RS2484FRJK1 Fisher & Paykel Refrigeration 24" Series 11 Integrated Column Freezer with Ice (RH)	9

Ferguson
build.com

LES MILTON
Sales Consultant
13176896714

Bid No **B129367**
Version 3.3

Wed, Oct 2, 2024
8:50 AM UEDT



enterprise.steelcod.com/sp/ferg/XHXLGU3N

Note about page numbers:
Because the original manufacturer's documents are not altered in any way, the page numbers displayed on the page may not correspond to the page number within this package.

All specifications are intended for initial planning purposes only.
Manufacturers reserve the right to change specifications at any time without notice. Always consult the installation instructions found on the manufacturer's website or included with the appliances before installation.

SCN60GA-1SU	10-11
Scotsman Refrigeration	
60 lb Nugget Ice Machine	

ELTE7600AT	12
Electrolux Washer-Dryer	
Laundry Tower™ Single Unit Front Load 4.5 Cu. Ft. Washer & 8 Cu. Ft. Electric Dryer	

Note about page numbers:
Because the original manufacturer's documents are not altered in any way, the page numbers displayed on the page may not correspond to the page number within this package.

All specifications are intended for initial planning purposes only.
Manufacturers reserve the right to change specifications at any time without notice. Always consult the installation instructions found on the manufacturer's website or included with the appliances before installation.

36" Series 7 5 Zone Induction Cooktop, 2 Smart Zones

Series 7 | Professional

Black Glass

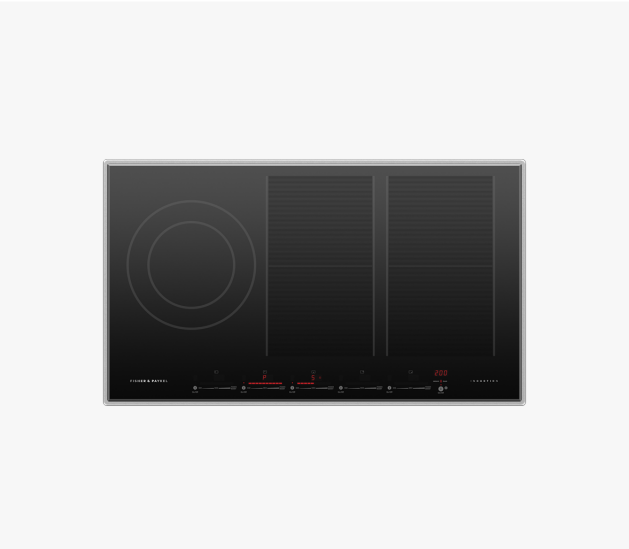

This Series 7 cooktop is a joy to use, with the instant response and energy efficiency of induction technology.

- Immediate heat response and extremely accurate temperature control
- Child and pet safe - cooktop remains cool to touch until a pot or pan is placed on the surface

- PowerBoost activates a very high heat, bringing liquid to boil in less than a minute
- Easily control each cook zone with Touch&Slide, including pairing cook zones to create a large SmartZone

DIMENSIONS

Height	3 7/16 "
Width	35 3/8 "
Depth	21 "

FEATURES & BENEFITS

Complementary Design

The subtle black glass and durable matte black detailing are designed to pair with the Minimal style Series 9 Ovens. With premium styling and detailing, these cooktops seamlessly blend with other appliances for a cohesive, considered kitchen design.

Enhanced Features

PowerBoost and GentleHeat deliver either very high or very low heat, fast. Perfect for specialized cooking tasks such as searing meat and melting chocolate. An integrated timer ensures a great result every time

Instant Response

Go from a boil to a simmer in seconds. Touch&Slide controls react immediately when you adjust the temperature so you don't waste time in the kitchen.

Safer Choice

Induction cooktops only start heating your pot or pan once you've placed it on the ceramic surface and stop as soon as you remove it – so you don't have to worry about curious little fingers or leaving a cook surface on.

Easy Cleaning

The surface around your cookware stays cool when you cook – preventing baked-on spills and making cleaning up a breeze. The ceramic cooktop surface, including anodized detailing for durability, just needs a quick wipe after use to maintain its good looks.

Superior Efficiency

Less heat is wasted during induction cooking because only the cookware is heated, not the cooktop surface. This makes induction cooking more energy-efficient than electric or gas cooktops.

SPECIFICATIONS

Burner ratings

Maximum burner power	Yes
----------------------	-----

Cleaning

Flat easy clean glass surface	•
-------------------------------	---

Controls

Auto cut-off timer for each zone	•
Minute timer	•
Soft-touch electronic controls	•
Touch and slide controls	•

30" Series 7 Contemporary Self-Cleaning Oven, 17 Function

Series 7 | Contemporary

Stainless Steel



With beautiful Contemporary styling and a generous 4.1 cu ft total capacity capacity, this built-in oven helps to ensures that every dish you create is cooked to perfection.

- 4.1 cu ft total capacity with 17 oven functions including Air Fry and Dehydrate
- Even heat circulation with AeroTech™, ideal for multi-shelf cooking

- Pyrolytic self-cleaning function breaks down food residue for an easy clean
- Guided cooking capability offers helpful tips for different food types

DIMENSIONS

Height	27 3/16 "
Width	29 15/16 "
Depth	23 15/16 "

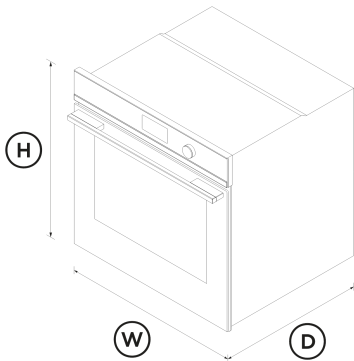

FEATURES & BENEFITS

Multi-Function Flexibility

Each function has been perfected to ensure that no matter what you're cooking, you've got the right heat to match. This built-in oven has 17 functions including Pastry Bake, Roast, Fan Grill, Dehydrate and Rapid Proof, allowing you to use a variety of cooking styles.

Generous Capacity

With an incredible 4.1 cu ft total capacity in each oven, you can create several perfectly cooked dishes at once using multiple shelves.

Cook With Confidence

The intuitive 2.4" screen provides an intuitive guided cooking experience that helps to deliver perfect results, whether you've been cooking all your life or are just starting out. Cook by food type and allow your oven to guide you through steps, or change temperature and heat type automatically, depending on your selection.

Exceptional Performance

AeroTech™ circulates heat evenly for a consistent temperature throughout the cavity, helping you ensure perfect results even when cooking on multiple shelves.

Self-Cleaning

Pyrolytic self-clean breaks down food residue at a very high temperature, leaving a light ash that's easily removed with a damp cloth. The enamel coated side racks don't need to be removed when using this function.

Design Freedom

Designed to fit seamlessly into your kitchen, this built-in oven features premium materials and detailing to support a cohesive, considered kitchen design.

Safe And Sound

The CoolTouch door features triple glazing and a cooling system that ensures it's safe to touch from the outside - protecting both your hands and the surrounding cabinetry.

Series 11, Integrated Tall Double DishDrawer Dishwasher

Series 11 | Integrated

Panel Ready



<p>Integrates seamlessly into kitchen cabinetry. Each drawer features a premium stainless steel interior and operates independently, for flexible washing.</p>

- Eight wash cycles from Heavy to Light, including Auto, 60min and Glassware
- Tall top drawer fits full-size dinner plates up to 12 1/4 inches, with flexible racking for large cookware

- With soft-close drawers, and knock to pause convenience
- Wi-Fi capability and a SmartHQ™ app for remote control and notifications

DIMENSIONS

Height	34 - 36 3/8 "
Width	23 9/16 "
Depth	21 3/4 "

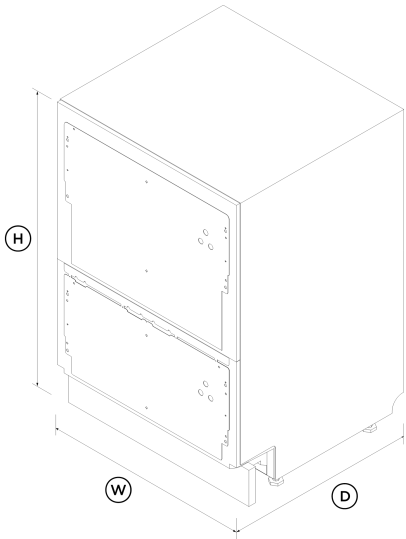

FEATURES & BENEFITS

Seamless Integration

Install your DishDrawer™ Dishwasher into an existing kitchen space or integrate into kitchen cabinetry. The touch-sensitive control panel is located inside this Integrated model, leaving an uninterrupted exterior that blends seamlessly with surrounding cabinetry.

Ease Of Use

DishDrawer™ Dishwashers are beautiful to use with soft-close drawers. The tall top drawer fits your larger plates and dishes up to 12 1/4 inches, while the bottom drawer is ideal for small washes. Flexible racking includes height-adjustable cup racks and wine glass supports.

True Half Load

Both drawers fit a true half load. Each drawer operates independently, so you can wash one load while stacking the other drawer, or wash simultaneously on separate cycles.

Flexible Wash Options

Eight wash programs including Auto, 60min and Glassware, while modifiers such as Sanitize, Dry+ and Quiet provide added wash flexibility. The Quiet wash modifier reduces the noise on some cycles while maintaining performance – perfect for late night washing.

Design Quality

Every detail has been carefully crafted using quality materials, from the easy-to-clean stainless steel interior to the spray arm sensor that detects jams for increased wash confidence.

Knock To Pause

For ease-of-use, these DishDrawer™ Dishwashers have a knock to pause function. A knock on the front panel will pause the dishwasher, which can be restarted by using the start button.

Quiet Performer

PRODUCT DIMENSIONS

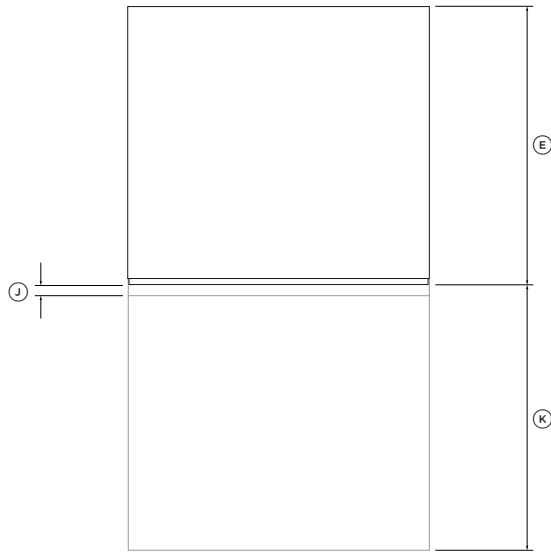

PLAN

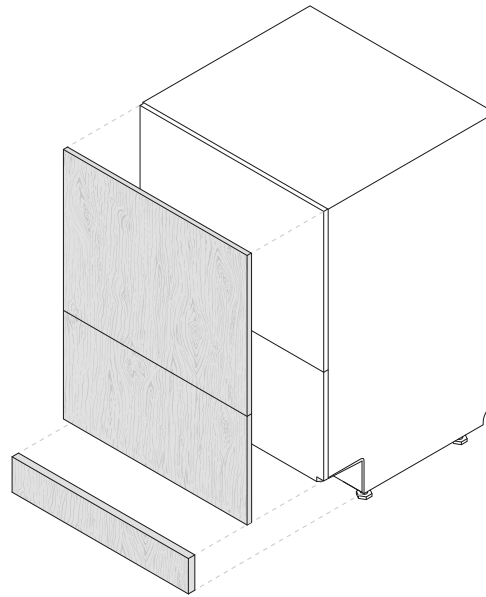

ISOMETRIC

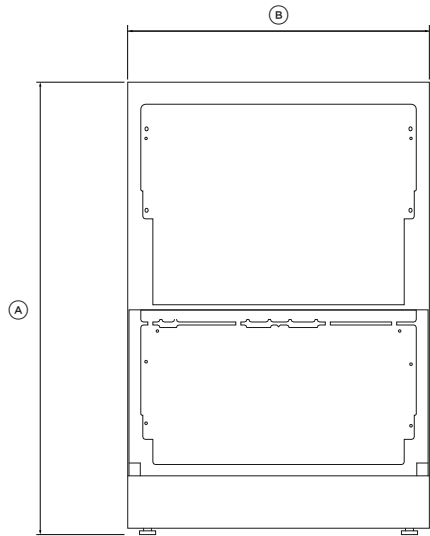

FRONT

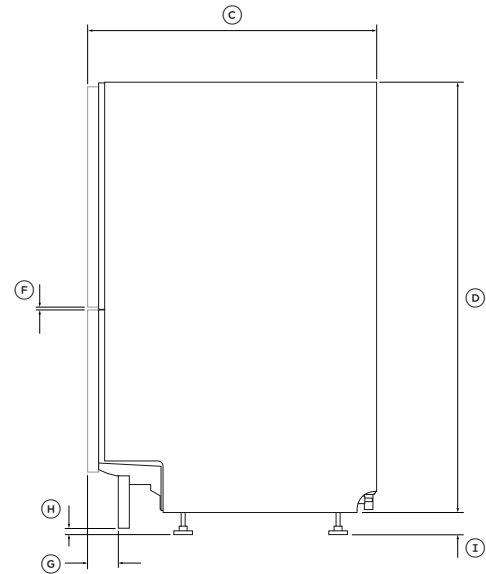

PROFILE

PRODUCT DIMENSIONS	INCHES	MM
(A) Overall height*	34-36 3/8	864-924
(B) Overall width**	23 9/16	599
(C) Overall depth***	22 1/2	571
(D) Height of chassis	33 11/16	855
(E) Depth of chassis	21 3/4	553
(F) Ventilation gap between door panels	5/16	8
(G) Depth of toe kick recess**		
Custom panel installation	1 9/16 - 3 15/16	40-100
Pre-finished panel installation	2 5/16 - 4 5/8	58-118
(H) Minimum clearance between toe kick panel and floor	1/2	12
(I) Height of feet*	3/8 - 2 3/4	10-70
(J) Door panel depth****	5/8 - 13/16	16-20
(K) Depth of drawer opening**	20 3/4	527

*depending on adjustment of levelling feet

**excluding custom panel and handle

***based on front panel thickness of 11/16" (18mm)

****refer to 'Custom panel dimensions' for more information

Actual product dimensions may vary by $\pm 1/16"$ (2mm)

24" Series 11 Integrated Column Refrigerator, Water

Series 11 | Integrated

Panel Ready | Right Hinge



Install it separately or pair with another Column for seamless integration - this model is right hinge with stainless steel interior.

- ActiveSmart™ technology helps keep food fresher for longer by constantly maintaining the ideal temperature
- Two separate Variable Temperature Zones. Choose from Fridge, Pantry or Chill
- Internal water dispenser for convenient access to fresh, chilled water

- Customize with your own kitchen cabinetry or purchase our stainless steel door panel accessory

DIMENSIONS

Height	84 "
Width	23 3/4 "
Depth	24 "

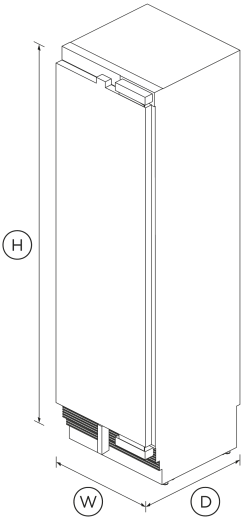

FEATURES & BENEFITS

Variable Temperature Zones

Create the perfect climate by storing food at their optimal temperature. Change a compartment to Fridge, Pantry or Chill.

Internal Water Dispenser

This integrated model features a slimline water dispenser, located on the inside for an uninterrupted exterior. The flush-fit design of the water dispenser maximizes internal storage space, allowing the shelves to be adjusted to suit your needs. Enjoy a continuous flow of temperature-controlled chilled water to fill almost any size or shape of vessel.

Appealing Illumination

Bright LEDs light up the ceiling, shelves, bins and trays in both refrigerator and freezer, creating a welcoming glow in your kitchen at night and using less power than comparable halogen lights.

Mix & Match

Integrated Column Refrigeration gives you the freedom to mix and match refrigerators and freezers based on your needs - or install separately. They can be customized with your kitchen cabinetry for a seamless look, or finished with one of our stainless steel door panels.

Clever Energy

ActiveSmart™ makes your refrigerator more energy efficient - adapting to daily use and cooling and defrosting only when needed. This means it uses the energy it needs without compromising on food care.

Design Quality

The premium design and quality finish includes a white or stainless steel interior lining, as well as full-extension metal shelf runners for easy access and robust glass shelving.

Perfect Fit

Create an understated and clean look in any kitchen. You can hide our Integrated Column models seamlessly behind your cabinetry, fitting flush with only a 1/8" gap and no visible hinges or grilles.

SPECIFICATIONS

24" Series 11 Integrated Column Freezer, Ice

Series 11 | Integrated

Panel Ready | Right Hinge



<p>Install it separately or pair with another Column for seamless integration - this model is right hinge with stainless steel interior.</p>

- ActiveSmart™ technology helps keep food fresher for longer by constantly maintaining the ideal temperature
- Two separate Variable Temperature Zones: each with Freeze, Soft Freeze or Deep Freeze
- Internal ice maker with boost for busy times

- Customize with your own kitchen cabinetry or purchase our stainless steel door panel accessory

DIMENSIONS

Height	84 "
Width	23 3/4 "
Depth	24 "

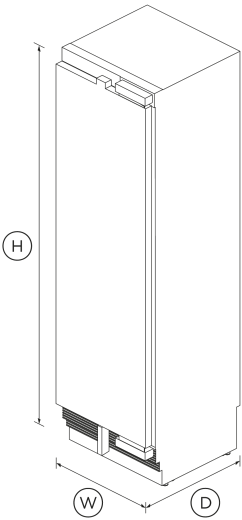

FEATURES & BENEFITS

Variable Temperature Zones

Food is stored in two separate zones. You have the choice of three food modes: Freeze -7°F to 7°F, Soft Freeze 14°F to 18°F and Deep Freeze is fixed at -13°F.

Mix & Match

Integrated Column Refrigeration gives you the freedom to mix and match. Different sized Column Fridges and Freezers can be installed separately or paired. Finish them with our stainless steel door panels or customize to match your own kitchen cabinetry.

Clever Energy

Our Energy Star certified ActiveSmart™ Foodcare Fridges & Freezers adapt to daily use by cooling and defrosting only when needed. This means your refrigerator uses the energy it needs without compromising on food care.

Appealing Illumination

Bright LEDs light up the ceiling, shelves, bins and tray in both refrigerator and freezer, making it easy to find your food and creating a welcoming glow in your kitchen for those midnight snacks.

Design Quality

The premium design and quality finish includes a steel interior lining as well as full extension metal shelf runners for easy access and robust glass shelving.

Easy Install

Integrated Column Refrigerators and Freezers have been developed to make their installation easy. The joiner kit is included when pairing refrigerator and freezers. All models come with front adjustable levelling feet and they've been designed to easily slide into place as separate units.

Perfect Fit

These models fit flush and have only 1/8" gaps around them with no visible hinges or grilles. Our Integrated Column models can be seamlessly hidden behind your cabinetry or you can purchase our stainless steel door panel.

SPECIFICATIONS

Accessories (included)

SCN60 – 60 lb Nugget Ice Machine

Brilliance® Under-Counter Nugget Ice Machine



model shown is SCN60PA-1SS

Features

- 15" cabinet width, produces up to 80 lbs. of nugget ice in 24 hours
- Uses 40% less energy and more than 50% less water than dedicated cube ice machines
- **Accepts custom wood panel to match surrounding cabinetry**
- Approved for indoor or outdoor use
- Lighted bin
- Concealed hinge system
- User-friendly control panel informs whether power is on, alerts a no-water condition, and a time to clean reminder
- Available with built-in drain pump
- Field reversible door
- **Protected with AgION®, a silver-based antimicrobial compound molded into key ice machine components in order to guard internal surfaces between cleanings.**

24 Hour Ice Production & Storage Capacity

70°F/21°C Air 50°F/10°C Water lb / kg	90°F/32°C Air 70°F/21°C Water lb / kg	Bin Storage Capacity lb / kg
85 / 39	60 / 27	26 / 12

Control Board



Scoop



Nugget Ice



The Original Chewable Ice™.
Soft ice ideal for beverages
and blended drinks.

Warranty

- 2 years parts and labor on all components.
- 5 years parts on the compressor only.

Warranty valid in North America.



Instructions: Custom Panel for models SCC30, SCC50 and SCN60

A custom panel of wood or other material not exceeding 15 lb can be attached to the door. Attachment is from the ice side of the door. Holes are provided in the door for this purpose.

To create and attach a custom panel:

- Panel width: 14 7/8"
 - Panel height: Between 29 3/8" and 30 3/8".
 - Panel thickness: 5/8" to 3/4"
1. Measure overall height of cabinet opening where ice machine will be (floor to bottom of countertop edge).
 2. Determine desired kickplate space (from bottom of door to floor). This could be equal to the adjacent cabinet's kickplate space or another space the user wants.
 3. Subtract kickplate space from cabinet opening.
 4. Subtract 1/8 or more for clearance space between top of door and bottom of countertop edge from cabinet opening. This is the maximum door length.
 5. Cut panel to width.
 6. Cut panel to length (cabinet space - kickplate space - top clearance = length).
 7. Determine top of panel.
 8. Mark hole locations using drawing on the back of these instructions. Drawing assumes top of panel will be flush with top of door. Measure hole locations from the top of the panel.
 9. Drill pilot holes for wood screws. Use drill stop to prevent drilling through the panel.
 10. Mount panel to door using wood screws or supplied panel mounting screws.

Note: When installed Ice machine must be adjusted for height to position top of door to desired clearance.



Laundry Tower Single Unit Front Load 4.5 Cu. Ft. Washer & 8 Cu. Ft. Electric Dryer

Laundry Tower

Available Products: ELTE7600AT, ELTE7600AW

Available Colors: Titanium, White

Version: 06/24

Product Specifications

Washer

Drum Light	Yes
Drum Material	Stainless Steel
Maximum Spin Speed	1300 RPM
Water Heater	Yes

Washer Options

Allergen	Yes
Delay Start Time	1-12 Hours
Perfect Steam	Yes
Pure Rinse	Yes
Stain Soak	Yes

Washer Spin Speeds

Spin Speed Selections	4
Max	Yes
Medium	Yes
Low	Yes
No Spin	Yes

Temperature Settings

Eco Cold	Yes
Warm	Yes
Hot	Yes
Sanitize	Yes

Dispenser

Bleach Dispenser	Yes
Detergent Dispenser	Yes
Fabric Softener Dispenser	Yes
Prewash Detergent Dispenser	Yes
PODs Dispenser	Yes

Dryer Cycles

Cycle Count	8
Activewear	Yes
Allergen	Yes
Delicates	Yes
Fast Dry	Yes
Heavy Duty	Yes
Instant Refresh	Yes
Normal	Yes
Timed Dry Time	Yes

Washer Cycles

Cycle Count	8
Activewear	Yes
Clean Washer	Yes
Delicates	Yes
Fast Wash	Yes
Heavy Duty	Yes
Normal	Yes
Optic Whites	Yes
Rinse and Spin	Yes

Soil Levels

Light	Yes
Normal	Yes
Heavy	Yes
Solid Soil	Yes

Dryer

Balanced Dry	Yes
Drum Back Type	Painted Steel
Drum Material	Stainless Steel
Dryness Level Selections	Yes
Lint Filter	Yes
Moisture Sensor	Yes

Dryer Options

Delay Start Time	1-12 Hours
Drum Light	Yes
Dry Boost	Yes
Extended Tumble	Yes
Perfect Steam	Yes
Wrinkle Release	Yes

Dryness Level

High	Yes
Normal	Yes
Low	Yes
Damp	Yes

Exterior

Door Latch	Yes
Reversible Door	Yes