

**HEFTY** 



# BLACK CLIP™

INVISIBLE FASTENER DESIGNED FOR HARDWOOD TIMBER

Discreet and High Performance with every installation.



**CLIP**  
INVISIBLE

## BLACK CLIP™ BY HEFTY

Designed to combine precision and performance, the **BLACK CLIP™** by **HEFTY** stands out as one of the most durable hidden fastening systems available. Its discreet design delivers a flawless finish with no visible screws, offering the perfect balance of strength, aesthetics, and innovation.

### INVISIBLE CLIP SYSTEM

The **BLACK CLIP™** securely holds decking boards from the sides, eliminating visible screws on the surface. The visible section, positioned between the boards, is made from treated black materials to blend seamlessly into the shadow gap while ensuring fast and precise installation.

### TAILORMADE FOR HARDWOOD

Developed specifically for exotic timber, the **BLACK CLIP™** combines a stainless steel reinforcement plate with a fibre-reinforced polymer shell. This design ensures strength, flexibility, and long-lasting durability, even in tropical climates. Its structure prevents water retention and resists UV exposure and harsh outdoor conditions for maximum longevity.

## TECHNICAL FEATURES

Isometric View

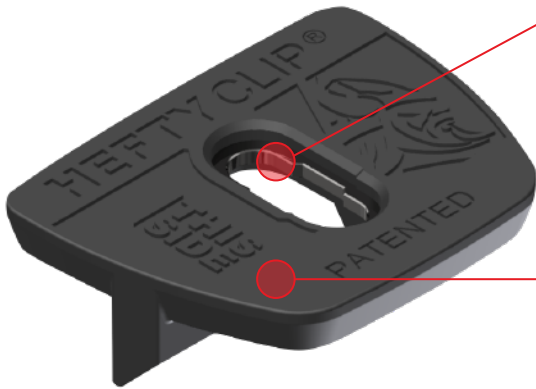

### Reinforcement Plates

Marine-grade 316 A4 stainless steel plate treated with a black oxide coating.

### Shell

Fibre-reinforced plastic shell with black shell particles.

Top View

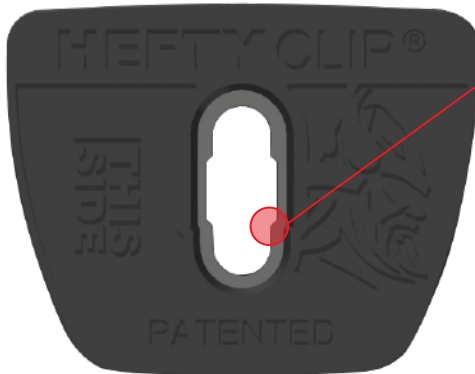

### “KEYHOLE” Design

This specially engineered shape is designed to receive the conical section of the screw, allowing it to sink deeper into the reinforcement plate while improving anchoring strength.

Side View

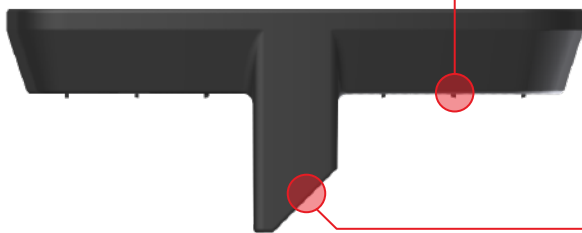

### Nibbles

Positioned along the direction of the wood grain to improve grip between both materials.

### Air Gap

Allows airflow circulation and prevents liquid stagnation caused by capillary action.

Rear View



### In-Built Spacer

Maintains consistent spacing between decking boards and prevents deformation or bending during screw installation.

## KEY FEATURES



### Stability

The BLACK CLIP prevents decking boards from shifting thanks to its spring mechanism, which absorbs pressure and reduces movement.



### Spacing Consistency

Ensures even spacing and perfectly aligned decking boards.



### Durability

Made from marine-grade stainless steel and protected against rust and UV exposure, the BLACK CLIP™ is strong and weather-resistant.



### Installation

Simple, fast, and consistent installation, even for professionals.



### Versatile

Can be installed in both directions, making installation and maintenance easier.



### Outdoor Use

Designed specifically for outdoor applications and resistant to harsh weather conditions.



Available in:  
**BOX OF 100 PIECES**



Available in:  
**BOX OF 600 PIECES**

## TECHNICAL DETAILS

Made from **SS316 STAINLESS STEEL** and **FIBRE-REINFORCED PLASTIC**, this clip provides exceptional corrosion resistance, high strength, and optimal durability for all outdoor installations.

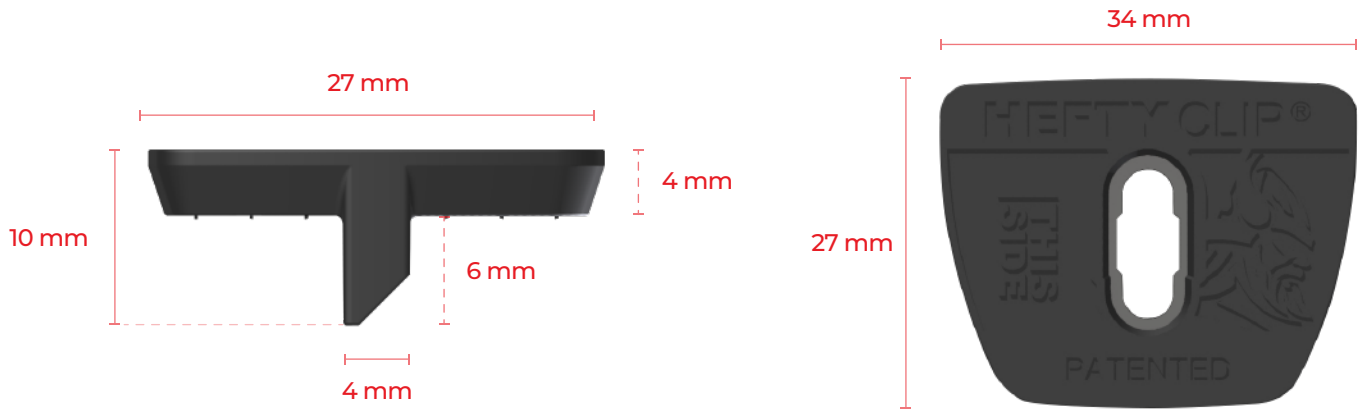

### INVISIBLE FINISH WITH CONSISTENT SPACING

Following both aesthetic and technical testing, a **4 MM GAP** was determined to be the optimal spacing between decking boards.

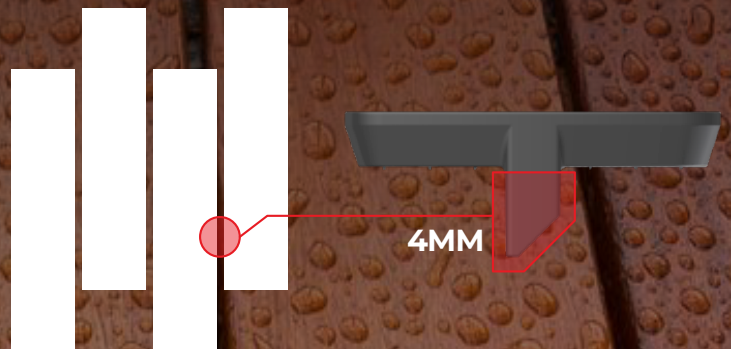

# INSTALLATION GUIDE

The HEFTY BLACK CLIP™ System combines BLACK CLIP™, A4-316 Stainless Steel BLACK CLIP™ Screws, and HEFTY BLACK BEARER™ to create a strong, durable, and virtually invisible decking system.

Designed to allow the natural movement of timber, it delivers a secure fixing without stressing the wood fibres for a clean, long-lasting finish.

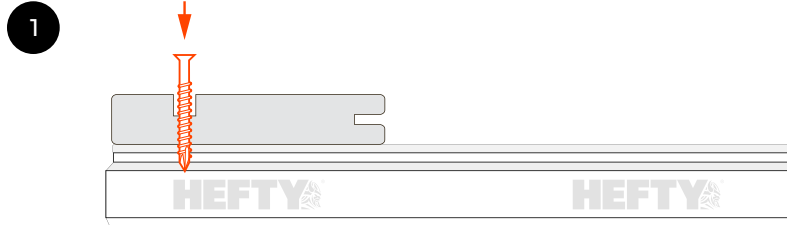

**Secure the first decking board using a traditional face-fixing method.**

Fix the first board directly onto the BLACK BEARER™ using stainless steel screws to create the starting point for the concealed fixing system.

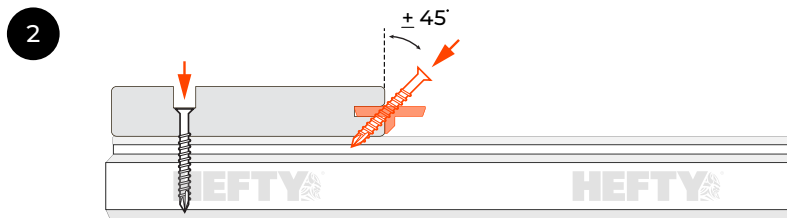

**Install the first BLACK CLIP™.**

Machine the required groove using a biscuit joiner or slot cutter. Insert the BLACK CLIP™ and secure it to the BLACK BEARER™ using the BLACK CLIP SCREW, driven at a 45° angle until firmly seated.

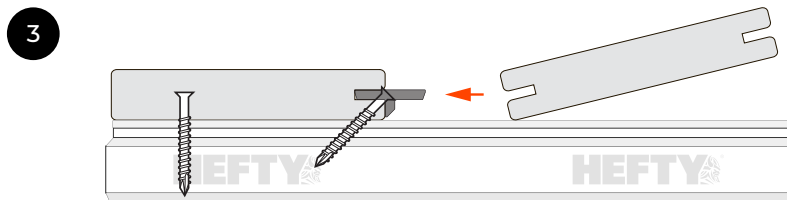

**Position the next decking board.**

Machine the groove in the next board, then slide it into the installed BLACK CLIP™ until fully engaged.

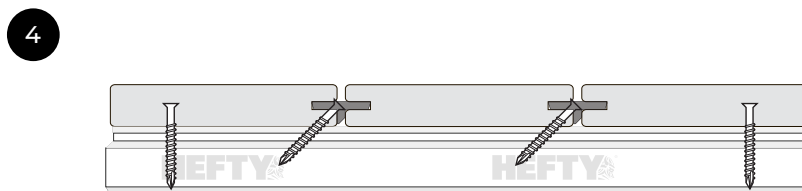

**Repeat the process.**

Continue installing clips and boards until the deck is complete. Secure the final board using a traditional face-fixing method where required.

## A COMPLETE DECKING SYSTEM

DISCREET AND HIGH PERFORMANCE WITH EVERY INSTALLATION

Engineered for hardwood applications, providing concealed fixing, superior structural stability and long-term performance in harsh outdoor environments.

● BLACK CLIP™ ● HEFTY SCREWS ● BLACK BEARERS™

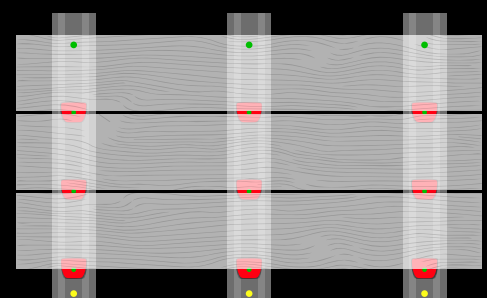

Decking System Top View



The “Tropicalized” label represents a quality standard achieved through product testing in tropical conditions. All products must be used in accordance with recommended best practices.

## LOCAL DISTRIBUTOR HEFTY LTD ( MAURITIUS)

HEFTY LTD | WWW.HEFTY.INDUSTRIES | ADDRESS: NO 1 MILITARY ROAD POINTE AUX  
PIMENTS MAURITIUS | Email: [INFO@HEFTY-TIMBER.COM](mailto:INFO@HEFTY-TIMBER.COM) | TEL: +230 2611300

DOMESTIC COMPANY REGISTRATION INFORMATION | BUSINESS REGISTRATION NUMBER  
(BRN) : C11101510 | COMPANY NUMBER (CN) : 101510 | VAT NUMBER (VN) : 270 79548

---

*DISCLAIMER: This brochure is provided for informational purposes only. The data and specifications contained herein are sourced from what are considered reliable sources; however, their accuracy or completeness is not guaranteed. No express or implied warranties are given, particularly with regard to forecasts or projections relating to future conditions. The publisher accepts no responsibility for any decisions made or actions taken based on the information contained in this document.*

© HEFTY – ALL RIGHTS RESERVED.

The design, format, layout, editorial and graphic structure, texts, visuals and creative concepts of this brochure are protected by copyright and intellectual property laws. Any reproduction, imitation or use, in whole or in part, without the prior written consent of HEFTY is strictly prohibited and may result in civil and/or criminal liability.