

# OAKWOOD HARBOR SECTION 1

A Subdivision Located in The E/2 NE/4 Of Section 3, T11N, R16E, 1 B & M, McIntosh County, Oklahoma

### OAKWOOD HARBOR SECTION 1 - PROPERTY DESCRIPTION

A tract of land located in the E/2 NE/4 of Section 3, T11N, R16E, 1 B & M, McIntosh County, Oklahoma, being more particularly described as follows, to-wit: BEGINNING at the Northwest corner of the E/2 NE/4 of said Section 3; thence N89°55'54"E on the North Boundary line of said Section 3 for a distance of 1160 feet to a point on the Westerly Right-of-Way line of Lotawatah Road; thence S0°15'03"E parallel with the East Boundary line of said Section 3 on the said Westerly Right-of-Way line, thence N89°44'57"E on the said Westerly Right-of-Way line for a distance of 75 feet; thence S0°15'03"E on the said Westerly Right-of-Way line for a distance of 150 feet; thence S11°03'33"W on the said Westerly Right-of-Way line for a distance of 152.97 feet; thence S0°15'03"E on the said Westerly Right-of-Way line for a distance of 223 feet; thence S11°33'39"E on the said Westerly Right-of-Way line for a distance of 76.49 feet; thence S0°15'03"E on the said Westerly Right-of-Way line for a distance of 331.63 feet; thence S89°44'57"W for a distance of 71 feet; thence N67°31'37"W for a distance of 43.37 feet; thence S89°44'57"W for a distance of 642.79 feet; thence N16°24'48"W for a distance of 93.24 feet; thence S75°30'06"W for a distance of 104.73 feet; thence S58°07'56"W for a distance of 110.01 feet; thence S80°25'19"W for a distance of 127.57 feet; thence S79°09'47"W for a distance of 40.69 feet; thence S89°45'46"W for a distance of 71 feet to a point on the West Boundary line of the E/2 NE/4 of said Section 3, thence N0°14'14"W on the West Boundary line of said Section 3 for a distance of 983.64 feet to the point of BEGINNING, containing 27.97 Acres, more or less.

4-12-83  
STATE OF OKLAHOMA )  
COUNTY OF )  
I do hereby certify that this instrument was filed for record and duly recorded in my office  
8:00 AM  
In Book 237 Page 665  
RANDY McIVER, County Clerk  
By [Signature] Deputy

### OWNER'S CERTIFICATE

IN TESTIMONY WHEREOF, National Development Company, Inc. has caused these presents to be signed by its President and Secretary and its seal affixed this 8 day of April, 1983.

ATTEST: [Signature] Secretary  
[Signature] President

STATE OF  
COUNTY OF

On this 8 day of April, 1983, before me personally appeared Robert J. Sabinsko and Karen Llewellyn to me personally known, who being by me duly sworn did say that they are the President and Secretary, respectively of National Development Company, Inc. a corporation and the seal affixed to this instrument is the seal of said corporation by authority of its governing body and that said President acknowledged said instrument to be the free act and deed of said corporation.

IN TESTIMONY WHEREOF, I have hereunto set my hand and affixed my official seal, at my office in Dallas County, the day and year above written.

My Commission expires 9/22/84  
[Signature] Notary Public

### SURVEYOR'S CERTIFICATE

KNOW ALL MEN BY THESE PRESENTS, that I, Basil E. Scott, Jr., Registered Professional Surveyor in the State of Oklahoma, have carefully and accurately surveyed the above tract of land known as Oakwood Harbor Section 1 an Addition in McIntosh County, Oklahoma and that this is a representation of said survey.

WITNESS MY HAND AND SEAL THIS 1st DAY OF April, 1983

[Signature]  
Basil E. Scott, Jr., R.L.S. No. 343



STATE OF OKLAHOMA )  
COUNTY OF MUSKOGEE )

BEFORE ME, THE UNDERSIGNED, a Notary Public in and for said County and State, this 1st day of April, 1983, personally appeared Basil E. Scott, Jr., to me known to be the identical person who subscribed his name to the foregoing instrument and acknowledged to me that he executed the same as his free and voluntary act and deed and the free and voluntary act and deed of SCOTT & ASSOCIATES, INC., for the uses and purposes therein set forth.

WITNESS MY HAND SEAL ON THE DAY AND YEAR LAST ABOVE WRITTEN

MY COMMISSION EXPIRES: Feb 21, 1987  
[Signature] Notary Public



### CERTIFICATE OF COUNTY TREASURER

All ad valorem taxes are paid on this land through the taxable year of 1983

[Signature] County Treasurer  
[Signature] Deputy

### HEALTH DEPARTMENT APPROVAL

[Signature] Date 4-8-83

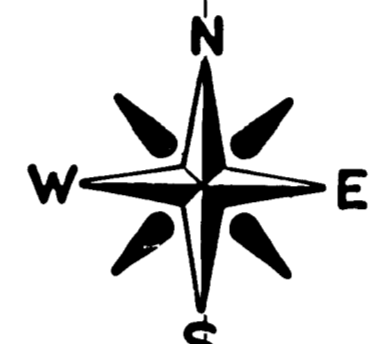

SCALE 1"=50'

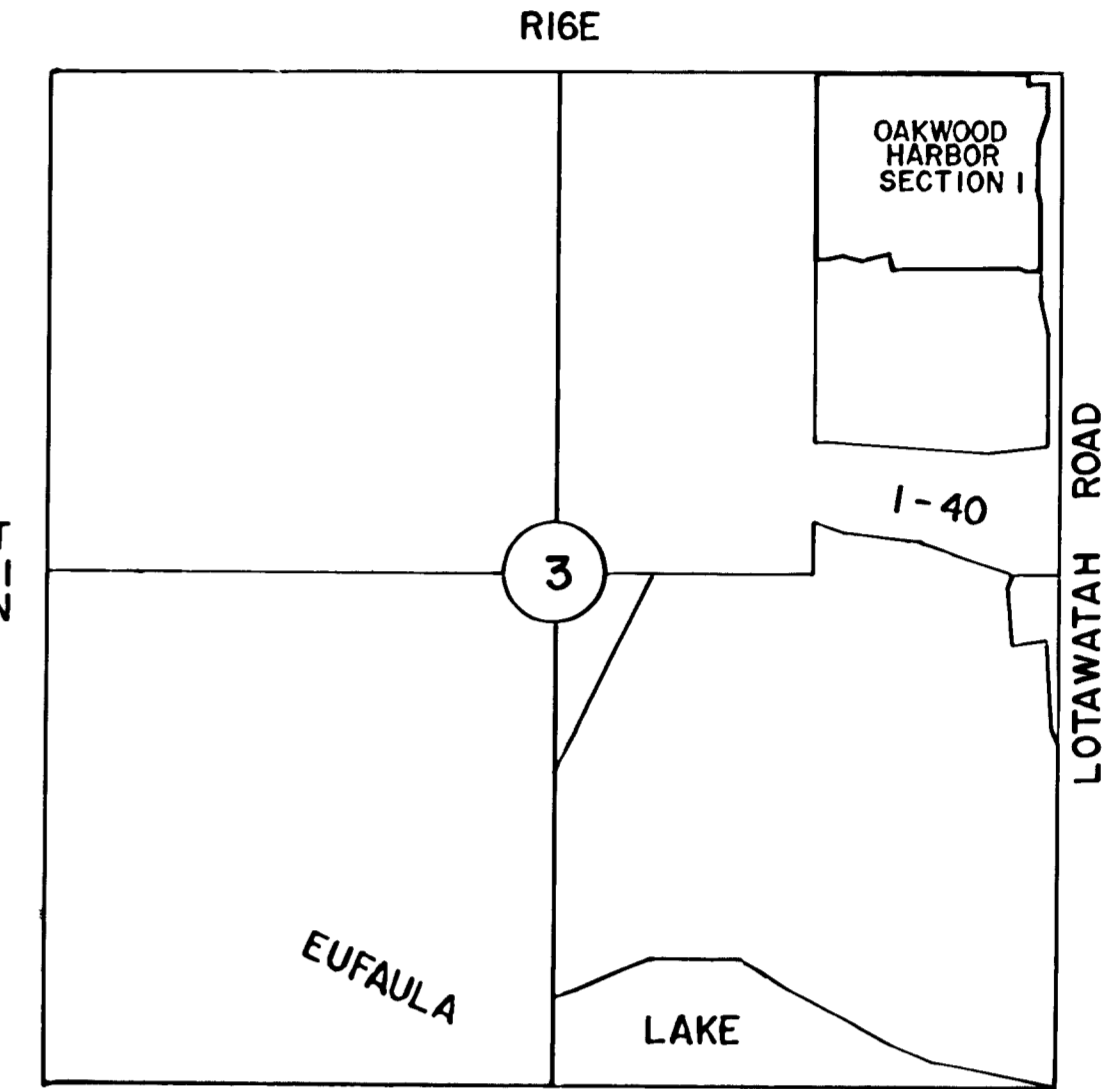

LOCATION MAP  
SCALE 1"=1000'

POINT OF BEGINNING  
NW CORNER E/2 NE/4  
SEC 3, T11N, R16E

NE CORNER OF  
SEC 3, T11N, R16E

