

## Installation of Extension Conveyor Internal Wiring Harness

1. Swing Mulch Mate open and use a forklift or skid steer to support the chute-side of machine to keep it from drooping.
2. Remove the lower inner panel (fig.#1) (23 Allen Head Blots) Note: Be sure to clean inside the Allen Head and press in firmly when unscrewing to prevent rounding them off.



Fig #1

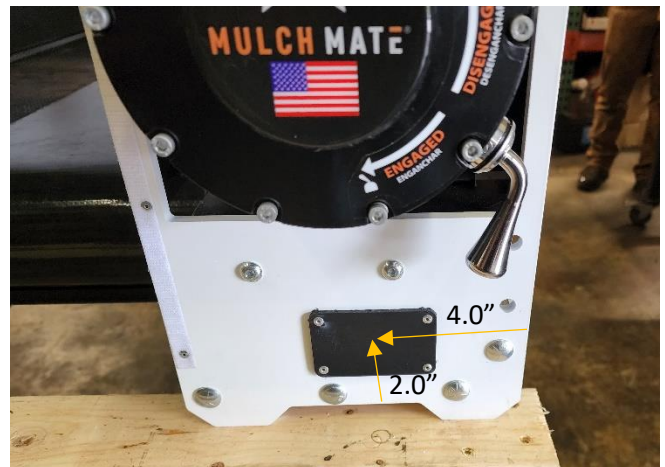
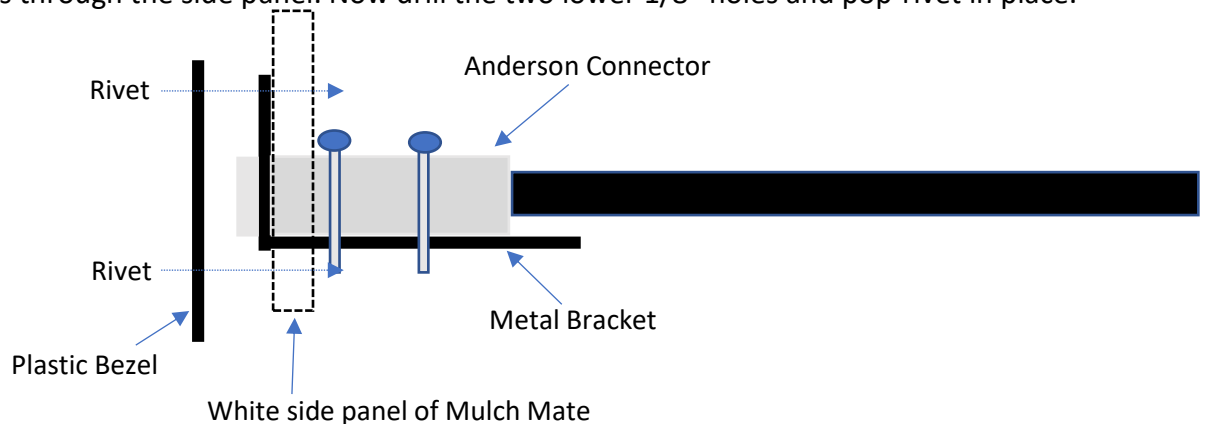

Fig #2

3. Using a 1-1/2" hole saw, Drill a hole in the chute-side panel for the conveyor power connector. (Fig #2) Measure 4.0" from the right edge and 2.0" from the bottom edge between the feet tabs and mark a center point. Drill hole through side panel.
4. Slide the terminal ends of the wiring harness through the hole. Align the metal bracket, mark and drill the two top hole with a 1/8 inch drill bit. Place the plastic bezel over the metal bracket and rivet the two top holes through the side panel. Now drill the two lower 1/8" holes and pop-rivet in place.



5. Fig #2 shows a blank cover but installed connector should look similar with Anderson Connector showing.

- Run the red and black wires through the area behind the panel supports to the right side of the black box. The red wire will get connected to the inside terminal of the 50 Amp Breaker, NOT THE WIRE WITH THE RED STRIP ON IT (see Fig #3). The black wire will get connected to the ground bolt (see fig #4).

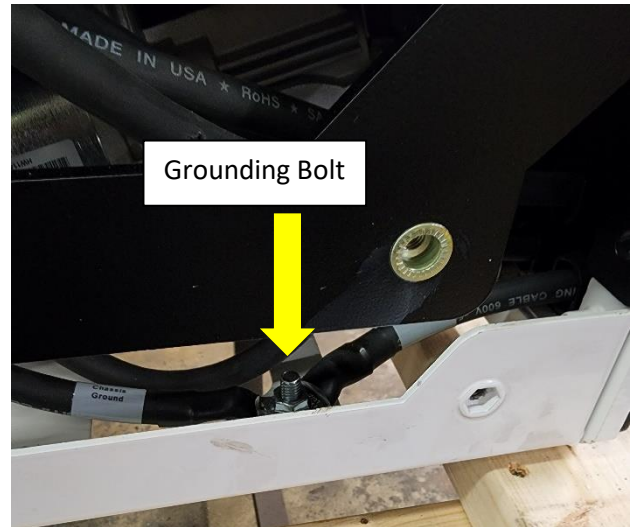
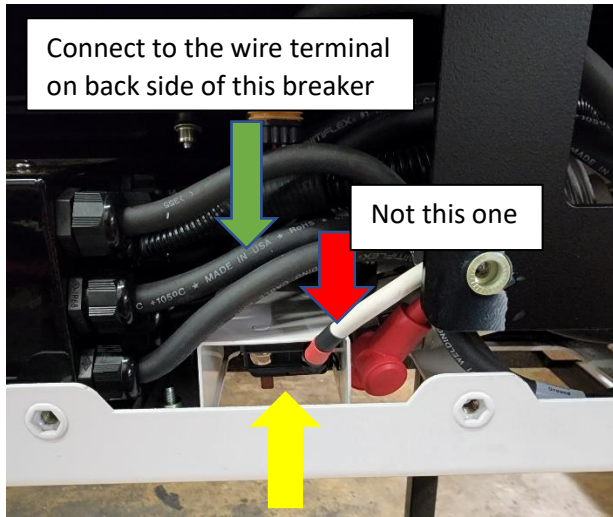

- Zip-tie red/black wires in a safe place usually to panel supports.
- Reinstall white lower inner panel. NOTE: Use forklift or jack to lift the chute-side of the machine in such a way that when you tighten the Allen -Head bolts it keeps the unit square. If you tighten the bolts with the unit in a drooped position it will make it harder to close the unit on the truck.

If you have any questions while installing this harness call our engineering dept at (888) 776-8524 x804 Jamie.