

4

3

2

1

ITEM NO.	PART NUMBER	DESCRIPTION	Default/QT Y.
1	M09-10504	X Hitch Mate Rect Tube	1
2	M09-10505	HITCH MATE SIDE SUPPORT, WRIGHT, STANDER X, LEFT	1
3	M09-10506	HITCH MATE SIDE SUPPORT, WRIGHT, STANDER X, RIGHT	1
4	M09-10458	HITCH MATE SLEEVE, WRIGHT STANDER B/X	2
5	H09-10047	1/2" x .75" Clevis Pin	2
6	H09-10048	Locking Cotter Pin, for 1/2" Clevis Pin	2
7	HM-FLT-UNV	STANDARD FLAT HITCH RECEIVER	1
9	H09-10215	3/8-16 x 2.25" Carraige Bolt	4
10	H09-10216	5/16-18 x 4" Socket Head Screw	2
11	H09-10008	3/8"-16 FLANGE LOCKNUT	4
12	H09-10005	5/16" FLANGE LOCKNUT	2

REVISIONS				
ZONE	REV.	DESCRIPTION	DATE	NAME
	A	ORIGINAL RELEASE	10/19/2020	JL

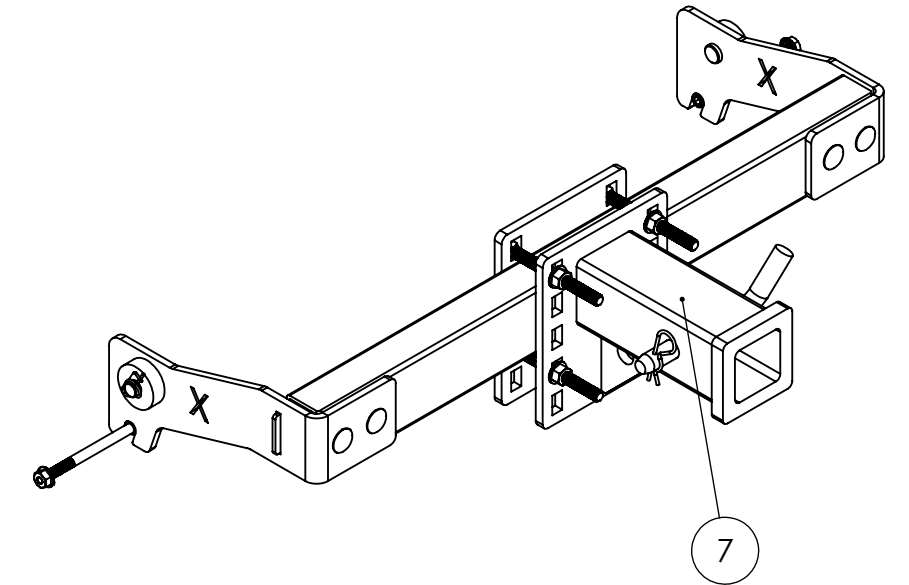

HITCH MATE
MOUNTING LOCATION

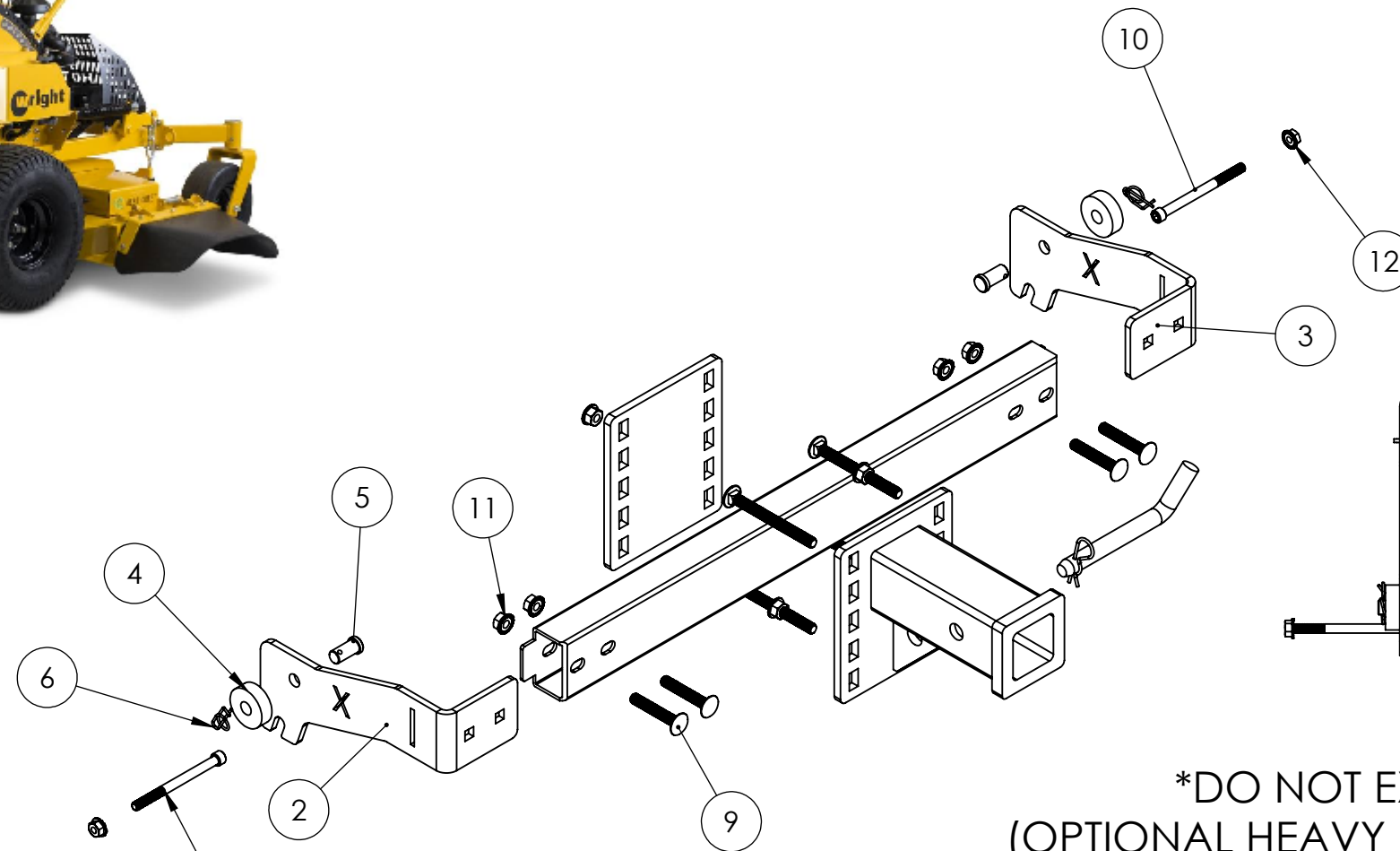

***DO NOT EXCEED 300LB TOWING CAPACITY
(OPTIONAL HEAVY DUTY TOWING BRACKET COMING SOON)**

*REPLACE BOLT IN REAR
SMALL PLASTIC WHEELS WITH
PROVIDED SOCKET SCREWS



DO NOT SCALE DRAWING	DIMENSIONS ARE IN INCHES TOLERANCES: ANGULAR: MACH ± 0.5 BEND ± 1 ONE PLACE DECIMAL ± .050 TWO PLACE DECIMAL ± .025 THREE PLACE DECIMAL ± .005	3RD ANGLE PROJECTION	TITLE: HITCH MATE, WRIGHT, STANDER X, REAR	PATENT PENDING	
PROPRIETARY AND CONFIDENTIAL THE INFORMATION CONTAINED IN THIS DRAWING IS THE SOLE PROPERTY OF DAWSON MANUFACTURING. ANY REPRODUCTION IN PART OR AS A WHOLE WITHOUT THE WRITTEN PERMISSION OF DAWSON MANUFACTURING IS PROHIBITED.	MATERIAL SEE BOM	FINISH	SIZE B	PART NO. HM-WRT-STX-R	REV A
			SCALE: 1:6	WEIGHT: 28.96 lbs	SHEET 1 OF 1

4

3

2

1