

SCHUMACHER LEASING PRESENTS

SILVER LAKE PROFESSIONAL CENTER

1710 * 1720 100th PL. SE, Everett, WA. 98208 (Silver Lake Highway 527)



**Silver Lake
Professional Center**



1710 Building



1720 Building

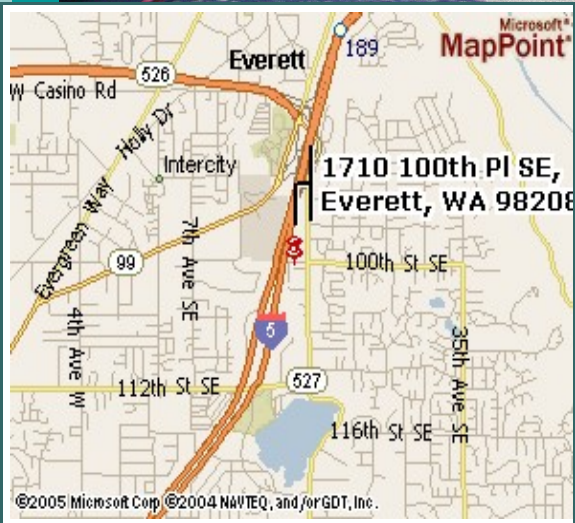

BUILDING FEATURES

APPROX 17,755 SQ. FT. OFFICE FACILITY
Medical and General Office Space

- ✦ Near Costco Everett I-5 Interchange
- ✦ Convenient Free Parking / Ground Floor Entry
- ✦ Excellent Value for Office Space
- ✦ Main Street Exposure on Bus Route
- ✦ Some Tenant Improvements Available
- ✦ Long Term Lease Discounts Available

Please ask about availability

For More Information Contact (206) 715-9000



SCHUMACHER LEASING

OFFICE SPACE – RETAIL – CONDO - SELF STORAGE

Owner Direct Properties Jim@LeasingRealestate.com

(206) 715-9000

PO BOX 949. Mukilteo. WA. 98275

* The Information contained herein has been obtained from sources deemed reliable but is not guaranteed.

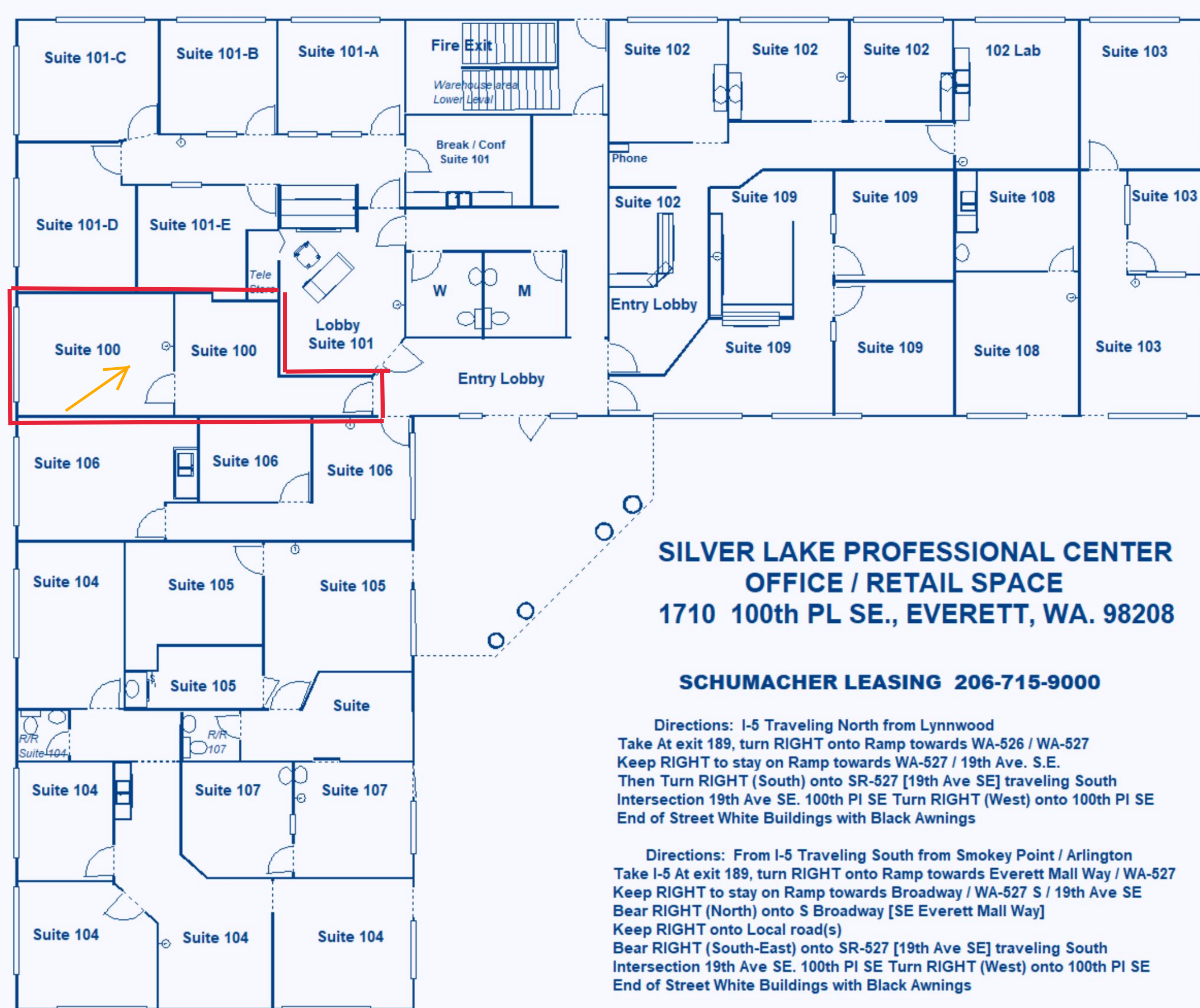

SILVER LAKE PROFESSIONAL CENTER OFFICE / RETAIL SPACE 1710 100th PL SE., EVERETT, WA. 98208

SCHUMACHER LEASING 206-715-9000

Directions: I-5 Traveling North from Lynnwood
Take At exit 189, turn **RIGHT** onto Ramp towards WA-526 / WA-527
Keep **RIGHT** to stay on Ramp towards WA-527 / 19th Ave. S.E.
Then Turn **RIGHT** (South) onto SR-527 [19th Ave SE] traveling South
Intersection 19th Ave SE. 100th Pl SE Turn **RIGHT** (West) onto 100th Pl SE
End of Street White Buildings with Black Awnings

Directions: From I-5 Traveling South from Smokey Point / Arlington
Take I-5 At exit 189, turn **RIGHT** onto Ramp towards Everett Mall Way / WA-527
Keep **RIGHT** to stay on Ramp towards Broadway / WA-527 S / 19th Ave SE
Bear **RIGHT** (North) onto S Broadway [SE Everett Mall Way]
Keep **RIGHT** onto Local road(s)
Bear **RIGHT** (South-East) onto SR-527 [19th Ave SE] traveling South
Intersection 19th Ave SE. 100th Pl SE Turn **RIGHT** (West) onto 100th Pl SE
End of Street White Buildings with Black Awnings