

**PRE-ENTRIES CLOSE 12:00 Noon EDT, Monday, October 15, 2018**  
*Method of Entry is Pre-Entry, First Received with Limited Day of Entries*

## Southern New Jersey

AMERICAN KENNEL CLUB  
Licensed CLUB

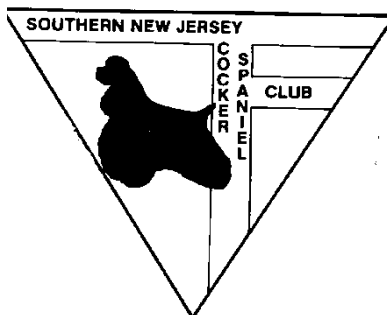

### ALL-BREED AND MIXED BREED AKC COURSING ABILITY TEST

**60 Dog Limit per Trial**

***Saturday, October 20, 2018***

**AM:** Event # 2018007507 *Limited day-of entries accepted until 10AM*

**PM:** Event # 2018007508 *Limited day-of entries accepted until noon*

***Sunday, October 21, 2018***

**AM:** Event # 2018007509 *Limited day-of entries accepted until 10AM*

**PM:** Event # 2018007510 *Limited day-of entries accepted until noon*

Colonial Park, 156 Mettlers Rd, Somerset NJ 08873  
Knob Hill

**This Event is Accepting Entries for Dogs listed in the AKC Canine Partners Program**



#### CERTIFICATION

Permission has been granted by the American Kennel Club for the holding of this event under AKC Rules and Regulations. James P. Crowley, Secretary

# Officers of Southern NJ Cocker Spaniel Kennel Club 2018

President .....Carolyn Kelley  
Vice President.....Debra Lampert Rudman  
Recording Secretary.....Regina Baker  
Corresponding Secretary.....Pat Crew  
Treasurer.....Debbie Gunkle

## **Board of Directors**

Jeannie Gau, Ellen Toomey, Jackie Curry, Bettie Campbell

## **Event Committee**

Pat Crew, Carolyn Kelly, Regina Baker, Deb Gunkle, Ellen Toomey, Dan Kelley

## **Chairperson**

Kim Vavulo

## **Emergency Response Coordinator**

Pat Crew

## **JUDGE**

Jaime R. Nuckles, #103235

## **FIELD COMMITTEE**

Field Chairperson.....Carolyn Kelley  
Field Secretary.....Pat Crew  
Lure Operators.....Thaddeus Szymczak, Mary Lou Roselli, Mark Barlics, Debbie Barlics  
Huntmasters.....Debbie Barlics, Elaine Szymczak, MaryLou Roselli  
Paddock.....Ellen Toomey, Regina Baker  
Inspection Committee..... Kim Vavulo, Deb Gunkle

**In case of unforeseen circumstances, committee members may be substituted as necessary.**

## **Trial Secretary**

Pat Crew 908 255-3632 pcrew66@gmail.com

**ENTRIES CLOSE: 12 Noon EDT ON MONDAY, October 15, 2018**

**Entries will be acknowledged by email.**

## **ENTRY FEES**

*All pre-entries become non-refundable after the pre-entry deadline*

**Pre-Entry for Coursing Ability Test: \$25.00**

**Day Of Entries: \$30.00**

**Make checks payable to SNJCSC and mail to:**

**SNJCSC c/o Pat Crew**

**66 No. Clark Ave., Somerville, NJ 08876**

**DO NOT SEND ENTRIES REQUIRING SIGNATURE FOR DELIVERY**

## > CAT Running Order: Entry Method First Received <

Entries accepted until closing date. Late, incomplete, unsigned, or conditional entries will not be accepted. Entries **WILL** be acknowledged by email. Please write legibly.

Approximate run order/time slots for your dog(s) will be posted after the closing date on

FACEBOOK/Southern New Jersey Cocker Spaniel Club

Scheduled run times will be emailed to entrants after closing date or when numerical limits have been met.

### **SATURDAY**

**TRIAL HOURS:** 9:00 AM until completed

**WORKERS BRIEFING:** 8:00 AM

### **SUNDAY**

**TRIAL HOURS:** 9:00 AM until completed

**WORKERS BRIEFING:** 8:00 AM

### **INSPECTION and CHECK-IN**

**\*\* Early inspection may not begin prior to published trial hours \*\***

Dogs will receive time slots via email.

Arrive *at least* 1 hour prior to timeslot for inspection and check-in.

Dogs not present and checked in at paddock 45 minutes before run time will be scratched after a 5 minute grace period.

If you do not check in and your run time comes up we will assume you are absent and you will lose your turn. No monies will be refunded for dogs not checked in ahead of time.

RIBBONS: CAT: Qualifying Course = Orange Ribbon  
CAT: New Title = Orange Rosette

**Dogs** will be inspected by a designated Inspection Committee consisting of at least two persons who are members of the field committee and who shall inspect each entered dog for lameness, fitness to compete and female estrus (in season). Inspection shall take place prior to any form of wrapping being applied to the dog. In the opinion of the inspection committee, any entry found to be lame, unfit to compete or in season shall not be allowed to enter and the applicable entry fees shall be refunded.

**CAT ELIGIBLE BREEDS & REGISTRY:** Open to all dogs at least 12 months of age that are individually registered with the AKC, recorded in the FSS program, dogs with PAL numbers or dogs enrolled in the AKC Canine Partners program. Females in season may not enter. A dog may enter only once per event. An event is defined by an event number.

### **WHAT IS THE PURPOSE OF THE COURSING ABILITY TEST (CAT)?**

The purpose of the AKC Coursing Ability Test is to provide all dogs and their owners an enjoyable, healthy activity in which they can participate. Dogs run singularly and are required to complete their course with enthusiasm and without interruption within a maximum amount of time. This is a pass/fail event. Based on the sport of lure coursing, Coursing Ability Tests will serve as an introduction to the sport for all eligible dog owners.

## WHO IS ELIGIBLE TO ENTER THE COURSING ABILITY TEST (CAT)?

Coursing Ability Tests are open to all dogs at least 12 months of age that are either 1) individually registered with the AKC, 2) recorded in the Foundation Stock Service (FSS) program, 3) individually registered with a foreign or domestic registry organization whose pedigrees are acceptable for AKC registration, 4) dogs granted a Purebred Alternative Listing (PAL) number, 5) dogs with AKC Limited or Conditional Registration, or 6) dogs enrolled in the AKC Canine Partners program. A dog may enter only once per test. Females in season may not enter.

## HOW DO I ENTER MY DOG IN THE TEST?

To enter your dog in the Coursing Ability Test, you must complete an official AKC entry form for each dog forward it with full payment of entry fees to the Test Secretary by the established entry deadline listed in this premium. Please know that the Test Secretary MUST decline any late, incomplete, unsigned, unpaid or conditional entries. This is to say that each entry must be completed in full and the information given on the form must be that which applies to that entered hound. Moreover, the owner or agent duly authorized to make the entry MUST sign the entry form(s) and submit full payment of entry fees for the entry to be accepted.

### ENTRY FEES

*All pre-entries become non-refundable after the pre-entry deadline*

**Pre-Entry for Coursing Ability Test: \$25**

**Day of Entries \$30**

**A pre-entry** is a completed official AKC entry form with payment received by the test secretary by the closing date and time designated for pre-entry in the premium list. The closing date/time for pre-entries at this event is Monday, October 15, 2018 at 12 Noon EDT at the Test Secretary's address.

## WHAT MUST MY DOG DO TO PASS THE CAT?

The Coursing Ability Test (CAT) is a pass/fail test wherein all entrants always run individually. This is to say they run once, and they run alone. Because safety is of the utmost importance, the CAT takes into consideration the individual dog pursuing qualification and therefore has two different course lengths to accommodate the type and size of the entrant. In either case, dogs will chase a lure made of plastic strips.

**DOGS LESS THAN 12" TALL & "FLAT FACED" DOGS.** Any entrant that is less than 12" tall at the withers and/or brachycephalic will run a clearly marked 300-yard\* course (or as close to 300 yards as possible) course that is basically rectangular in shape with turns no more acute than 90 degrees.

**DOGS MORE THAN 12" TALL.** Any entrant that is taller than 12" at the withers and not brachycephalic shall run a clearly marked 600-yard\*\* course (or as close to 600 yards as possible) that is basically rectangular in shape with turns no more acute than 90 degrees.

In order to pass, the dog must complete the course with enthusiasm and without interruption within the maximum amount of time for the course length. The judge keeps the official time and decides the merits of the dog's performance. For a 300-yard\* course, a dog must complete the test in less than 90 seconds; for a 600-yard\*\* course, 120 seconds.

\*200 yards for Veteran dogs 7 Years and older

\*\*400 yards for Veteran dogs 7 years and older

If there is a question which course a dog should run, the judge will decide.

## **CAN MY DOG EARN AN AKC TITLE FOR COURSING ABILITY?**

Three titles will be awarded for dogs that pass the Coursing Ability Test the required number of times. These are suffix titles that will appear on a dog's pedigree with a higher level title superseding a lower level title.

**Coursing Ability (CA)** – Awarded to a dog that passes the Coursing Ability Test three times under at least two different judges.

**Coursing Ability Advanced (CAA)** – Dog passes the Coursing Ability Test ten times.

**Coursing Ability Excellent (CAX)** – Dog passes the Coursing Ability Test 25 times.

**Coursing Ability Excellent 2 (CAX2)** – Dog passes the Coursing Ability Test 50 times. A higher numbered title will be awarded for every additional 25 passes.

### **GENERAL:**

- All entries must be one year of age or older on the day of the trial.
- Dogs not present 45 minutes before run time will be scratched after a 5 minute grace period.
- The field committee reserves the right to alter the course plan as required by weather and/or field conditions on the day of the trial
- The field committee reserves the right to bar known aggressive dogs from the event site.
- Each entry will be examined at inspection. Bitches in season and lame dogs will be excused. Entry fee for dogs excused, during inspection, for bitches in season, or lameness will be refunded.
- Gasoline or electric powered continuous loop lure machines will be used. Backup equipment will be available. Lure will consist of white plastic bags.
- THERE WILL BE A \$5.00 FINE ASSESSED FOR ANY LOOSE DOG NOT TAKING PART IN THE COURSE IN PROGRESS or for anyone caught not picking up after their dog or leaving garbage on the field.
- NO ONE will be allowed on the field without the express permission of the field chairman, except the appointed field committee.
- Anyone exhibiting unsportsmanlike behavior will be excused from the field and may be subject to further disciplinary actions.
- Control of dogs is strictly enforced, on leash at all times except when running.
- Please pick up after your dog and put in receptacles provided at the site.
- PLEASE BRING YOUR OWN SHELTER and water for your dog.
- This is a NON-SMOKING event.
- Big Pinks BBQ Food Truck will be on site for lunch. Check the menu website: <http://www.BIGPINKSBBQ.COM>

**ROUTES TO CAT**

**Google maps: Colonial Park 156 Metlars Lane, Somerset NJ 08873  
Knob Hill location**

**EQUIPMENT**

The equipment for this event is being provided by Mary Lou Roselli and Tad and Elaine Szymczak.

**OFFICIAL PHOTOGRAPHER**



**Mark Baer  
MLBaer Photography  
Stockbridge, MA 01262**

**HOTELS THAT ACCEPT WELL-MANNERED DOGS**

The following will accept well-mannered dogs. (However, exhibitors should double check when making reservations as motels sometimes change their policies and pet fees).

- Hillsborough Days Inn**, 118 US Hwy. 206 S., Hillsborough, NJ 08876 .....(908) 685-9000
- Hyatt House Branchburg**, 3141 Route 22 East, Branchburg, NJ 08876..... (888) 882-1234
- Hyatt House Bridgewater**, 530 Route 22 E., Bridgewater, NJ 08807.....(888) 882-1234
- Super 8 Motel**, 119 Route 206 at Somerville Circle, Raritan, NJ 08869 (908)722-5400
- Holiday Inn Express**, 947 Highway 202 North, Branchburg, NJ 08876.....(908) 252-1000

**CAMPGROUNDS / RV INFORMATION**

Overnight RV parking is available in Lot C at Colonial Park for \$30 payable to the Park Ranger upon arrival. Reservations are not needed.

## **Animal Emergency Clinic**

Animerge  
21 Route 206, Raritan, NJ 08869  
(908) 707-9077

Owner/handler must transport the animal

### **BRACHYCEPHALIC DOGS**

Affenpinscher	English Toy Spaniel
American Bulldog	French Bulldog
American Cocker Spaniel	Japanese Chin
Boston Terrier	Lhasa Apso
Boxer	Mastiff
Brussels Griffon	Neapolitan Mastiff
Bulldog	Newfoundland
Bullmastiff	Pekingese
Cavalier King Charles Spaniel	Presa Canario
Cane Corso	Pug
Chihuahua (apple headed)	Shar-Pei
Chow Chow	Shih Tzu
Dogo Argentino	Tibetan Spaniel
Dogue de Bordeaux	Valley Bulldog

# COURSE DIAGRAM

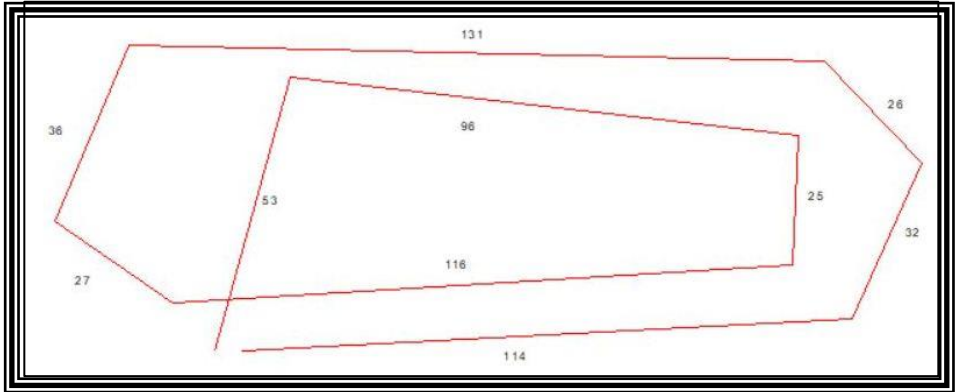



## NOTICE TO ALL EXHIBITORS

All entries must be one year of age or older on the day of the test.

Spayed or neutered dogs and dogs with breed disqualifications may be entered. Each dog requires an individual entry form for each event in which it is entered.

No entry shall be made and no entry shall be accepted which specifies any condition as to its acceptance. Entries will not be accepted without fees, signatures or the "Agreement" found on the Official AKC Entry Form.

Bitches in season and lame dogs will be refused entry and, if presented at inspection, will be refunded entry fees.

Coursing is an athletic activity that can tax a dog's physical strength. Dogs that are overweight and/or out of condition may be at greater risk for injury and exhaustion. The Inspection Committee has the authority to disallow a dog's entry into a test, and in such instances, applicable entry fees will be refunded.

Exhibitors should follow their veterinarian's recommendation to assure their dogs are free of parasites, any communicable diseases and have appropriate vaccinations.

Dogs ideally will be handled with a "slip-lead" that gives instantaneous freedom to the dog when the "Tallyho" (release) signal is called by the Huntmaster. However, dogs can be run with a flat buckle collar without tags or anything that dangles. Special Training devices including but not limited to pronged collars, shock collars, halti-leads and similar training devices may not be used.

For the safety of the dog and as a courtesy to other entrants, a testing dog should have a reliable recall. Dogs that delay the event because they cannot be recalled by their owners may be refused entry at future events.

The Huntmaster is responsible for field safety and therefore he/she is in complete charge of all dogs and handlers on the field. In service to this responsibility, he/she has the authority to stop the lure in any potentially dangerous situation and signal the handler to retrieve a testing dog. Listen to the Huntmaster and follow his/her instructions promptly and swiftly.

Any decisions made by the event's officiating judge(s) regarding the performance of an entered dog shall be final. Full discretionary power is given to the judge(s) to withhold any and all qualifications for lack of merit. The Judge is responsible for ensuring compliance with the AKC Regulations on the field.

No entry fees will be refunded if the event cannot be started or completed by reason of riots, civil disturbances, fire, extreme and/or dangerous weather conditions, an act of God, public emergency, act of a public enemy, strikes or any other cause beyond the control of the Club or its members and representatives.

Persons exhibiting conduct detrimental to AKC/SHKC/any dog(s)/other person(s) will be asked to leave the trial site.

The event-hosting club, its agents, members, representatives, volunteers, etc, assume no responsibility for any loss, damage or injury sustained by exhibitors, handlers, or to any of their dogs or property and further assumes no responsibility for injury to children or spectators.

All rights to televise, videotape, advertise, photograph, promote or otherwise exploit this event are vested in the club, or in persons to whom assignments of such rights have been made in writing by the club. All persons and animals attending these shows grant the club the right to use their likeness and voice in any matter without further consent.

A penalty of \$5.00 will be assessed for any and each loose dog(s) not competing in the course in progress. A penalty of \$10.00 will be assessed for any dog causing an excessive delay of the event because it cannot be recalled or retrieved from the field.

A return check fee of \$35.00 will be assessed for any check(s) returned for insufficient funds. Portable restroom facilities will be available.

Some tree-shade is available on the perimeter of the field, but please ensure your own comfort by bringing portable shade/shelter, as well as water.

