

85
Set 88
2

OPERATOR'S MANUAL AND PARTS LIST

JACOBSEN **TEXTRON**

Jacobsen Division of Textron Inc.

BLITZER PULL FRAMES

PRODUCT NOS. 73403, 73404, 73410,
73411, 73412, 73413,
73420, 73430, 73440.



WARNING

IF INCORRECTLY USED THIS MACHINE CAN CAUSE SEVERE INJURY. THOSE WHO USE AND MAINTAIN THE MACHINE SHOULD BE TRAINED IN ITS PROPER USE, WARNED OF ITS DANGERS, AND SHOULD READ THE ENTIRE MANUAL BEFORE ATTEMPTING TO SET UP, OPERATE, ADJUST OR SERVICE THE MACHINE.



CAUTION

1. KEEP ALL SHIELDS IN PLACE.
2. STOP MACHINE TO ADJUST AND OIL.
3. WHEN MECHANISM BECOMES CLOGGED,
DISENGAGE POWER BEFORE CLEANING.
4. KEEP HANDS, FEET AND CLOTHING AWAY
FROM POWER-DRIVEN PARTS.
5. KEEP OFF IMPLEMENT UNLESS SEAT OR
PLATFORM IS PROVIDED.
KEEP OTHERS OFF.

FOREWORD

This manual contains operating, maintenance, assembling instructions and parts list for your Jacobsen attachments. This material has been prepared in detail which will prove helpful in ordering of parts and for proper care and efficient operation of this equipment.

If added information is needed and not given in this manual, or should you require trained mechanic services, contact your local Jacobsen Turf Equipment Distributor.

All Jacobsen Turf Equipment Distributors are kept informed of latest methods of servicing and are equipped to provide prompt and efficient service either in the field or at their service station. They carry ample stocks of service parts or can secure them promptly for you from the factory.

When, through wear or accident, new parts are required, make certain that only genuine Jacobsen parts are used.

WHEN ORDERING PARTS, ALWAYS SPECIFY THE MODEL NUMBER OF YOUR TRACTOR OR EQUIPMENT AS WELL AS QUANTITY AND PART NUMBER OF PARTS REQUIRED.

SPECIFICATIONS

Cutting Width: 30 inches (762 mm.) (each unit)

Over-all Cutting Swath:

3-Gang	7 ft. 2 in. (2184 mm.)
5-Gang	11 ft. 10 in. (3606 mm.)
7-Gang	16 ft. 6 in. (5029 mm.)
9-Gang	21 ft. 2 in. (6451 mm.)

Frames: Electrically welded convertible steel frames permit attaching frames into gang combinations listed above. The frames also have automotive type suspension springs mounted in rubber shackles. These springs permit high speed cutting with reduced maintenance cost.

The handy spring lever assembly regulates the cutting height from 7/8" (22.2 mm.) to 3-1/2" (89 mm.) in 1/4" (6.35 mm.) increments.

BLITZER PULL TYPE FRAMES SET-UP INSTRUCTIONS

Refer to Blitzer Frame Assembly, page 6 for reference numbers given below.

FRONT FRAME

1. Remove the Spring Lever Assembly (Ref. #53) from the frame assembly.
2. Remove rod (Ref. #51), cotter pins (Ref. #22), lock pin (Ref. #44), and cotter pin (Ref. #43) from Spring Lever Assembly.
3. Remove spring adjusting nut (Ref. #45) from outer tube assembly (Ref. #47) along with spring lever (Ref. #50).
4. Insert outer tube assembly (Ref. #47) along with spring (Ref. #46) into 1-1/2" (38 mm.) hole in rear section of frame and reinstall spring adjusting nut (Ref. #45), lock pin (Ref. #44) and cotter pin (Ref. #43).
5. Remove two (2) rod end pin (Ref. #21) and cotter pin (Ref. #22) from perch (Ref. #20).
6. Install frame onto cutting unit with perch (Ref. #20) resting on cutting unit main axle and secure with rod end pin (Ref. #21) and cotter pin (Ref. #22).
7. Install rod (Ref. #51) into center hole of cutting unit bedknife backing assembly as shown under Ref. 53 and lock with cotter pins (Ref. #22).
8. Install hinges (Ref. 29) with connecting hinges in alternate holes.

REAR FRAME

1. Follow instructions 1 through 7 of Front Frame.
2. Remove swivel hinge and rod assembly (Ref. #52) from frame.
3. Insert short end (rear of swivel hinge and rod assembly (Ref. #38) into hinge casting (Ref. #40) and lock with hinge pin (Ref. #39).

48" (1219 mm.) TONGUE

1. Remove carton of parts from tongue angles (Ref. #9) and remove parts from carton.
2. Remove two (2) screws (Ref. #1) from tongue plate (Ref. #7) and spread tongue angles (Ref. #9) until bolt holes line up.
3. Reinstall two (2) screws (Ref. #1) through tongue plate (Ref. #7) and tongue angle (Ref. #9).

96" (2438 mm.) TONGUE

1. Follow instructions 1 through 3 of 48" (1219 mm.) tongue.
2. Remove screw (Ref. #11) from tongue angle (Ref. #8) line up cross member (Ref. #10) and secure with screw (Ref. #11).

ASSEMBLY OF VARIOUS GANG UNITS

The Blitzer 3-Gang Unit consists of a 48" Tongue, two front frames, one rod and swivel hinge assembly, one hinge and posts assembly, and one rear frame. To assemble a 3-Gang Unit, proceed as follows:

1. Install a hitch ball (Ref. #5 & 13) into center of each front frame and into pull tongue of tractor.
2. Install 48" Tongue to tractor and front frames by securing hitches (Ref. #4 & 12) to hitch balls (Ref. #5 & 13).
3. Install long end of swivel hinge and rod assembly (Ref. #52) of rear frame into center hinges of front frames.
4. Adjust all spring lever assemblies evenly and you are ready to mow.

The Blitzer 5-Gang Unit consists of a 48" (1219 mm.) Tongue, two front frames, three rod and swivel hinge assemblies, two hinge and posts assemblies, and three rear frames. To assemble 5-Gang Unit proceed as follows:

1. Follow instructions 1 through 3 of 3-Gang.*
2. Install the two remaining rear frames by installing the long end of swivel hinge and rod assembly (Ref. #52) into right and left end hinges on front frames.
3. Adjust all spring lever assemblies evenly and you are ready to mow.

The Blitzer 7-Gang Unit consists of a 96" (2438 mm.) Tongue, four frames, three rod and swivel hinge assemblies, three hinge and posts assemblies, and three rear frames. To assemble a 7-Gang Unit proceed as follows:

1. Install a hitch ball (Ref. #5 & 13) into center of two front frames and into pull tongue of tractor.
2. Install 96" tongue to tractor and two front frames (Instr. #1) by securing hitches (Ref. #4 & 12) to hitch balls (Ref. #5 & 13).
3. Line up remaining front frames one on each side of center frames.
4. Install long end of swivel hinge and rod assembly (Ref. #52) of a rear frame into center hinges of front frames.

5. Install two remaining rear frames on right and left side of center rear frame by installing the long ends of the swivel hinge rod assembly (Ref. #34) into the right hand center and left hand center hinges of the front frames.
6. Adjust all spring lever assemblies evenly and you are ready to mow.

The Blitzer 9-Gang Unit consists of a 96" (2438 mm.) Tongue, four front frames, five rod and swivel hinge assemblies, four hinge and posts assemblies, and five rear frames. To assemble a 9-Gang Unit proceed as follows:

1. Follow instructions 1 through 4 of 7-Gang Unit.*
2. Install four remaining rear frames on right and left sides of center rear frame by installing the long ends of the swivel hinge and rod assembly (Ref. #34) into right hand center and end hinges as well as the left hand center and end hinges.
3. Adjust all spring lever assemblies evenly and you are ready to mow.

LUBRICATION

The grease fittings (Ref. #35) on Swivel Hinge Rod (Ref. #34) should be lubricated with a good grade of chassis lubricant when gang mowers are assembled.

Lubricate the balls (Ref. #5 & 13) of ball hitches assembly (Ref. #4 & 12), the threads on the ball hitch adjusting handle, and the hinge rod where it passes through the hinge brackets with a good grade of winter chassis lubricant, when assembling and after every twenty-five (25) hours of operation.

IMPORTANT

To insure perfect performance of your equipment, keep it clean, properly lubricated and use standard Jacobsen repair parts.

* IMPORTANT

When assembling 5 and 9 Gang Units the left front and right rear outer rings on the front end frames must be located to the forward holes on the left side and the rear holes in the right side.

STANDARD BLITZER GANG MOWER FRAME COMBINATIONS

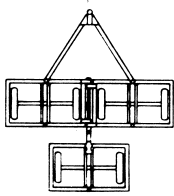

3 GANG BLITZER FRAME
7 feet 2 inches

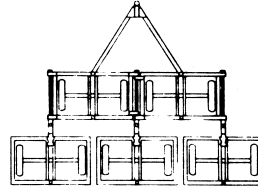

5 GANG BLITZER FRAME
11 feet 10 inches

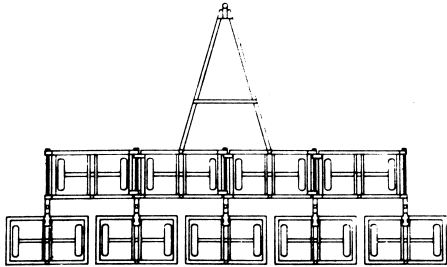

9 GANG BLITZER FRAME
21 feet 2 inches

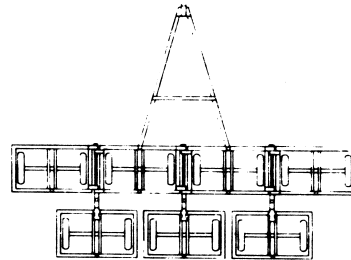

7 GANG BLITZER FRAME
16 feet 6 inches

Refer to the chart for various combinations of these Jacobsen products:

Product No. 73411 - Frame Assembly (Front & Rear)
Product No. 73413 - Rod & Swivel Hinge Assembly Complete
Product No. 73412 - Hinge & Posts Assembly (1 Pair)
Product No. 73403 - 48 inch Tongue Assembly
Product No. 73404 - 96 inch Tongue Assembly

PRODUCT NO.	PRODUCT 73411 NO. REQUIRED	PRODUCT 73413 NO. REQUIRED	PRODUCT 73412 NO. REQUIRED	PRODUCT 73403 NO. REQUIRED	PRODUCT 73404 NO. REQUIRED
73410 3 Gang	3	1	1	1	-
73420 5 Gang	5	3	2	1	-
73430 7 Gang	7	3	3	-	1
73440 9 Gang	9	5	4	-	1

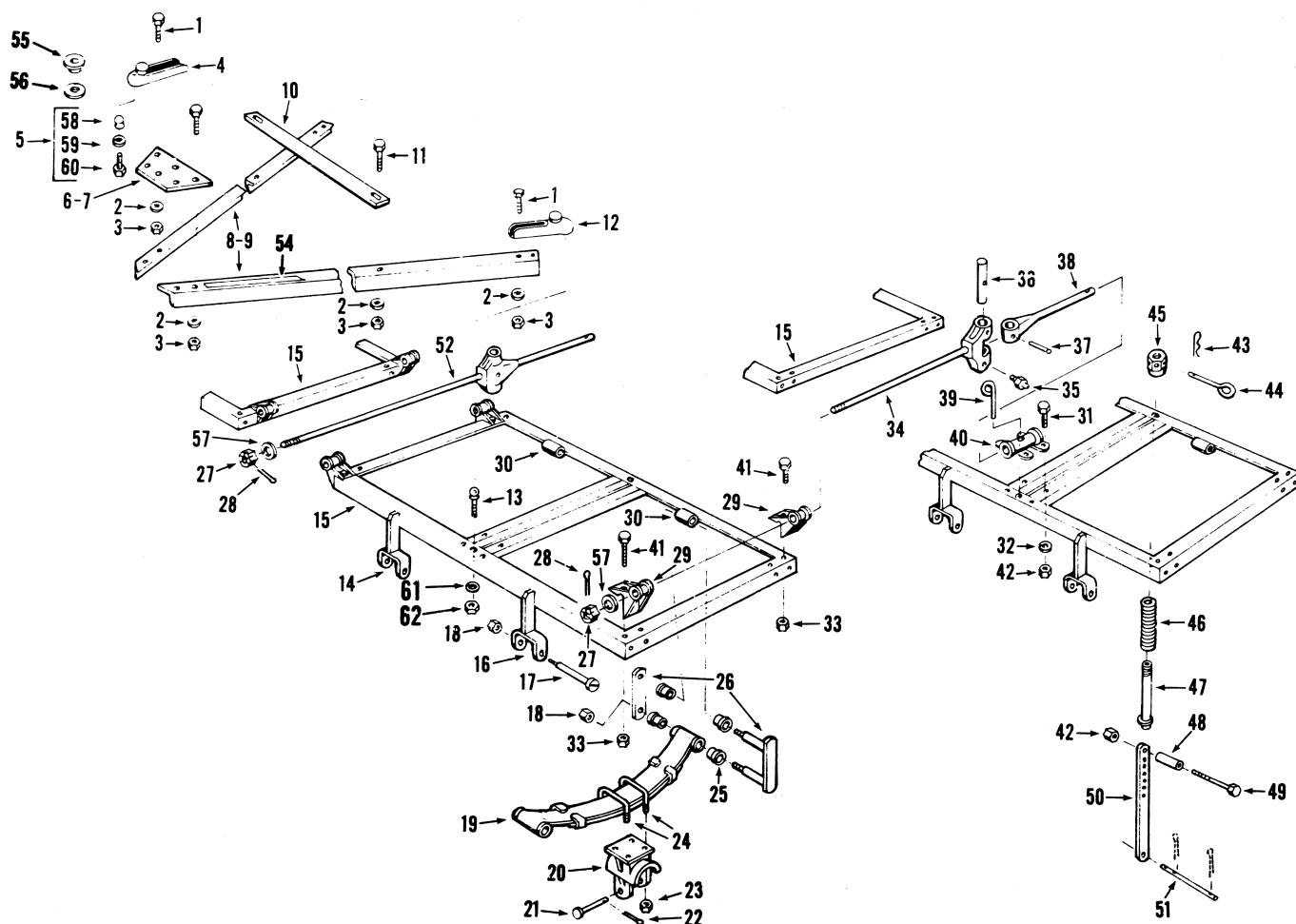

BLITZER PULL FRAMES - PARTS LIST

Ref. No.	Part No.	Quantity for No. of Gangs				Description
		3	5	7	9	
1	400610	10	10	10	10	Screw, 5/8-11 x 1-1/4 Hex Hd Cap
2	447224	10	10	12	12	Lockwasher, 5/8
3	443126	10	10	12	12	Nut, 5/8-11 Hex
4	159409	1	1	1	1	Hitch, Ball (Includes Ref. #5)
5	110466	1	1	1	1	Ball, Hitch (Incl Ref #58, 59, 60)
6	318014			1	1	Plate (96" Tongue)
7	318018	1	1			Plate (48" Tongue)
8	318013			2	2	Angle (96" Tongue)
9	318017	2	2			Angle (48" Tongue)
10	318015			1	1	Bar (96" Tongue)
11	400612			2	2	Screw, 5/8-11 x 1-1/2 Hex Hd Cap
12	131224	2	2	2	2	Coupler Assembly
13	361433	2	2	2	2	Ball, 2" Coupling
14	110041	3	5	7	9	Bracket, Front Spring, Right
15	110040	3	5	7	9	Frame, Weldment
16	110042	3	5	7	9	Bracket, Front Spring, Left
17	318005	6	10	14	18	Bolt, Front Spring
18	444730	18	30	42	54	Nut, 7/16-20 Hex
19	110024*	6	10	14	18	Spring, Leaf
20	204863	6	10	14	18	Perch, Spring

* Single or Multiple Leaf Construction available. Use in pairs; do not mix.

Ref. No.	Part No.	Quantity for No. of Gangs				Description
		3	5	7	9	
21	325390	6	10	14	18	Pin, Rod End
22	460028	6	10	14	18	Pin, 1/8 x 1 Cotter
23	444744	24	40	56	72	Nut, 3/8-24 Hex
24	318010	12	20	28	36	Bolt, "U"
25	318006	36	60	84	108	Bushing, Rubber
26	110022	6	10	14	18	Shackle, Spring,
27	445720	1	3	3	5	Nut, 1-1/8-7, Slotted Hex
28	460067	1	3	3	5	Pin, 1/4 x 2 Cotter
29	204860	4	8	12	16	Hinge, Front Frame
30	318009	6	10	14	18	Hinge, Rear Spring
31	400442	4	12	12	20	Screw, 1/2-20 x 1-1/2 Hex Hd Cap
32	446154	4	12	12	20	Lockwasher, 1/2
33	444816	8	16	24	32	Nut, 1/2-20 Hex Flex Lock
34	110028	1	3	3	5	Rod w/ Swivel Hinge, Front Section
35	471226	2	6	6	10	Fitting, 1/4 Grease
36	318019	1	3	3	5	Pin, Hinge
37	461333	1	3	3	5	Pin, 1/4 x 1-3/4 Type "E" Groove
38	110029	1	3	3	5	Rod w/ Swivel Hinge, Rear Section
39	318012	1	3	3	5	Pin, Hinge
40	204867	1	3	3	5	Hinge, Rear Frame
41	400444	8	16	24	32	Screw, 1/2-20 x 1-3/4 Hex Hd Cap
42	443120	7	17	19	29	Nut, 1/2-20 Hex
43	460316	3	5	7	9	Hairpin, Cotter
44	318001	3	5	7	9	Pin, Lock
45	358414	3	5	7	9	Nut, Adjusting Spring
46	316133	3	5	7	9	Spring
47	110031	3	5	7	9	Tube, Outer
48	319873	3	5	7	9	Handle, Spring Lever
49	400456	3	5	7	9	Screw, 1/2-20 x 4 Hex Hd Cap
50	325296	3	5	7	9	Lever, Spring
51	316478†	3	5	7	9	Rod, Spring Lever to Skid
52	110032	1	3	3	5	Swivel Hinge & Rod (Incl. Ref. #27, 28, 34 thru 38)
53	110030	3	5	7	9	Spring Lever Assem (Incl Ref. #42 thru 51)
54	336940	2	2	2	2	Decal, Jacobsen
55	110068	1	1	1	1	Adapter, Ball Hitch
56	325406	1	1	1	1	Washer, Ball Hitch
57	325262	3	9	9	15	Washer, Special
58	352786	1	1	1	1	Ball Hitch
59	445166	1	1	1	1	Lockwasher, 5/8 Hvy
60	400620	1	1	1	1	Bolt, 5/8-11 x 2-1/2 Hex Hd
61	446178	2	2	2	2	Lockwasher, 3/4 Hvy
62	443130	2	2	2	2	Nut, 3/4-10 Hex

† Furnished with Blitzer Mowers.

HOW TO ORDER REPAIR PARTS

This manual is an operating and service guide for the owner. We recommend that you read it carefully before operating your vehicle and that you follow the simple adjustments and maintenance listed. We do not recommend that you make major repairs beyond necessary adjustments and simple parts replacements required to keep your unit in good operating condition.

For assistance in getting the most out of your unit, and for overhaul, winter or summer storage, tune-up, and repair service, we recommend your Authorized Jacobsen Turf Equipment Distributor, who is prepared to help you.

To eliminate error and speed delivery:

1. Write your NAME and ADDRESS on your order plainly.
2. Explain WHERE and HOW to make shipment.
3. Give PRODUCT NUMBER, NAME, and SERIAL NUMBER that is stamped on the NAME PLATE or SERIAL PLATE of your product.
4. Order by QUANTITY DESIRED, the PART NUMBER, and the DESCRIPTION OF PART.
5. Send your order to or visit your nearest AUTHORIZED JACOBSEN TURF EQUIPMENT DISTRIBUTOR.
6. INSPECT ALL SHIPMENTS ON RECEIPT. If any parts are damaged or missing, file a claim with the carrier before accepting.
7. Do not return material to your nearest AUTHORIZED JACOBSEN TURF EQUIPMENT DISTRIBUTOR without a letter of explanation. Make a list of all returned parts, show your name and address, and include it with the shipment. TRANSPORTATION CHARGES MUST BE PREPAID.

JACOBSEN **TEXTRON**

Jacobsen Division of Textron Inc.