



Ora 3/16" Radius *Full-Wrap Pencil Edge*

Ora takes authentic natural surface beauty further than ever, adding a pencil-line edge—exclusive to VT—around both the top and bottom edges of the countertop. The full-wrap design serves up a clean and distinctive look. Combining stunning natural surface style with the low maintenance and affordability of laminate, the Ora edge and VT Dimensions help take your kitchen remodeling dollars further.

Expect More from VT Dimensions

Bring together modern style, intriguing depth, and the seamless edge you want with the beautifully contoured look of VT Dimensions countertops.

Beyond the beauty, you'll have the assurance of knowing VT fabricates the whole countertop from top to bottom—not just the laminate surface—for consistent quality and service. And you get a 1-year warranty you can count on.

One source. Many beautiful looks. Only from VT.



Edge: Ora
Laminate: Walnut Heights
Wilsonart® 7965-12

Specifications

- Standard substrate is $\frac{3}{4}$ " industrial-grade particleboard, available in 8', 10', and 12' lengths
- Standard postformed-grade laminate with a thickness of $0.042" + 0.002" - 0.008"$
- Both standard and special styles and sizes are suitable for all residential, commercial, institutional, or light-industrial applications
- Available surfaced with Formica®, Nevamar®, Pionite®, and Wilsonart® laminate
- Available as an environmentally friendly EQcountertop
- Not available surfaced with solid color laminates

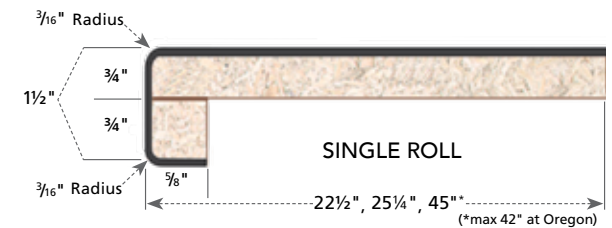
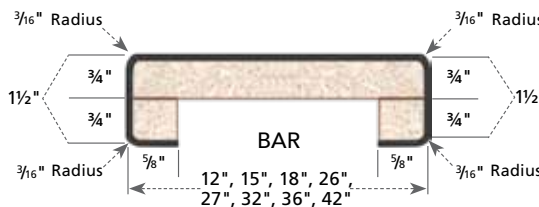
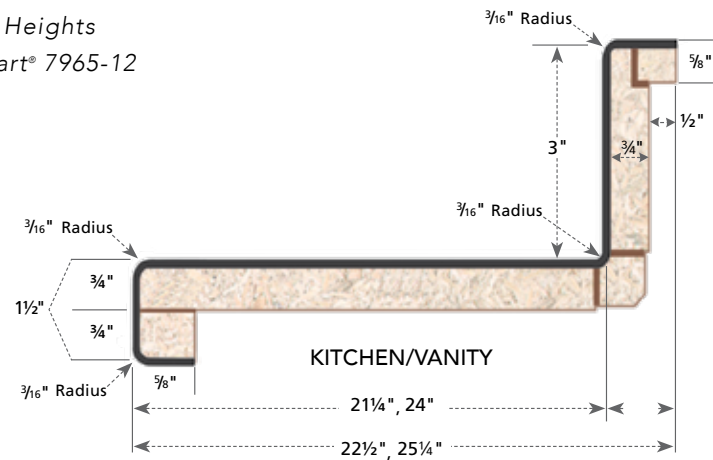

All measurements in inches. Drawings not to scale.



VTDimensions.com | 1-888-287-8356
1000 Industrial Park | P.O. Box 490 | Holstein, IA 51025

©2019 VT Industries, Inc. All rights reserved.
NPOA 0119

