



TEXAS GENERAL LAND OFFICE  
COMMISSIONER DAWN BUCKINGHAM, M.D.

**NOTICE OF NON-COMPLIANCE**

Certified Mail No. 7015 0640 0001 2131 5505  
Return Receipt Requested

Mr. & Mrs. Kevin C. & Lucinda M. Henry

[REDACTED]  
Brazoria, TX 77422-6844

RE: Coastal Public Lands Instrument No. LPO53417  
San Bernard River, Brazoria County, Texas

Dear Mr. & Mrs. Henry:

YOU ARE HEREBY GIVEN NOTICE that the below-described facility or structure is not in compliance with §51.302 of the Texas Natural Resources Code (“TNRC”), which requires that owners or possessors of facilities and structures on State land obtain an easement, lease, permit or other instrument for the land on which the facility or structure is to be constructed or located:

**FACILITY OR STRUCTURE:** A residential wood piling pier consisting of an 18' x 23' dock, an 11' x 18' covered boatlift, a 5' x 11' dock, a 4' x 23' walkway, and two (2) 1 square foot wood pilings comprising a total project encumbrance of 761 square feet of coastal public land

**LOCATION:** [REDACTED]

**NATURE OF NON-COMPLIANCE:** Failure to return application

THIS NOTICE OF NON-COMPLIANCE is intended to give you the opportunity to bring the above facility or structure into compliance, within thirty (30) days after this notice is served. In the event compliance is not accomplished within the above time period, or as extended, in writing, by the General Land Office for good cause shown, the Land Commissioner may begin proceedings, pursuant to §51.3021 of the TNRC, by serving upon you a NOTICE OF VIOLATION to obtain remedies including penalties of not less than \$50 or more than \$1000 a day for each day that a violation occurs and/or removal of the facility or structure by the Land Commissioner and liability for the costs of removal.

To avoid the commencement of proceedings under §51.3021 of the TNRC, you should immediately contact Natasha Howard at (281) 471-0391 x108 in order to obtain the information necessary to seek compliance with the statutory requirements.

*Dianna L Ramirez*

Dianna Ramirez

Upper Coast Regional Manager, Coastal Field Operations

09/16/2024

Date



**STATE OF TEXAS  
GENERAL LAND OFFICE  
RESIDENTIAL APPLICATION**

FOR GLO USE

Working File #

LPO53417

Initials

NH

**APPLICANT**

Applicant Name:

Kevin C. & Lucinda M. Henry

Entity Contact:

Cell Phone:

Email Address:

Fax:

Home Phone:

Work Phone:

Mailing Address:

City, State, Zip:

**AGENT** (only complete if authorizing agent to obtain authorization on your behalf)

Agent Name:

Mailing Address:

Email Address:

Business Phone:

Cell Phone:

**LAND/PROJECT**

I currently own this property

Date of Purchase:

Name(s) of previous owner(s):

Please indicate if an owner of the property is 65 or older

Real Estate Agent/Contractor acting on behalf of the owner or purchaser

Name/Address of adjacent property owner(s):

Commercial construction or activity

Homeowners Association

Property is leased as a vacation rental (daily/weekly/monthly)

Name/Address of adjacent property owner(s):

Structure is existing, I am proposing modifications at this time

Structure is existing, I am not proposing modifications at this time

Current COE Permit # (if known):

Current GLO ID (if known):

SP20140377

Site Address:

Legal Description and/or Parcel ID:

Waterbody:

County:

Type(s) of Structure(s)

Proposed

Existing

Pier

Dock

Boat Lift

Walkway

Rip Rap

Other

Description of Structure:

I HEREBY ATTEST THAT THE FOREGOING INFORMATION IS TRUE AND CORRECT.

Signed By (Property Owner - required)

Date

Signed By (Agent - if applicable)

Date

PLEASE ANSWER QUESTIONS BELOW AND RETURN WITH YOUR APPLICATION



San Bernard River

Does the existing structure remain the same as on this drawing? Yes / No

If no, please draw any changes on this drawing.

Are you proposing to make any changes at this time? Yes / No

If yes, you may indicate those changes on this drawing.

Is this property being used for commercial purposes? Yes / No

Is this property being used as a vacation rental? Yes / No

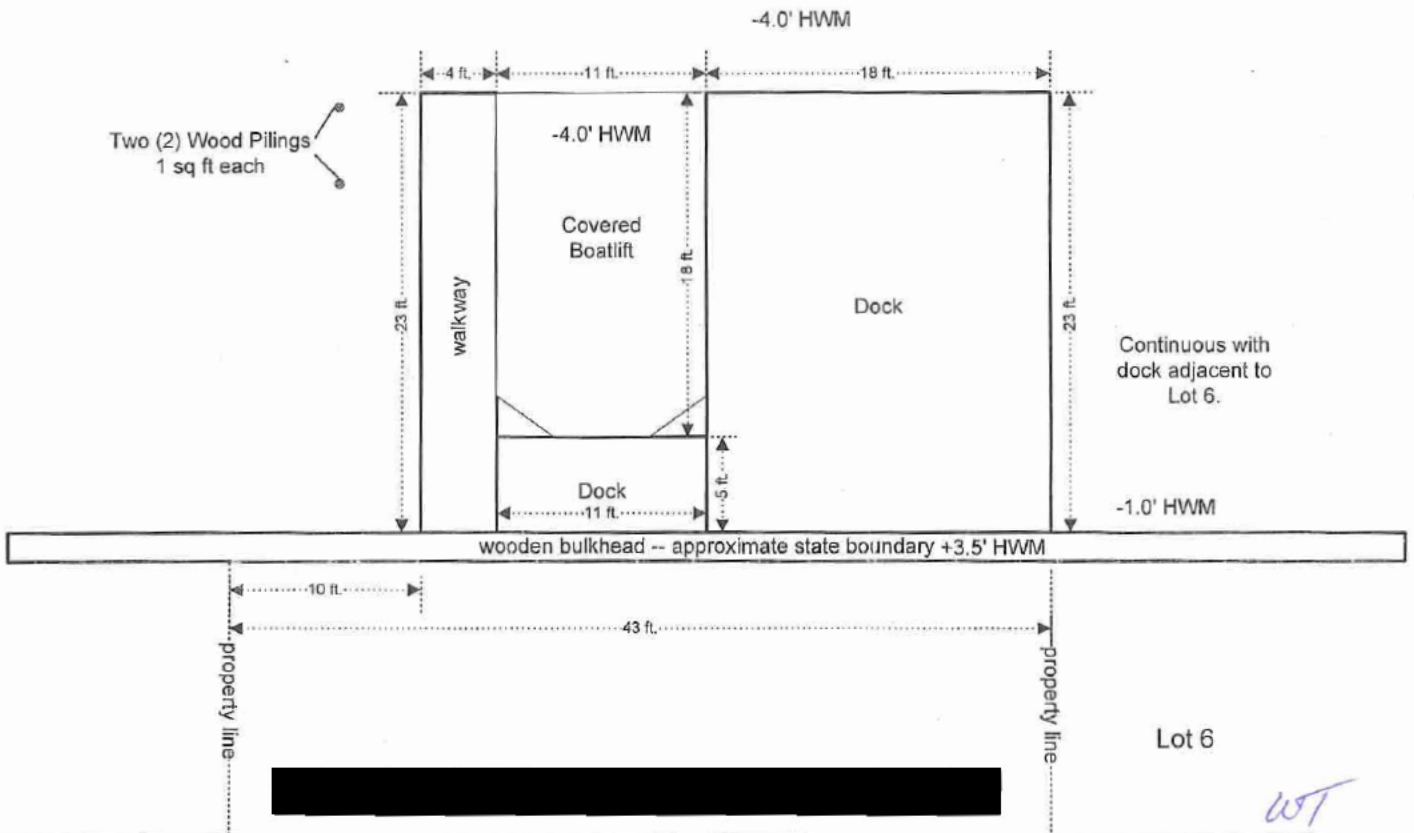

Title: [REDACTED]

Date of Inspection: 05/19/2014

Company: General Land Office

Creator: JHernandez

Scale: 1 inch equals 10 feet

Attachment B

---

## Property Details

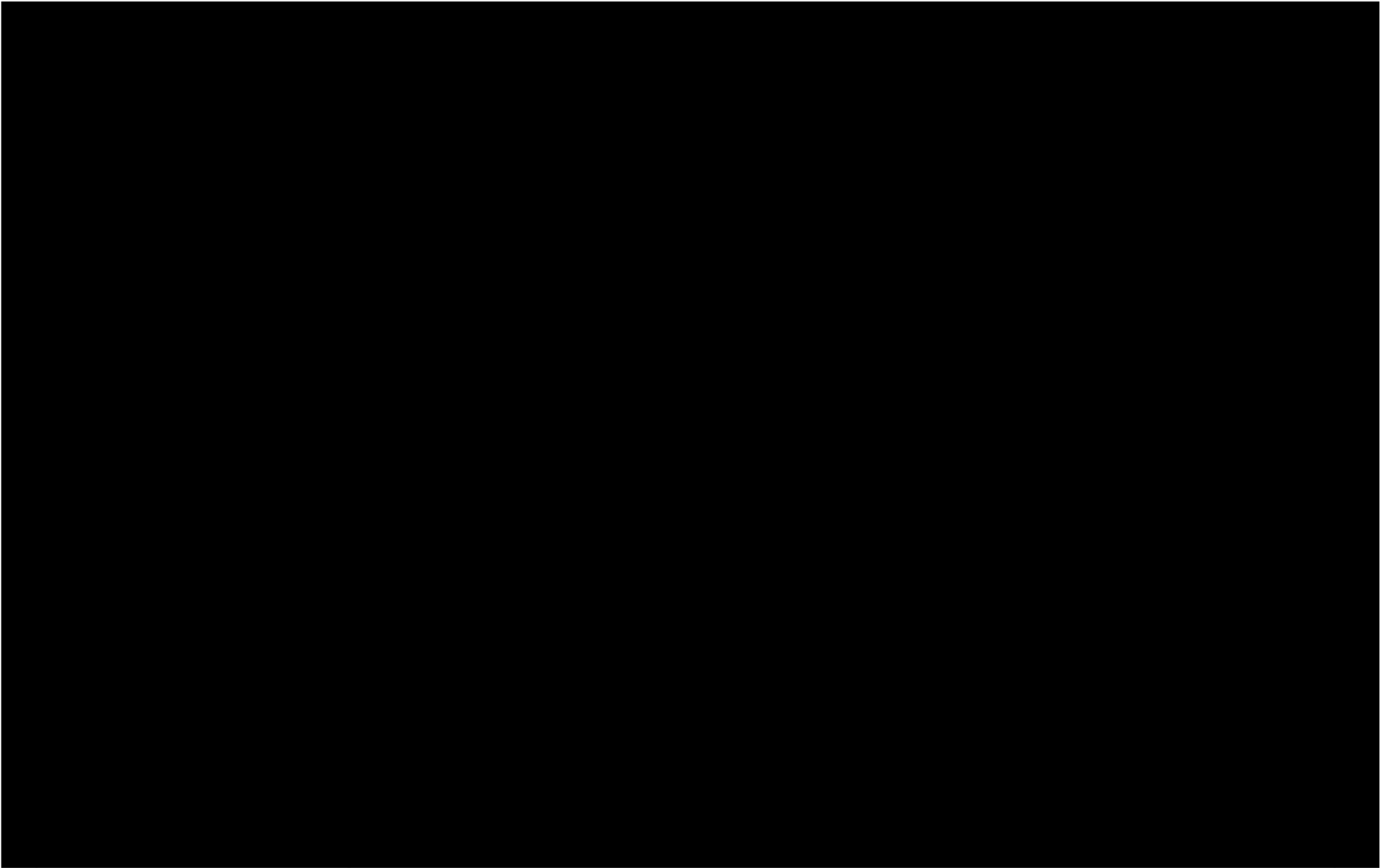

<b>Exemptions:</b>	For privacy reasons not all exemptions are shown online.

---

## Property Values

