

First... *relax!* This is a simple project. It may seem daunting now, but I have walked hundreds of folks through this process and they all found the process easier than they originally anticipated.

Who, What, How, When, etc.

Who: You will likely need a plumber and a granite fabricator. If you are not comfortable taking measurements, you might solicit a friend that is. I am always available over the phone to help you with easy ways to take measurements.

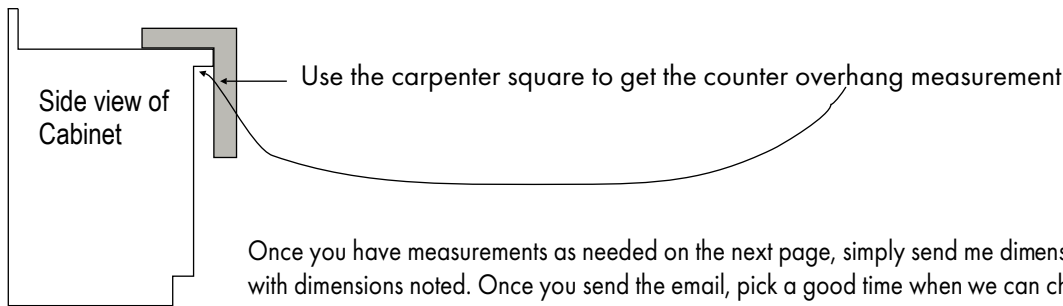

Once you have measurements as needed on the next page, simply send me dimensions. Just list A through G with dimensions noted. Once you send the email, pick a good time when we can chat on the phone and call me at 407-880-6903. We should be able to build a sink together online and obtain an exact delivered investment cost.

How: If you would like to go forward, I will draw up the sink with all dimensions, send it to you so you can lay out the sink on the counter using the tape mentioned above. Double check everything, then email back indicating drawings are approved. Once you do that, I put the sink in production.

When: Once you receive and inspect the sink, line up your plumber for first thing one morning and have the granite cutter come after about an hour. Have the plumber come back early afternoon and you should have a working sink for dinner!

The countertop in front of the original under mount sink was severely cracked. There were cracks behind the sink as well. This required the new sink to reach the backsplash. The project started at 7:30am and was finished by 3:30pm



Rachiele.
CUSTOM SINKS
Sinks that make sense® | USA | 1999

Information needed for a top mount retrofit patented design farmhouse sink

Note: No cutting of the cabinet is required!

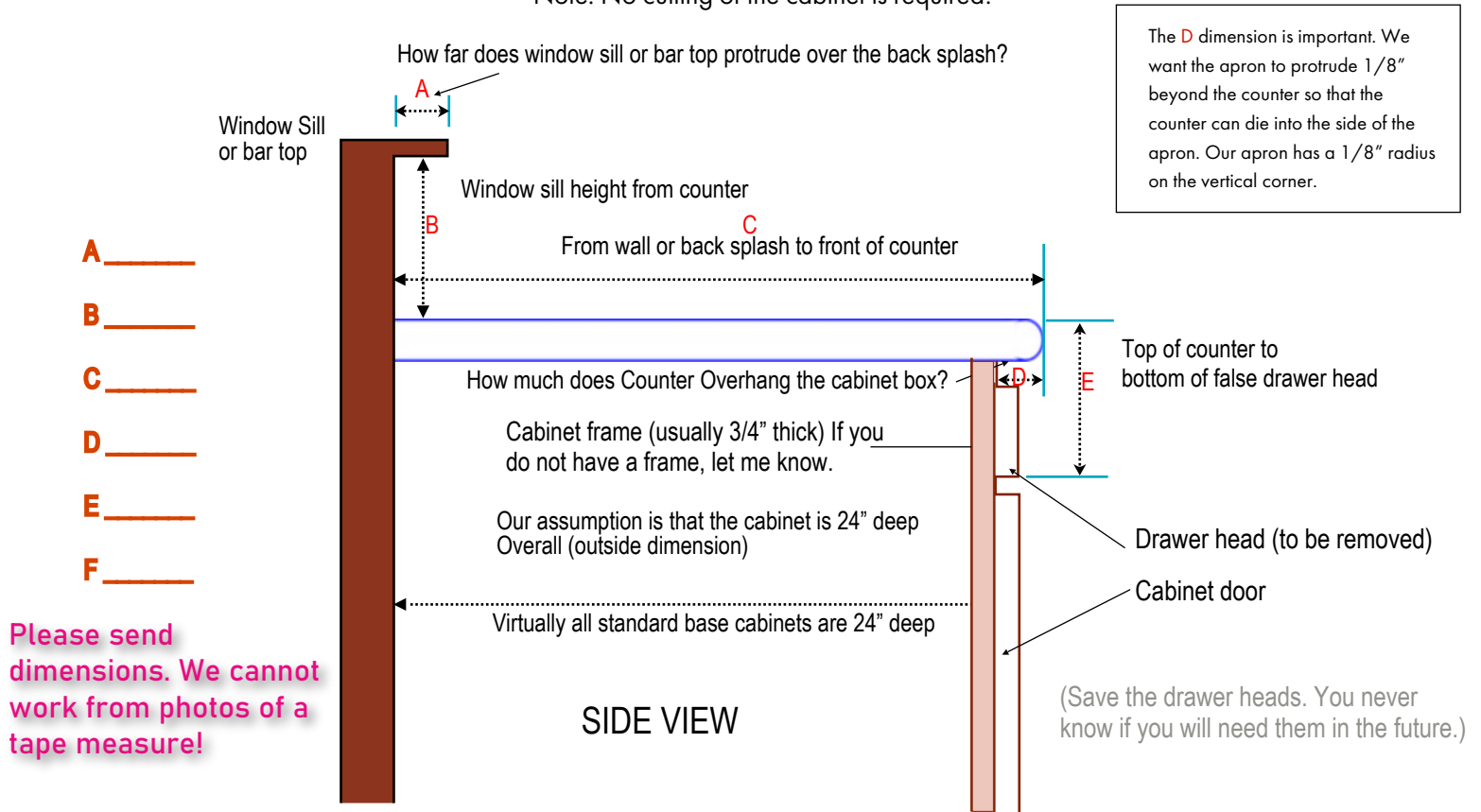

The **D** dimension is important. We want the apron to protrude 1/8" beyond the counter so that the counter can die into the side of the apron. Our apron has a 1/8" radius on the vertical corner.

If you are wanting your sink to go all the way back to the wall or backsplash, make sure you take the "C" and "D" measurements in three locations - right side, left side and middle. There is often a variation in dimensions here.

Apron of your sink will be the exact length of the overall length of the doors below (G). The Apron height will be (E) plus 1/16" - which is due to the fact that our drop-in sinks sit 1/16" above the counter top.

I need to know if your cabinet is a framed or frameless cabinet. A framed cabinet has rails and stiles. A frameless cabinet has no face frame. The sides of the cabinet are all you will see. A key way of knowing which you have is how the hinges attach. If they attach to the side of the cabinet instead of the front frame. Generally frameless cabinets have a white interior.

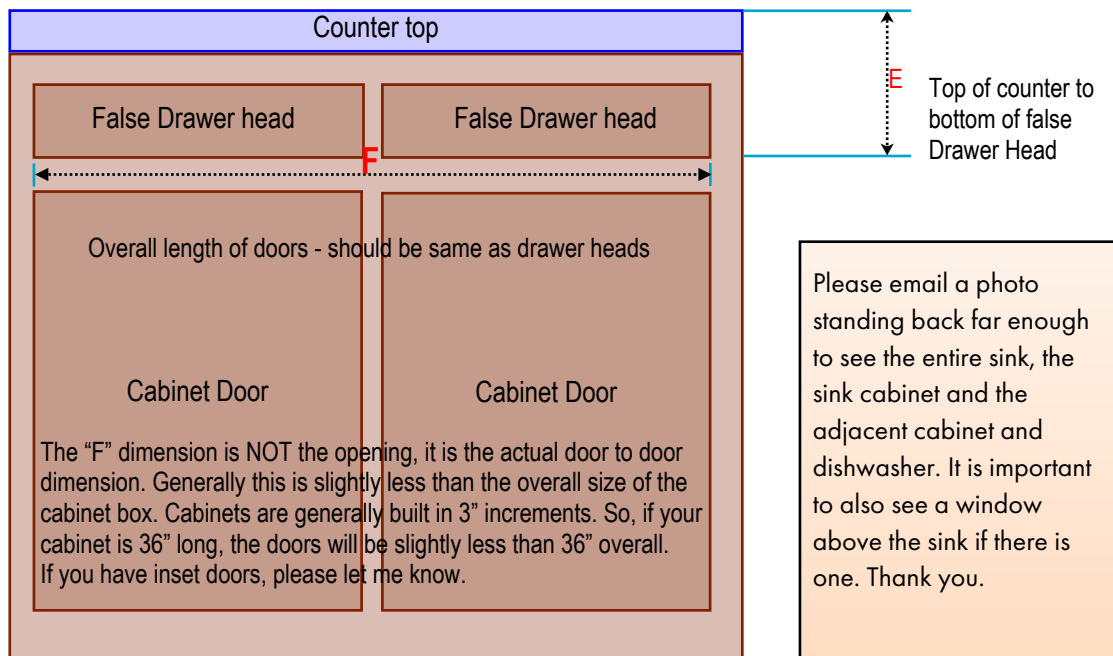

FRONT VIEW



IMPORTANT

General instructions for cutting the countertop for a top mount retrofit apron front farmhouse sink.

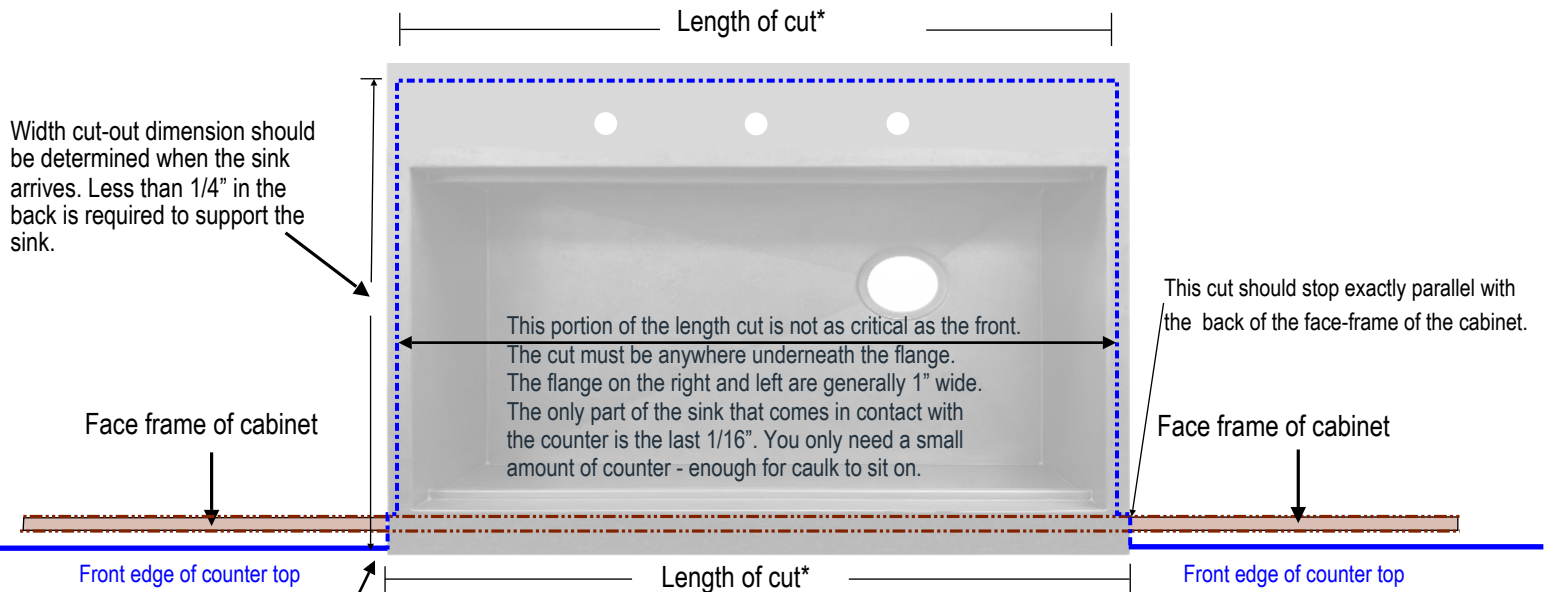

*Length of cut is critical. It should be just slightly larger than the width of the **apron portion of the sink**. You might want to use some form of protection over the granite on each side when you drop the sink in place. You don't want to scratch the sides of the apron when installing. If you are installing one of our copper sinks, this area should be caulked with our color matched caulk after installing.

Note: Do not use tape on the apron of the sink. You may damage the finish. Tape can be used on the cut edges of the countertop where the apron will be slid into place.

Feel free to call me any time if you have questions. 407-880-6903 Dino Rachiele

Please note: All cutting should be done **after** the sink has arrived and has been inspected for any damage.

Note: This is proprietary information and is not be shared beyond the scope of your project with Rachiele, LLC without the permission of Rachiele, LLC

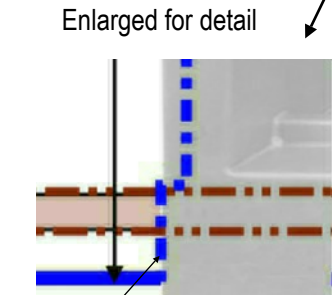

Initial cut, just large enough to drop in sink. Once you are past the face-frame, jog inward so that you are under the flange. The only part of the flange that requires support is the last 1/16" of an inch. Cut anywhere under the 1" wide flange.

Interface of sink with countertop

