

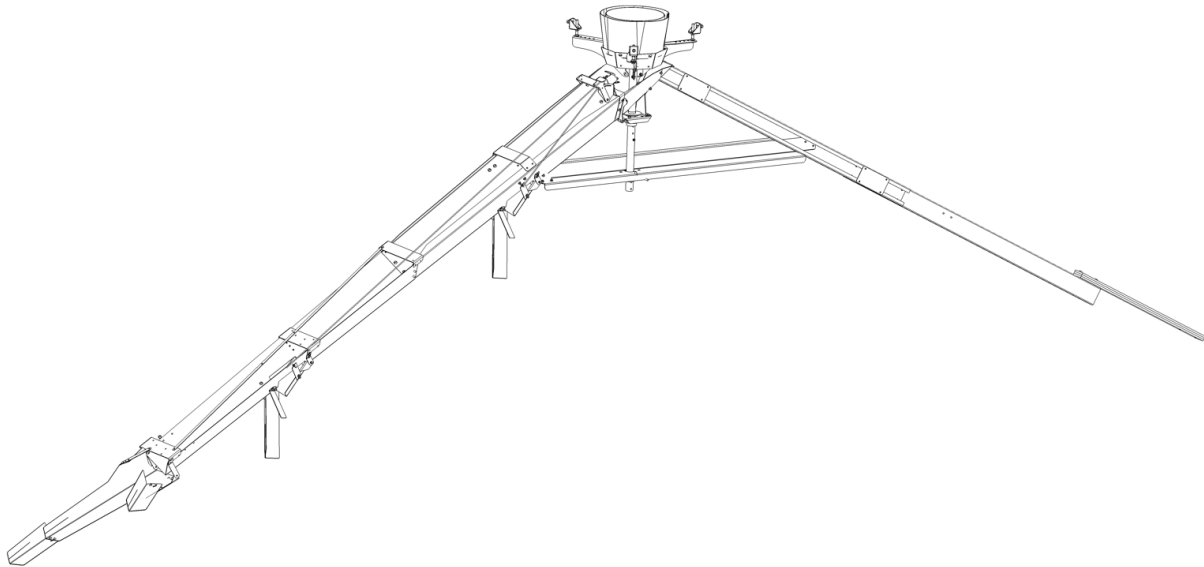

Cornado[™]
(Model 300T)



****READ COMPLETE MANUAL BEFORE STARTING TO MAKE SURE YOU ARE AWARE OF YOUR SPECIFIC MODELS/OPTIONS REQUIREMENTS DURING ASSEMBLY****

*For more information/VIDEOS, please visit our website: **cornadograinspreader.com***

MODEL NUMBERS AND OPTIONS:

Model 300T: Grain Spreader for Grain Bins 54'- 72'

Approximate Dimensions for Reference Purposes only:

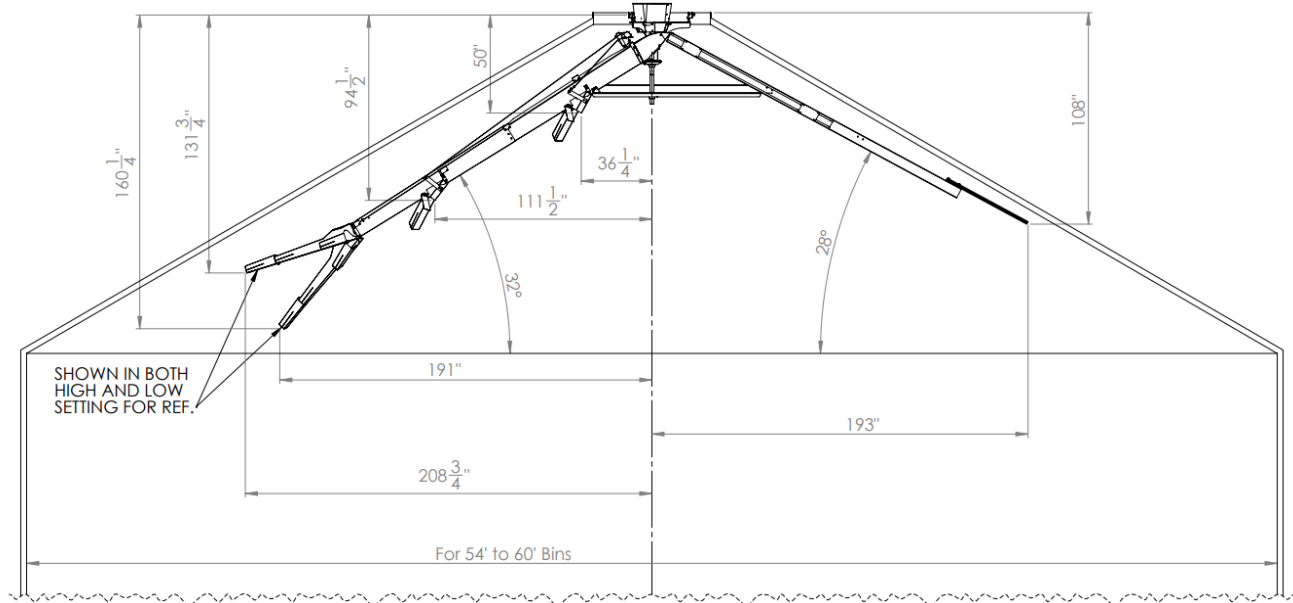

STEP 1:

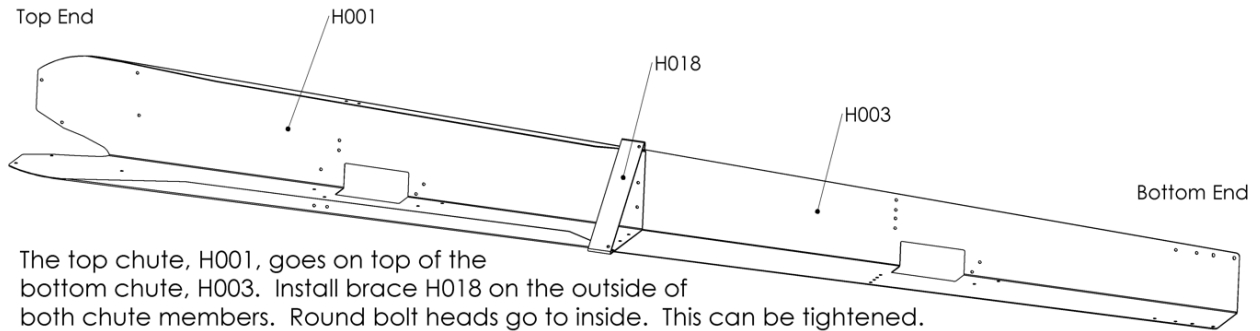

STEP 2:

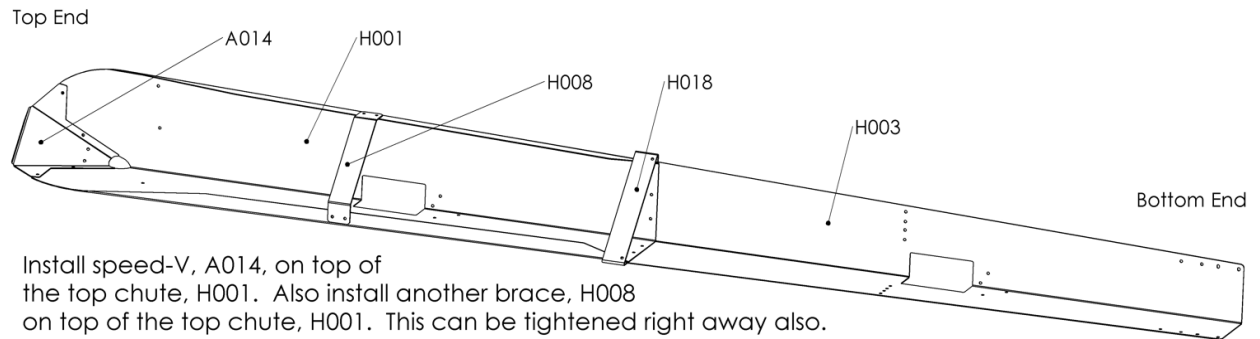

STEP 3:

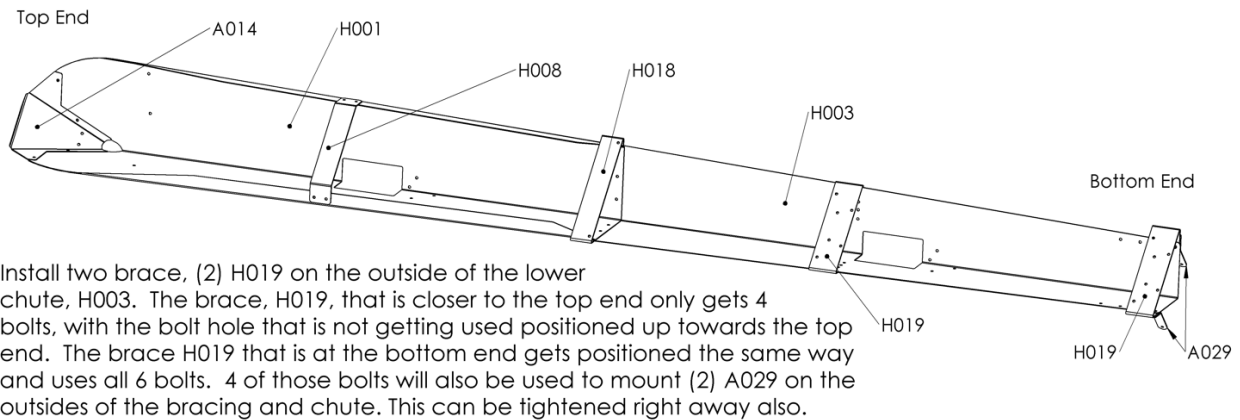

STEP 4:

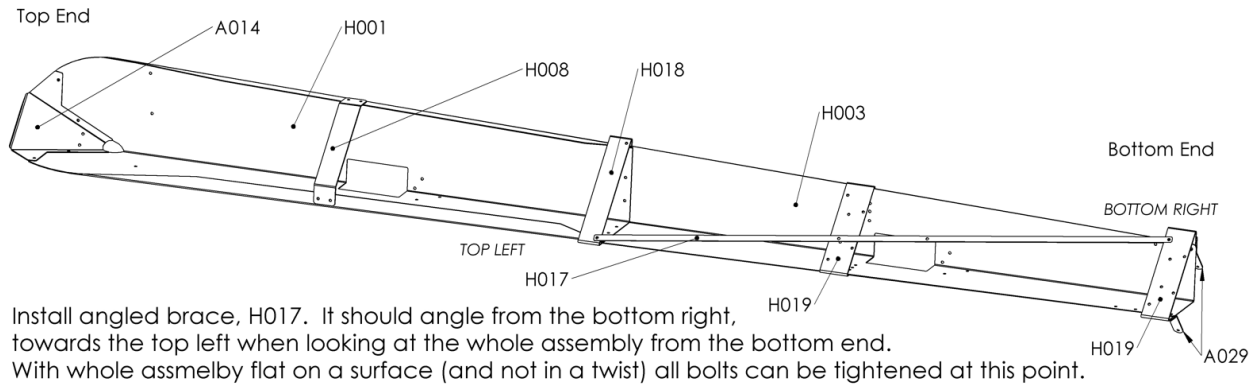

STEP 5:

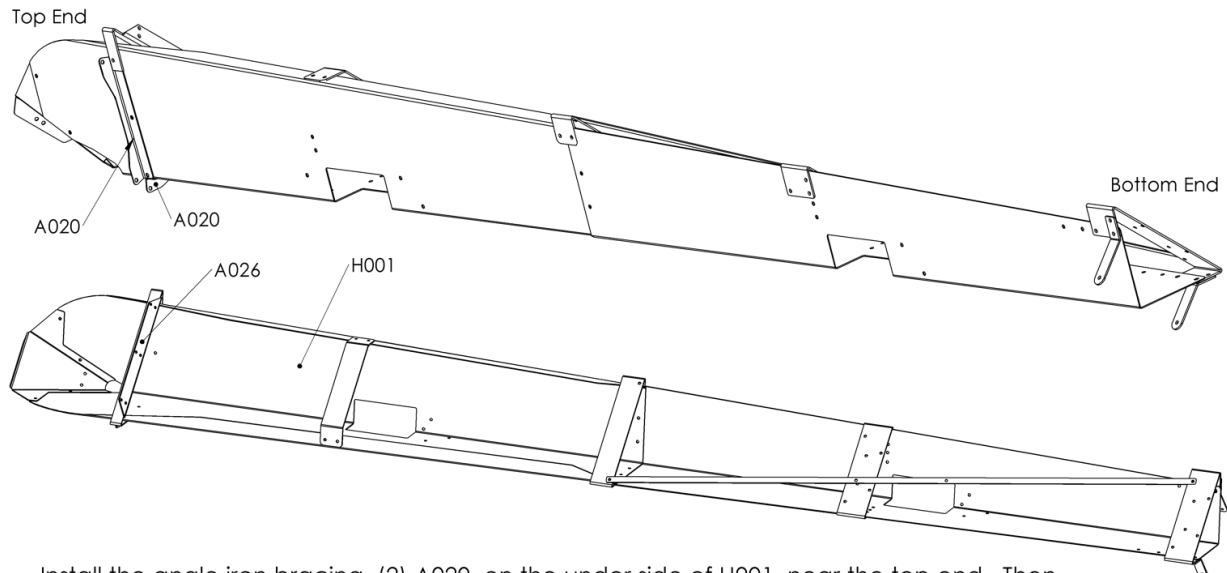

STEP 6:

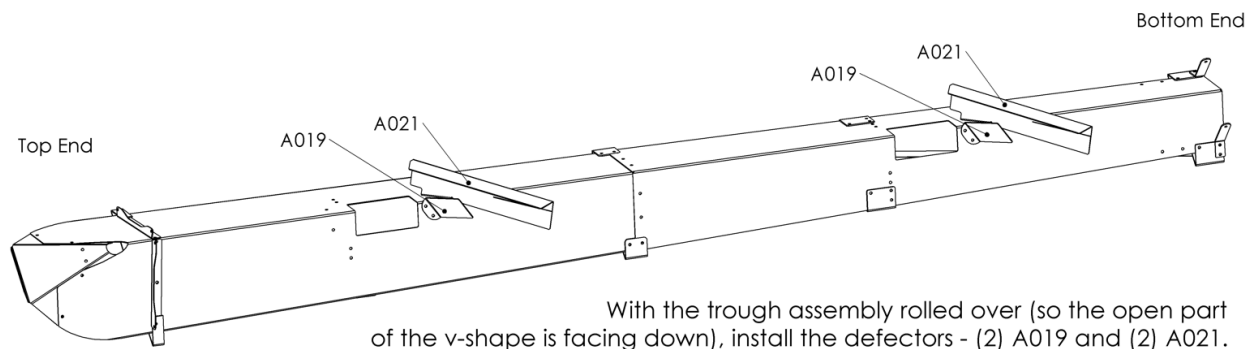

STEP 7:

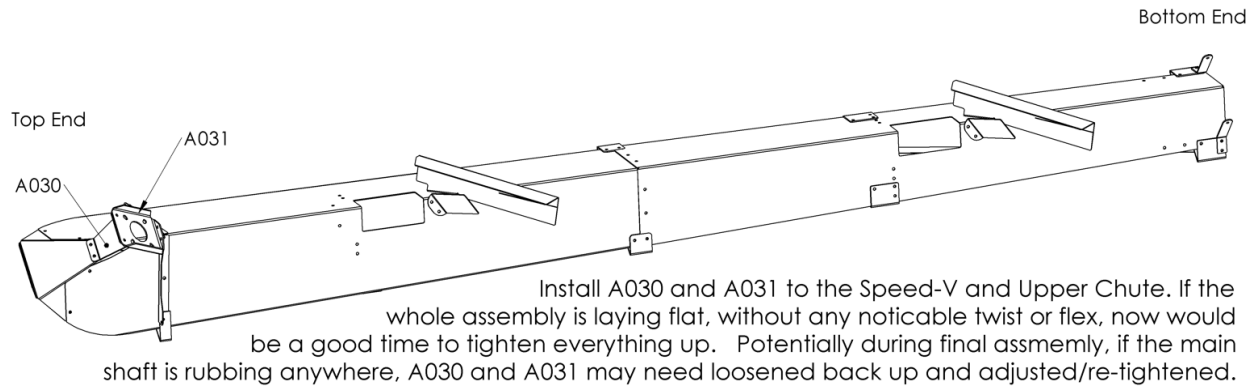

STEP 8:

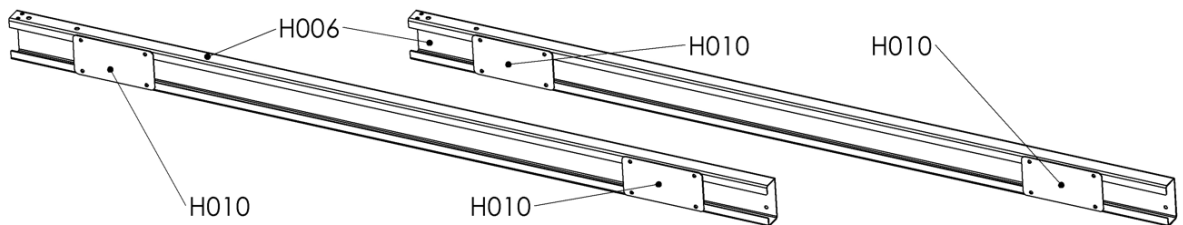

STEP 9:

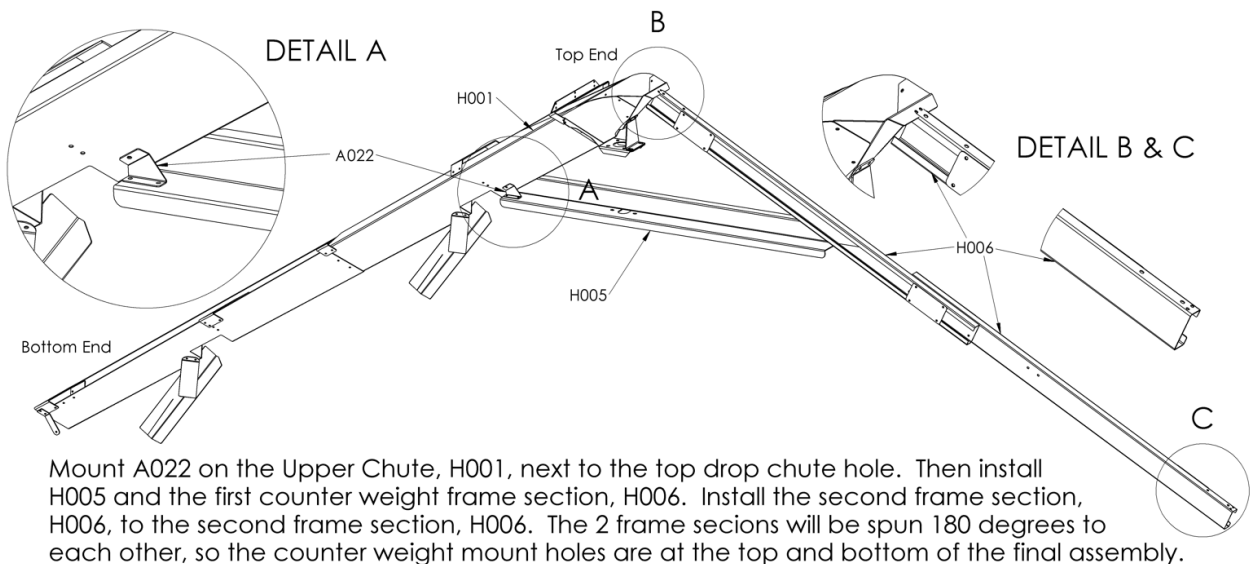

STEP 10:

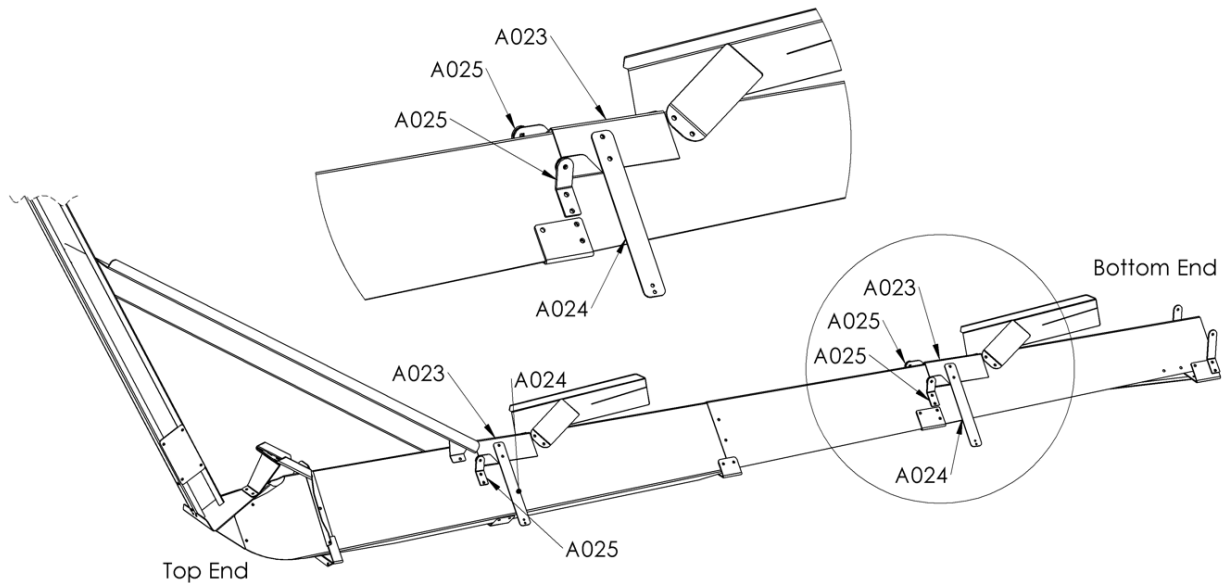

Fasten the drop door ears, (4) A025, to the v-chutes. Two sets installed by each hole. Install each drop door lever arms, A024, onto each drop doors, A023. Then attach the drop doors, A023, to the ears, using the 3/8" carriage bolts and washer provided. Tighten the carriage bolts so the doors are snug, but can still freely pivot on the carriage bolt.

STEP 11:

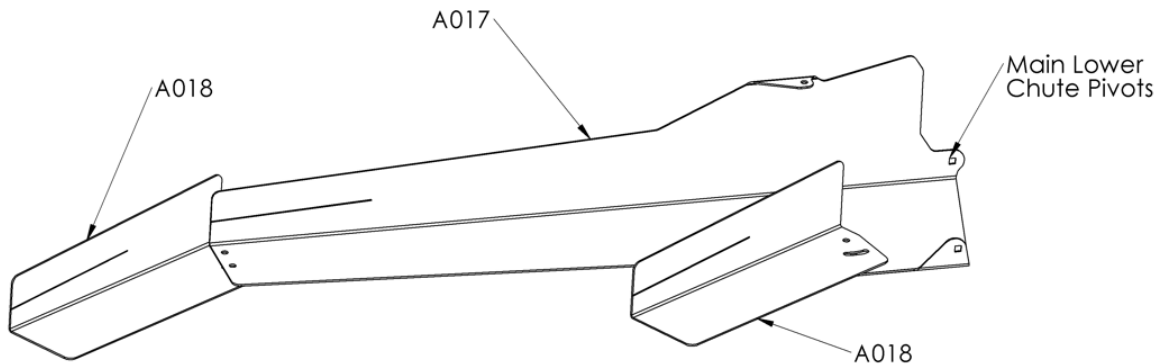

Install the lower deflector plates, (2) A018, to the lower adjustment chute, A017. The deflector plate further from the main lower chute pivots mounts under the chute, and the deflector plate closer to the main lower chute pivots goes on top of chute.

Angle and placement of the adjustment chutes will vary based on unload rates, moisture, type of grain, and diameter of bin. Generally speaking, faster flowing grains and smaller diameter bins will want more angle on the deflectors, and slower flowing grains and larger diameter bins will less angle on deflectors. As bins fill you will quickly notice where too much flow is or more flow is needed. Make notes to fine tune adjustments for the next season. Fines and debris will still be spread evenly throughout the bin, but it may not fill as level until this is set properly.

STEP 12:

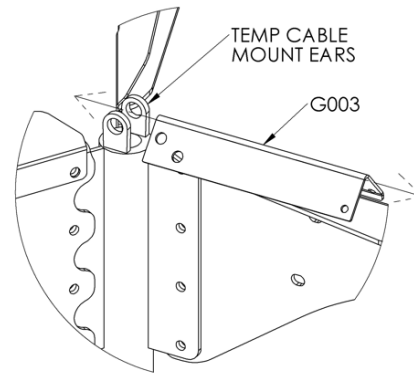
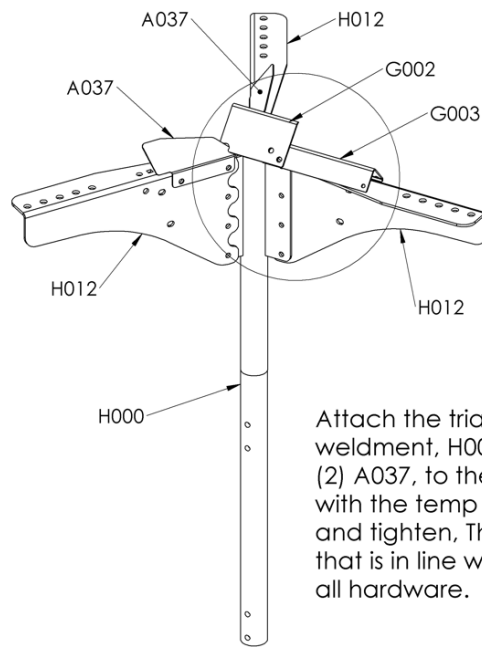

Attach the triangle mounts, (3) H012, to the main shaft weldment, H000. Next, install the grain deflectors, (2) A037, to the two triangle mounts that are not inline with the temp cable mount ears. Attach G002 to G003 and tighten, Then install G003 onto the triangle mount that is in line with the temp cable mount ears. Tighten all hardware.

STEP 13:

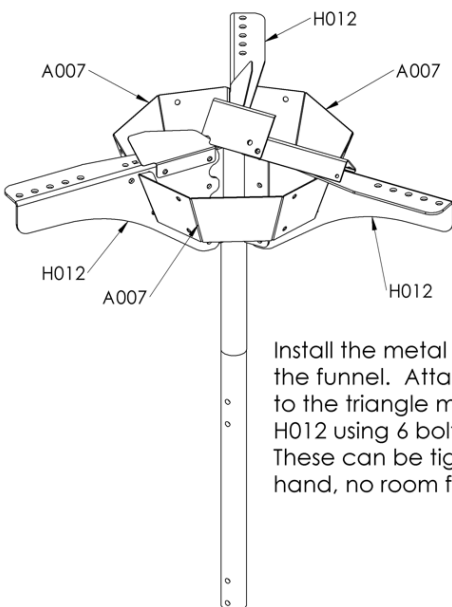

Install the metal portion of the funnel. Attach (3) A007 to the triangle mount plates, H012 using 6 bolts all around. These can be tightened (by hand, no room for impact).

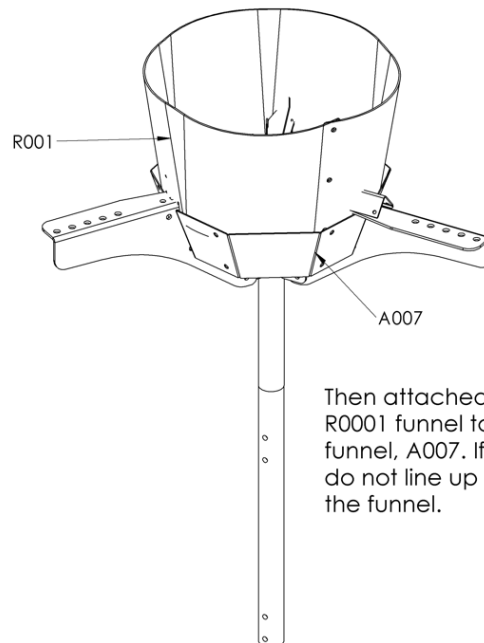

Then attached the rubber, R001 funnel to the metal funnel, A007. If the holes do not line up right, invert the funnel.

STEP 14:

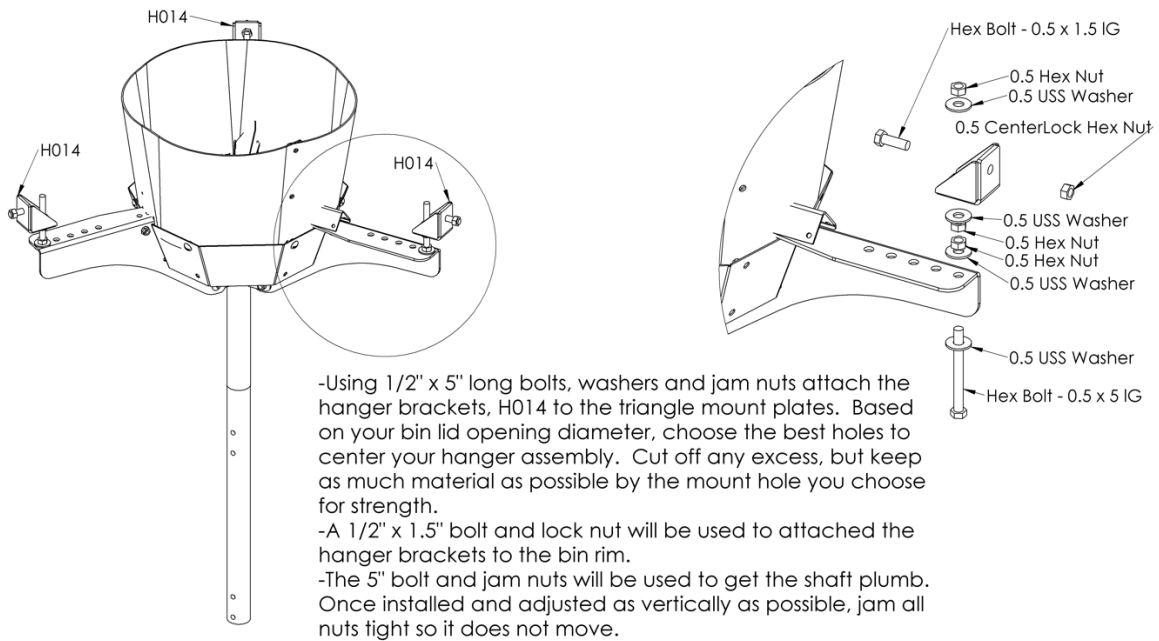

STEP 15:

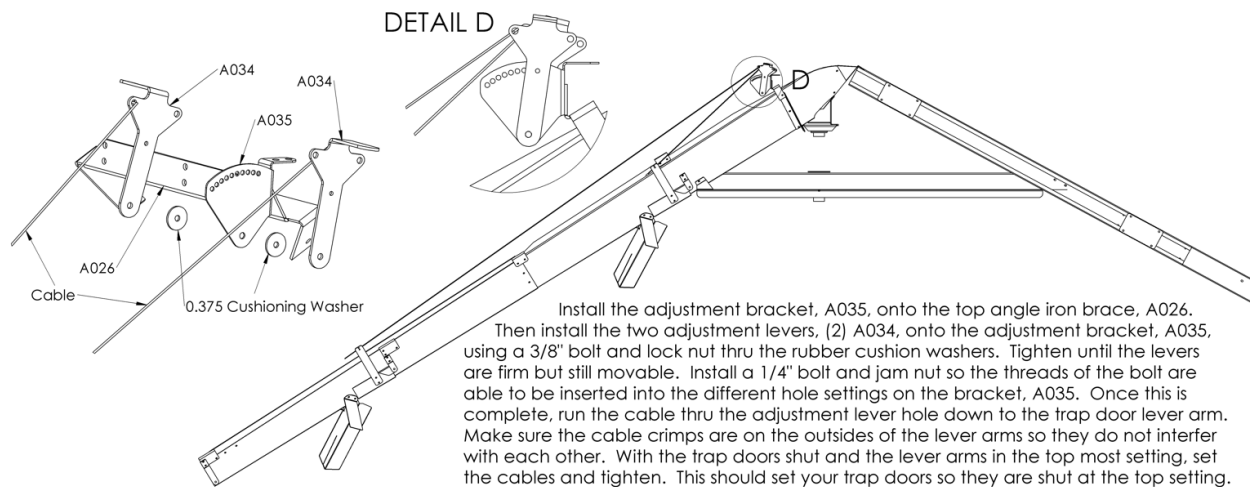

STEP 16:

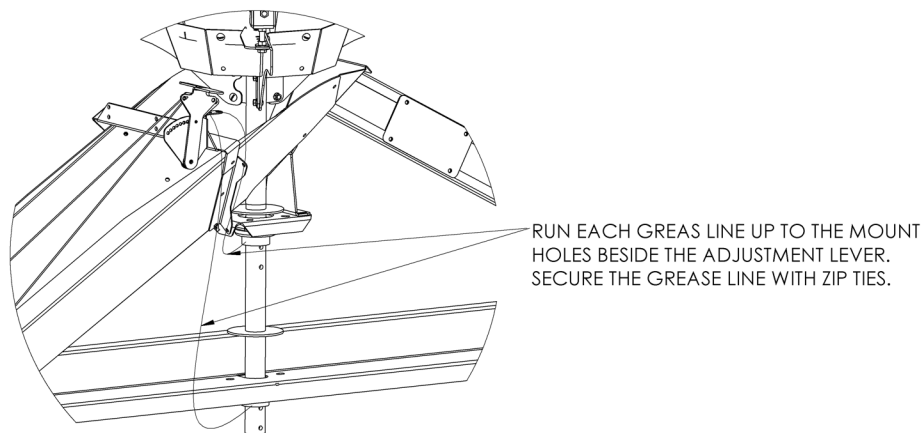
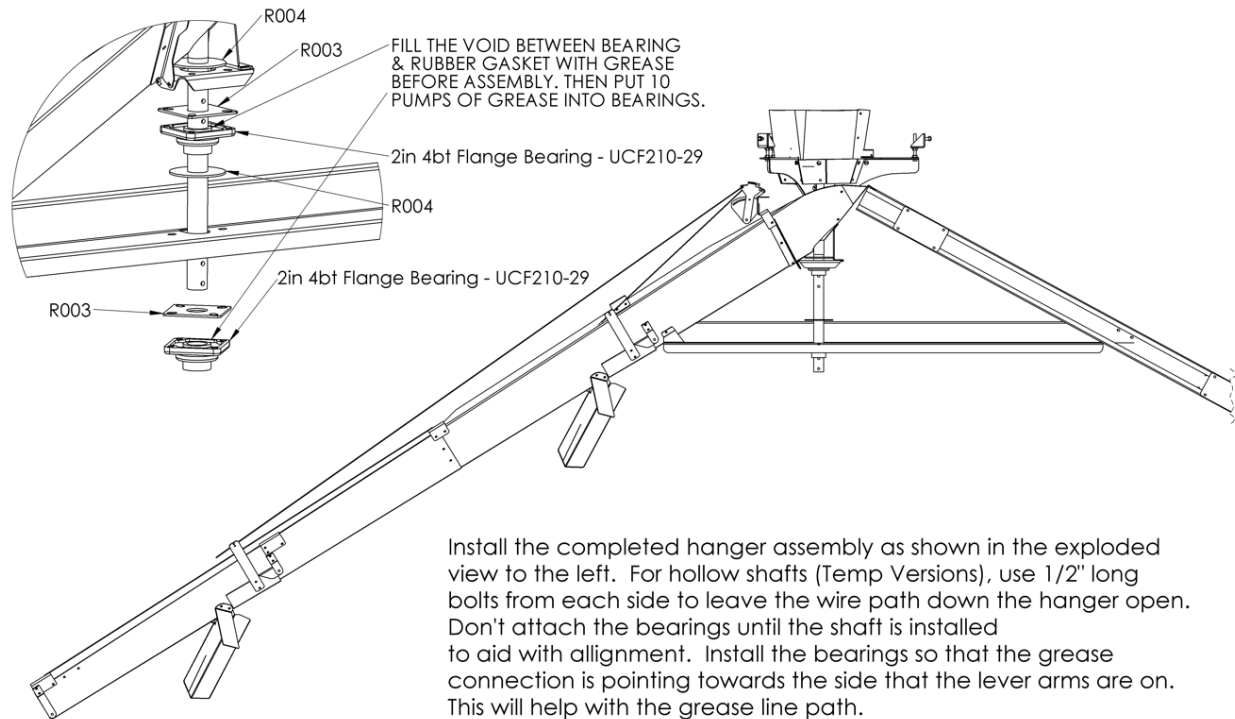

****INITIAL GREASING****

Fill each void above the bearings and below R003 with grease before assembly. Then put 10 pumps of grease into the bearings after assembly.

****MAINTENANCE GREASING****

Each time the bin is re-filled, add an additional 10 pumps of grease to each bearing.

Step 17:

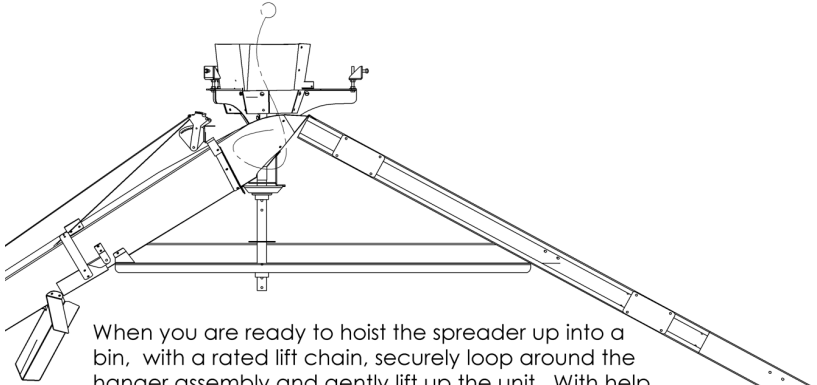

When you are ready to hoist the spreader up into a bin, with a rated lift chain, securely loop around the hanger assembly and gently lift up the unit. With help, watch both ends carefully as you lift to ensure nothing gets bent or in a bind while getting the spreader into the hanging position.

STEP 18:

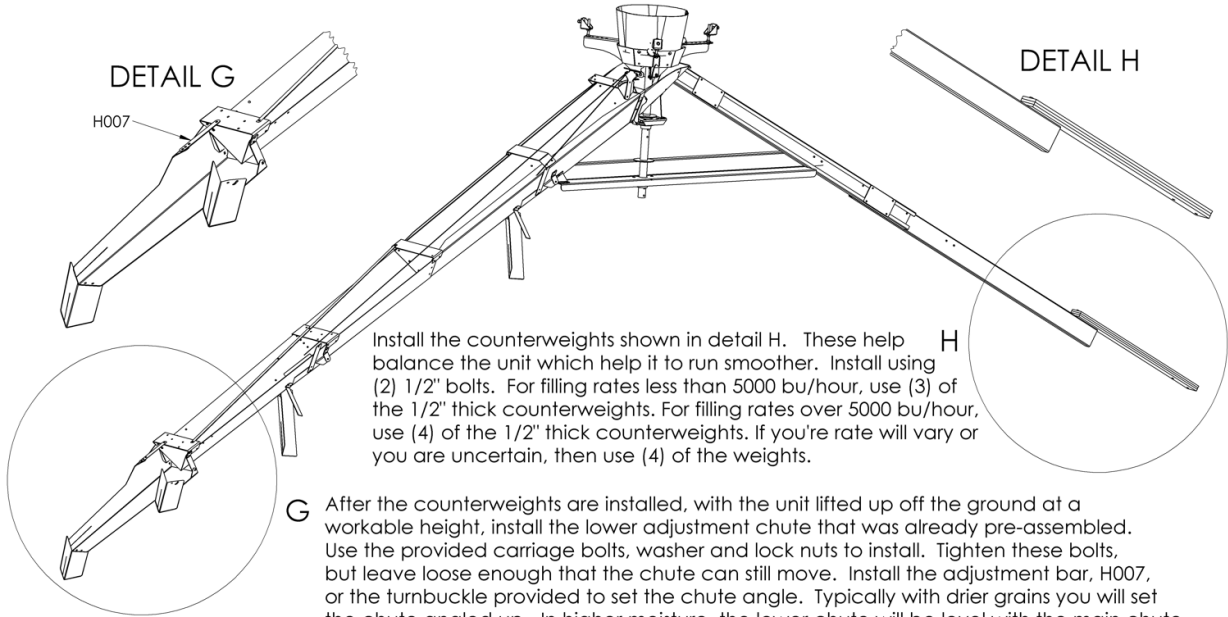

Install the counterweights shown in detail H. These help balance the unit which help it to run smoother. Install using (2) 1/2" bolts. For filling rates less than 5000 bu/hour, use (3) of the 1/2" thick counterweights. For filling rates over 5000 bu/hour, use (4) of the 1/2" thick counterweights. If you're rate will vary or you are uncertain, then use (4) of the weights.

G After the counterweights are installed, with the unit lifted up off the ground at a workable height, install the lower adjustment chute that was already pre-assembled. Use the provided carriage bolts, washer and lock nuts to install. Tighten these bolts, but leave loose enough that the chute can still move. Install the adjustment bar, H007, or the turnbuckle provided to set the chute angle. Typically with drier grains you will set the chute angled up. In higher moisture, the lower chute will be level with the main chute. Rarely will the lower chute angle down from the main chute.