

Mechanical - Electrical - Plumbing Design Drawings for Marcus Garvy Harmony Re-Development

1537 NE 24th Street
Oklahoma City, OK, 73111

GENERAL MEP SPECIFICATIONS

- IT IS THE RESPONSIBILITY OF THE CONTRACTOR TO REVIEW AND UNDERSTAND ALL DRAWINGS AND SPECIFICATIONS IN THE CONTRACT DOCUMENTS. EACH CONTRACTOR IS RESPONSIBLE FOR ALL WORK ASSOCIATED WITH HIS TRADE REGARDLESS OF WHERE THE WORK IS DEPICTED IN THE DRAWINGS OR SPECIFICATIONS.
- THE LAYOUT OF SYSTEMS SHOWN ON PLANS ARE APPROXIMATE AND WILL NEED TO BE COORDINATED IN FIELD. THE CONTRACTOR SHALL INCLUDE THIS COORDINATION IN HIS SCOPE AND INCLUDE ALL COSTS OF MODIFYING THE LAYOUT AS REQUIRED IN HIS BID.
- THE CONTRACTOR IS RESPONSIBLE FOR PROVIDING ALL NECESSARY PARTS AND LABOR TO PRODUCE A COMPLETE AND FULLY OPERATIONAL SYSTEM UNLESS STATED OTHERWISE ON PLANS.
- ALL MATERIALS TO BE NEW, FIRST CLASS, AND INSTALLED PER MANUFACTURE'S PUBLISHED INSTRUCTIONS.
- ALL WORK SHALL BE PERFORMED IN COMPLIANCE WITH LOCALLY ADOPTED CODES AND ORDINANCES.
- CONTRACTOR IS RESPONSIBLE FOR TO COORDINATE EQUIPMENT LOCATIONS AND SYSTEM ROUTING WITH OTHER TRADES PRIOR TO INSTALLATION.
- CONTRACTOR TO GUARANTEE ALL MATERIALS AND WORKMANSHIP FOR A PERIOD OF ONE YEAR FROM THE DATE THE PROJECT IS TURN OVER TO THE OWNER, UNLESS NOTED OTHERWISE.
- CONTRACTOR IS TO INCLUDE IN HIS SCOPE THE COST OF ALL PERMITS, INSPECTIONS, METERING, AND TAPS ASSOCIATED WITH HIS WORK.
- CONTRACTOR IS RESPONSIBLE FOR ALL EXCAVATION, CUTTING, CORING, PATCHING, AND BACKFILL REQUIRED TO COMPLETE HIS WORK, UNLESS NOTED OTHERWISE.
- THESE PLANS ARE NOT TO BE SCALED. SEE ARCHITECTURAL PLANS FOR DIMENSIONS. WHERE THERE IS A CONFLICT BETWEEN ARCHITECTURAL DIMENSIONS AND MEP DIMENSION, ARCHITECTURAL SHALL GOVERN.
- SEE DISCIPLINE SHEETS FOR ADDITIONAL DISCIPLINE SPECIFIC SPECIFICATIONS.

DEFERRED SUBMITTAL NOTES

- FIRE SPRINKLER CONTRACTOR TO PROVIDE DEFERRED SUBMITTAL FOR FIRE SPRINKLER SYSTEM SUBMITTAL TO INCLUDE HYDRAULIC CALCULATIONS AND SPRINKLER DRAWINGS SEALED BY A QUALIFIED DESIGN PROFESSIONAL LICENSED BY THE STATE.

REFERENCED CODES IN EFFECT

- 2015 INTERNATIONAL MECHANICAL CODE
- 2015 INTERNATIONAL PLUMBING CODE
- 2015 INTERNATIONAL FUEL GAS CODE
- 2015 INTERNATIONAL FIRE CODE
- 2017 NATIONAL ELECTRIC CODE
- 2009 INTERNATIONAL ENERGY CONSERVATION CODE
- 2015 INTERNATIONAL RESIDENTIAL CODE

SHEET INDEX

Sheet Number	Sheet Title
MEP1	MECHANICAL ELECTRICAL PLUMBING COVER SHEET
MEP2	SITE LIGHTING PLAN
MEP3	UTILITY SITE PLAN

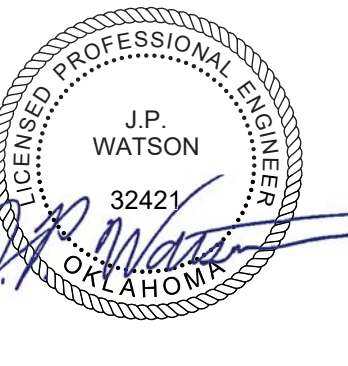

James Watson, P.E. October 8th, 2021
PE-32421
OK Certificate of Authority # 8654

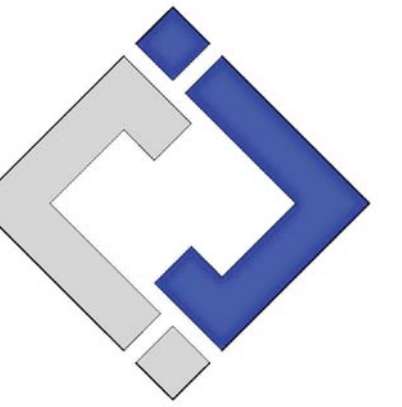

**J-SQUARED
ENGINEERING**

2401 Bernadette Drive, Suite 201
Columbia, Missouri 65203
573 - 234 - 4492 phone
www.j-squaredeng.com

J2 PROJECT No: J20395

J2 DESIGN: KEL

ISSUE TITLE DATE

PERMIT SET 10-08-2021

SHEET TITLE

MECHANICAL
ELECTRICAL
PLUMBING COVER
SHEET

SHEET NUMBER

MEP1

Mechanical - Electrical - Plumbing Design Drawings for
Marcus Garvy Harmony Re-Development

1537 NE 24th Street
Oklahoma City, OK, 73111

SITE LIGHTING PLAN SYMBOL LEGEND

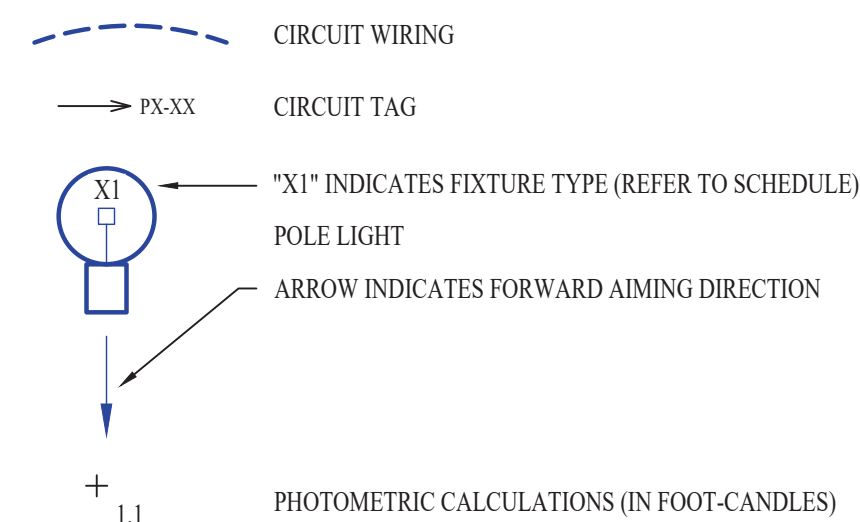

SITE LIGHTING PLAN GENERAL NOTES:

- SITE PHOTOMETRIC VALUES SHOWN HAVE BEEN CALCULATED PER SPECIFIED LIGHT FIXTURES AT INDICATED MOUNTING HEIGHTS. ANY CHANGES OR ALTERATIONS TO LIGHTING LAYOUT SHOWN WILL REQUIRE RECALCULATING SITE PHOTOMETRICS AND WILL BE THE RESPONSIBILITY OF THE ELECTRICAL CONTRACTOR / EQUIPMENT SUPPLIER.
- PHOTOMETRIC CALCULATIONS SHOWN DO NOT INCLUDE EXISTING LIGHT FIXTURE(S), ONLY NEW POLE LIGHT FIXTURE(S) SHOWN.

SITE LIGHTING PLAN KEY NOTES:

- EXISTING POLE AND POLE BASE TO BE REUSED. DEMO EXISTING FIXTURE & INSTALL NEW FIXTURE PER PLANS.
- POLE LIGHT CIRCUIT TO BE CONTROLLED BY ASTRONOMICAL TIMER LOCATED NEXT TO PANEL 'HP'. TURN ON AT DUSK AND TURN OFF AT DAWN. SEE HARMONY SCHOOL APARTMENT PLANS.
- POLE LIGHT CIRCUIT TO BE CONTROLLED BY ASTRONOMICAL TIMER LOCATED NEXT TO PANEL 'CBI'. TURN ON AT DUSK AND TURN OFF AT DAWN. SEE HARMONY CENTER PLANS.

LIGHT FIXTURE SCHEDULE

TAG	MANUFACTURER (OR EQUAL)	MODEL NUMBER (OR EQUAL)	DESCRIPTION	MOUNTING	LUMEN OUTPUT	CCT (°K)	CRI	VOLTS	WATTS	NOTES
X1	McGraw-Edison	GLEON-SA2C-740-U-SL3	PARKING & DRIVE POLE LIGHT	26 FT. POLE WITH 4 FT. POLE BASE	14400	4000	70	208 / 1	113	
X2	McGraw-Edison	GLEON-SA2C-740-U-T4W	PARKING & DRIVE POLE LIGHT	26 FT. POLE WITH 4 FT. POLE BASE	14300	4000	70	208 / 1	113	
X3	McGraw-Edison	GPC-SA1C-740-U-T4FT-QM-BZ	AREA POLE LIGHT	12 FT. POLE WITH 6 IN. POLE BASE	7600	4000	70	208 / 1	59	
X4	McGraw-Edison	GPC-SA1B-740-U-T2-HSS-QM-BZ	SIDEWALK POLE LIGHT	12 FT. POLE WITH 6 IN. POLE BASE	6000	4000	70	208 / 1	44	
X5	McGraw-Edison	GPC-SA1B-740-U-T2-QM-BZ	SIDEWALK POLE LIGHT	12 FT. POLE WITH 6 IN. POLE BASE	6000	4000	70	208 / 1	44	
X6	McGraw-Edison	GPC-SA1B-740-U-T3-HSS-QM-BZ	SIDEWALK POLE LIGHT	12 FT. POLE WITH 6 IN. POLE BASE	6100	4000	70	208 / 1	44	

NOTES:
1. VERIFY LIGHT FIXTURE FINISHES WITH OWNER / ARCHITECT PRIOR TO INSTALLATION

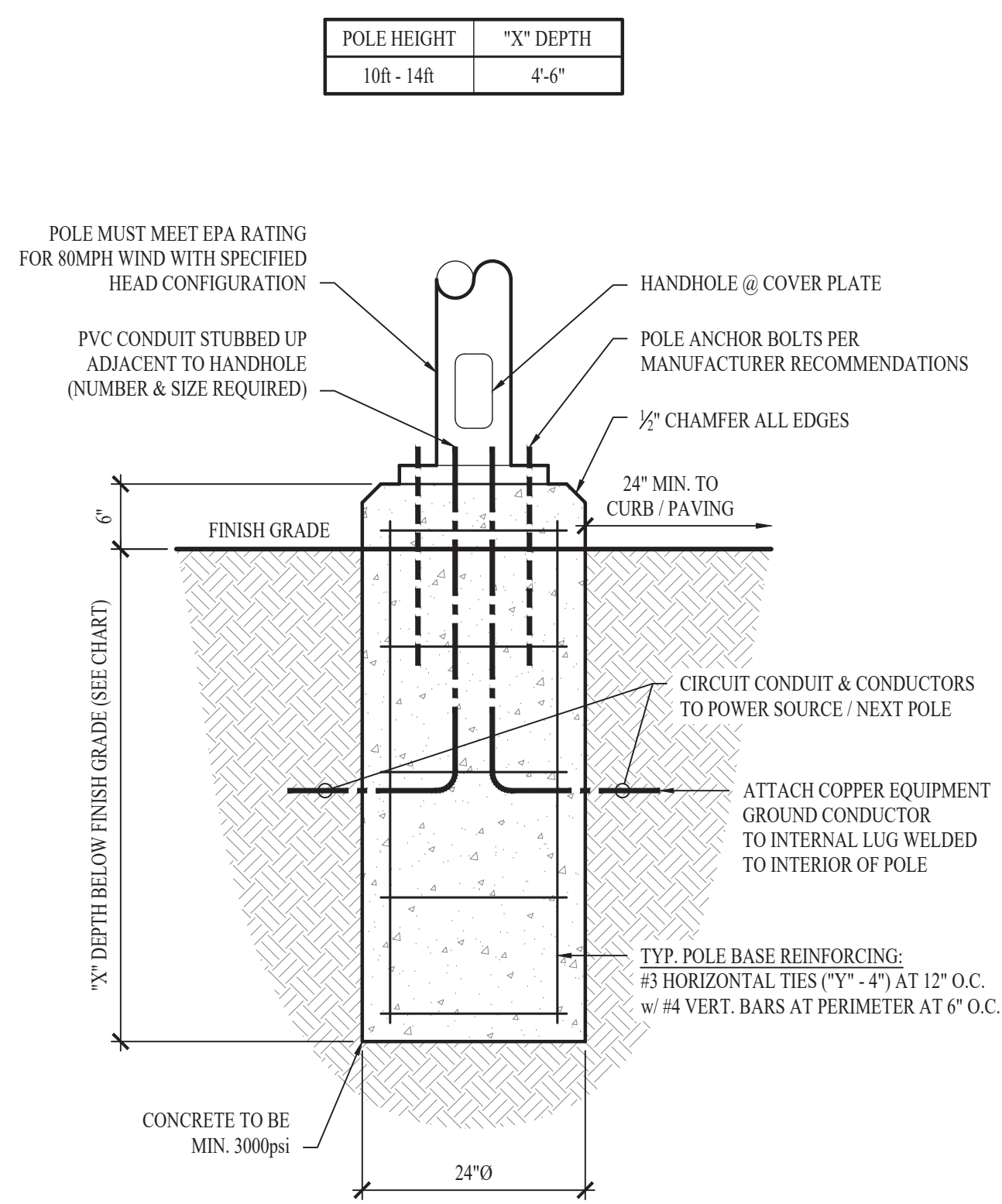

TYP. LIGHT POLE DETAIL - 2

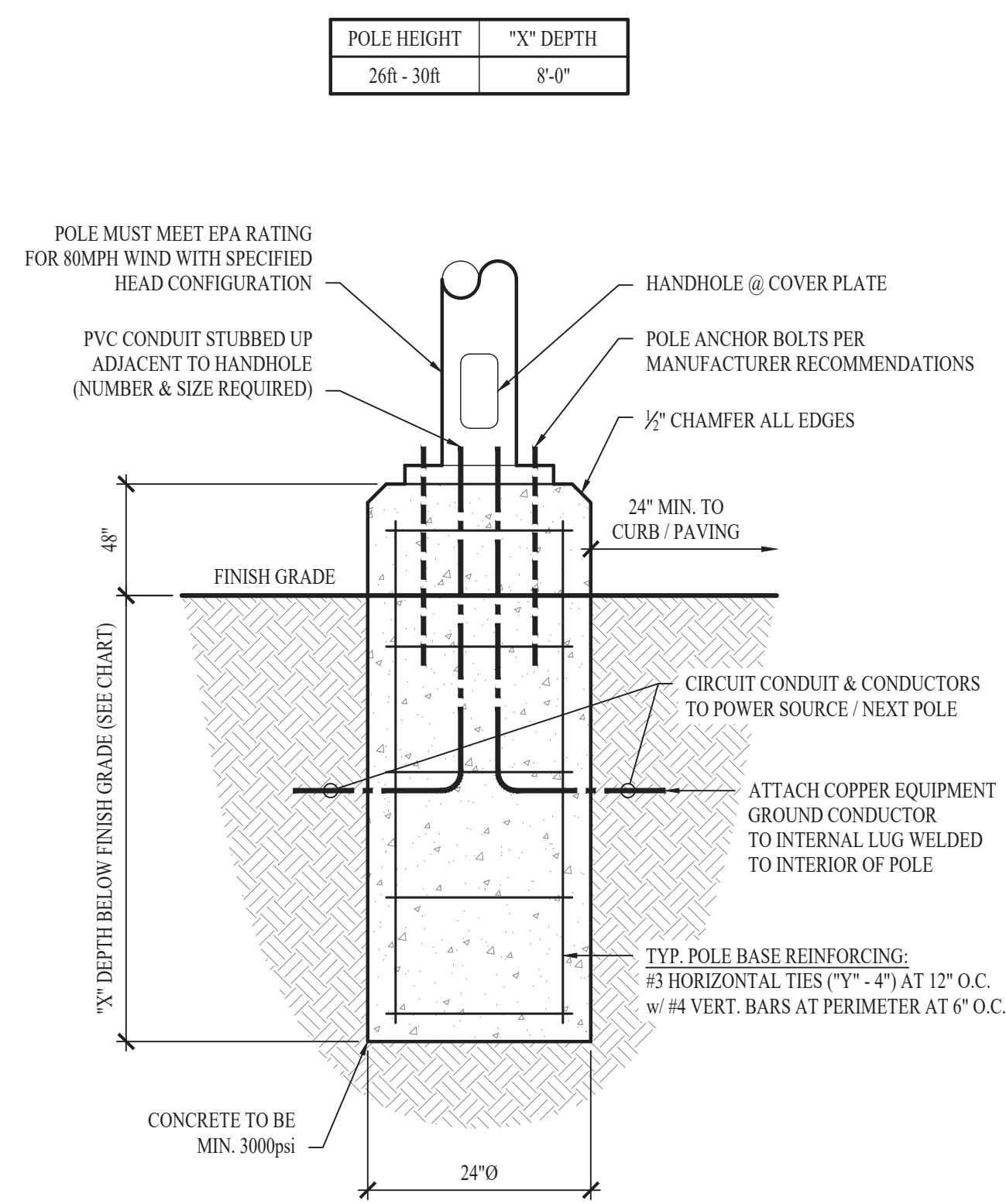

TYP. LIGHT POLE DETAIL - 1

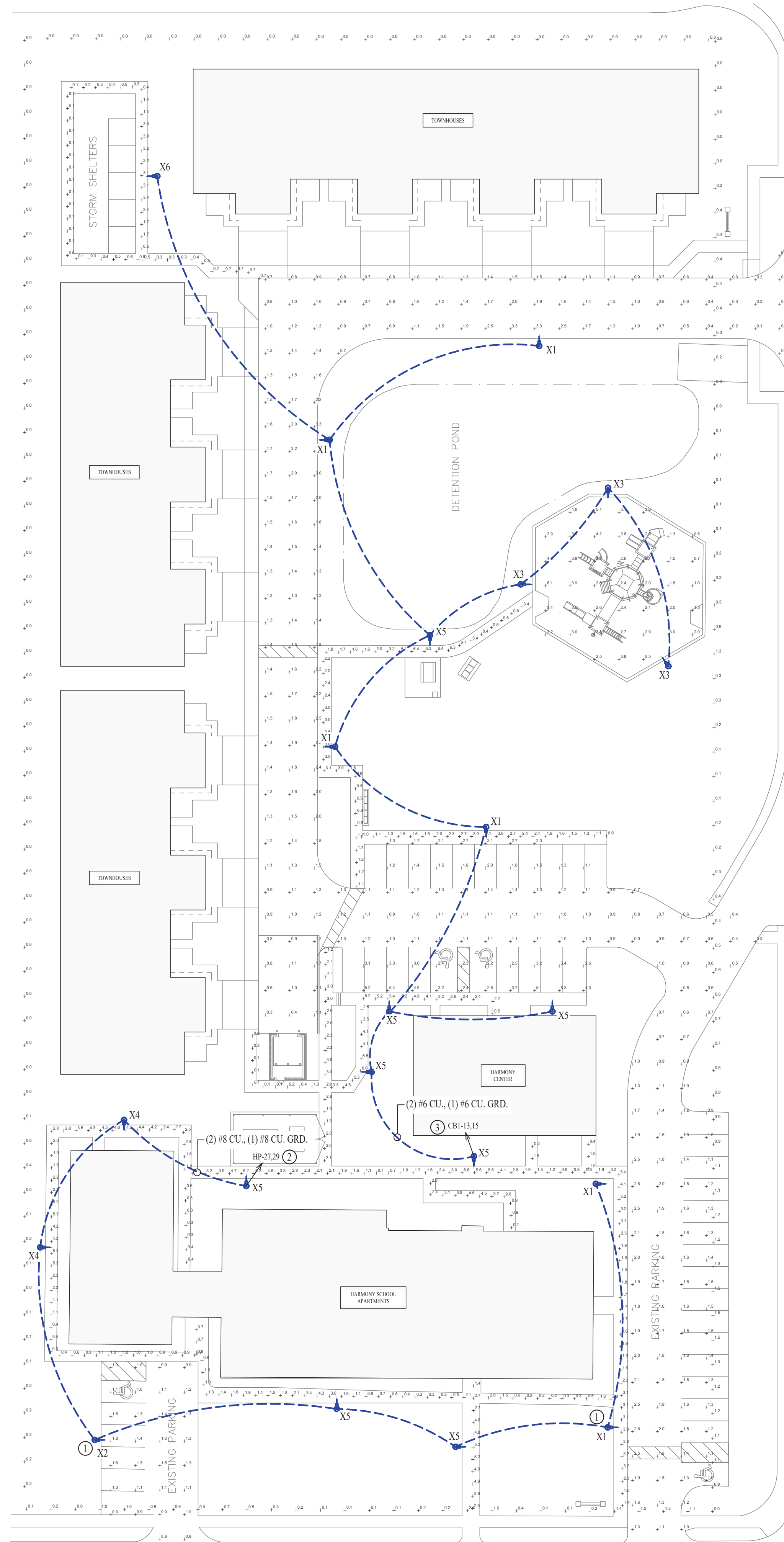

1/8" = 1'-0"
SITE LIGHTING PLAN
SCALE: 1" = 30 ft



James Watson, P.E. October 8th, 2021
PE-32421
OK Certificate of Authority # 8654

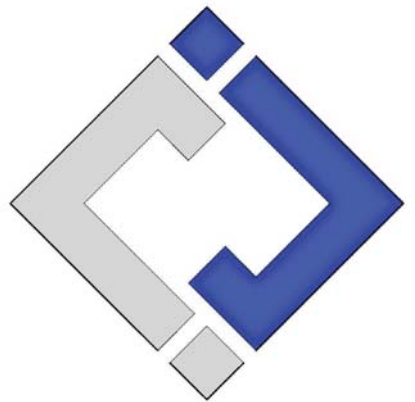

J-SQUARED ENGINEERING
2401 Bernadette Drive, Suite 201
Columbia, Missouri 65203
573 - 234 - 4492 phone
www.j-squaredeng.com

J2 PROJECT No: J20395
J2 DESIGN: KEL







ISSUE TITLE DATE
PERMIT SET 10-08-2021

Mechanical - Electrical - Plumbing Design Drawings for
Marcus Garry Harmony Re-Development
1537 NE 24th Street
Oklahoma City, OK, 73111

SHEET TITLE
SITE LIGHTING PLAN

SHEET NUMBER
MEP2

SITE PLAN SYMBOL LEGEND

-  SANITARY SEWER PIPING
-  COLD WATER LINE
-  GAS LINE
-  GAS METER
-  TIE INTO EXISTING
-  UNDER GROUND ELECTRIC

SITE PLAN GENERAL NOTES:

1. SEE HARMONY SCHOOL AND HARMONY CENTER PLANS FOR ELECTRICAL AND PLUMBING NOTES, SCHEDULES, AND DETAILS.
2. COORDINATE FINAL FIRE LINE WATER SIZE WITH SPRINKLER CONTRACTOR PRIOR TO INSTALLATION.
3. GAS PIPING BELOW GRADE SHALL BE INSTALLED WITH YELLOW TRACER WIRE AND ABOVE GRADE TERMINATIONS SHALL BE WITH ANODELESS RISER (PER IFGC 404.17).

SITE PLAN KEY NOTES:

- ① TIE INTO EXISTING GAS LINE. SEE CIVIL PLAN FOR CONTINUATION.
- ② 250kW GENERATOR PAD LOCATION. COORDINATE GAS LINE LOCATION AND ELECTRICAL CONDUIT CONNECTIONS PRIOR TO INSTALLATION.
- ③ 100kW GENERATOR PAD LOCATION. COORDINATE GAS LINE LOCATION AND ELECTRICAL CONDUIT CONNECTIONS PRIOR TO INSTALLATION.
- ④ ANODELESS RISER LOCATION. CONTRACTOR TO COORDINATE PRESSURE REGULATOR SIZE WITH GENERATOR SUPPLIER PRIOR TO INSTALLATION.
- ⑤ AUTOMATIC TRANSFER SWITCH LOCATION. SEE HARMONY SCHOOL APARTMENTS POWER RISER FOR MORE INFORMATION.
- ⑥ METER, CT CABINET, & AUTOMATIC TRANSFER SWITCH LOCATION. SEE HARMONY CENTER POWER RISER FOR MORE INFORMATION.

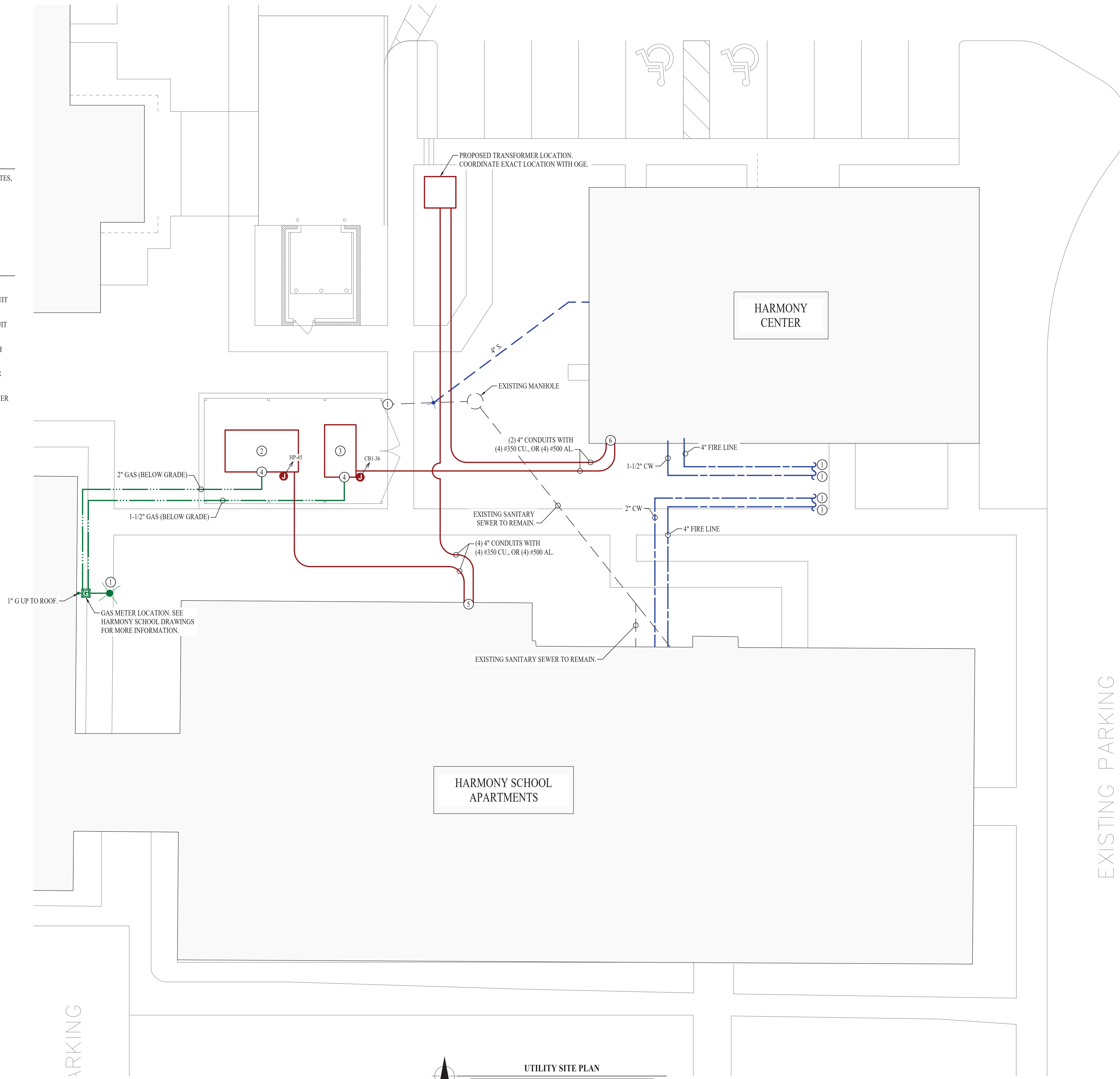

James Watson, P.E. October 8th, 2021
 PE-32421
 OK Certificate of Authority # 8654

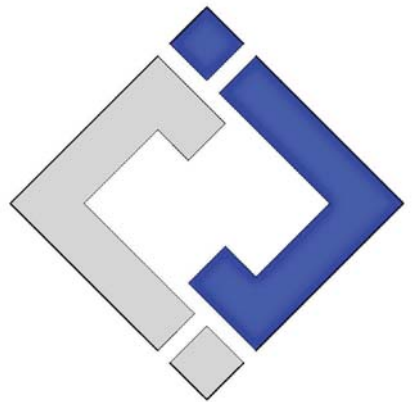

J-SQUARED ENGINEERING
 2401 Bernadette Drive, Suite 201
 Columbia, Missouri 65203
 573 - 234 - 4492 phone
 www.j-squaredeng.com

J2 PROJECT No:	J20395
J2 DESIGN:	KEL

ISSUE TITLE	DATE
PERMIT SET	10-08-2021

Mechanical - Electrical - Plumbing Design Drawings for
Marcus Garry Harmony Re-Development
 1537 NE 24th Street
 Oklahoma City, OK, 73111

SHEET TITLE
UTILITY SITE PLAN

SHEET NUMBER
MEP3