



Agri-Spread

AS2000 SERIES

THE NEXT GENERATION OF PRECISION SPREADING



FERTILISER, LIME, GYPSUM & MANURE



INTRODUCING A NEW GENERATION OF SPREADER

The latest Agri-Spread AS2000 series is an advanced precision spreader, which takes simplicity, durability, capacity and accuracy to the next level.

Whether you are spreading fertiliser, lime, gypsum, manure or mouse bait, the 2000 series precision Agri-Spread delivers the target rate at the highest level of accuracy. The new AS2000 series is independently certified to spread urea to 36m and lime to 12m. It's built to last, functional in design and is easier than ever to operate.

New design features include the Agri-Spread exclusive Positive Drive Conveyor System, making it virtually impossible for the conveyor to slip. A slick new bin design featuring more stainless components and a new adjustable rear deck spinner system to ensure the highest level of accuracy and distribution of all products are some other new features visible on the AS2000 series.

The AS2000 series takes care of variable rates using mapping technology and can accurately apply product with variable bulk density using dynamic auto calibration. The help of four load cells and a variable speed floor belt guarantees the target rate regardless of forward speed.

Reducing input costs by minimising overlap, Agri-Spread are also excited to announce the release of optional Section Control available throughout the whole AS2000 series range. Taking care of the required spread width in 14 sections, working in conjunction with paddock shape and GPS map data alongside the already popular auto shut off for headlands and border control functions spreading is easily managed from the Agri-Spread VT controller meaning little to no overlap. And most importantly a reduction in fertiliser requirements from 5-15%.

ISOBUS / VT compatible the Agri-Spread provides control of the spreader as well as recording input application data for farm management documentation from inside the cab.

BRINGING IMPROVEMENTS TO SIMPLICITY, DURABILITY, CAPACITY AND ACCURACY

As the leaders in spreading the AgriSpread team are focused on developing their product to meet customers' changing needs. The enhancements that are offered with the new AS2000 series encompass the need for capacity and simplicity whilst retaining the earned reputation of accuracy and durability.

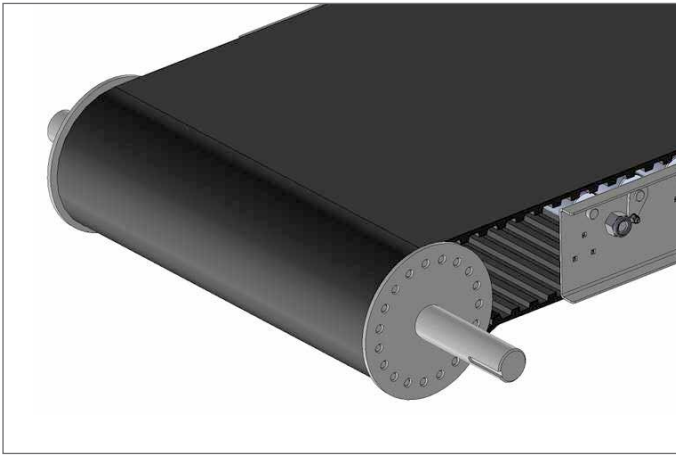

Positive Drive

To eliminate belt slippage AgriSpread has designed and developed the Positive Drive Conveyor System for the AS2000 range of spreaders. The conveyor floor-belt is a flexible belt with a smooth surface on one side and with teeth moulded on the underside which run over a matching cage roller drive system. The patented Positive Drive Conveyor provides maximum synchronised power transmission to the belt to ensure low noise, no slippage and precise application rate control. The non-slip design is ideally suited to the precise metering of product density. The tooth belt eliminates stretch which is seen on conventional belt spreaders and therefore, requires minimal tensioning and lower maintenance. The cassette design conveyor can be withdrawn from the spreader in one piece for service and access. The Positive Drive Conveyor system is also self-tracking ensuring side wall damage to the belts are kept minimal, limiting operator input and increases the life span and durability of the belt.

Load Sense Hydraulics

The AS2000 Hydraulic Valve Assembly is compatible with tractors using load sensing hydraulics. The Disc spinners and belt drive(s) now independently control their hydraulic oil requirement. The new hydraulic valve assembly is standard on the new series and can also be operated as a fixed pump for non-load sensing tractors.



Bin & Chassis

The 2000 series is released with a redesigned bin shape with formed last cuts and folds to prevent material build up. The front panel is now completely fabricated with stainless steel along with the rear and the bottom third of the bin and full fabrication of extensions. Other new features include adjustable hitch options, two sight inspection windows and a swinging hydraulic hose holder. Stainless steel pressure and return lines are fitted to minimise oil temperature, increase longevity and reduce maintenance. All other cabling is now encased inside the chassis rails to avoid cable erosion, corrosion or damage.

Spreading Deck System & Vane Spinners

The AS2000 series comes with a completely new Spreading deck system with adjustable rear deck positioning. The spread width can be finetuned by adjusting the deck forward and back. Users can set spread bout width with the deck and pattern distribution with vanes. The new two vane spinner design, one long and one short, creates an accurate and adjustable placement of product across the spread. With the development of more fertiliser product options and blends the moving deck gives more options for settings to adjust for maximising accuracy and placement.

FEATURES & BENEFITS

Capacity

Size matters! One of the biggest developments of the AS2000 series is the introduction of two new models to the range. The AS2200 (20m³) and its big brother the AS2220 (22m³) providing even more capacity than ever before. Coupled with a muscled-up version of the durable Agri-Spread Chassis system and a standard steerable axle, the AS2220 provides the consistent flotation that the Agri-Spread tandem range is renowned for.

Simplicity

The AS2000 Series is an advanced precision farming spreader that meets the requirements of a convenience, serviceability, productivity and accuracy. The spinner speeds are set from the cab based on the product being applied and spread width required while the floor belt speed is varied through Pulse Width Modulation to ensure the application rate is always on target regardless of the product density or forward speed. Based on the area spread, the controller continuously fine-tunes the flow rate of product onto the disks to ensure the highest level of accuracy. The data collected is processed and provides a record of the applied product, as well as how much was applied and where. Data then can be utilized in farm management applications to help maintain accurate spreading and nutrient records.

Built to Last

Not just a slogan, but a feature well acknowledged among AgriSpread owners. All the nuts, bolts and hydraulic fittings are also stainless steel. The axle, flotation tyres, tandem axle suspension and drawbar suspension provides the smoothest ride for enhanced distribution and load carrying performance. AgriSpread uses state-of-the-art surface treatment processes including steel shot blasting and two pack paint finish to provide longevity in corrosive and high wear environments.

Variable Rate Technology (VRT)

Variable Rate applications utilises a pre-planned prescription map to optimise the use of products across paddocks where there is a variability in soil and crop nutrition. The ISOBUS user interface adopts the precision map to control the application rate based on the maps formatted information and GPS position. The AS2000 uses the variable speed positive drive floor belt conveyor to meter the product onto the disks at the prescribed rate regardless of forward speed or product density. Working from a prescription map versus a set rate gets the application right where it's needed which can have significant impact on crop yield while reducing input costs.

Accuracy

- Independently accredited to spread Urea up to 40m and Lime to 15m
- Two sets of discs; one for fertiliser and one for lime, gypsum and manure
- Applies variable bulk density products with capacity, control and precision using
- Dynamic weighing
- Designed for speeds up to 50km/h
- Adjustable rear spinner deck and vane position to ensure an even spread
- Regardless of product





**ACCURACY EQUALS
EFFICIENCY**

AS2000 SERIES MODELS

AS2100



- Single Axle
- 2m or 3m Wheel Centres

10M³

AS2120



- Single Axle
- 2m or 3m Wheel Centres

12M³

AS2130-T



- Tandem Axle
- 3m Wheel Centres

13M³

AS2150-T



- Tandem Axle
- 3m Wheel Centres
- Steerable Rear Axle

15M³

AS2200-T



- Tandem Axle
- 3m Wheel Centres
- Steerable Rear Axle

20M³

AS2220-T



- Tandem Axle
- 3m Wheel Centres
- Steerable Rear Axle

22M³

CALIBRATION & TEST KITS

Whether your target rate is 1kg/ha, 10,000kg/ha or anywhere in between, AgriSpread testing equipment has you covered. AgriSpread test significant amounts of fertilisers and rates each year. Although test hall results give a good guideline for spreader settings, nothing beats field and environmental testing to ensure you are getting the desired results. Standard with each spreader, the high spec calibration kit includes; 13 test trays with dividing inserts, test tubes, bulk density meter, hardness tester, granular sieve, and a windometer. This kit has been designed to assist with the correct set-up and testing of the rate, flow and distribution pattern of spread products. Simple testing and recalibration guarantee accuracy of spread over a range of products with different densities and conditions. AgriSpread recommends retesting regularly when changing products.



PRODUCTIVITY IN THE PALM OF YOUR HAND.

AgriSpread App

The AgriSpread App is a link between ongoing back-up and support and is free to download. Not only does the app provide valuable setup and operational information, it's also where copies of the operators manual, including parts, maintenance and service, are shared and updated for everyone's convenience. All parts diagrams are clearly numbered and labelled.

Available now from the App Store and Google Play.



STANDARD FEATURES



Swinging Hose Holder

Secures hydraulic hoses and electrical cables. Pivots in the direction of travel to keep hoses and cable stress free on headlands and corners.

Stainless Steel Hydraulic Pressure and Return Lines

Along the side of the bin, they offer superior performance, longevity and better heat transmission.

Lime Discs

The extremely robust and hardened pressed steel lime disc vanes are designed to handle the harshest of products whilst maintaining an even spread. Intended for lime, gypsum, manure, and compost they are also available with optional Teflon wear plates to minimise potential build-up when spreading sticky products.

Fertiliser Discs

Designed to handle product with care whilst maintaining an even spread pattern the Fertiliser Discs with adjustable vane position on the 2000 series maximise width whilst maintaining a low coefficient of variation (CV) no matter what the product.

Stainless Steel Hopper Mesh

Made in smaller sections for easy lifting and removal for one person the stainless steel is longer lasting when using corrosive fertilizer products.

Stainless Steel Fittings

The front end, entire rear section, and bottom one third of the bin is made from stainless steel. All the nuts, bolts, pipes, and hydraulic fitting are also stainless steel.

Load Sense Hydraulics

With spinners and belt drives now independently controlled the hydraulic oil requirement for the AS2000 is more variable than ever before, therefore ideally suited to tractors with load sensing hydraulics. As a result a new selectable load sense hydraulic valve block is standard on the AS 2000 spreaders to cater for both pressure compensating and load sensing.

Axles

AgriSpread axles are designed to suit all paddock conditions and have a reputation for being tough and reliable. The rear self-steering axle on tandem models minimises dragging when cornering making the AgriSpread easier to tow. There is much less soil and crop disturbance as well as less wear and tear on the undercarriage.

Suspension

AgriSpread fit drawbar suspension to all models to help minimise the effect of inertia energy transmission and to provide a smoother ride. To enhance the spread accuracy further, all tandem axle models have the addition of axle suspension to absorb impacts, providing a smoother ride, and better distribution at higher operating speeds.

Lug and Flotation Tyre Options

Whether you require flotation tyres or prefer lug tyres AgriSpread have options to suit any cropping situation. Tyre widths range from 300 to 800mm wide. Additional tyre options available subject to certain design limitations.

Brakes & LED Tail Lights

Whether you are on the road or in the paddock brakes provide the peace of mind you have control of a loaded AgriSpread and the stopping power when you most need it. LED lights provide safety on the road and let other users know your intentions.

Chains

Maintain uniform flow of high bulk density products from the conveyors onto the spinners.

OPTIONAL FEATURES

AS2000 SERIES OPTIONS



Hydraulic Folding Curtains

Agri-Spread's hydraulic folding curtains make it possible to spread low density product into difficult conditions without compromising spread width or distribution accuracy. It works by forcing incoming air over the curtain to create a wake of low pressure stalled air behind. The applied product fills the wake and is forced to the ground by high pressure air flowing over the curtain. Where there's a lot of spreading to be done hydraulic folding curtains can significantly increase productivity.



3M Axle

The 3m axle option is perfect for controlled traffic farming systems. Also providing extra stability and a smoother ride, its strong robust and built to last.



Border Controller

Border Control allows the adjustment of spinner speed from inside the cab at the touch of a button on the ISOBUS display to reduce spinner speed independently whilst boundary spreading to minimize wastage or overthrow.



Stainless Steel Bin

The painted grade 304 stainless steel provides complete rust protection. Minimizing maintenance and corrosion, the paint will increase the life and residual value of the spreader.

THE FUTURE OF PRECISION SPREADING IS HERE



SECTION CONTROL (Factory Option)

Introducing the latest in precision application technology – automatic section control

The AgriSpread section control spreader use two independent, hydraulically controlled conveyors via GPS, to feed material onto independently controlled hydraulic spinners to give the applicator the most precise distribution of product where required.

The twin conveyor system give the spreader the ability to change the rate on either side of the machine in relation to the spread width/rate required. In conjunction to this, the spinner speed automatically changes speed to match the width required based on the amount of sections turned off.

As well as automatic section control, the operator can shut off one side of the spreader by the touch of a button. Boundary or headland spreading is also a one-touch operation to reduce the spread width on one side only.

In addition to the twin conveyor, AgriSpread have also incorporated the latest advancements in belt conveyor systems – Positive Drive – to produce the most precision built spreading machine on the market.



TAKE TOTAL CONTROL



AS2000 SERIES SECTION CONTROL ADVANTAGES

Main Features

- 14 section swath width control
- Fertiliser and lime capable
- Boundary spreading at the touch of a button
- Complete left/right shut off
- Variable rate spreading
- Auto Shut-off
- Proven hydraulic system (Load Sense of Fixed Pump option)
- Independent conveyor/spinner control and monitoring

User Benefits

- Fertiliser savings of 10% - 20%
- Proven ISOBUS software interface
- Hydraulic controlled sections with proven hydraulic system
- In-cab diagnostics for ease of use
- Load cells for precise applications built into the mechanical design and user interface

ISOBUS Controller

AgriSpread's proven ISOBUS user interface gives the operator a simple and reliable interface for controlling and monitoring the spreader.





AS 2000 SERIES SPECIFICATIONS

STANDARD SPECIFICATIONS

MODEL	AS265	AS285	AS2100 (2m)	AS2100 (3m)	AS2120 (2m)	AS2120 (3m)	AS2130T (2m)	AS2130T (3m)	AS2150T (3m)	AS2200T (3m)	AS2220T (3m)
Bin Length (mm)	3330	3630	3630		4228		4640		4640	5632	5632
Bin Width (mm)	2245	2245	2245		2245		2245		2245	2245	2245
Loading Height - load cells (mm)	2560	2560	2800		2800		2710		2985	2870	3133
Capacity (m ³)	7	7.6	10		12		13		15	20	22
Fertiliser Capacity Heaped (tonnes)	7.7	8.5	10.1		11.9		13.5		17	16.6	21
Lime Capacity Heaped (tonnes)	9.2	11.9	13.5		14.5		19		19.5	23.3	25
Unladen Weight	3500	4050	4300	4650	5150	5500	5800	6500	6730	6950	7300
Carrying Capacity (kg)	9200	12000	13500		14500		19500		19500	25000	25000
Tyres	600/55-26.5 BKT	600/65-30.5 BKT	650/65-30.5 BKT		650/65-30.5 BKT		600/55-26.5 BKT		600/55-26.5 BKT	650/65-30.5 BKT	650/65-30.5 BKT
Axle Cross Section (mm)	1x120SQ	1x150SQ	1x150SQ		1x150SQ		2x127SQ		2x127SQ	2x150SQ	2x150SQ
Wheel Stud	10 STUD	10 STUD	10 STUD		10 STUD		10 STUD		10 STUD	10 STUD	10 STUD
Axle Track Width (m)	2	2	2	3	2	3	2	3	3	3	3
Sprung Drawbar	YES	YES	YES		YES		YES		YES	YES	YES
Hopper Mesh	YES (75mm)	YES (75mm)	YES (75mm)		YES (75mm)		YES (75mm)		YES (75mm)	YES (75mm)	YES (75mm)
Rate Controller Type	ISOBUS	ISOBUS	ISOBUS		ISOBUS		ISOBUS		ISOBUS	ISOBUS	ISOBUS
Variable Rate Ready	YES	YES	YES		YES		YES		YES	YES	YES
Hydraulic Brakes	YES	YES	YES		YES		YES		YES	YES	YES
Lights	YES	YES	YES		YES		YES		YES	YES	YES
Roll Over Cover	YES	YES	YES		YES		YES		YES	YES	YES
Chains	YES	YES	YES		Yes		YES		YES	YES	YES
Load Cells	YES	YES	YES		YES		YES		YES	YES	YES
Vertical Load on Hitch - Unladen (kg)	445	514	383	414	670	715	551	618	639	646	650
Vertical Load on Hitch - Max laden (kg)	2159	2729	2492	2541	3537	3600	3542	3640	3672	4793	5156
Steerable Axle	NO	NO	NO		NO		NO - Optional		YES	YES	YES
Fethers False Door	YES	YES	YES		YES		YES		YES	YES	YES

Capacity varies according to the density of material being spread. For the purpose of this table, densities of 1.4 and 1 have been assumed for lime and fertiliser respectively. Loading heights vary depending on the wheel specification and optional load cells.

OPTIONAL SPECIFICATIONS

MODEL	AS265	AS285	AS2100 (2m)	AS2100 (3m)	AS2120 (2m)	AS2120 (3m)	AS2130T (2m)	AS2130T (3m)	AS2150T (3m)	AS2200T (3m)	AS2220T (3m)
In-Cab Border Control	YES	YES	YES		YES		YES		YES	YES	YES
Hydraulic Folding Curtains	NO	NO	YES		YES		YES		YES	YES	YES
Stainless Steel Hopper	YES	YES	YES		YES		YES		YES	YES	YES
Steerable Axle	N/A	N/A	N/A		N/A		YES		STANDARD	STANDARD	STANDARD
Tyre Options	YES	YES	YES		YES		YES		YES	YES	YES
Section Control - no retrofit	YES	YES	YES		YES		YES		YES	YES	YES

Agri-Spread reserves the right to modify the machinery and the technical data contained within this document without prior notice.

As standard the PD range come standard with a 204 stainless painted front and rear panel, lower bin panels and main spreading deck. The main conveyor system is 304 unpainted stainless steel.

Proudly Distributed by Waringa Agriculture | +61 08 9960 7164 | waringa.com.au

As farmers we expect high quality and reliability in the products we buy. More importantly we want backup support that can be relied on. Our mission is to provide farmers with a spreader that exceeds their demand for quality, productivity, reliability, and service.

