

Stephanie Reynolds

From: Stephanie Reynolds
Sent: Tuesday, September 18, 2018 12:04 PM
To: fcullooyah@kalispeltribe.com
Cc: EMAIL FILE BASKET; pwillmering@kalispeltribe.com
Subject: Ainsworth Community Park Project - Request for Comments
Attachments: Kalispel Indian Community of the Kalispel Reservation.pdf

Hi Francis,

Please see the attached letter requesting comments for the proposed Ainsworth Community Park project in Thompson Falls, MT. This project was recently funded through CDBG and we are currently working through the environmental review and design process. Please let me know if you have any questions or would like additional information.

Thanks,



Stephanie Reynolds, P.E.

Project Engineer

OFFICE: 406-756-4848
CELL: 406-241-7712
EMAIL: sreynolds@wmggroup.com
ADDRESS: 431 1st Avenue West, Kalispell, MT 59901

170725.3

September 18, 2018

Francis Cullooyah
Cultural Director
Kalispel Indian Community of the Kalispel Reservation
P.O. Box 39
Usk, WA 99180

Re: Agency Review for Proposed Ainsworth Community Park Project in Thompson Falls, MT

Dear Mr. Cullooyah:

The City of Thompson Falls is proposing to build a park at the northwest intersection of Maiden Lane and Lincoln Street, just south of W. Main Street (Hwy 200). The project is located in Government Lot 6 of Section 7 and Government Lot 4 of Section 8, T21N, R29W, P.M., M, City of Thompson Falls, Sanders County, Montana (see vicinity map below). The proposed Ainsworth Community Park will serve as the keystone park in the City's urban system and will include a pavilion with restrooms along with an amphitheater. This park will be capable of holding events, concerts, and family gatherings. Its presence is expected to increase the number of events downtown, stimulate economic activity and contribute to the community's sense of place.



FIGURE 1. GENERAL VICINITY MAP

A preliminary engineering report (PER) was prepared in October 2017 and followed the requirements of the Uniform PER for Montana Public Facility Projects to assist with obtaining grant funding for construction of the project. The City of Thompson Falls obtained CDBG grant funding

earlier this year, and we are now requesting comments from your agency as part of the Environmental Assessment (EA) requirements associated with this project.

This project entails creating a public park on an underutilized City-owned parcel in downtown Thompson Falls (see Figure 2), located within the downtown Thompson Falls Main Street corridor, just a block away from the Clark Fork River. The property was historically used for athletics and then as a baseball field, but those features were removed in 2012.



FIGURE 2. PROJECT AREA VICINITY MAP

The timeline associated with this project is to complete final design in 2018 and construct in 2019. The project entails the construction of a new covered pavilion building, an amphitheater, and a trail system connecting existing Thompson Falls park trails. This will include utility extensions to the property including electrical, water, and sewer. All proposed construction will take place in areas previously developed; primarily on the park property and in City right-of-way. A conceptual drawing of the park is enclosed with this letter, and a 3D rendering of the project can be seen below in Figure 3.



FIGURE 3. Conceptual 3D Rendering of Proposed Ainsworth Community Park

Please provide comments on this project from your agency's perspective. All comment letters received will be incorporated into the Environmental Review Record (ERR) on file for public review with the local government. A full copy of the ERR will be sent to the Montana Department of Commerce (MDOC) upon project completion. If you have any questions as you are going through your review, please feel free to email me at sreynolds@wgmggroup.com or give me a call at (406) 756-4848.

Sincerely,
WGM Group, Inc.

Stephanie A. Reynolds, P.E.
Project Engineer

Enclosure: Ainsworth Community Park Conceptual Drawing Record of Survey

Cc: Glen Nenema, Tribal Chairman, Kalispel Indian Community of the Kalispel Reservation

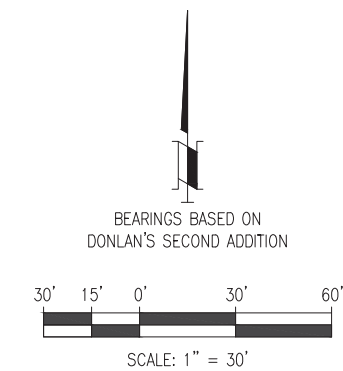
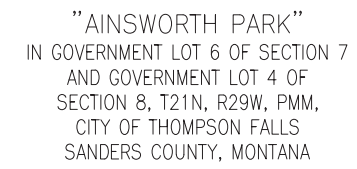

<h1 style="margin: 0;">RECORD OF SURVEY</h1> <h2 style="margin: 0;">SANDERS COUNTY, MONTANA</h2> <h3 style="margin: 0;">CITY OF THOMPSON FALLS, AINSWORTH PARK</h3> <h3 style="margin: 0;">SECTION 8, T21N, R29W PMM</h3> <p style="margin: 0;">AVISTA CORP SPOKANE, WASHINGTON</p>		
1" = 30'	10-14-14	APPROVED
SCALE	DATE	
DESIGN <u>HAGEDORN</u>	CHECKED _____	
DRAWN <u>JEWELL</u>	NOTED _____	
CHECKED _____	NOTED _____	DATE
		SHT _____ OF _____ E-37730