

Coming this August!!!

Marrowstone Island's own Firehouse



Firehouse rendering after it is painted in EJFR colors

As most of you know, the Marrowstone Island Foundation (MIF) has been engaged in a multi-year effort to secure a building on Marrowstone Island to house volunteer firefighters and EMTs. These efforts are about to bear fruit with the delivery of a firehouse this August.

We expect to have our last fund drive for this project once delivery costs are finalized next month.

How the new firehouse will be sited on the property

The two existing buildings will be painted the same EJFR colors as the firehouse

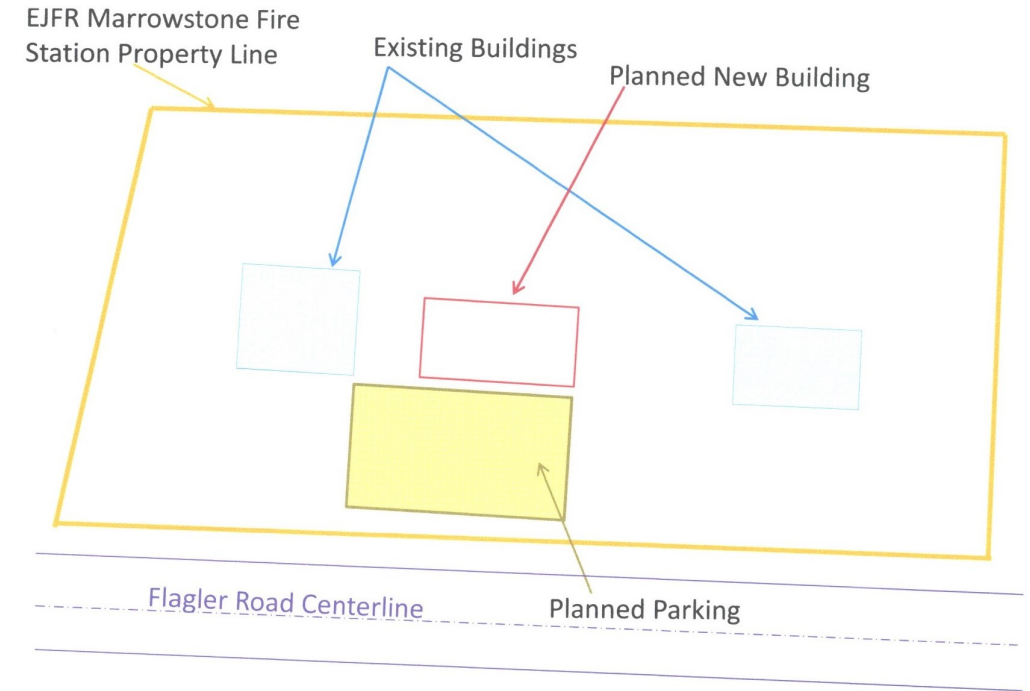

The Firehouse Floor Plan

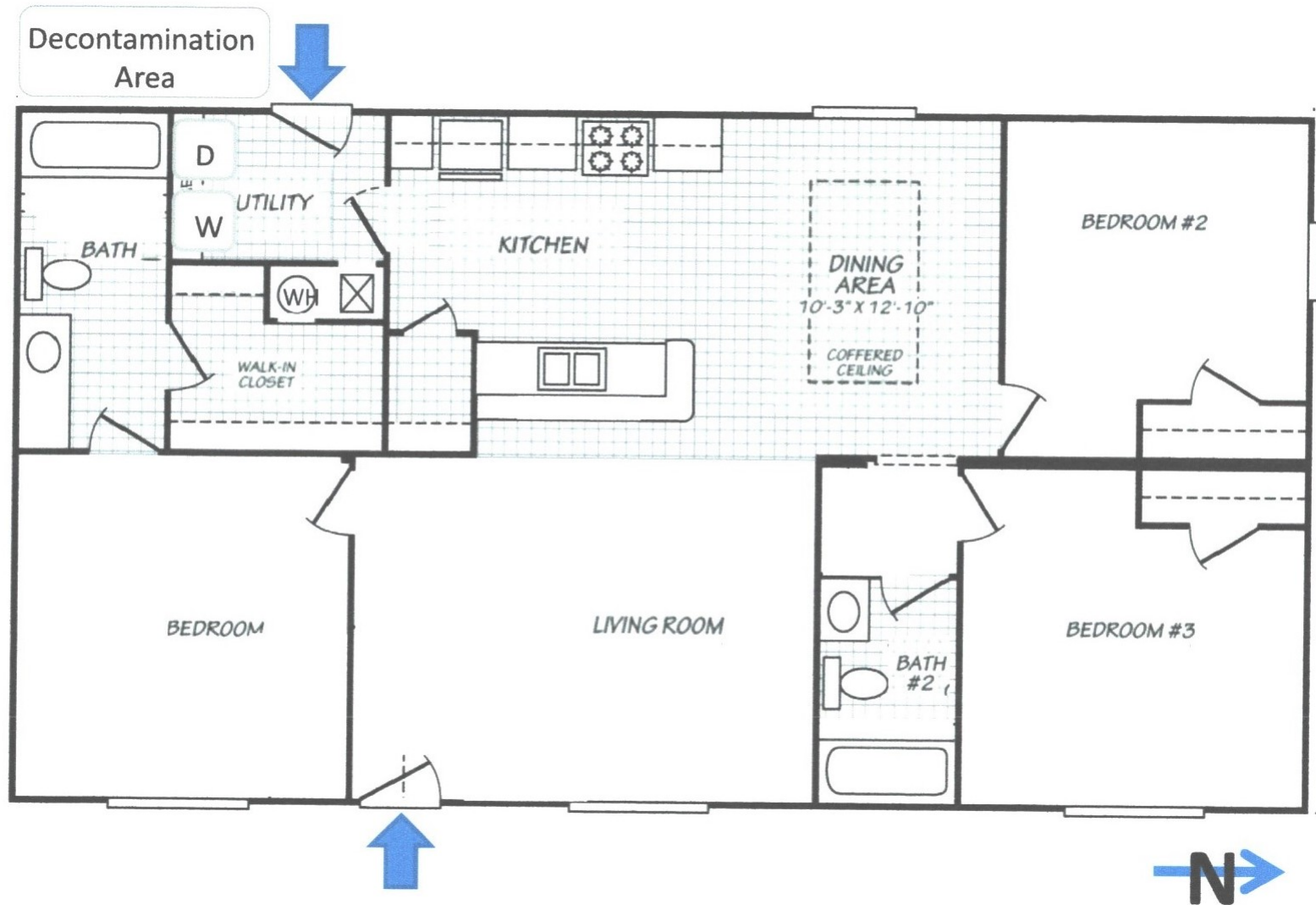

Why do we need a firehouse on Marrowstone island?

911 response times to the Island exceed 14 minutes from the closest career-staffed fire station. The presence of a volunteer crew quarters will facilitate members of EJFR's Volunteer Intern Firefighter cohort to staff the station during periods of peak demand. It will also strengthen the Island's ability to remain resilient during a large earthquake, which may isolate the island for an extended period. If we want crew on the island, we need a place for them to be ***that has required facilities like a place to decontaminate after a call.***

Besides faster emergency response times, having Station 1-2 here may reduce homeowners' insurance premiums, particularly for residents on the northern end of the island.

How will it be used?

Like most rural fire departments in the US, EJFR has a roster of volunteers to help it serve its large geographical community. Thirteen of the roughly 50 EJFR volunteers were able to staff the ambulance during a June 2021 Pilot Study on the island, but there was no place to house the volunteers. They spent their 12-hour shifts mostly inside their vehicles which was hard on both them and the vehicles. You can read EJFR's synopsis of the study here: [June 2021 Pilot Study](#)

Why is the Marrowstone Island Foundation (MIF) raising money for the firehouse?

The Marrowstone Island Foundation is the child of the Marrowstone Emergency Medical Service [MEMS] which was created in 1978 entirely with donations of time and money from residents. Prompt, life-saving response to medical emergencies was delivered by island volunteers who trained as EMTs and First Aider/Drivers, and was free of charge.

When emergency response services were taken over by Jefferson County Fire Protection District No. 1 (now EJFR) in March, 2001, MEMS had \$109,568.13 left in its coffers. MIF was formed to hold those funds in a restricted account per the bylaws: *“Original funds (hereafter designated as principle) received from MEMS by the Foundation may not be disbursed for other than investment purposes except in a time of general Island emergency as declared by the full Board of Directors.”*

Besides holding that money in trust to be spent only during a time of general emergency, MIF has stayed committed to restoring better emergency response times to island residents.

What will the new firehouse cost?

WATCH THIS SPACE . . .

After an extensive search of companies that provide modular buildings suitable for crew quarters, the best offer came from Wilder Affordable Homes of Port Angeles for a building manufactured by Fleetwood Homes of Woodburn, Oregon. Their initial estimated total cost for the building, delivery, and WA sales tax, which we must pay, was 7 dollars shy of \$140K.

However, by August of 2021, when our purchase agreement was signed, lumber prices were fluctuating wildly and no company would guarantee the final price. The price of the firehouse is set to be finalized 45 days before final delivery in August. To protect the community, MIF wrote into the contract that if MIF deemed any cost increases to be unreasonable they could cancel the agreement at no cost to MIF.

AS SOON AS WE HAVE A LOCKED-IN FINAL COST WE WILL LAY OUT ALL THE FIGURES FOR YOU. WE'LL POST IT HERE, THROUGH GROUPS.IO, AND POINT NEXTDOOR USERS TO THE FIGURES ON OUR WEBSITE.

STAY TUNED.

How much money has MIF already raised for the firehouse and why are additional funds needed?

Through the generous donations of Marrowstone Island residents and property owners MIF has raised \$128,069 to date for this project.

We expect to get our “locked in” price for the firehouse 45 days before final delivery in August, roughly mid-June, and when we do we will present all the financial details to the community and launch a fundraiser to complete MIF’s part of the project.

What is East Jefferson Fire and Rescue (EJFR) responsible for funding?

EJFR is solely responsible for site preparation, foundation/slab construction, infrastructure construction costs, utility connections, final grading and site improvement, landscaping, and final finishings and severable (personal property) for the lodging quarters.

EJFR agreed to have the site ready for delivery and positioning of the building on or before the delivery date. To this end, EJFR has secured the building permits for the infrastructure construction. EJFR will assume full responsibility for maintenance of the fire house once ownership has been transferred to them.

Email us with any other questions you might have at marrowstoneislandfoundation@gmail.com

Thank you for your continued support of this important step toward strengthening Marrowstone Island's community resilience.

Your MIF Board of Directors