

## WEARABLE BASICS

### WEAR WEARABLE

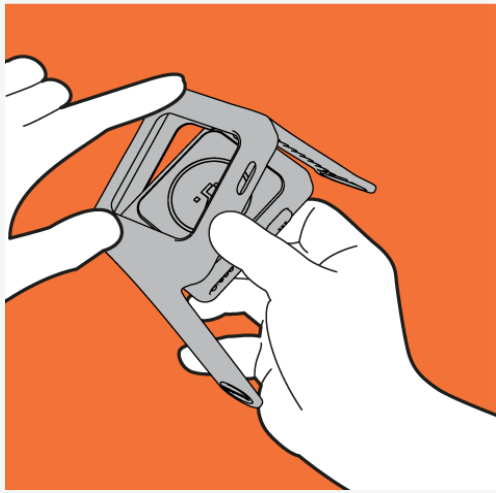

Put the wearable in its case through the back of the case, **never through the front.**

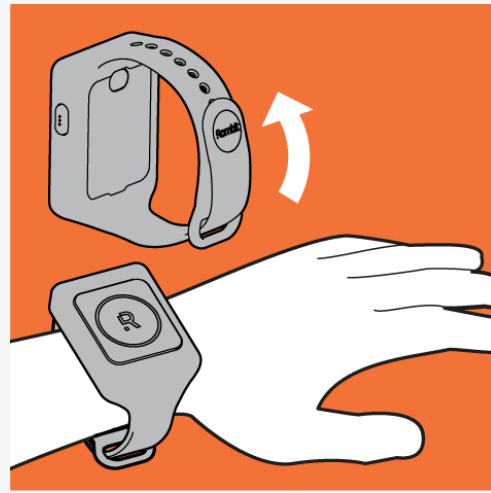

Put the band through the clasp.

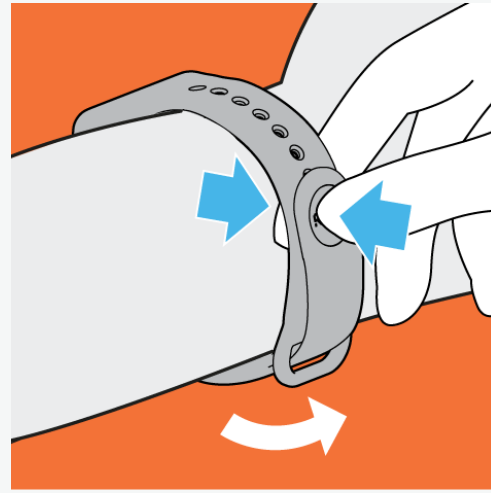

Push the band into two holes to lock it.

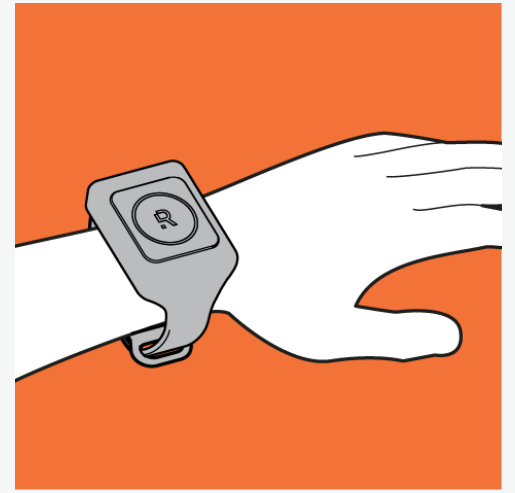

Make sure the wearable is tight enough.

### TURN THE WEARABLE ON AND OFF

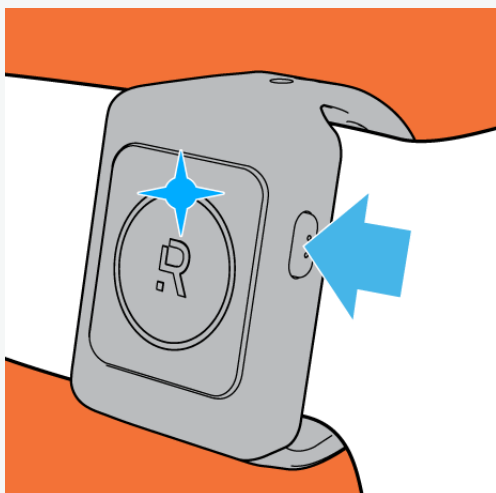

Press the side button until you see a blue light.

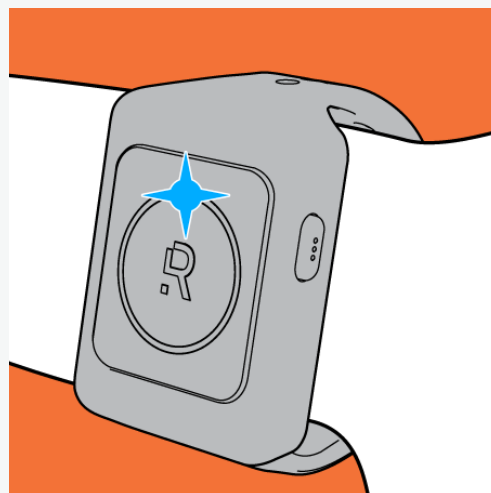

The light blue light flashes: the wearable is connecting.



When a short dark blue light appears, the wearable is connected and ready to use.

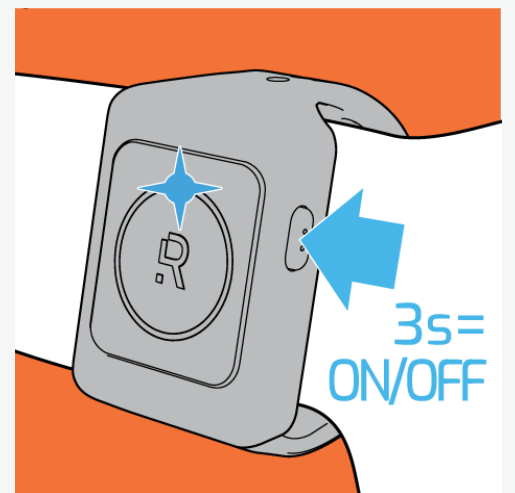

Press the side button for three seconds to turn the wearable off.

### CHARGE WEARABLE



Take the wearable out of its casing through the back, **never through the front.**

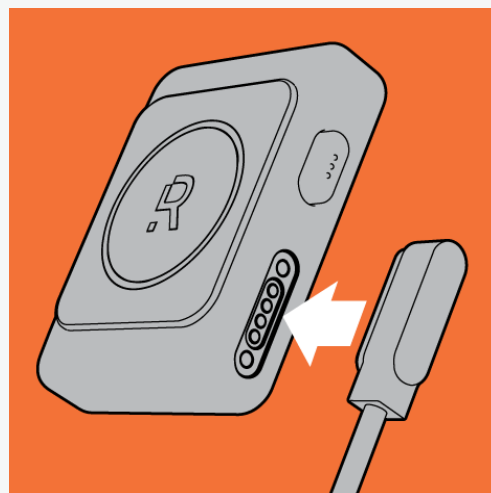

Attach the charger to your wearable on its side.



The wearable **is charging** when it blinks orange. Let it charge for some time.



A green light means the wearable is **fully charged.**