



Sponsor & Vendor Marketplace

# HERHEALTH SUMMIT

Science for the Body. Wisdom for the Mind. Strength for the Soul  
October 28th, 2026 | Mizner Studio | Boca Raton

A SoulTech Foundation benefit supporting charities uplifting women and children including: Healthy Mothers, Healthy Babies; Speak Up for Kids, Sweet Dream Makers, and Kindness Matters.

Event Sponsors:



PAIGE KORNBBLUE *Media*

INTENTION



Monica McMahon  
GET FIT RETREATS



GREENHOUSE WELLNESS  
SARA STARKOFF GREEN

Secure Tickets

# About HER Health Summit

## Women's Unique Health Challenges

Shining a light on overlooked pain, hormonal health, menopause, mental health, and the pursuit of longevity.

## Science & Holistic Practices

Built at the intersection of cutting-edge medical research and time-tested wellness practices. HER Health will address and share women's total mind-body-soul experience. Guests will have access to the HER Health Library of the presentations, research, and the post-event HER Health Report.

## Pioneers & Experts

Leaders in medicine, wellness, yoga, psychology, media, and conscious living, united around women's health.

## Empowerment & Community Impact

Attendees leave with tools, knowledge, and community support, while proceeds benefit the SoulTech Foundation and five South Florida charities.

## Men as Allies

Most women-focused events exclude men. At the HER Health Summit, we embrace men as a necessary part of the conversation, so they can learn, share their perspective, and be a necessary part of the solution.

Together, the summit advances both the conversation around women's health and the organizations working to improve women's lives.



# The Truth About Women's Health

For generations, women's health conversations have been incomplete.



**Pain Dismissed**



**Hormones  
Misunderstood**



**Menopause  
Ignored**



**Mental Load Invisible**



**Vastly Under-researched**

HER Health Summit creates a space where women, and the men who care about them, finally speak honestly about the realities of women's bodies, health, aging, and wellbeing.

This is not just a wellness event. It is a movement to elevate the conversation around women's health while supporting organizations working to improve women's lives.



# Why Partner with HER Health Summit

## *Where Purpose, Visibility, and Impact Converge.*

Partnering with the **HER Health Summit** positions your brand at the center of a rapidly growing movement — one dedicated to redefining women’s wellness, elevating conscious leadership, and shaping a healthier, more empowered future. This is more than sponsorship; it is meaningful alignment with the mission-driven women driving change.



### Visibility That Matters

Your brand will be showcased in front of an influential audience of women leaders, innovators, and wellness-forward consumers. This is premium visibility with individuals who value authenticity, purpose, and partnership.



### Credibility Through Powerful Association

By aligning with respected experts, doctors, bestselling authors, and wellness pioneers, your brand stands shoulder-to-shoulder with the voices shaping modern women’s health. This alignment enhances your credibility and reinforces your commitment to the wellbeing of women everywhere.



### Engagement That Builds Lasting Loyalty

This summit creates an environment designed for deep connection and meaningful exchange. Attendees come ready to discover trusted partners, explore wellness solutions, and build relationships — making this a rare opportunity for direct, high-value engagement.



### Impact That Extends Beyond the Event

Your partnership contributes to a movement that is redefining wellness for this generation and the next. By supporting HER Health, you help create lasting change in how women care for their bodies, minds, careers, and communities.

# Her Health Summit

## Event Agenda

Emcees: Judy Weaver & Sara Starkoff Green

### MAIN STAGE

**9:00 AM** - Welcome & Opening Remarks  
**9:10 AM** - Paige Kornblue  
**9:30 AM** - Laura Waldorf Reiss  
**9:55 AM** - Cynthia L. Elliott  
**10:20 AM** - Speaker Q&A (Judy Weaver)  
**10:40 AM** - Break: Tea & Vendors  
**11:00 AM** - Dr. Francesca Lewis  
**11:20 AM** - Dr. Shivani Gupta  
**11:40 AM** - Dr. Amy Wecker  
**12:00 PM** - Menopause Panel (Sara Starkoff Green)  
**12:30 PM** - Break: Tea, Cocktails & Bites  
**1:00 PM** - Becca Tebon  
**1:20 PM** - Dr. Michelle Weiner  
**1:50 PM** - Future of Women's Health Panel  
**2:10 PM** - Men's Panel (Sara & Judy)  
**2:35 PM** - Break: Tea, Cocktails & Vendors  
**3:00 PM** - Living Legend & Icon Awards  
**3:15 PM** - Film Screening  
**3:35 PM** - Film Screening  
**4:00 PM** - Closing Remarks

### WELLNESS STAGE

**9:30 AM** - Yoga & Wellbeing (Brie Larson)  
**9:30 AM** - Yoga & Wellbeing (Brie Larson)  
**11:00 AM** - The Power of Meditation (Monica McMahon)  
**12:00 PM** - Success & the Single Mother (Charlene Brigantry)  
**1:20 PM** - Personal Empowerment (Dr. Lisa Ray)

# 1st Floor Lobby — Grand Arrival Experience

## Floor Plan

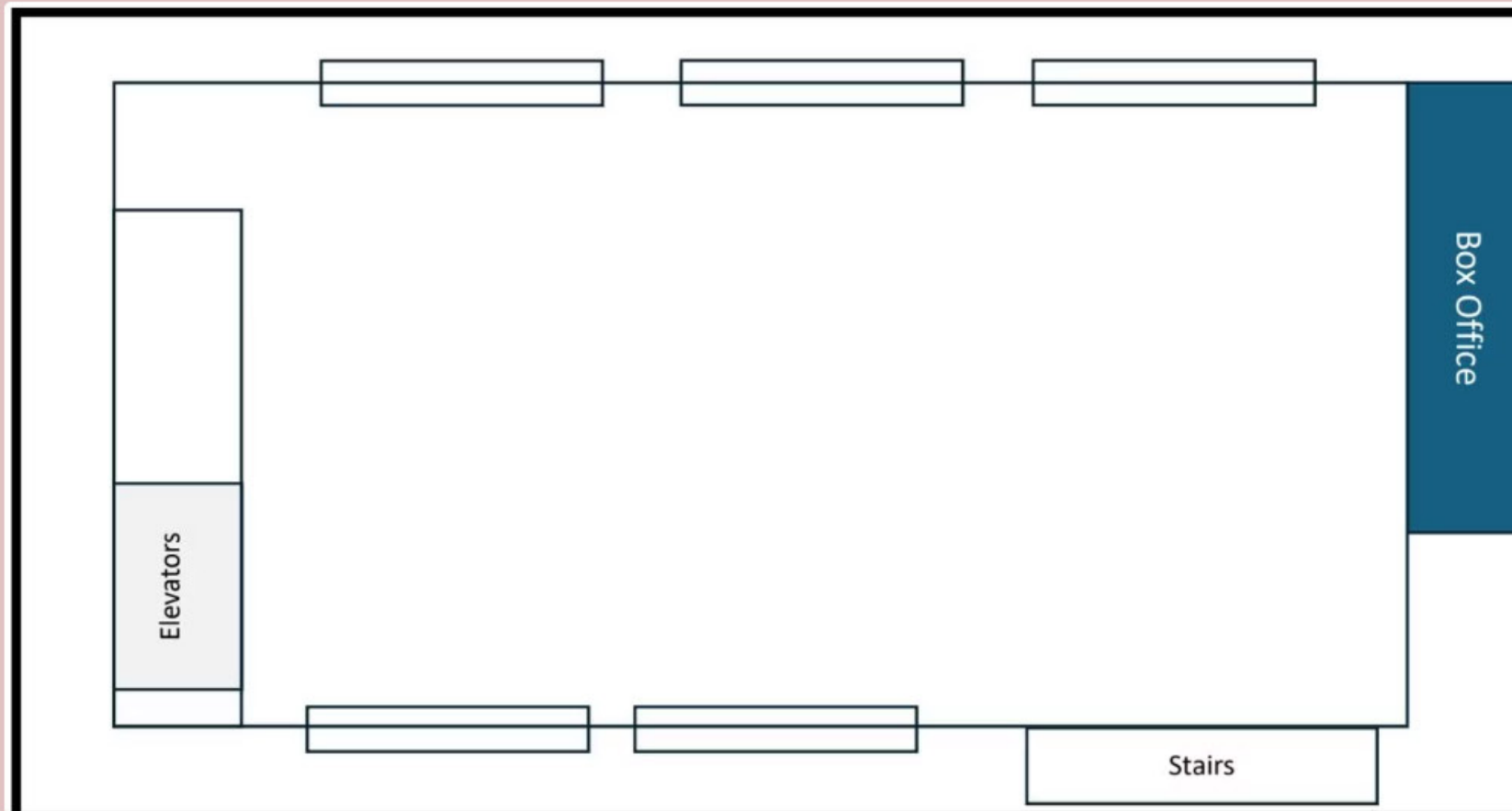

Rectangular lobby with elevators (left), Box Office (right), and open central space — transformed into a welcoming arrival zone.

## Design Elements



# 2nd Floor — Atrium Exhibit Hall

## Floor Plan (2,500 sq ft)

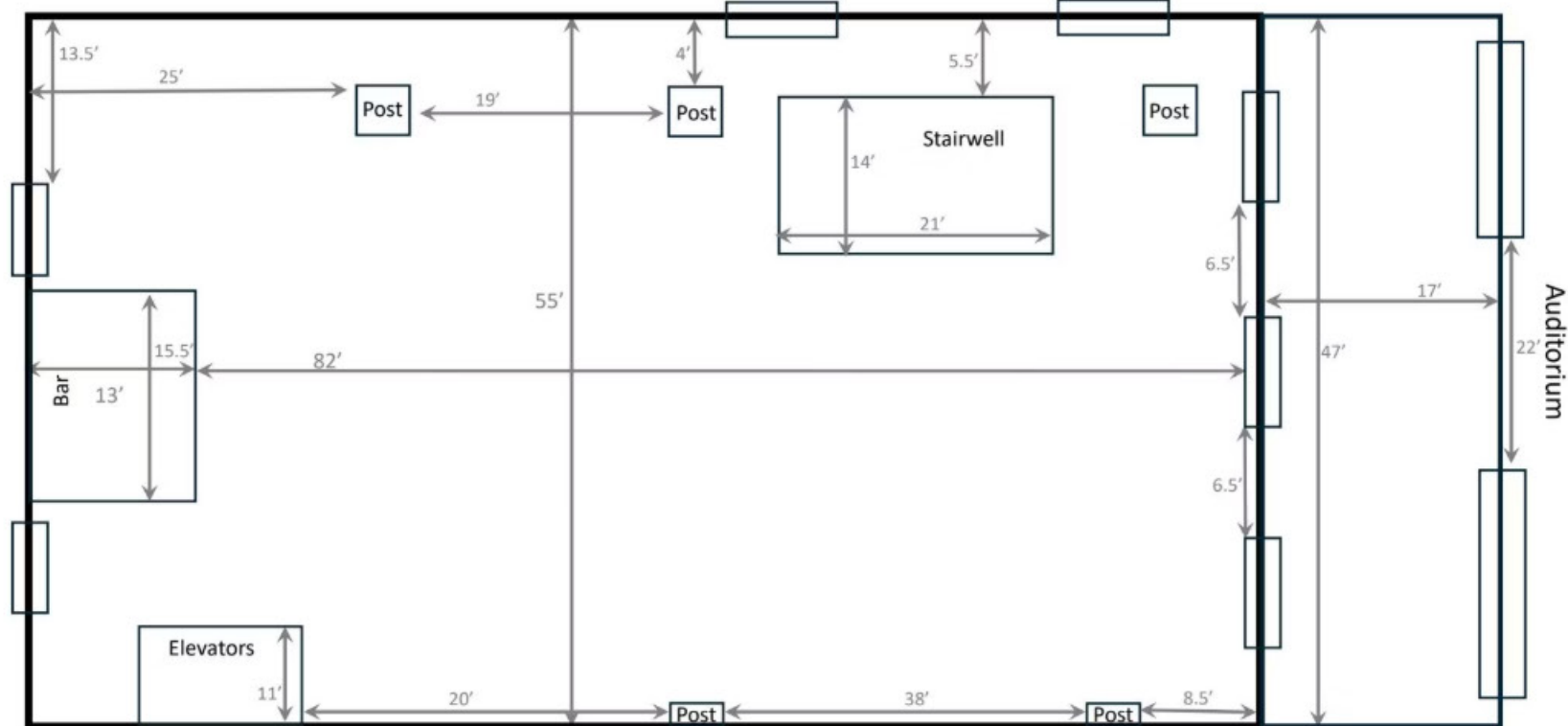

82' x 55' open hall with bar (left), stairwell (center-right), elevators (bottom-left), and auditorium access (far right). Six structural posts distributed throughout.



# Black Box Theater — Main Stage (340 Seats)

Auditorium Floor Plan

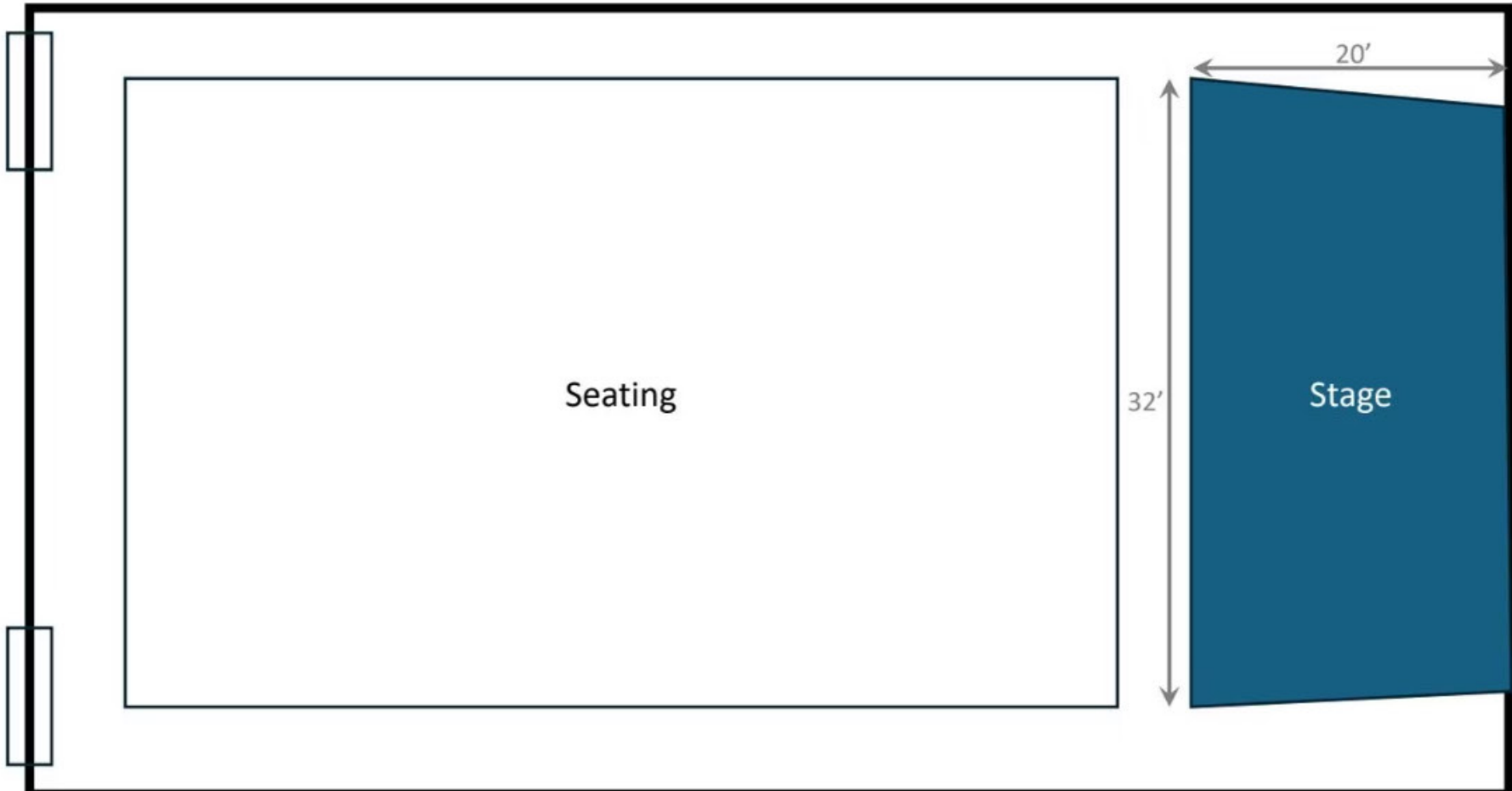

Seating area 32' deep, stage 20' wide × 28' tall — ample room for a commanding triple-screen setup and full stage production.

Stage Design



# Club Room — Wellness Room & Stage

NOTE: TITLE SPONSOR BRANDED

## Space Overview

~1,500 sq ft square room with a dramatic two-story Palladian window — natural light floods the space, making it ideal for a serene wellness sanctuary.



## Yoga Floor

50+ yoga mats arranged in rows facing the Wellness Stage, with ample movement space.



## Nature Decor

Botanical installations, living plants, and earthy textures create a grounding, restorative atmosphere.



## Wellness Stage

Intimate stage for movement classes, breathwork, and wellness speakers.



# Cymatics Tea Lounge

## 1,000 sq ft Balcony

Open-air porch just off the bar — a breathtaking outdoor retreat with views and fresh air.

## Cymatics Water Art

A mesmerizing cymatics water display at the center of the balcony — sound frequencies made visible through water, creating a living art installation.

## Tea Lounge Seating

Curated seating with herbal teas, warm lighting, and soft music — the perfect sanctuary between sessions.

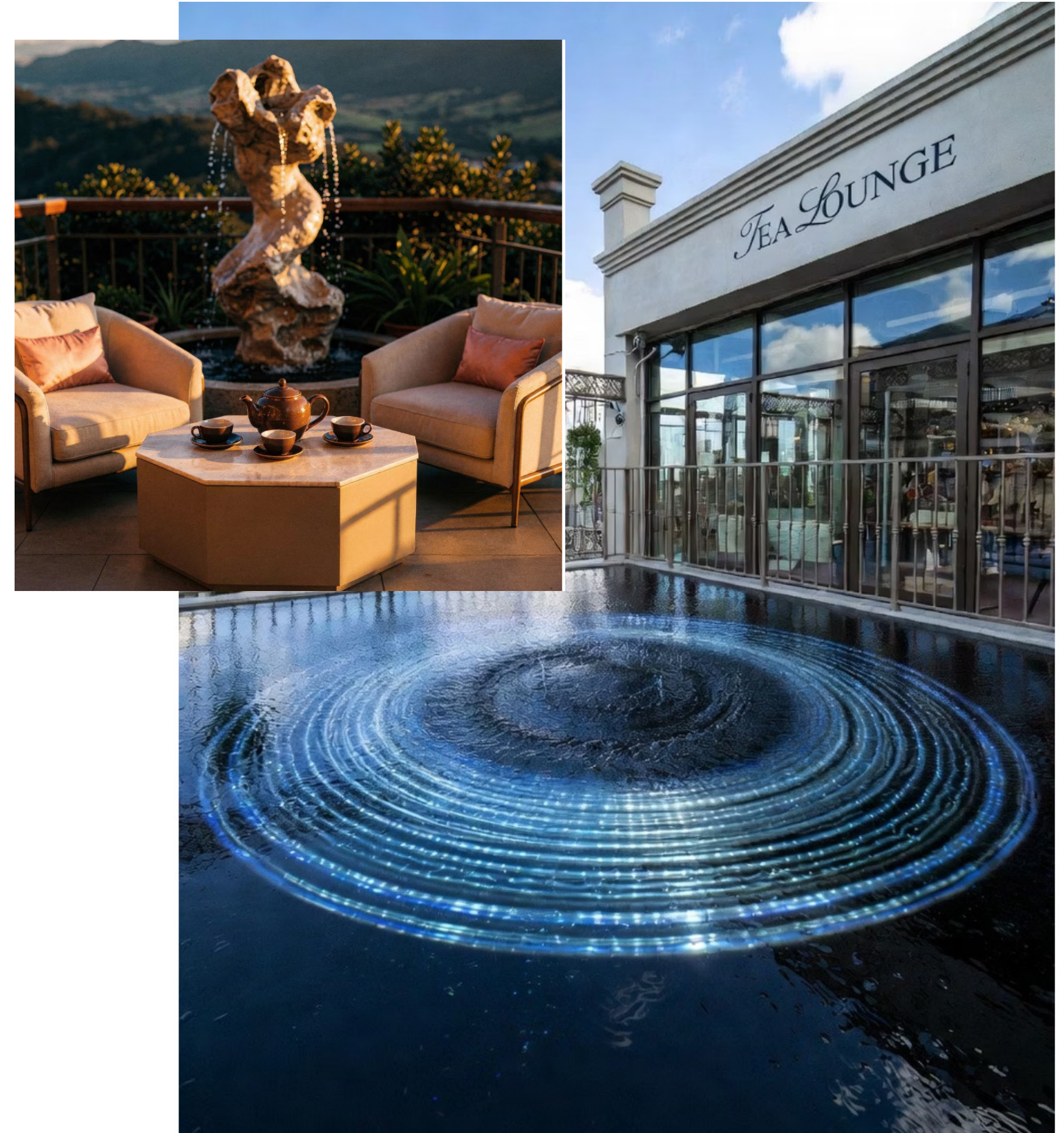

# HER HEALTH SUMMIT

## Sponsorship Opportunities

*Where Purpose Meets Visibility. Where Innovation Meets Influence. Where Brands Become Part of a Movement Changing the Future of Women's Wellness.*

At the **HER Health Summit**, sponsors don't just place logos, **they take the stage in a revolution.**

By partnering with us, you align your brand with groundbreaking research, industry-leading speakers, and a growing community of influential women. This is more than exposure; it is a chance to drive **cultural impact** and **brand elevation** by supporting the women shaping our future.

Whether you champion longevity, mental health, sustainability, or future-forward solutions for women, **you belong here.**

### Event Sponsors:





# Title Sponsorship: \$25,000

*Become the Name Behind the Movement.*

As the Presenting Partner of the HER Health Summit, your brand steps into the spotlight as the driving force behind a global shift in women's wellness. Seen everywhere and woven into every touchpoint, your presence radiates leadership, authority, and meaningful commitment to women's lives.

1

## Premier Co-Branding

"HER Health Summit — Presented by *Your Brand*."  
Your name becomes synonymous with empowerment, innovation, and wellness evolution.

2

## Marquee Speaking Opportunity

Command the stage with a keynote or high-impact panel appearance that aligns your mission with our movement.

3

## Dominant Visibility Across All Platforms

Stage screens, event signage, digital promotion, social campaigns — your brand leads every visual experience.

4

## Exclusive Media Mentions

Priority inclusion in PR outreach, press releases, and partner media channels.

5

## Luxury Activation Space

A premium, high-traffic footprint at the event entrance — designed to showcase your products, services, or experiences.

6

## Lifestyle Product Integration

Your premium product placed directly into attendee gift bags — a physical connection to your brand.

7

## 10 VIP All-Access Passes

Bring your leaders, clients, influencers, or partners to experience the event in elevated style.

# Presenting Sponsor | \$15,000

*Stand Out, Show Up, and Shape the Conversation.*

This level is ideal for brands who want strong visibility, meaningful engagement, and the power to activate onsite.

## Your Presenting Sponsorship Includes

- **Premium Logo Placement**  
On key signage, in the digital program, across social, and throughout the event marketing ecosystem.
- **Spotlight Social Media Feature**  
A dedicated promotional highlight introducing your brand to our growing audience.
- **Prime Activation Table**  
A high-visibility touchpoint where your team can meet attendees, demo products, or create experiential moments.
- **Gift Bag Product Inclusion**  
Extend your brand impact beyond the Summit with curated product placement.
- **6 VIP All-Access Passes**  
Perfect for teams, clients, or influencer partners.

## The Presenting Sponsor Promise

Your brand becomes a cornerstone of the Summit experience — seen, celebrated, and remembered.





## Supporting Sponsor | \$7,500

*Amplify Your Presence, Expand Your Reach.*

Ideal for forward-thinking brands that want to invest in women, wellness, and community impact.

### Your Supporting Sponsorship Includes

- **Logo Presence**  
Featured on the event website and program.
- **Engagement Space**  
Activation table for product or service promotion.
- **Gift Bag Placement**  
Put your brand in the hands of every attendee.
- **4 VIP All-Access Passes**

### The Supporting Sponsor Promise

A highly visible way to support a transformative event and connect with women seeking trusted wellness partners.

## Community Partner | \$2,500

*Support the Movement. Grow with the Community.*

A perfect entry-level partnership for businesses who believe in uplifting women and aligning with conscious, purpose-driven events.

### Your Community Partnership Includes

- **Logo Visibility**  
Featured on select signage and event webpage.
- **Gift Bag Inclusion**  
Offer attendees a touch of your brand.
- **2 VIP All-Access Passes**

### The Community Partner Promise

You play a vital role in creating the supportive ecosystem that makes women's wellness thrive.



# Vendor Booth Options

## ✨ Atrium Exhibit Hall — 2,500 sq ft

Designed for seamless flow, high visibility, and natural engagement. Every vendor benefits from thoughtful placement and elevated ambiance.

- Perimeter vendor marketplace with full traffic flow
- Central open networking space for organic connection
- Bar + Tea Lounge to encourage longer guest dwell time
- Elevated branding, ambiance, and design throughout

## ☀️ Booth Options

### Premium Placement

#### Booths 110–124

High-traffic, prime visibility areas

\$350

### Standard Booths

#### Booths 101–109 & 125–129

Excellent perimeter exposure

\$250

**i** Payment secures your space — first come, first served.

# Atrium Exhibit Hall

Red boxes or numbers indicate a booth is reserved

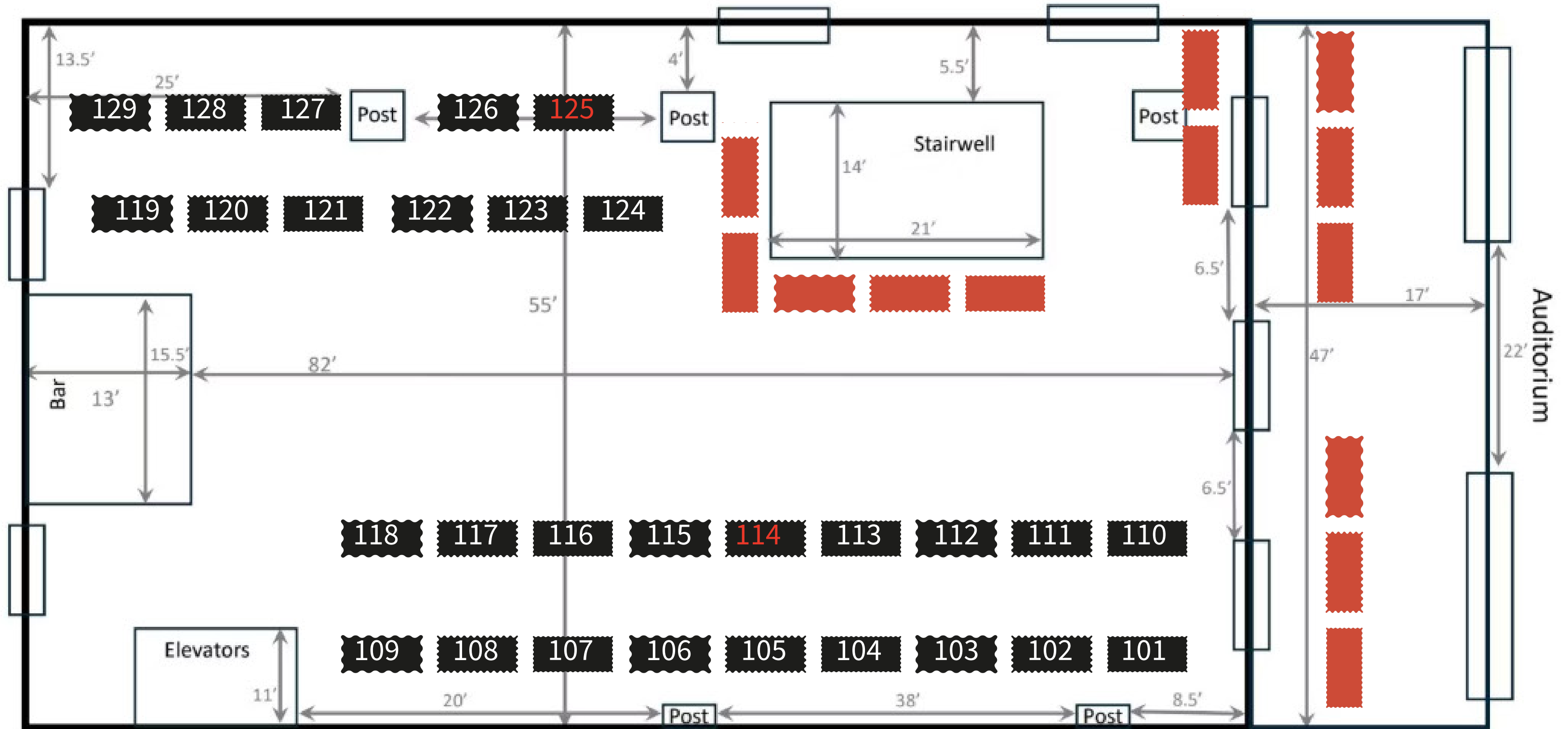

# What's Included & Who Should Exhibit

## Every Booth Includes

01

---

6-foot table with linen aligned to event aesthetic

02

---

Vendor listing in event materials (if submitted on time)

03

---

Access to a curated, high-quality audience

04

---

Opportunity to sell products & services onsite

05

---

Social media inclusion with select features

## Ideal Vendors



### Wellness & Holistic Health

Brands rooted in whole-body well-being



### Beauty & Skincare

Self-care products and conscious cosmetics



### Spiritual & Mindfulness

Personal growth, fitness & lifestyle services

Also: Nutrition & supplements, women-focused founders, conscious fashion & accessories

# How to Apply

This is not a typical expo. This is a **high-vibe, intentional space** where people come to connect — not just browse. Your brand becomes part of a larger experience, and you gain **real customers, not just impressions**.

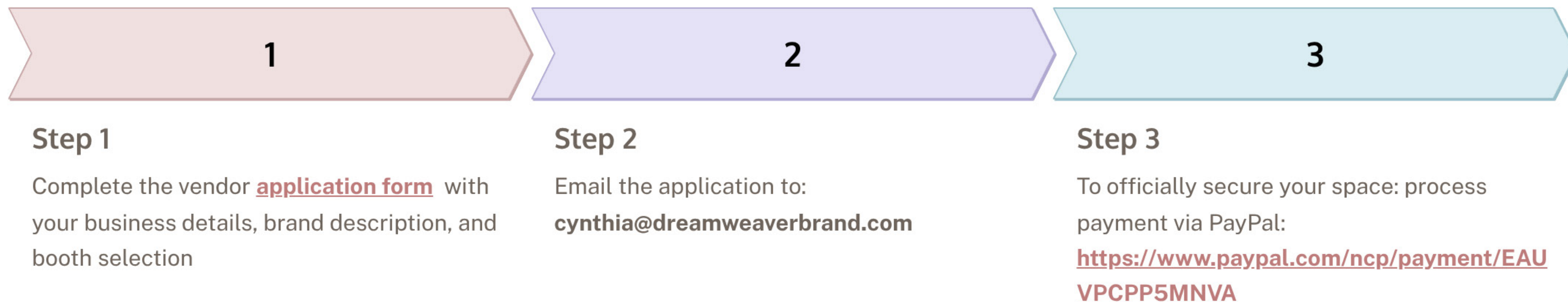

Booths are **limited and curated**. Placement is assigned based on flow, category, and availability. Setup details and event logistics will be shared upon acceptance.

Join us in creating something truly special. Show up, stand out, and connect with a community that is ready to support and grow with you. **We can't wait to feature your brand at Her Health Summit.**

# HERHEALTH SUMMIT

## Vendor Application

### How to Apply

1. Complete the vendor application form below with your business details, brand description, and booth selection.
2. Submit via email to [cynthia@dreamweaverbrand.com](mailto:cynthia@dreamweaverbrand.com).
3. Process payment to officially secure your space.

For payment, please use this [Paypal link](#) or scan the QR code here:



### Business Information

Business Name
Contact Name
Email Address
Phone Number
Website / Social Media

### Brand Details

Products/Services Offered
Price
Range

### Booth Selection

Premium Booths (110–124) – \$350
Standard Booths (101–109 & 125–129) – \$250
Preferred Booth Number(s)

### Logistics

As the event approaches, the Her Health Team will share full logistics information for the Summit. Be prepared to set-up your 6 foot table at 7am with tear-down set for 5PM. Email with any questions: [cynthia@dreamweaverbrand.com](mailto:cynthia@dreamweaverbrand.com)

# Join the Movement

October 28th, 2026

Mizner Studio, Boca Raton, FL

HER Health Summit is more than an event. It is a revolution in women's wellness. It is the future, and it starts here. Together, we rise. Together, we heal. Together, we thrive.

Contact Information: To learn more about the event and sponsorships, contact [Cynthia@DreamweaverBrand.com](mailto:Cynthia@DreamweaverBrand.com) or 786-531-7842.

HER Health Summit, produced by the SoulTech Foundation, the home of education that helps underserved communities thrive in the age of AI.

## Event Sponsors:



PAIGE KORNBLUE *Media*

INTENTION



GREENHOUSE WELLNESS  
SARA STARKOFF GREEN

Monica McMahon  
GET FIT RETREATS



GOLDEN RAY  
BOOK PUBLISHING

Secure Tickets

