

*alton* **maltings**



# Room Diagrams

# Community Space

## Room Dimensions

Length	10.23m
Width	5.46m
Height	3.5m
Area	55.85m <sup>2</sup>

*alton* **maltings**  
a community initiative of *harvestchurch*



Booking ref.	
Client name	
Booking date	

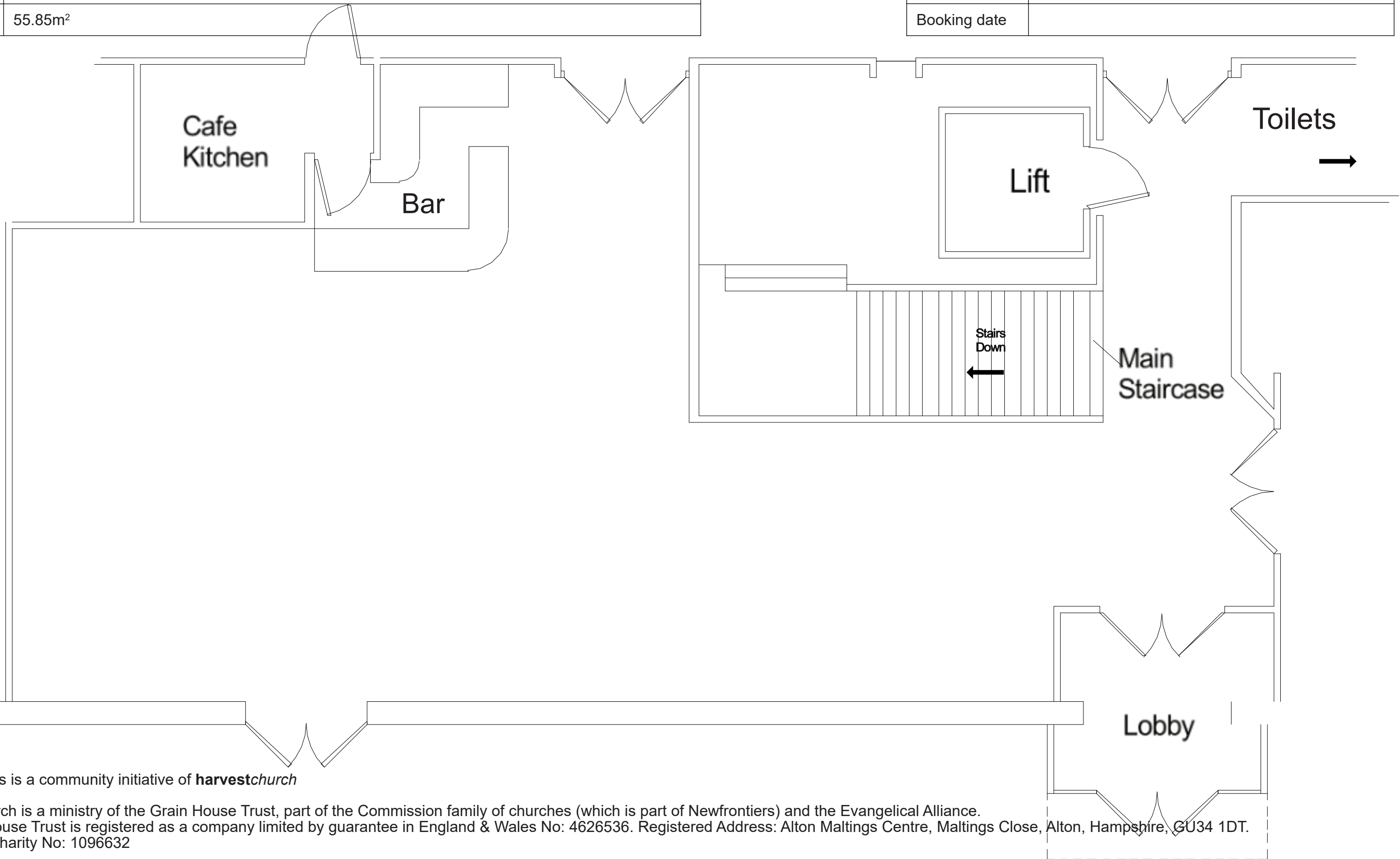

Alton Maltings is a community initiative of **harvestchurch**

Harvest Church is a ministry of the Grain House Trust, part of the Commission family of churches (which is part of Newfrontiers) and the Evangelical Alliance. The Grain House Trust is registered as a company limited by guarantee in England & Wales No: 4626536. Registered Address: Alton Maltings Centre, Maltings Close, Alton, Hampshire, GU34 1DT. Registered Charity No: 1096632

# Tyndale

altonmaltings



## Room Dimensions

Length	27.64m
Width	12.42m
Height	15m
Area	343.28m <sup>2</sup>

Booking ref.	
Client name	
Booking date	

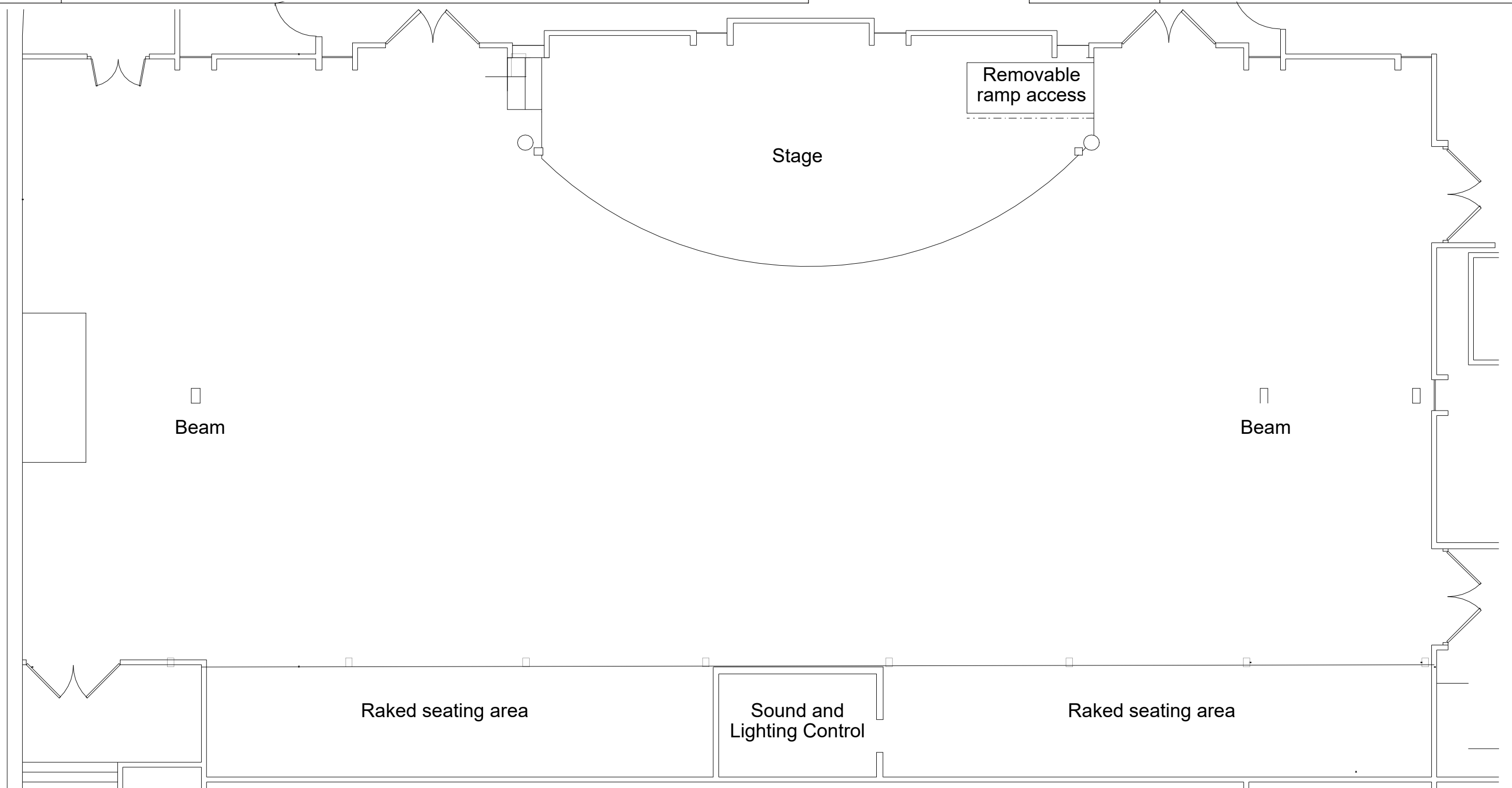

Alton Maltings is a community initiative of **harvestchurch**

Harvest Church is a ministry of the Grain House Trust, part of the Commission family of churches (which is part of Newfrontiers) and the Evangelical Alliance. The Grain House Trust is registered as a company limited by guarantee in England & Wales No: 4626536. Registered Address: Alton Maltings Centre, Maltings Close, Alton, Hampshire, GU34 1DT. Registered Charity No: 1096632

# Wesley

## Room Dimensions

Length 19.54m

Width 9.52m

Height 3.5m

Area 186.11m<sup>2</sup>

altonmaltings



Booking ref.

Client name

Booking date

Laminate  
flooring

Carpet  
flooring

Sound  
control

Alton Maltings is a community initiative of **harvestchurch**

Harvest Church is a ministry of the Grain House Trust, part of the Commission family of churches (which is part of Newfrontiers) and the Evangelical Alliance.  
The Grain House Trust is registered as a company limited by guarantee in England & Wales No: 4626536. Registered Address: Alton Maltings Centre, Maltings Close, Alton, Hampshire, GU34 1DT.  
Registered Charity No: 1096632

# Shaftesbury

altonmaltings



## Room Dimensions

Length	9.53m
Width	6.56m
Height	3.5m
Area	62.55m <sup>2</sup>

Booking ref.	
Client name	
Booking date	

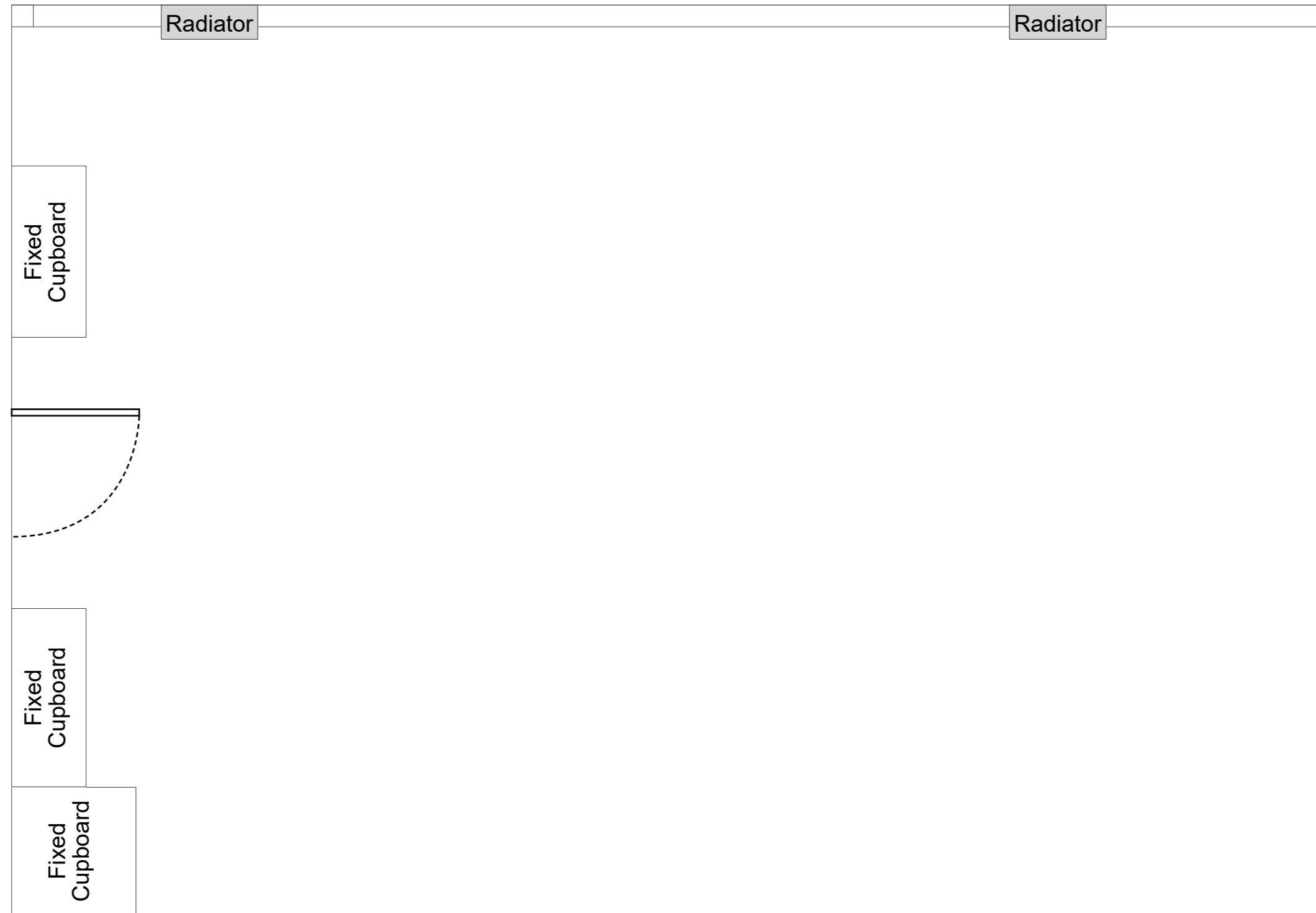

Alton Maltings is a community initiative of **harvestchurch**

Harvest Church is a ministry of the Grain House Trust, part of the Commission family of churches (which is part of Newfrontiers) and the Evangelical Alliance. The Grain House Trust is registered as a company limited by guarantee in England & Wales No: 4626536. Registered Address: Alton Maltings Centre, Maltings Close, Alton, Hampshire, GU34 1DT. Registered Charity No: 1096632

# Nightingale

altonmaltings



## Room Dimensions

Length	9.43m
Width	6.78m
Height	3.5m
Area	63.46m <sup>2</sup>

Booking ref.	
Client name	
Booking date	

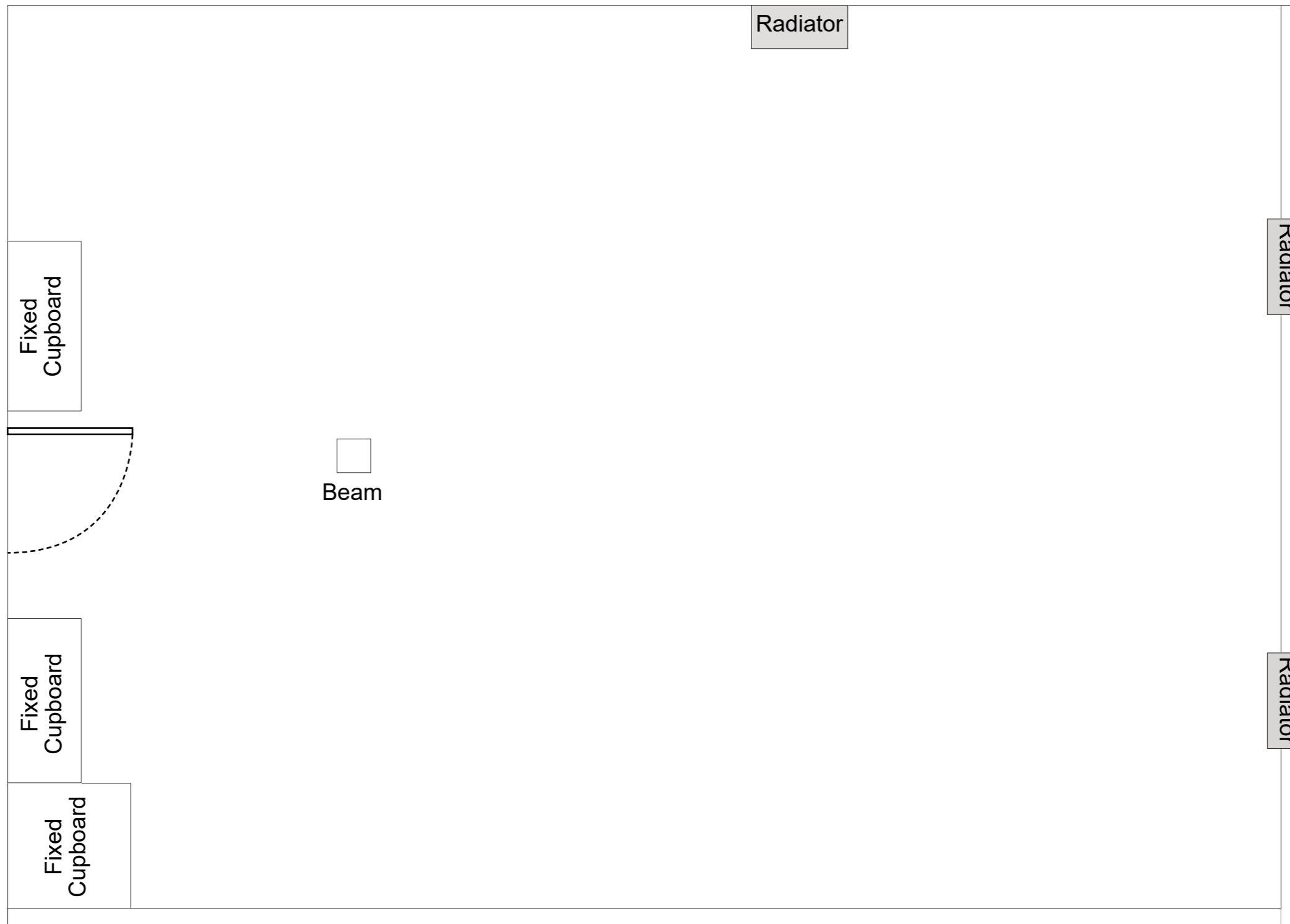

Alton Maltings is a community initiative of **harvestchurch**

Harvest Church is a ministry of the Grain House Trust, part of the Commission family of churches (which is part of Newfrontiers) and the Evangelical Alliance. The Grain House Trust is registered as a company limited by guarantee in England & Wales No: 4626536. Registered Address: Alton Maltings Centre, Maltings Close, Alton, Hampshire, GU34 1DT. Registered Charity No: 1096632

# Wilberforce

## Room Dimensions

Length	10.02m
Width	4.81m
Height	3.5m
Area	48.19m <sup>2</sup>

altonmaltings



Exit to  
sunken  
patio

Booking ref.

Client name

Booking date

Radiator

Alton Maltings is a community initiative of **harvestchurch**

Harvest Church is a ministry of the Grain House Trust, part of the Commission family of churches (which is part of Newfrontiers) and the Evangelical Alliance.  
The Grain House Trust is registered as a company limited by guarantee in England & Wales No: 4626536. Registered Address: Alton Maltings Centre, Maltings Close, Alton, Hampshire, GU34 1DT.  
Registered Charity No: 1096632

# Carmichael

## Room Dimensions

Length	9.23m
Width	4.46m
Height	3.5m
Area	41.16m <sup>2</sup>

altonmaltings



Booking ref.	
Client name	
Booking date	



Radiator

Alton Maltings is a community initiative of **harvestchurch**

Harvest Church is a ministry of the Grain House Trust, part of the Commission family of churches (which is part of Newfrontiers) and the Evangelical Alliance. The Grain House Trust is registered as a company limited by guarantee in England & Wales No: 4626536. Registered Address: Alton Maltings Centre, Maltings Close, Alton, Hampshire, GU34 1DT. Registered Charity No: 1096632



# Spurgeon

altonmaltings



## Room Dimensions

Length 9.83m

Width 4.88m

Height 3.5m

Area 48.11m<sup>2</sup>

Booking ref.

Client name

Booking date

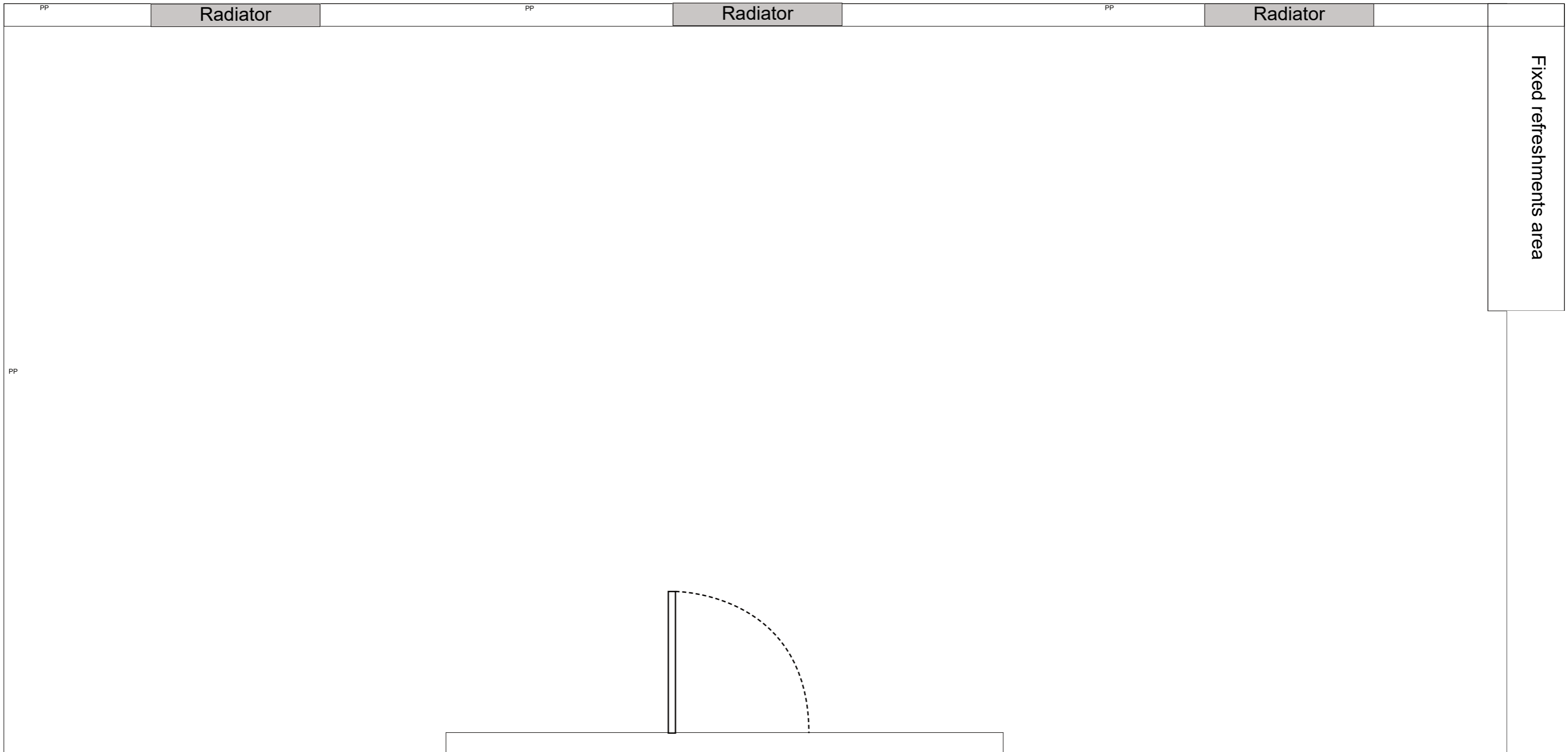

Fixed refreshments area

Alton Maltings is a community initiative of **harvestchurch**

Harvest Church is a ministry of the Grain House Trust, part of the Commission family of churches (which is part of Newfrontiers) and the Evangelical Alliance. The Grain House Trust is registered as a company limited by guarantee in England & Wales No: 4626536. Registered Address: Alton Maltings Centre, Maltings Close, Alton, Hampshire, GU34 1DT. Registered Charity No: 1096632

# Quiet Room

## Room Dimensions

Length	5.23m
Width	4.46m
Height	3.5m
Area	23.33m <sup>2</sup>

altonmaltings



Booking ref.	
Client name	
Booking date	

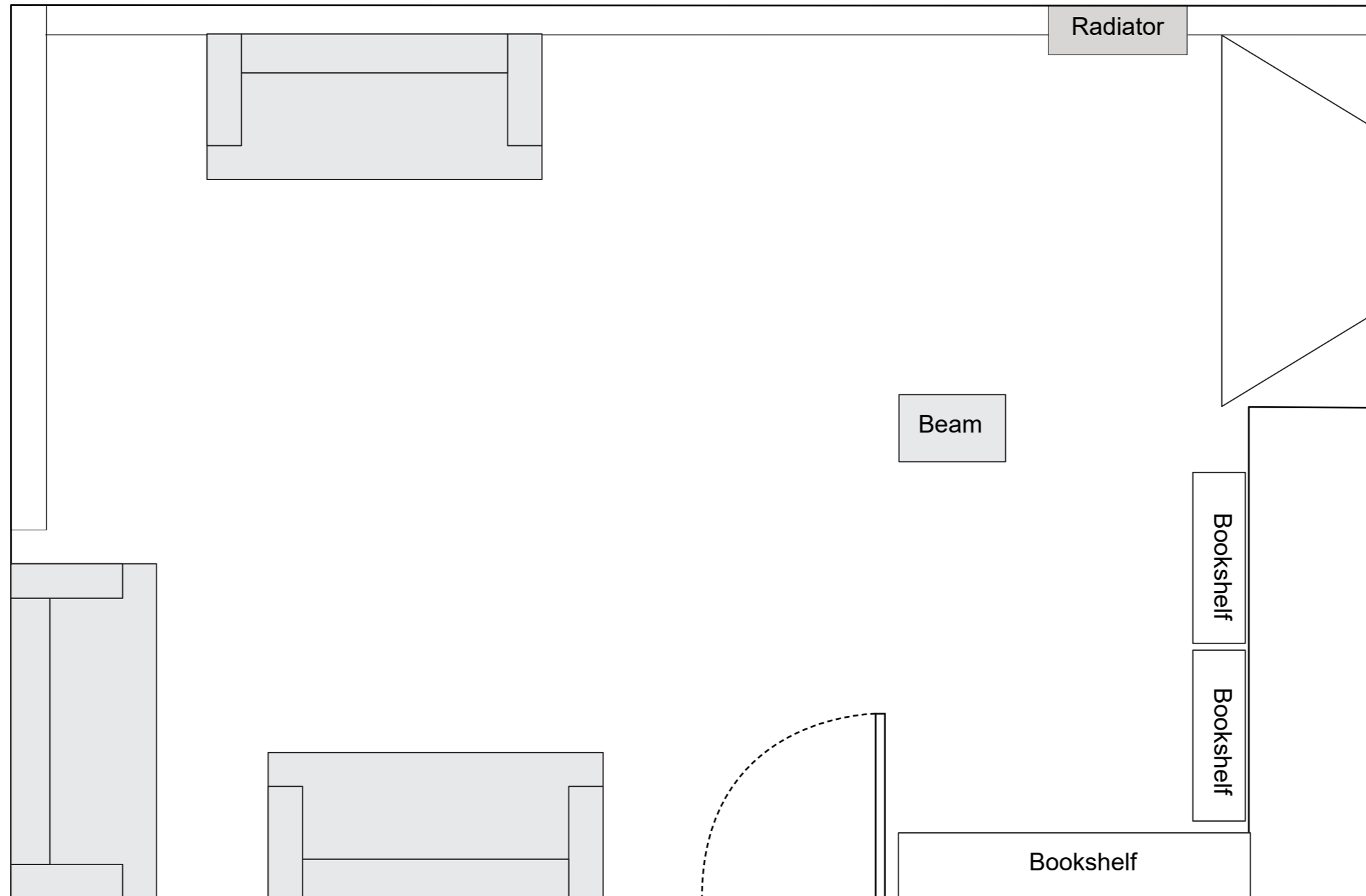

Alton Maltings is a community initiative of **harvestchurch**

Harvest Church is a ministry of the Grain House Trust, part of the Commission family of churches (which is part of Newfrontiers) and the Evangelical Alliance. The Grain House Trust is registered as a company limited by guarantee in England & Wales No: 4626536. Registered Address: Alton Maltings Centre, Maltings Close, Alton, Hampshire, GU34 1DT. Registered Charity No: 1096632

# Car Park

50 Spaces  
Including 2 accessible.

altonmaltings



Booking ref.	
Client name	
Booking date	

## Maltings Close

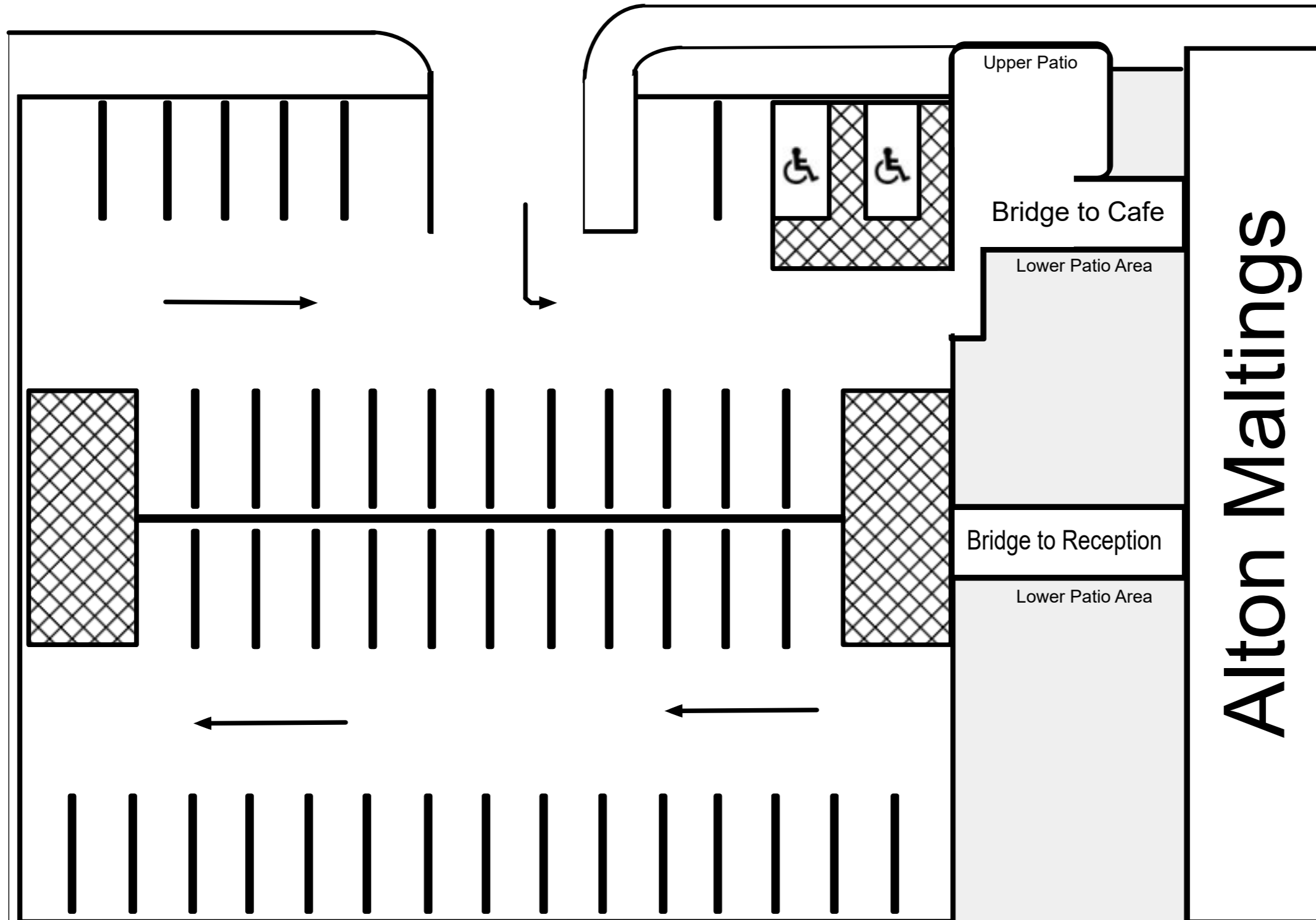

Alton Maltings is a community initiative of **harvestchurch**

Harvest Church is a ministry of the Grain House Trust, part of the Commission family of churches (which is part of Newfrontiers) and the Evangelical Alliance.  
The Grain House Trust is registered as a company limited by guarantee in England & Wales No: 4626536. Registered Address: Alton Maltings Centre, Maltings Close, Alton, Hampshire, GU34 1DT.  
Registered Charity No: 1096632