



AZ-AVD TXX

DUCT AIR VELOCITY TRANSMITTER

DESCRIPTION

The AZ-AVD T series of air velocity transmitters is engineered for building automation in the HVAC/R industry. The AVDT measures air velocity and temperature, with field selectable ranges and output options in a single device. Designed with a duct mount probe and adjustable collar suitable for round or rectangular ducts. Options include a relay, and a backlit LCD available in Metric or Imperial measurements.



TYPICAL INSTALLATION

For complete installation and wiring details, please refer to the product installation instructions. The AVDT should be mounted in an easily accessible location in a straight section of duct at least five feet from corners or other items that may cause disturbances in the air flow. Ensure that the end of the probe reaches the middle of the duct. Tighten the screws on the flange to hold the probe in position.

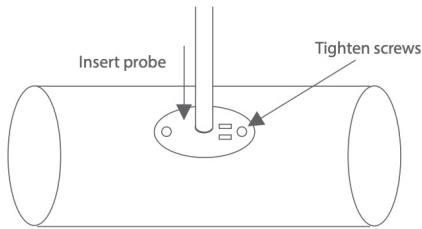
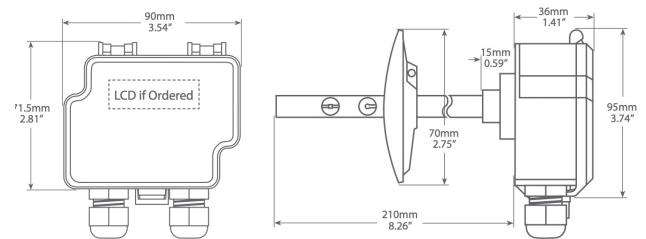

WIRING INFORMATION

TERMINAL	FUNCTION
TOUT	ANALOG OUTPUT
VOU T	ANALOG OUPUT
24 V	POWER SUPPLY
GND	COMMON
NC	DIGITAL OUTPUT
COM	COMMON
NO	DIGITAL OUTPUT

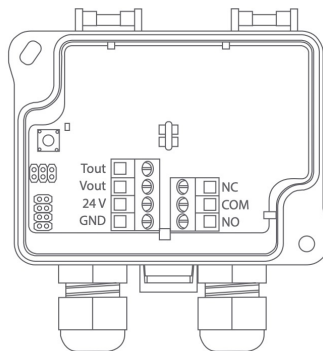

ORDERING

PRODUCT	AVD T	DUCT AIR VELOCITY TRANSMITTER
DISPLAY (REQUIRED IF RELAY OPTION SELECTED)	X M I	NONE METRIC (m/s, °C) IMPERIAL (FPM, °F)
RELAY	X R	NONE ADJUSTABLE RELAY (REQUIRES LCD)

PART NUMBER

AVDT

ALL RIGHTS RESERVED TO D-VAC SALES INC.
 200B VERDI STREET, FARMINGDALE NY 11735
SALES@DVACHVAC.COM
 516-256-3131





AZ-AVD TXX

DUCT AIR VELOCITY TRANSMITTER

SPECIFICATIONS

VELOCITY RANGES	Base & Metric Models: 0-2, 10 & 20m/s, field selectable Imperial Model: 0-400, 2000 & 4000 fpm, field selectable
VELOCITY ACCURACY	Metric: Range – 0...2 m/s: <0.2 m/s + 5% from reading Range – 0...10 m/s: <0.5 m/s + 5% from reading Range – 0...20 m/s: <1.0 m/s + 5% from reading Imperial: Range – 0...400 fpm: <20 fpm + 5% from reading Range – 0...2000 fpm: <100 fpm + 5% from reading Range – 0...4000 fpm: <200 fpm + 5% from reading
THERMAL SHIFT	±0.8 %FS / °C
CALIBRATION	Units calibrated at 22°C (71.6°F). Rapid thermal shift stabilization time 10 min.
TEMPERATURE RANGE	0 to 50°C (32 to 122°F)
TEMPERATURE ACCURACY	0.5 m/s (100 fpm)
OPERATING CONDITIONS	0 to 50°C (32 to 122°F), 0 to 95 %RH, non-condensing
STORAGE TEMPERATURE	-20 to 70°C (-4 to 158°F)
MEDIA COMPATIBILITY	Dry air or non-aggressive gases
OUTPUT SIGNAL 1 (TOUT)	0-10 Vdc (linear to temperature) L min 1K Ω 4-20 mA (linear to temperature) L max 400 Ω
OUTPUT SIGNAL 2 (VOUT)	0-10 Vdc (linear to m/s) L min 1K Ω 4-20 mA (linear to m/s) L max 400 Ω
OPTIONAL RELAY OUTPUT	Potential free SPDT (NC, COM, NO) 250 Vac, 6A / 30 Vdc, 6A adjustable switching point and hysteresis
POWER SUPPLY	24 Vdc / 24 Vac ±10%
CURRENT CONSUMPTION	Current: 75 mA (90 mA with relay) Voltage: 35 mA (50 mA with relay)
OPTIONAL DISPLAY	4 digit backlit display Size: 45.7mm W x 12.7mm H (1.79" x 0.5")
DISPLAY UNITS	Metric: m/s and °C Imperial: fpm and °F Alternating Velocity/Temperature in 5 second intervals
ENCLOSURE	Case: ABS Cover: Polycarbonate Ratings: IP54 (NEMA 3) Probe: 304 series stainless steel Mounting Flange: LLPDP
DIMENSIONS	Case: 90mm W x 71.5mm H x 36mm D (3.5" x 2.8" x 1.4") Probe: OD 10mm (0.394"), length 210mm (8.26") from bottom of cover
MOUNTING	Mounting Flange: Ø4mm (11/64")
INSERTION LENGTH WITH FLANGE	Adjustable 50 to 180mm (2" to 7.08")
DUCT WIDTH/DIAMETER	100 to 380 mm (4" to 15")
ELECTRICAL CONNECTIONS	Power Supply & Signal Out: 4-screw terminal block 12-24 AWG (0.2 to 1.5mm ²) Relay Out: 3-screw terminal block 12-24 AWG (0.2 to 1.5mm ²)
CABLE ENTRY	M16 (0.625") cable gland
WEIGHT	220g (7.76oz)
APPROVALS	CE, RoHS
COUNTRY OF ORIGIN	Finland

ALL RIGHTS RESERVED TO D-VAC SALES INC.
200B VERDI STREET, FARMINGDALE NY 11735
SALES@DVACHVAC.COM
516-256-3131

