

CODE TRANSMISSION - MANUAL REMOTE CONTROL TO RADIO RECEIVER

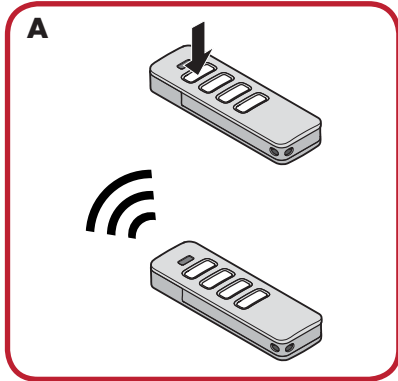



- There are 2-channel and 4-channel radio receivers.
- SL type garage door openers are equipped with a 2-channel receiver

1. Press learning button on the radio receiver;
 - 1 x for channel 1, LED 1 lights up
 - 2 x for channel 2, LED 2 lights up
 - 3 x for channel 3, LED 3 lights up
 - 4 x for channel 4, LED 4 lights up
2. Press the desired remote button (see diagram A)
 - > LED on the hand-held remote control lights up red
 - > Radio command is transmitted
3. LED on the receiver flashes to confirm command has been received
4. Repeat the procedure mentioned under points 1 + 2 to program further manual remote controls on to the given radio receiver

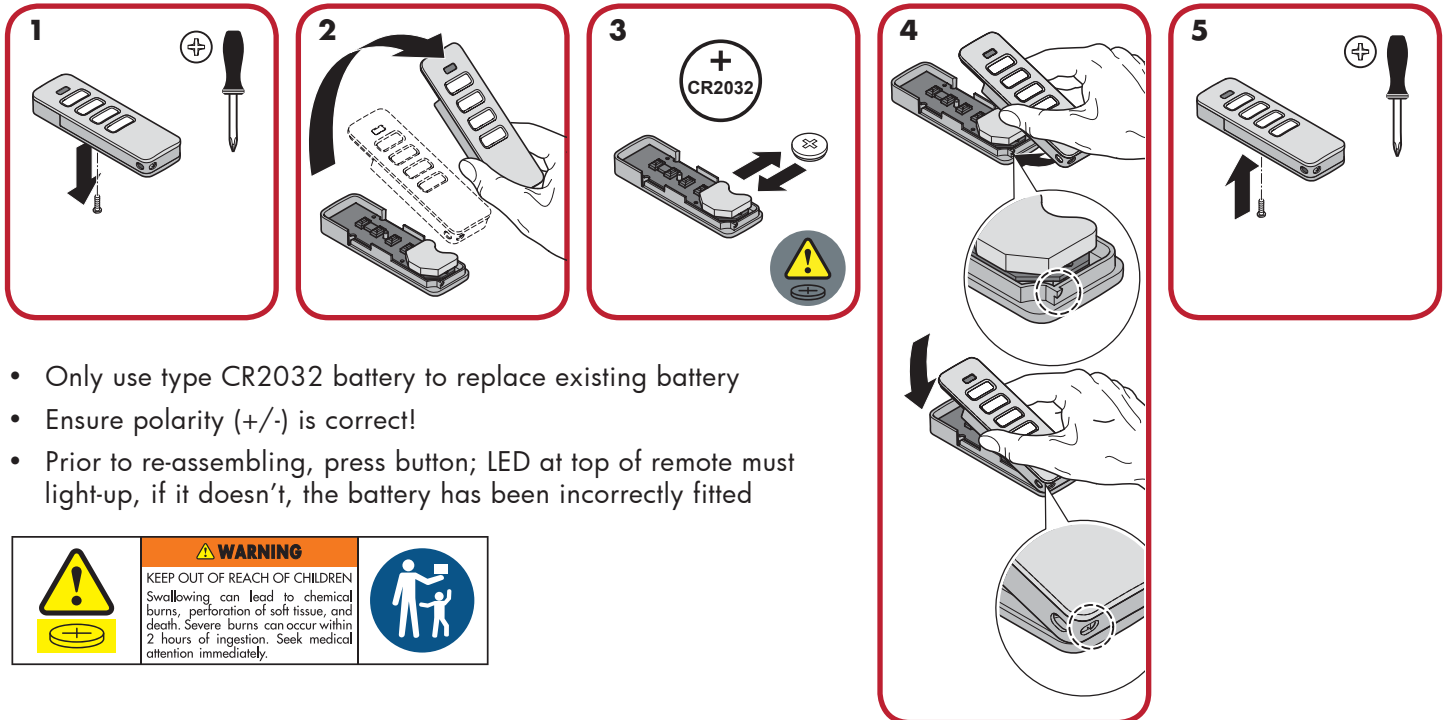
CHANGING THE BATTERY



- Only use type CR2032 battery to replace existing battery
- Ensure polarity (+/-) is correct!
- Prior to re-assembling, press button; LED at top of remote must light-up, if it doesn't, the battery has been incorrectly fitted

	<p>WARNING KEEP OUT OF REACH OF CHILDREN Swallowing can lead to chemical burns, perforation of soft tissue, and death. Severe burns can occur within 2 hours of ingestion. Seek medical attention immediately.</p>	
---	---	---