

# ENFIELD PK-5 NEW SCHOOL X 4 (PK-5, 599P)

PROGRAM AREA: 97,790 GSF (OGA ALLOWABLE W/ GROSS UP: 82,270 GSF)

## GENERAL ACADEMIC CLASSROOMS



## GRADE 1-2 SLC



## GRADE 3-5 SLC

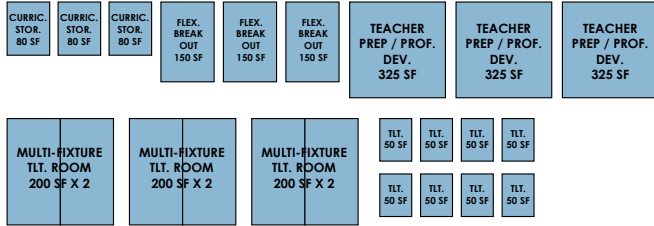

## SPECIAL EDUCATION

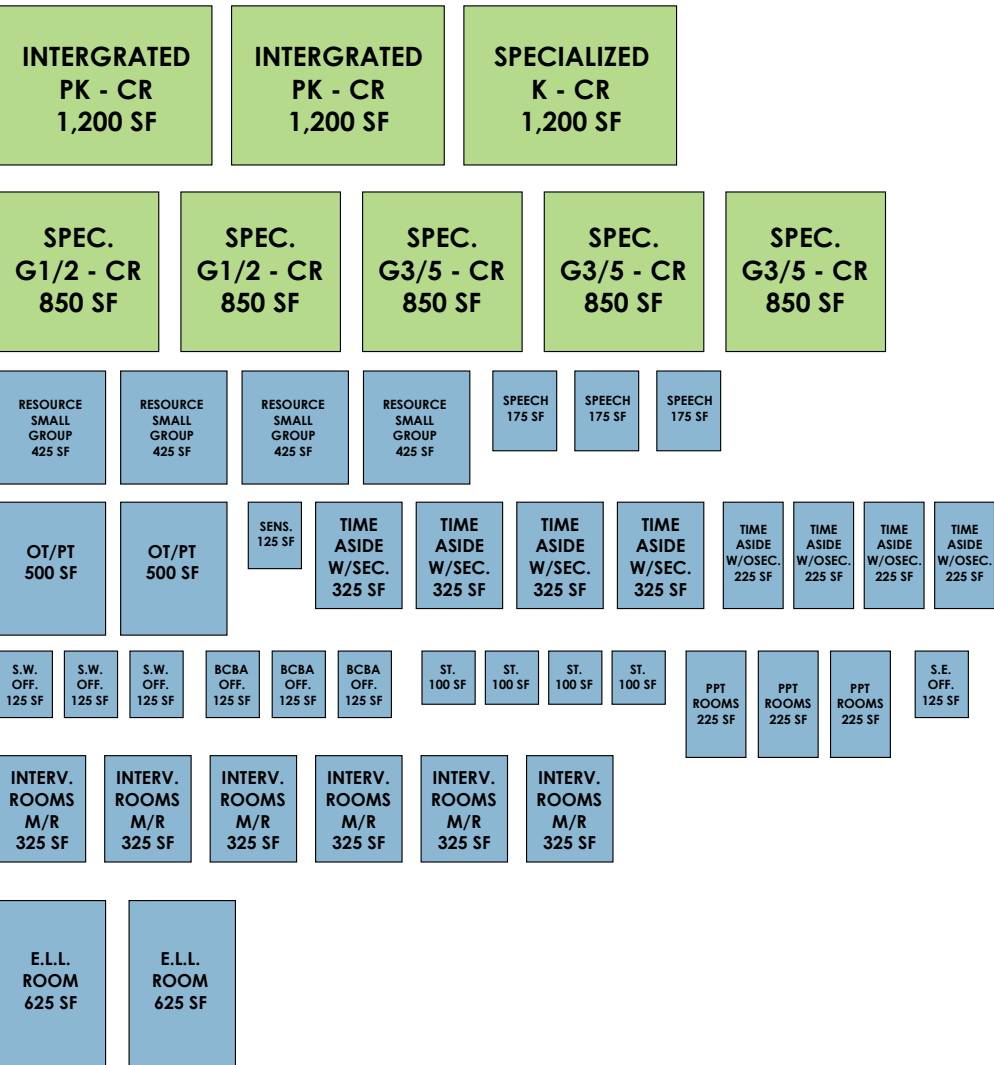

## LEARNING COMMONS

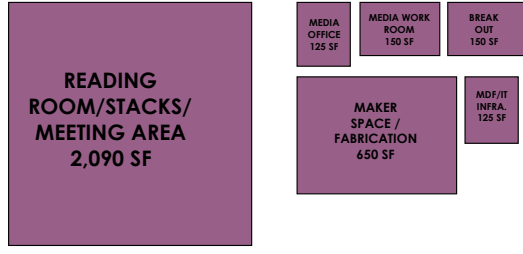

## WELLNESS/PHYSICAL EDUCATION

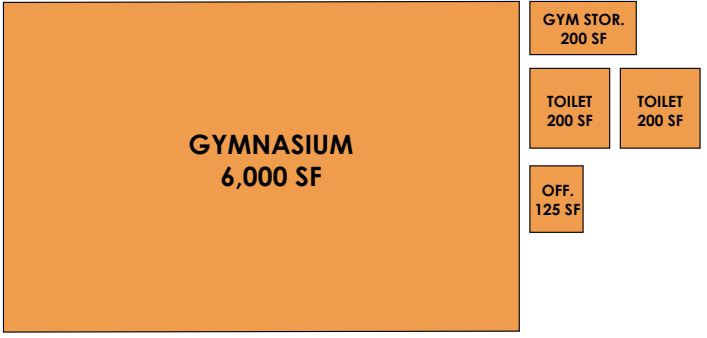

## BUILDING SERVICES

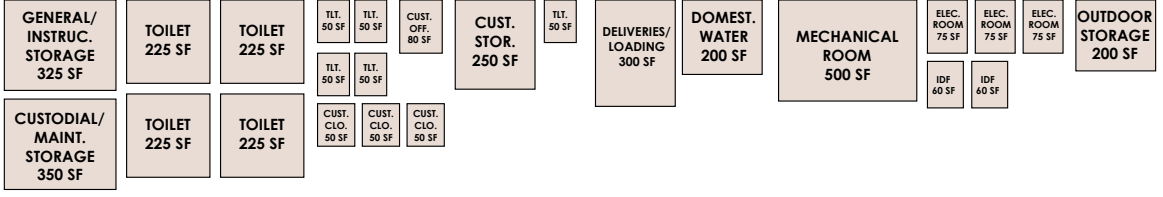

## ADMINISTRATION & NURSE

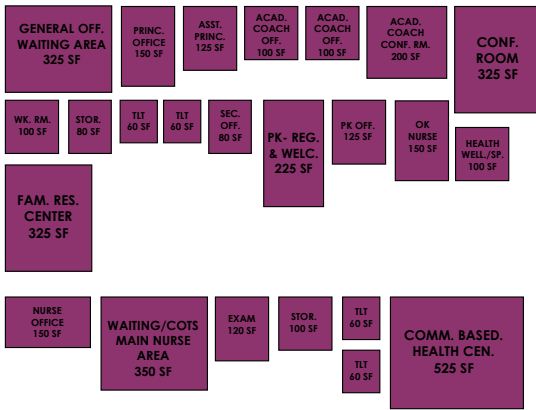

## VISUAL & PERFORMING ARTS

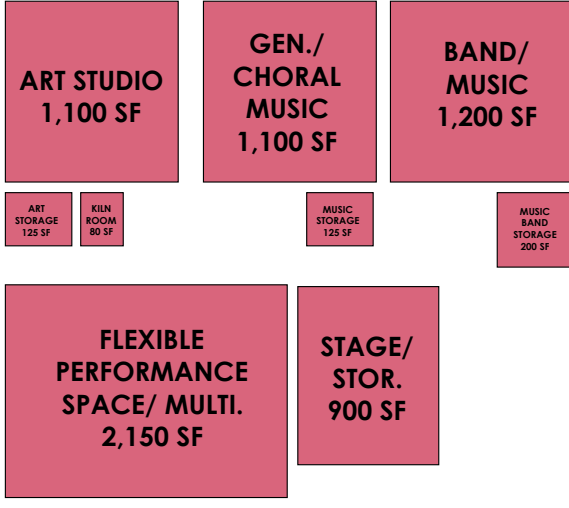

## CAFETERIA/FOOD SERVICE

