

MILLENNIUM PLUS

PIVOT DOOR

TB



Transmittance

$U_D \geq 0.77$ (W/m²K)

Consult typology, dimensions and glass.

Acoustic insulation

Maximum glazing **64 mm**

Sightlines

Frame 80 mm
Sash 80 mm

Profile Thickness

Door 2.0 mm

Panel 80 mm

Polyamide strip length 24 / 26 mm

Maximum sash dimensions

Width (L) = 2,100 (1,700* + 400 mm)

Height (H) = 3,000 mm

* Measurement from the pivot axis

Consult maximum weight and dimensions according to typologies.

Maximum sash weight 250 kg

Categories achieved at test centre

Protection against atmospheric agents.

Air permeability

(UNE-EN 12207): Class 4

Watertightness

(UNE-EN 12208): Class 5A

Wind resistance

(UNE-EN 12210): Class C5

* Reference test 1.20 x 2.00 m / 1 sash.

Test verified by

ALUMINIOS CORTIZO S.A.U.

Extrusion alloy

6063 T-5

Finishes

Possibility of dual colour.

Colour powder coating (RAL, mottled & rough).

According to Qualicoat >60 microns

Wood effect powder coating.

According to Qualideco standard

Anodising.

According to Ewwa Euras / Standard Class 15 / Optionally Class 20 and 25

Opening possibilities

Pivoting

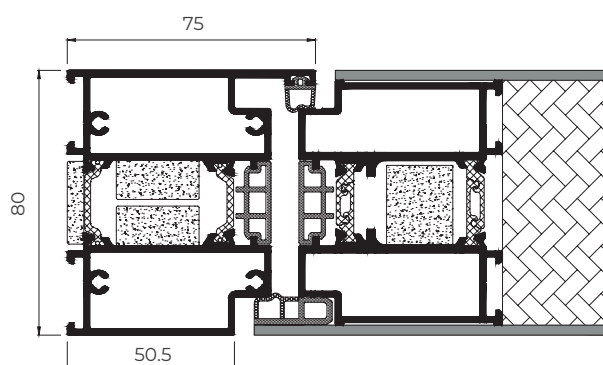

* Panelled version

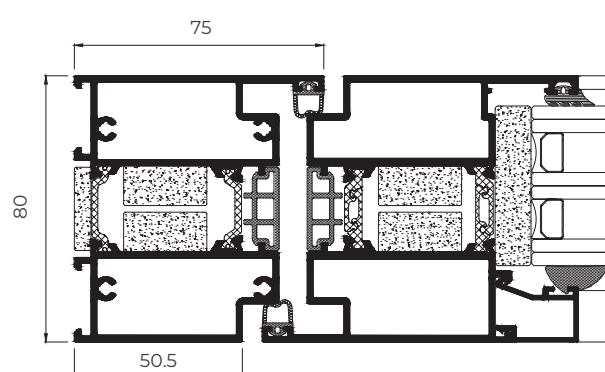

* Glazed version