



JLU

EZTRUNK

4Door_ASSEMBLY MANUAL

BEFORE BEGINNING, LOOK AT ASSEMBLY VIDEO ON EZTRUNK.COM



Customer Service

If you have a question or concern

EMAIL US: SERVICE@EZTRUNK.NET

or call 203-591-9060

Monday-Friday 8:30am-4:30pm EST

PDF manual on www.EZTRUNK.com

DO NOT RETURN TO THE STORE!

**CUSTOMER SERVICE:
SERVICE@EZTRUNK.NET
CALL: 203-591-9060**

Please read instructions fully before beginning assembly

NO	Illustration	Description	Part #	QTY.
1		Trunk	201941	1
2		Side Plate_BP	201943	1
3		Bottom Plate_DS	201946	1
4		Bottom Plate_PS	201947	1
5		Plastic Block_Wing	189002	1
6		Double Tape	403002	1
7		Wing Clamp_DS	192166	1
8		Wing Clamp_PS	192177	1
9		Speaker_Side Panel	201949	1
10		Pan Head Bolt M8x50 1/2"	68501	2
11		Bolt M5x5	55051	2*
12		Bolt M5x6	55061	2*
13		Pan Head Bolt M6x13	66131	1*
14		Pan Head Bolt M6x18	66181	5
15		Star Wrench_T27	60027	1
16		Star Wrench_T30	60030	1

* Extra hardware

RECOMMENDED TOOLS



PHILLIPS SCREWDRIVER

PLEASE NOTE:

DO NOT USE ELECTRIC TOOLS THIS WILL CAUSE SCREWS TO STRIP

**CUSTOMER SERVICE:
SERVICE@EZTRUNK.NET
CALL: 203-591-9060**

Figure A

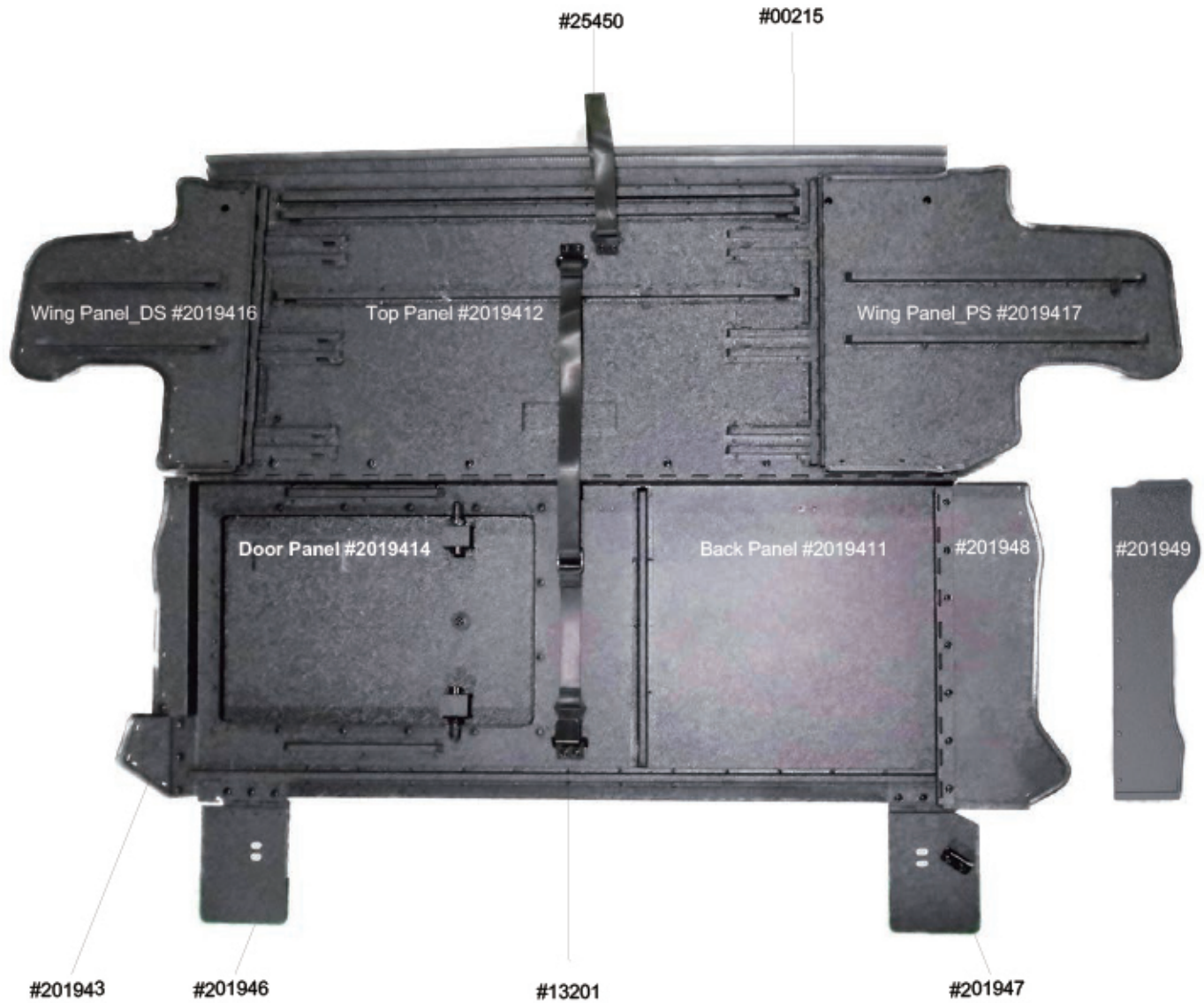

PLEASE NOTE:
DO NOT USE
ELECTRIC TOOLS
THIS WILL
CAUSE SCREWS
TO STRIP

**USE SCREW
DRIVER**

**DO NOT
OVER
TIGHTEN**



* DS = Driver Side
PS = Passenger Side

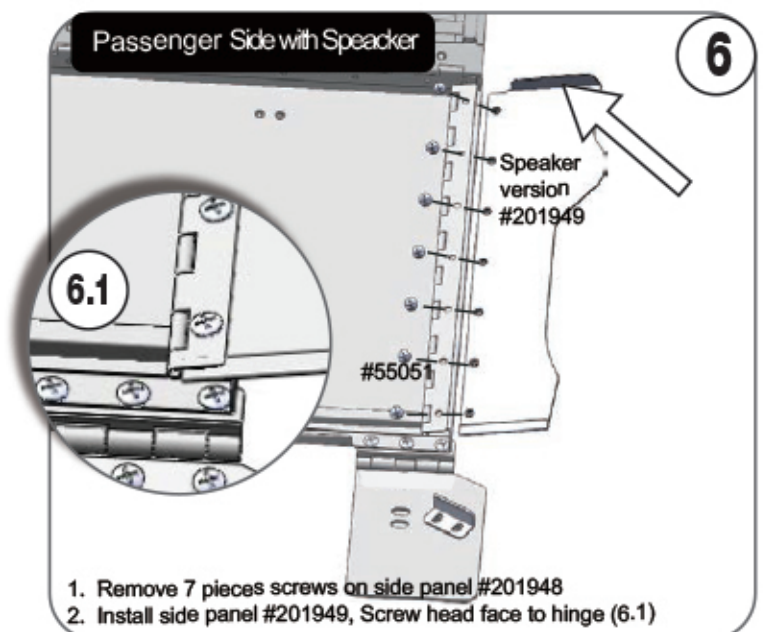
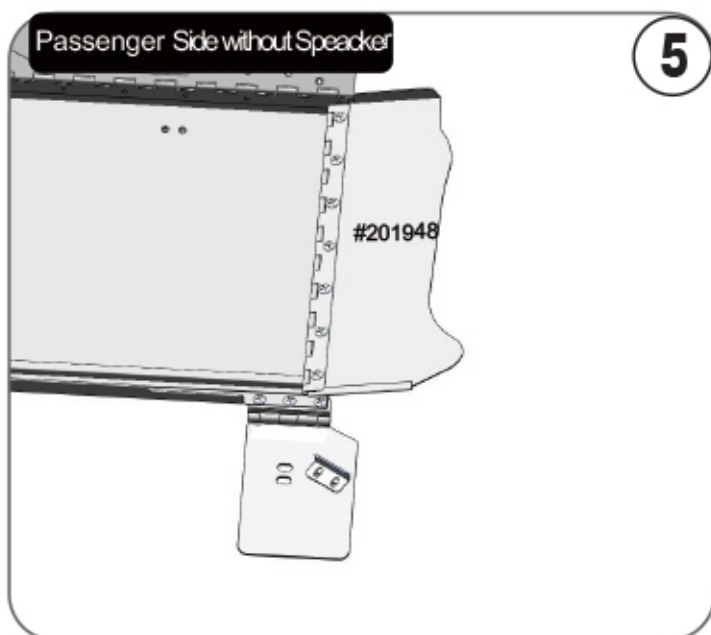
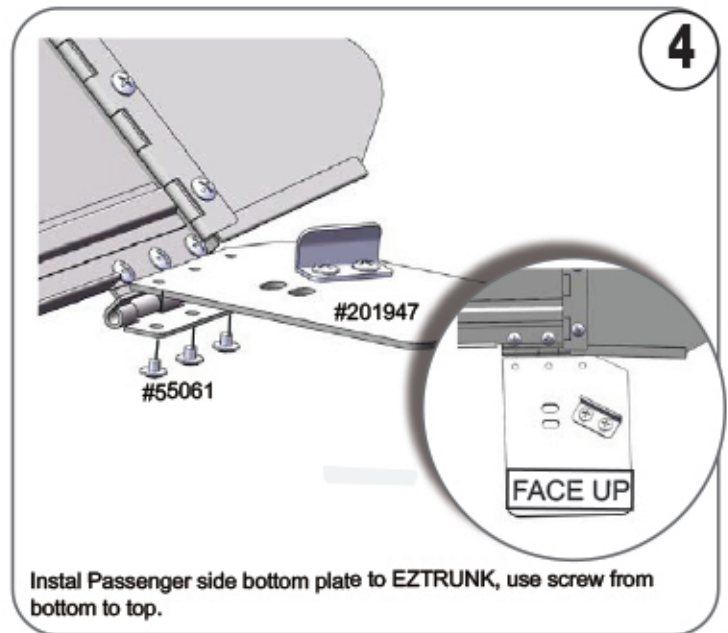
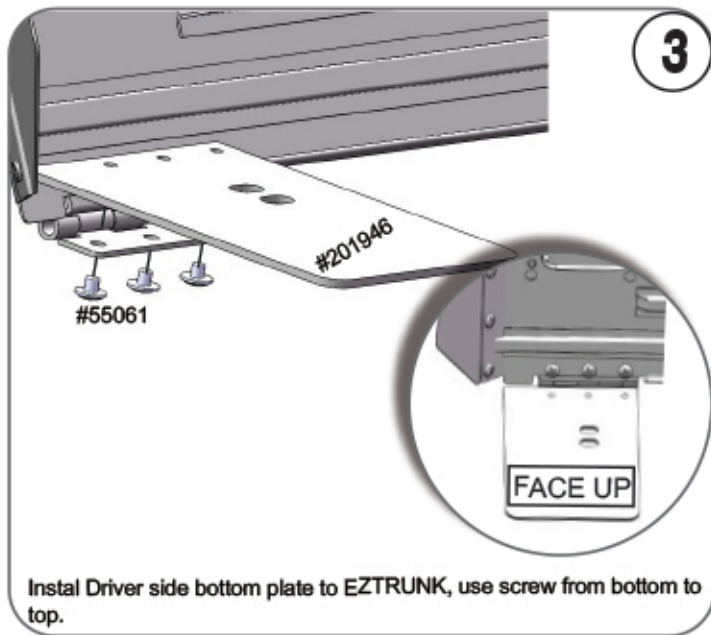
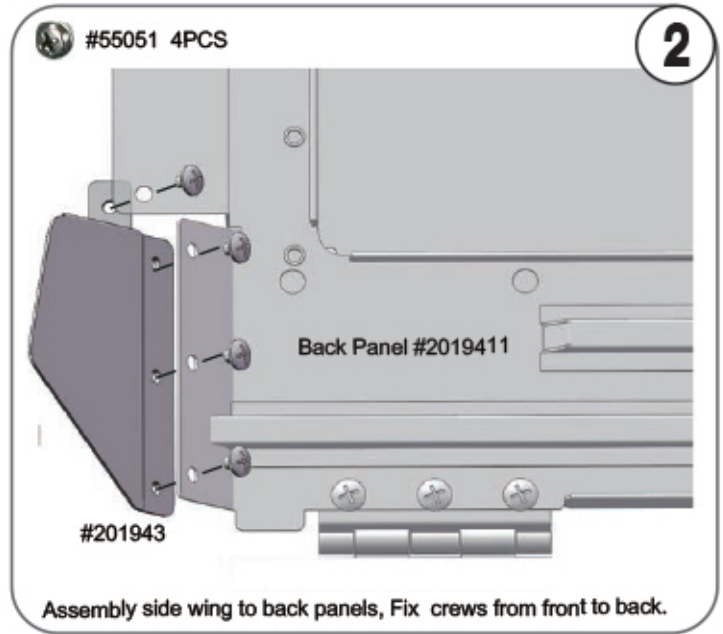
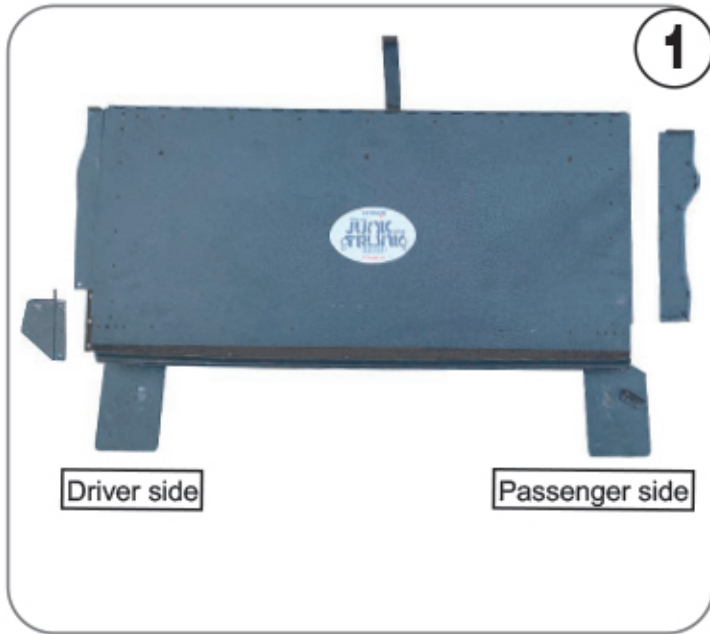

7



1. Flip up rear soft windows, better to remove aluminium bar to falling down.

8



Pop up both side middle D ring. Use tooling remove bolt.

9



Install # 68501 bolt and D ring set to second hole.

#68501

10



PLASTIC CAP SLANTED FACE BACKWARD

11





GROOVE FACE BACKWARD

#189002

1. Use double tape glue #189002 plastic part to jeep
2. Use clean pad to clean area before glue together

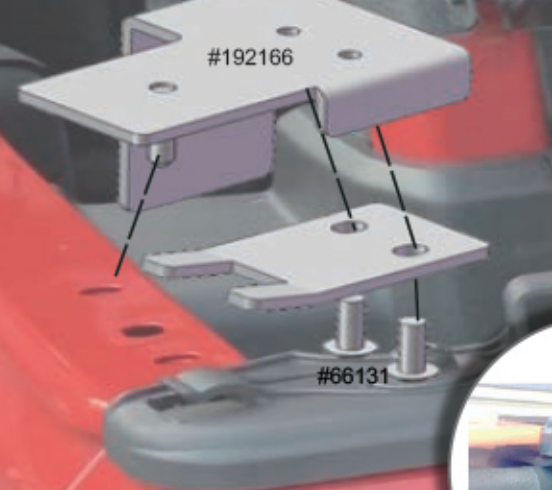
12

#192166

#66131

1. Install wing block on both side of jeep.
2. Soft top use #66131 bolts, Hard top use #66181 bolts.

How to use EZTRUNK



13

1. Hold on top panel and lift EZTRUNK up. (DON NOT GRAB ON RUBBER)



14

1. Open both side wings from top panel. Open passenger side first.

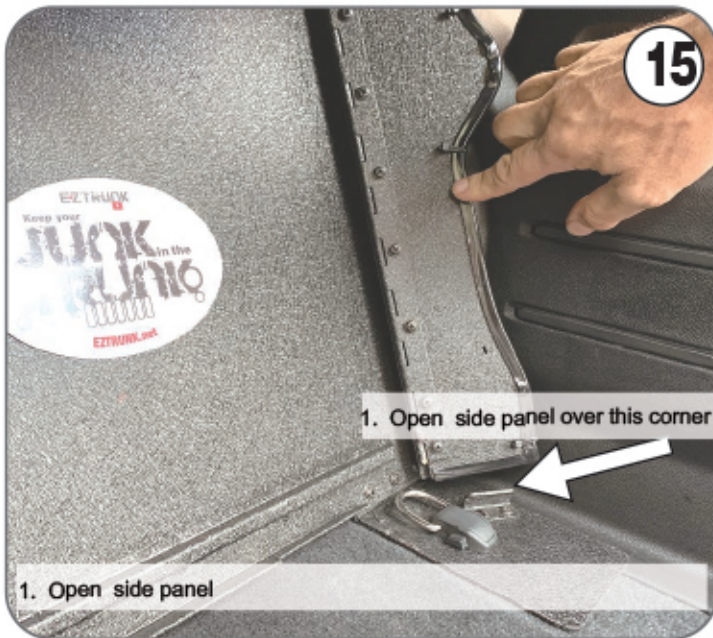

15

1. Open side panel over this corner

1. Open side panel



16

1. Hold both wings
2. Slowly put down top panel.

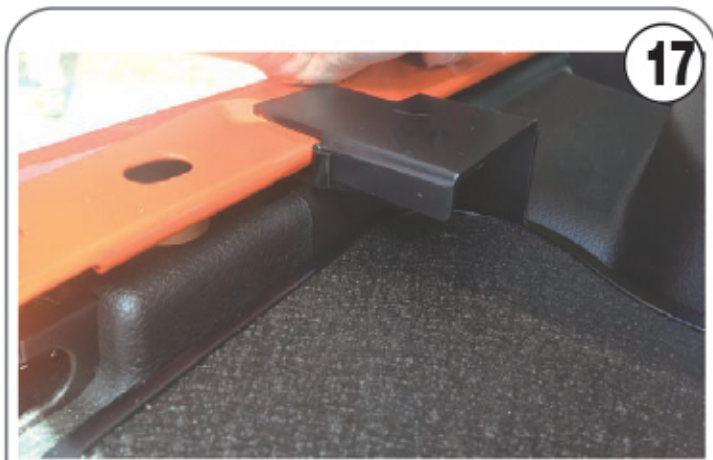

17

1. Wing goes under this block.



18

How to secure soft top on EZTRUNK

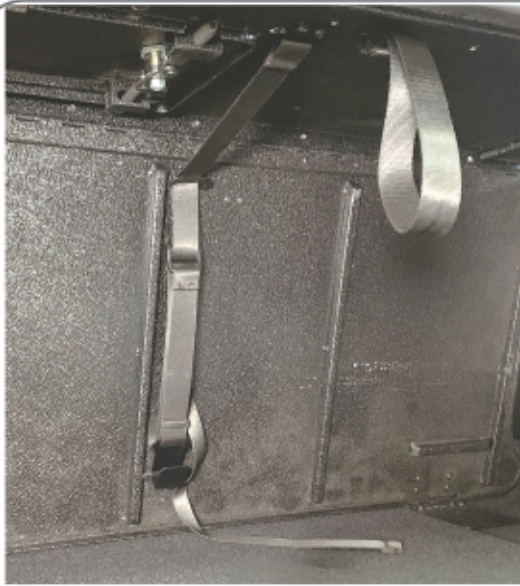

19

1. Remove this trip .



20

1. Low down soft top on EZTRUNK.
2. Adjust welbbing long enough to hook on soft top as picture show.



21

1. Pull end of strip make soft top secure on EZ trunk.



22

1. Tie a knot for end of strip.

PLEASE NOTE



SOFT TOP

THIS RUBBER PIECE COMES ON EZTRUNK AND IS FOR SOFT TOP



HARD TOP

IF CHANGING TO HARD TOP REMOVE RUBBER PIECE USED FOR SOFT TOP AND REPLACE WITH HARD TOP RUBBER

**ANY QUESTIONS PLEASE CALL OR EMAIL
CUSTOMER SERVICE: SERVICE@EZTRUNK.NET**

CALL: 203-591-9060

Monday-Friday 8:30am-4:30pm EST

PDF manual on www.EZTRUNK.com

DO NOT RETURN TO THE STORE!