



Operation Manual

for analog BVC central vacuum cleaners C 600, S 600 and S 700 BLACKLINE & SILVERLINE

CONTENTS

Operation Manual –

for analog BVC central vacuum cleaners C 600, S 600 and S 700

Content:

Important safety instructions.....	pages 3-5
Front view with detailed description S 600, S700.....	page 6
Rear view with detailed description S 600, S 700.....	page 7
Front view with detailed description C 600.....	page 8
Rear view with detailed description C 600.....	page 9
Wall mounting.....	page 10
Electrical installation and power supply.....	page 11
Installation of the low-voltage cable and suction pipe.....	page 12
Installation of the BVC exhaust air muffler.....	page 13
HEPA filter.....	page 14
Care instructions.....	pages 15-16
Troubleshooting.....	pages 17-18
Notes.....	page 19

OPERATION MANUAL

Important safety instructions

When using electrical appliances, basic safety precautions are mandatory.

All BVC central vacuum cleaners are only suitable for indoor use and are not designed for vacuuming liquids.

Read this manual prior to installing and operating your BVC central vacuum cleaner.

BVC central vacuum cleaners are approved by SEV (Electrosuisse)
Please see your rating plate for details.



Attention:

Always disconnect the main power plug prior to servicing or cleaning your BVC central vacuum cleaner (e.g. filter change).

Warning:

Read the following instructions BEFORE using this appliance to reduce the risk of burns, fire, electric shock or injuries:

1. Keep the power cord away from heated surfaces.
2. This appliance is not a toy, but can be used by children from 8 years up and persons with reduced physical, sensory or mental capabilities or lack of experience and knowledge, if they are being supervised and have been given proper instruction concerning the safe use of this appliance and have been made aware of the risks and dangers involved. Children shall not play with the appliance. Cleaning and maintenance must be performed by adults only.

OPERATION MANUAL

Important safety instructions

3. Only use this central vacuum cleaner for its intended use as described above. The use of accessories not recommended by the manufacturer may cause fire, electric shock and injuries, or even damage system components leading to system failure.
4. Never operate the BVC central vacuum cleaner if the power cord, the main power plug or the unit itself is damaged. Otherwise contact your authorized dealer for repair.
5. Do not use the power cord to carry or pull your BVC central vacuum cleaner. Avoid pulling the power cord around sharp edges or corners.
6. Never disconnect the main power plug by pulling on the power cord. To disconnect the main power cord from the outlet, always grasp the plug, never the power cord.
7. Do not put any objects into the inlet valves. Do not use your BVC central vacuum cleaner when inlet valves are blocked. Keep the openings free of dust, lint, hair and anything that may reduce air flow or compromise seal tightness.
8. Keep hair, body parts and loose clothing away from all suction points.
9. Do not vacuum anything burning or smoking, such as cigarettes, hot ashes, matches or similar materials.
10. Never operate your BVC central vacuum cleaner without the filter bag and a motor protection filter in place.
11. Never touch the main power plug, the power cord or your BVC central vacuum cleaner with wet hands. Risk of electric shock!
12. Do not use on wet surfaces to reduce risk of electric shock.

OPERATION MANUAL

Important safety instructions

13. Take extra caution when vacuuming on the stairs.
14. Do not vacuum flammable or combustible liquids such as gasoline or use in areas where they may be present.
15. We recommend using the BVC central vacuum cleaner after construction work is completed. Do not vacuum construction sites.
16. Turn the power off before unplugging the unit.
17. Connect only to a properly grounded (earthed) outlet .
Only disconnect the BVC central vacuum cleaner from the main power supply in stand-by mode.

KEEP THIS MANUAL HANDY FOR FUTURE REFERENCE

Attention - Important!

When put into service and connected to the mains, the BVC central vacuum cleaner is operating in standby mode. The I/O switch on the unit is intended for testing purposes only. The standard position for this switch is „O“ (Stand-by mode).

In order to avoid damage to the motor, the BVC central vacuum cleaner should not be operated with closed inlet valves for longer than 60 seconds. This is the case if you start the unit with the I/O switch without a vacuum hose plugged in.

It is imperative to avoid this.

OPERATION MANUAL

Front view with detailed descriptions

english

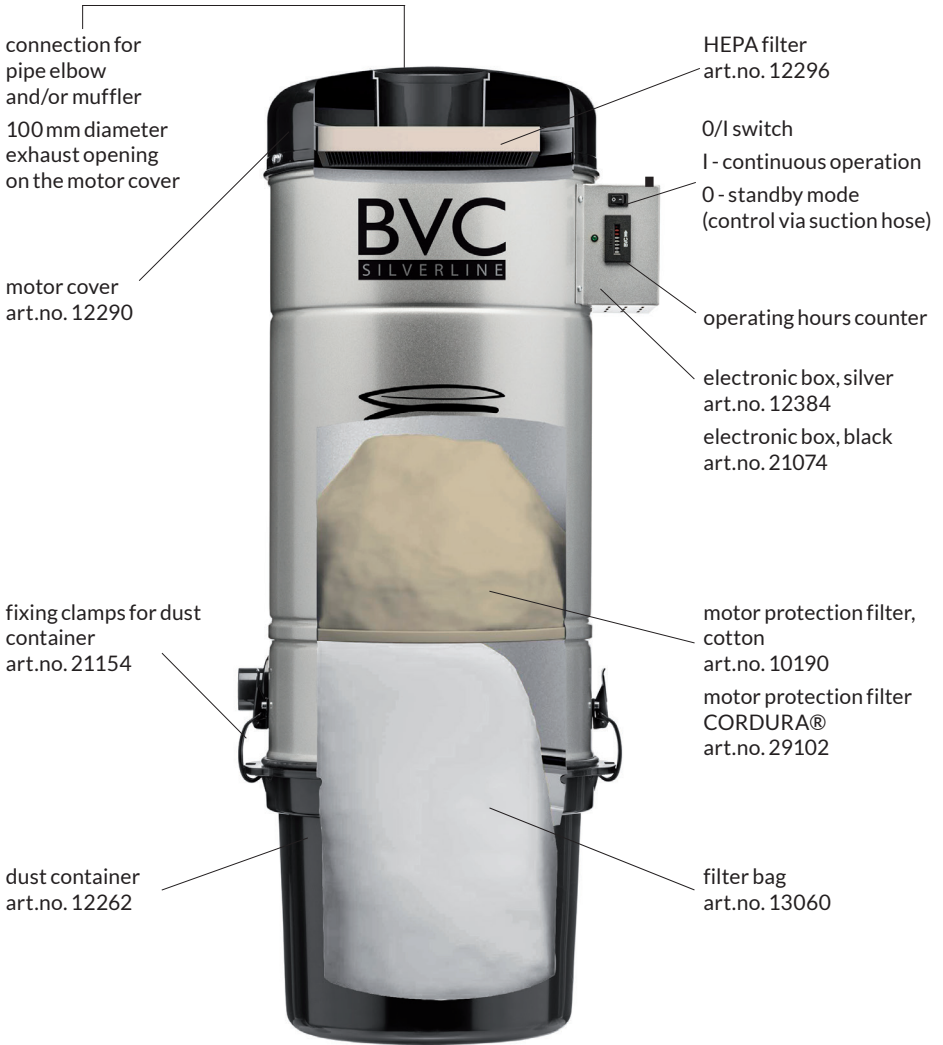

OPERATION MANUAL

Rear view with detailed descriptions

connector for
low voltage wire
art.no. 12176

connector for
voltage wire
230 Volt

cover
for suction flange, silver
art.no. 10210
for suction flange, black
art.no. 21150



vacuum valve
art.no. 12030

wall-mounting unit
with sound-
absorbing rubber
blocks

suction flange
50mm Ø
art.no. 10226

OPERATION MANUAL

Front view with detailed descriptions C 600

english



OPERATION MANUAL

Rear view with detailed descriptions C 600

connector for low voltage wire
art.no. 12176

connector for
voltage wire 230V

cover
for suction flange, silver
art.no. 10210

for suction flange, black
art.no. 21150

vacuum valve
art.no. 12030

wall-mounting unit

suction flange
50mm Ø
art.no. 10226



OPERATION MANUAL

Wall mounting

The top of the wall mount should be mounted at a height of approximately 130 cm to 150 cm measured from the floor, for easy removal of the dust container. For proper cooling of the motor, we suggest a distance of at least 20 cm to the ceiling.

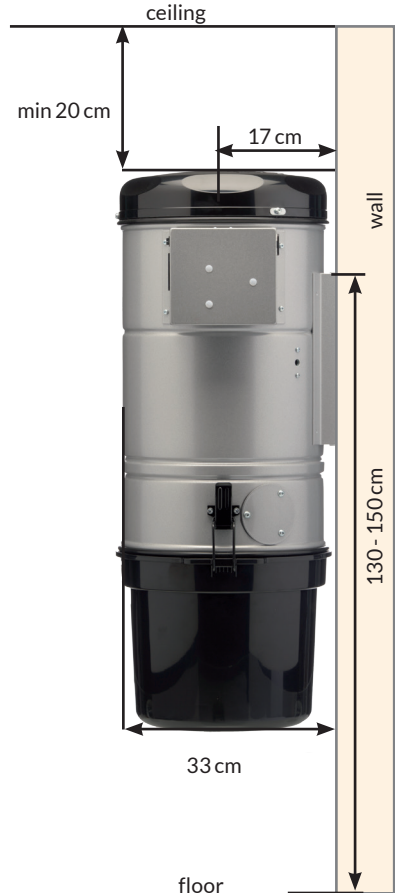
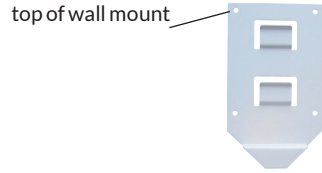
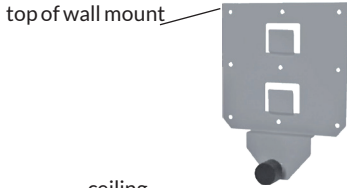

OPERATION MANUAL

Electrical installation and power supply

Electrical installation of your BVC central vacuum cleaner

After mounting the BVC central vacuum cleaner, the low-voltage cable must be connected with the unit. On the top side of the unit you will find the plug connector and socket for the low-voltage cable. Remove insulation from the low-voltage cable (2-wired, with 0.75 mm cross section) and connect the two wires of the low-voltage cable with the screw connectors to the plug.

The low-voltage cable should be suitable for a voltage of 5 V and has to comply with the current specifications of your country for this voltage.

Attention:

When put into service and connected to the mains, the BVC central vacuum cleaner is operating in stand-by mode. The I/O switch on the unit is intended for testing purposes only. The standard position for this switch is „O“ (stand-by mode).

Power supply

Power supply (AC) and voltage at the operation point has to comply with the current specifications of your country for this voltage. Connect the appliance to a properly grounded (earthed) power outlet only.

C 600 and S 600: 16 Ampere fuse type „B“.

S 700: 16 Ampere fuse type „C“.

The socket must be easily accessible.

Grounding instructions

The BVC central vacuum cleaner has to be grounded. Use only the supplied cable and plug. The plug must be connected with a properly installed power outlet. The power outlet must comply with the current specifications of your country for this voltage.

Attention:

If you are not sure, whether the power outlet is properly installed and grounded, have it checked by a qualified electrician.

OPERATION MANUAL

Installation of low-voltage cable and suction pipes

The 5 V of control lines leading to the individual inlet valves are to be connected in a parallel circuit (tree network). It is possible to connect each inlet valve with a separate cable to the BVC central vacuum cleaner (star network). Installing the 5 V cable next to a 230 V cable can cause electrical interference with the control system.

english

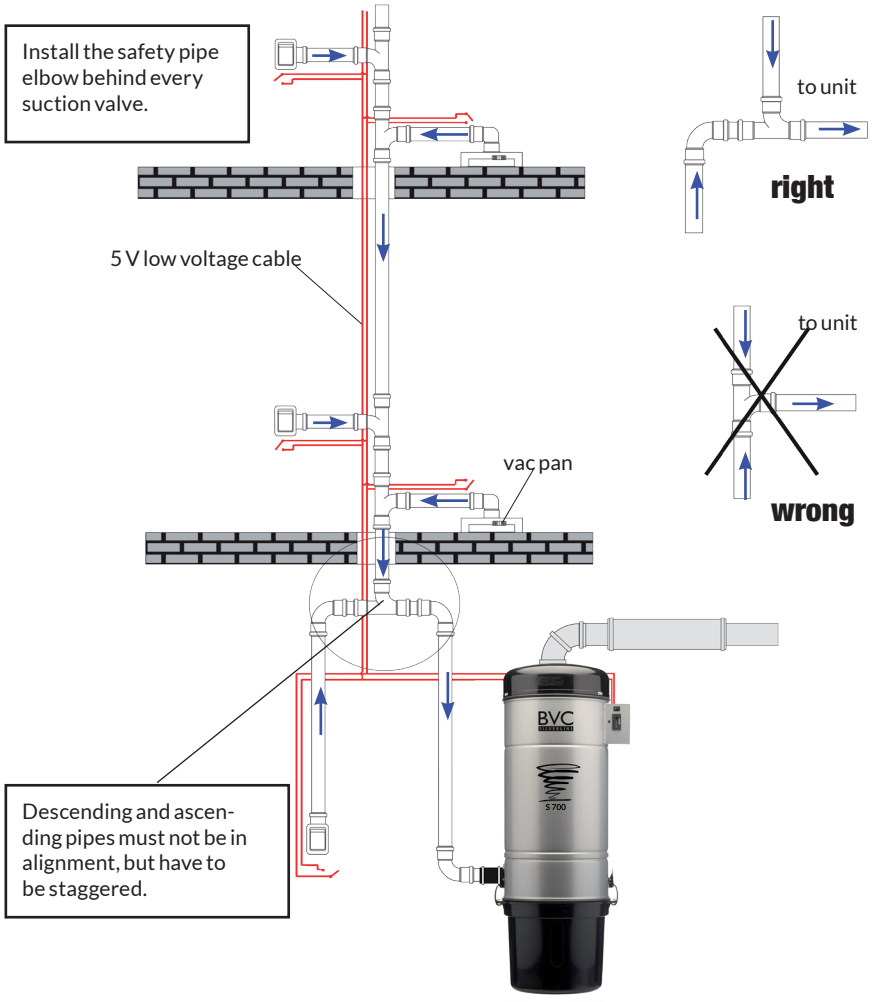

OPERATION MANUAL

Installation of the BVC exhaust air muffler

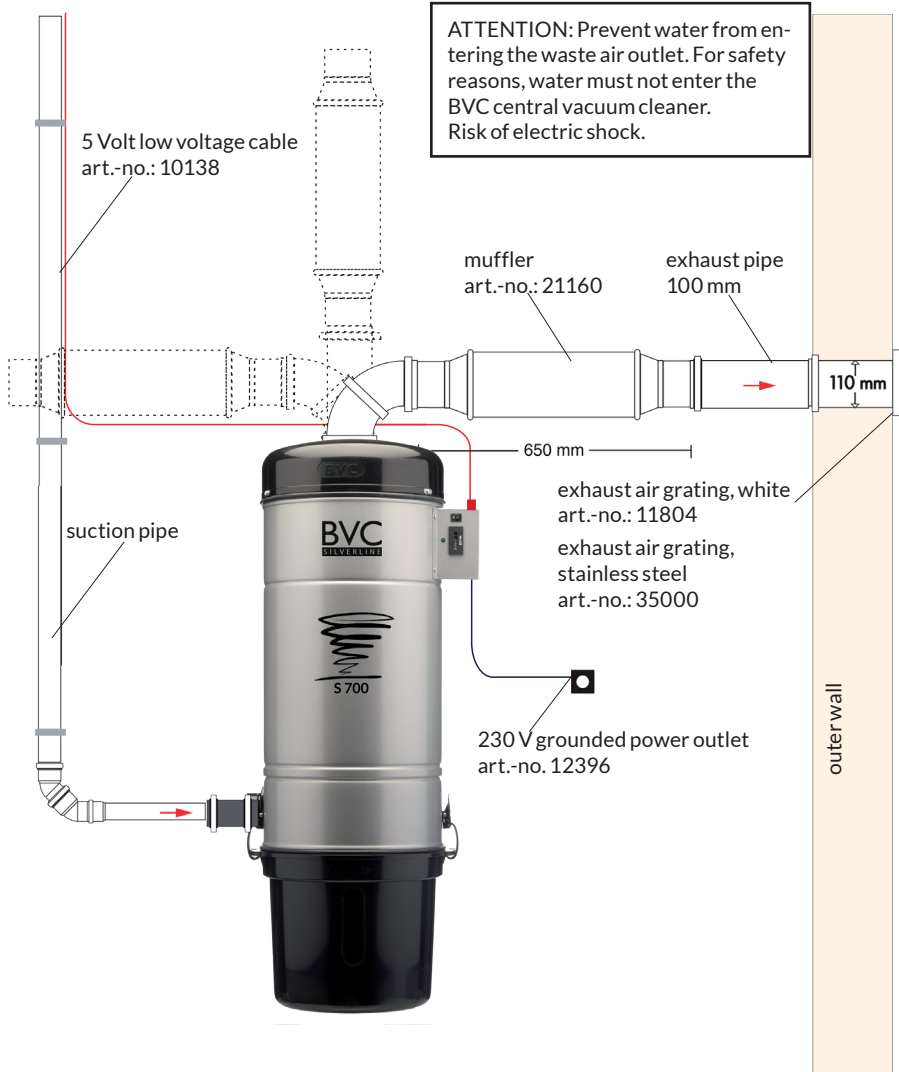

OPERATION MANUAL

Usage of the HEPA filter

All BVC central vacuum cleaners are standardly delivered with a HEPA-filter, which is not installed in the device.

When the exhaust air is routed to the outside, the HEPA-filter is NOT needed.

If it is not possible to route the exhaust air to the outside (e.g. passive house), you can use the highly efficient HEPA filter in recirculation mode, so the indoor air remains at its best - clean. A regular check of the HEPA filter is highly recommended. We also suggest replacing the HEPA filter every 200 working hours.

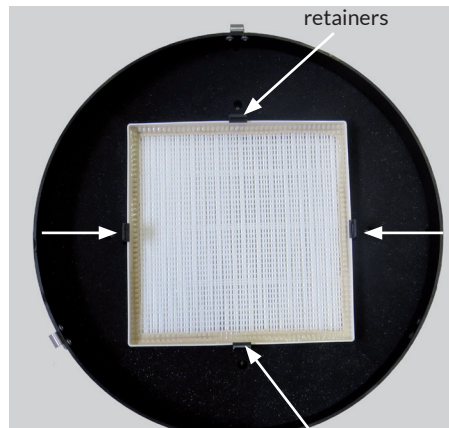

Installing and removing the HEPA filter

Before installing or changing the HEPA filter, disconnect the main power plug. Then loosen the screws of the motor cover and remove the cover. Turn the motor cover upside down and set it on an even surface. Place the HEPA filter on the retainers and gently push it down until it is completely engaged.

To remove the HEPA filter, gently push the retainers in an outward direction and lift up the HEPA filter.

Attention:

Never operate the BVC central vacuum cleaner without a properly installed motor cover. Always make sure that the screws of the motor cover are tightened fast.

OPERATION MANUAL

Care instructions

Changing the filter bag

BVC recommends not filling the filter bag completely, since suction decreases with a full filter bag and can cause damage to the filter bag.

To replace the filter bag, open the fixing clamps of the dust container and remove it.

Removing the filter bag:

Always use both hands to detach the full filter bag from the black spigot. Horizontally pull away from the black spigot. Never pull vertically downward (see picture 1).

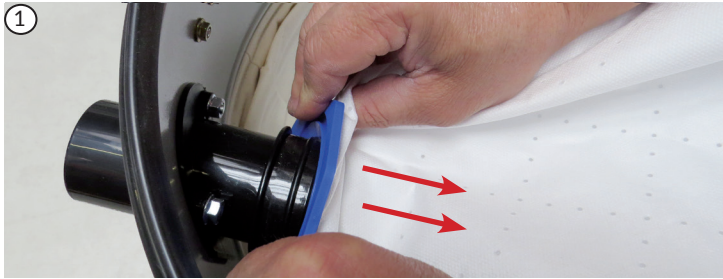

Inserting the new filter bag

Push the plastic flange completely over the black spigot (see picture 2).

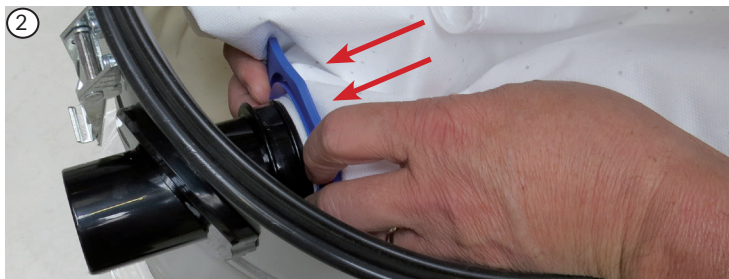

OPERATION MANUAL

Care instructions

Attention:

Always disconnect the main power plug prior to servicing or cleaning your BVC central vacuum cleaner.

When required, clean the main unit of the BVC central vacuum cleaner with a soft cloth. Never use solvents or strong cleaners.

Changing the motor protection filter

We recommend that you clean the motor protection filter once a year or completely replace the filter.

To guarantee a smooth removal and installation of the filter, remove the dust container and the filter bag as described on page 28. Then dismount the BVC central vacuum cleaner, turn it upside down and put it on an even surface.

The spring tension ring must be pulled with the loop towards the center (see picture 1). This will cause the filter to deform which is necessary for the removal.



Make sure that the motor compartment is entirely free of dust and dirt particles. Dust and dirt can damage the motor!

To insert the filter, the filter must be formed to a semi-circle (see picture 2) and be placed gently into the seam (see picture 3). The spring tension ring needs to spring back into its original form. The remaining bend needs to be pressed into the seam. You should hear a snapping sound.

BVC EBS Distribution GmbH assumes no liability for damages on the BVC central vacuum cleaner due to wrongful installation and/or removal of the filter.

OPERATION MANUAL

Troubleshooting

Partial loss of the suction power

1. Check if the hose is clogged.
2. Check if the dust container is tightly sealed.
3. Open the dust container. If the filter bag is full, change it.
4. Remove the suction pipe from the suction flange on the BVC central vacuum cleaner. Switch the BVC vacuum cleaner to (I) and check the suction power at the suction flange. If the motor produces enough suction power, the function of the motor is OK.
5. To find out where the pipe system is clogged, you need two people to perform the test:
 - One person switches on the motor and produces underpressure by keeping the inlet valves closed.
 - The other person goes to the nearest inlet valve and checks if there is enough suction power. If the suction power is lower than normal, open and close the lid of the inlet valve several times. This has a pumping effect. If necessary, repeat with the other inlet valves until the problem is solved. When testing the suction power, underpressure (all inlet valves are closed) should not be maintained for more than 60 seconds in order to avoid an unnecessary overload of the motor.
6. After identifying the position of the blockage, insert a cleaning worm into the pipe system and push out the object clogging the pipe.
7. For further assistance, please contact your local BVC partner or BVC EBS Distribution GmbH.

BVC EBS Distribution GmbH, Londonstr. 9, D-97424 Schweinfurt,
Tel. +49 (0) 97 21 / 78 57-0, Fax 0 97 21 / 78 57-29.

OPERATION MANUAL

Troubleshooting

The motor does not start

1. If the green lamp on the unit is off, the power supply is NOT OK.
Check the 230 V socket for voltage.
2. If the green lamp on the unit is on, the power supply is OK.
Start the BVC central vacuum cleaner by switching the I/O switch to „I“
If the motor does not start, the motor is defective.
Please contact your local BVC partner.
3. If the green lamp on the unit is on, the power supply is OK.
Start the BVC central vacuum cleaner by switching the I/O switch to „I“
If the motor can be started, the problem can either be caused by the
low-voltage transformer, the relay, the low-voltage installation or the
handgrip on the suction hose.
Please contact your local BVC partner or BVC EBS Distribution GmbH.

BVC EBS Distribution GmbH, Londonstr. 9, D-97424 Schweinfurt,
Tel. +49 (0) 97 21/78 57-0, Fax 0 97 21/78 57-29.



BVC EBS Distribution GmbH

Londonstraße 9 • D-97424 Schweinfurt

Telefon +49 9721/7857-0 • Telefax +49 9721/7857-29

E-Mail: info@einbaustaubsauger.de • Internet: www.einbaustaubsauger.de

E-Mail: info@bvc-vac.com • Internet: www.bvc-vac.com