

EURO VISTA PIVOT™

ALUMINUM & WOOD PIVOT DOORS



Approved for use in Miami-Dade HVHZ Zones
Florida Building Code Approved
[Product Approval FL 22410](#)

www.euro-wall.com
888.989.EURO (3876)

euro-wall®



FOLDING

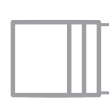

SLIDING



STACKING

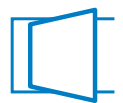

PIVOT

SYSTEM THRESHOLDS

Maximum / Minimum Specifications

| | |
|-------------------|------------------|
| Max Panel Weight: | 700 lbs |
| Min Panel Width: | 36" |
| Max Panel Width: | 96" |
| Min Panel Height: | 48" |
| Max Panel Height: | 144" |
| Panel Thickness: | 2-1/4" to 3-1/2" |

NOTE: The Euro Pivot™ Door comes in aluminum, aluminum with wood clad, wood and wood with aluminum clad options. The Euro Pivot™ door can also be configured with either an outswing or an inswing. Solid wood pivot doors are not Florida Product Approved and are not impact rated. For installations in Florida, please see the Florida Product Approval for usage and limitations.

SYSTEM HIGHLIGHTS

Aluminum Pivot Panel Specifications

Extruded aluminum 6063-T5 with door panel corner keys for strength and security / optional wood clad finish available

Wood Pivot Panel Specifications

From 2-1/4" - 3-1/2" thick / optional aluminum clad finish available in AAMA 2604 and 2605

Hardware

Stainless steel (316/304SS) components with aluminum hinges

Lever Lock Sets

Top and bottom shootbolt locking system

Multi-point Door Locks

Faceplate, latch and hooks are 304SS

No Sills

No sills necessary

Matching Fixed Units

Matching Florida Product Approved impact rated transom and sidelight units available

Largest Impact Rated Panel Sizes

144" tall / 72" wide panels - the largest available HVHZ impact tested and Florida Product Approved pivot door

Under Pressure

Highest design pressure available for any impact rated pivot door - up to 60+/-

Aesthetics

Muntins, simulated divided lites, mid-rails, custom wood cladding, custom aluminum cladding . . . a multitude of customization options allow for flexible and functional design

Ladder Pull

Available in sizes ranging from 1' - 8' to meet the needs of your application

Self Closure

Hydraulic self closure option available

Long Lasting Finish

Standard finish coating is AAMA 2605, the highest quality finish available

SYSTEM COMPONENTS / OPERATION

(Aluminum pivot door shown below; configurations are valid for all pivot door types)

TOP VIEW - Horizontal Cross Section

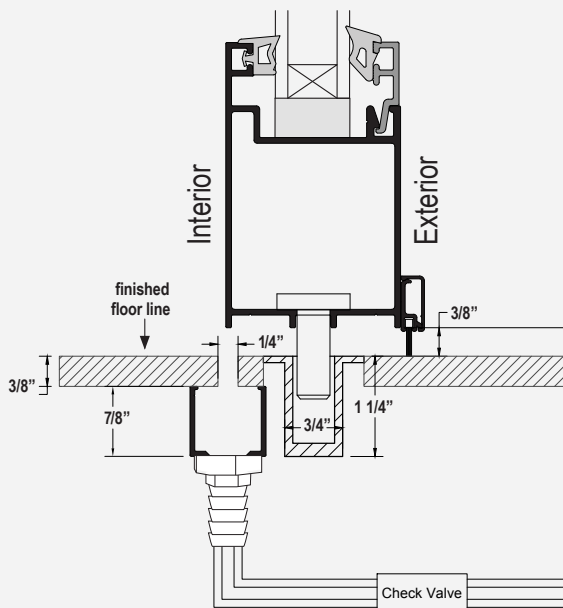
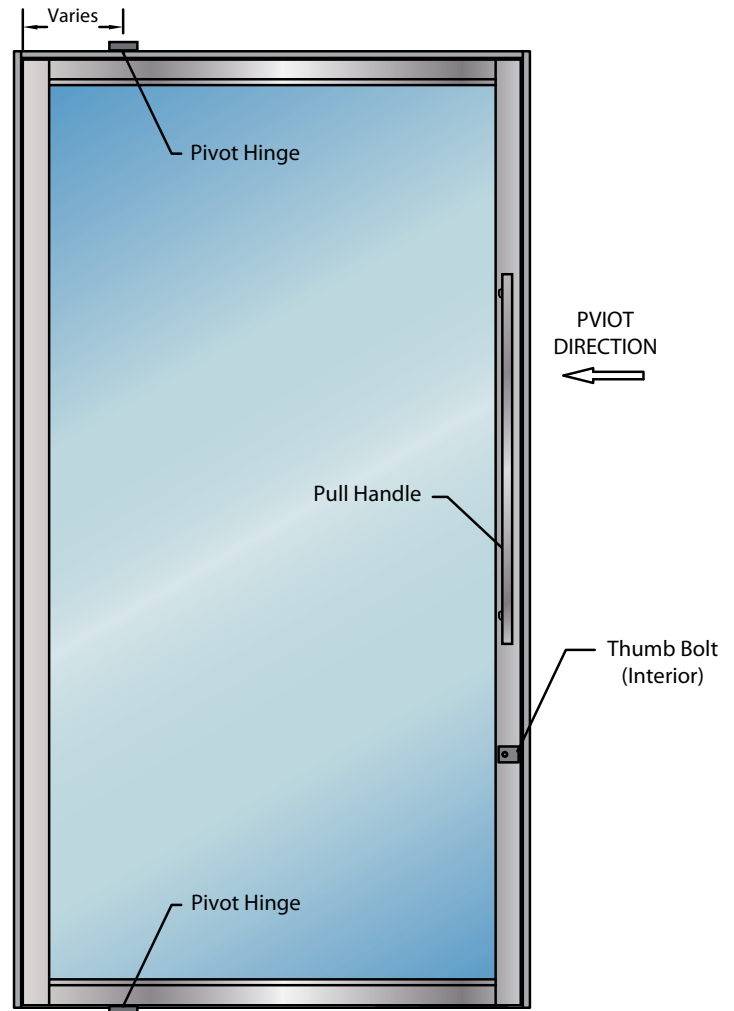
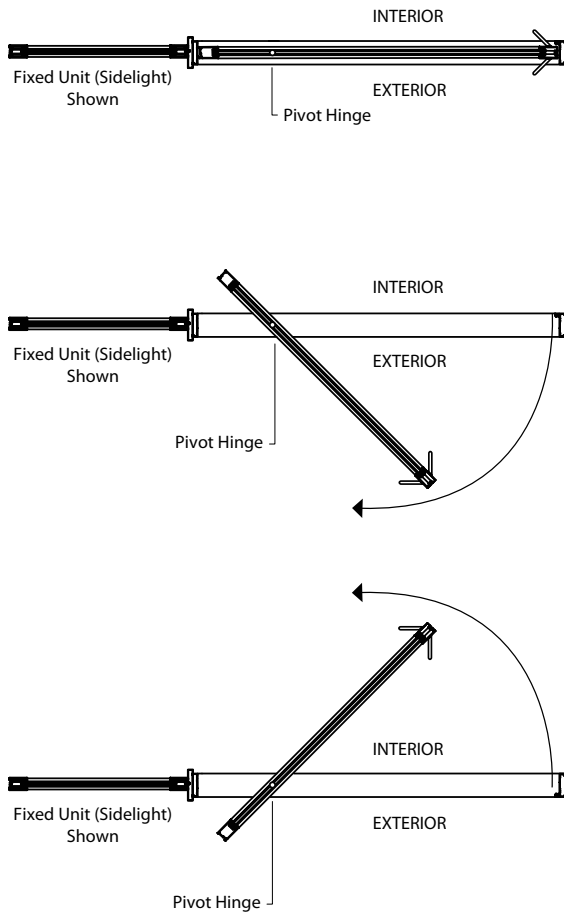

OPTIONAL DRAINAGE SYSTEM

Euro-Wall offers an optional water management system that allows water to drain away from the pivot door location. NOTE: This is a non water rated door in the state of Florida.

ALUMINUM & WOOD PANEL FINISH OPTIONS

STANDARD FRAME & ALUMINUM PANEL FINISHES

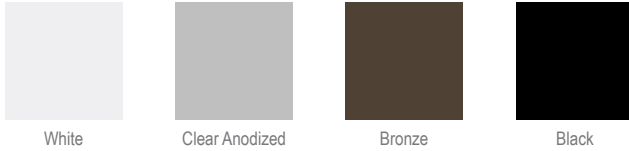

- Anodized, powder coat or Kynar® finishes available
- Custom powder coat or Kynar® finishes available
- Manufacturer color match options
- Custom wood grain finishes available

STANDARD WOOD PANEL FINISHES



White Oak Douglas Fir Mahogany / Sapele

In addition to the three standard wood finishes, Euro-Wall's Euro Vista Pivot™ wood panel can be finished with a wide variety of other exotic species.

INTERIOR WOOD CLAD FINISH OPTION

- Douglas fir
- Mahogany / sapele
- White oak
- Additional wood species available



ALUMINUM CLAD FINISH OPTION

- White
- Clear anodized
- Bronze
- Black
- Custom colors available

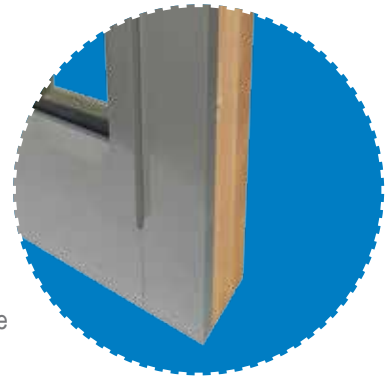

HANDLE OPTIONS

MULTIPOINT LOCK HANDLE



Available Finishes

Polished Stainless Steel
Brushed Satin
Bronze
Black

TRACK / FRAME

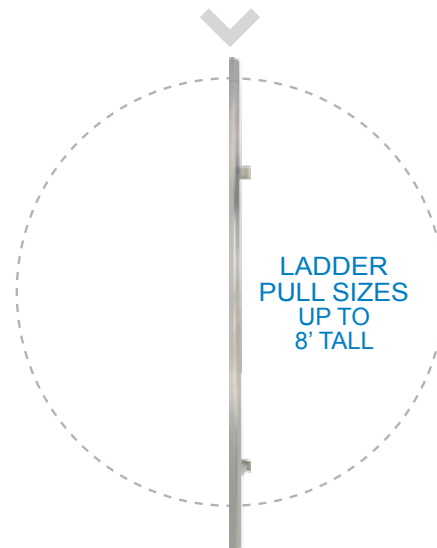

LADDER
PULL SIZES
UP TO
8' TALL

Available Finishes

Polished Stainless Steel
Brushed Satin
Bronze
Black
Custom Colors Available

EURO PIVOT™ DOOR PANEL OPTIONS

The illustrations below are just a few possible design examples for the aluminum & wood Euro Pivot™ door.

NOTE: Solid wood doors are not Florida Product Approved and are not impact rated

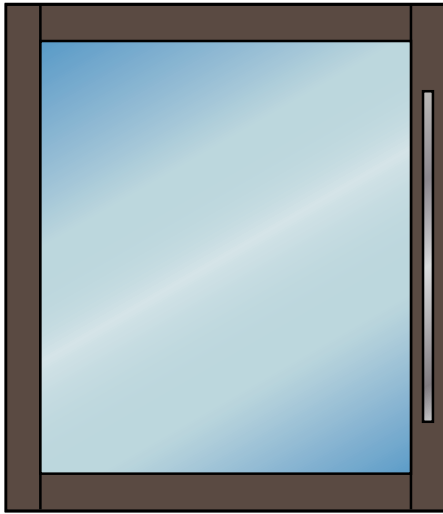

1

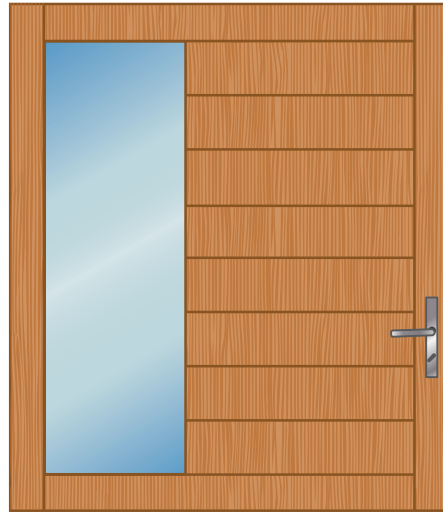

*2

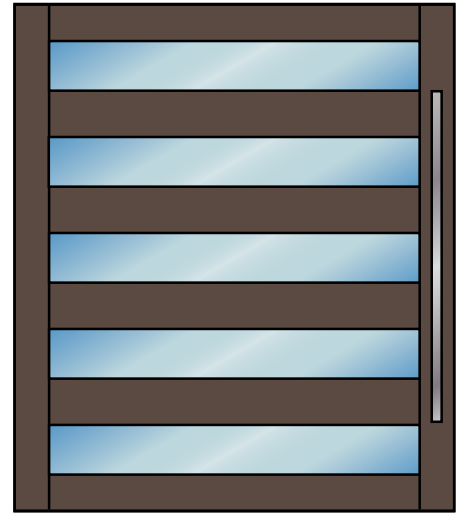

3

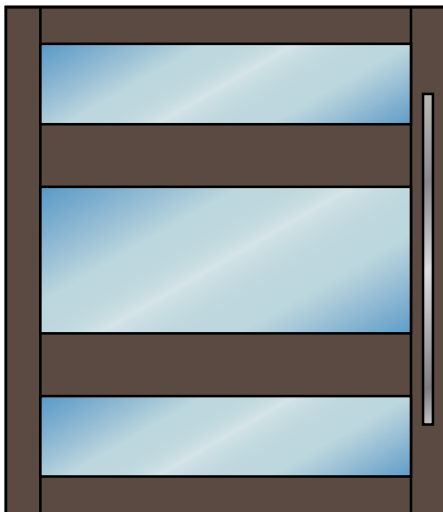

4

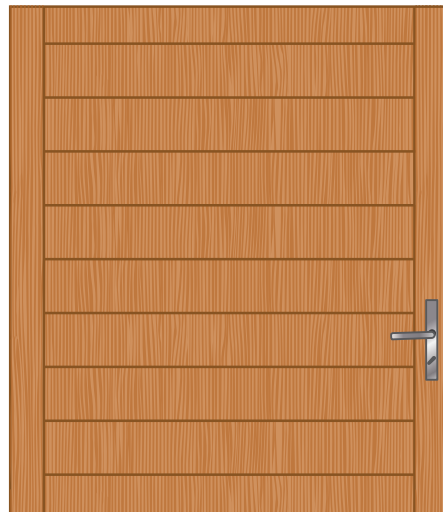

*5

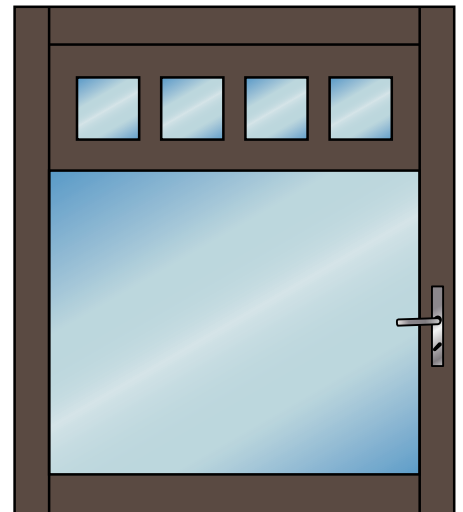

6

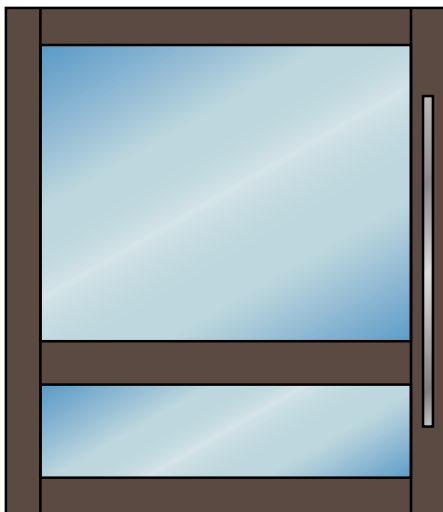

7



8

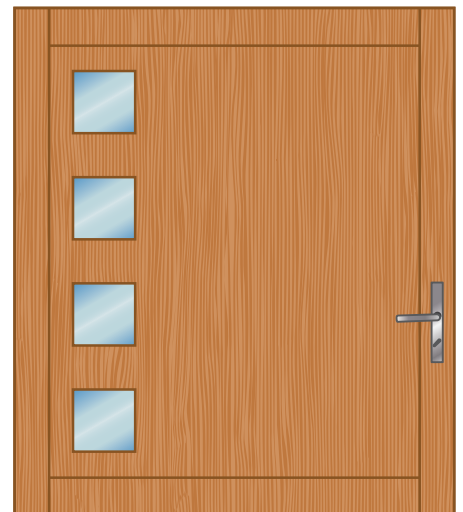

*9

**Configurations 2, 5 and 9 are available in wood or wood clad ONLY. All other pivot door samples are available in aluminum or aluminum with wood clad finish.*

PANEL & GLAZING CROSS SECTIONS

ALUMINUM & WOOD PANEL CROSS SECTION

Outswing Extrusion Shown

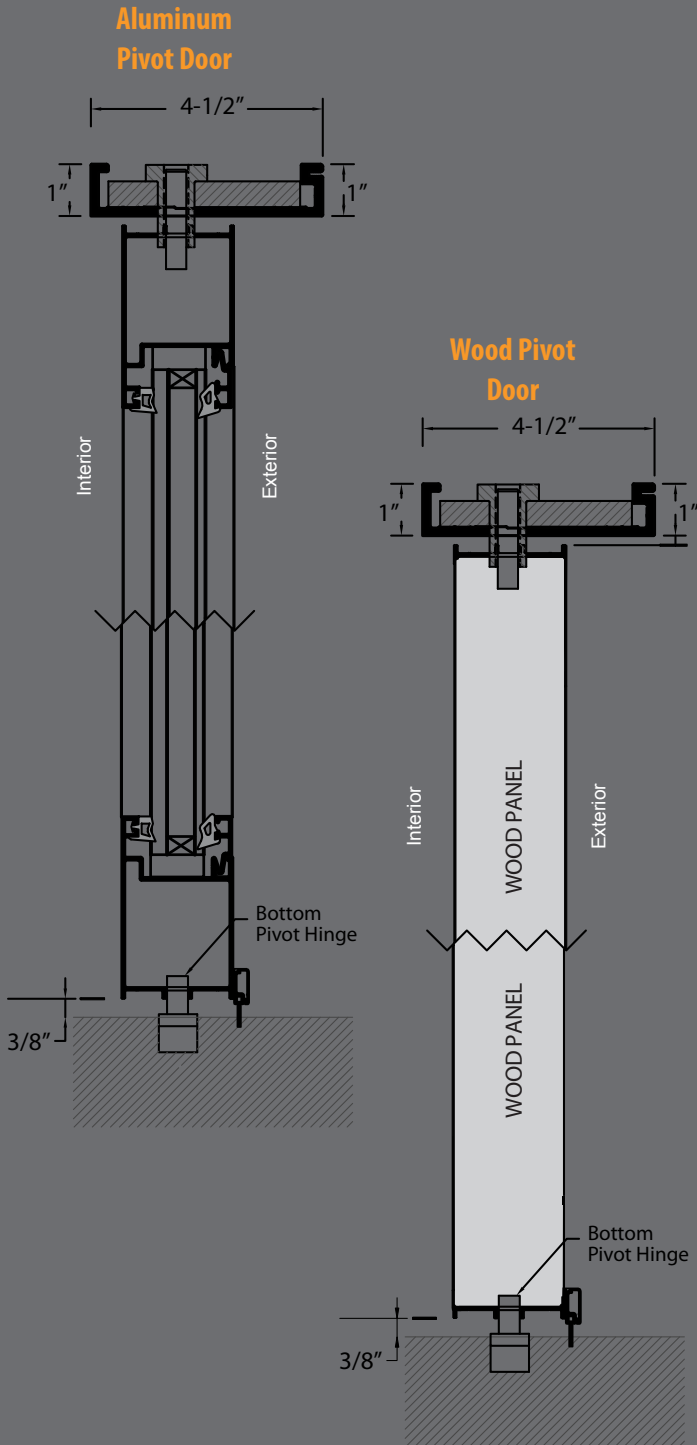

GLAZING DETAILS

Available glass options for the Euro Vista Pivot™:

Aluminum Pivot Door

- IG
- IG Impact
- 9/16" Impact Monolithic

Wood Pivot Door

- 1/4" Tempered
- 1/2" Tempered
- IG
- IG Impact
- 9/16" Impact Monolithic

Impact Glass (9/16" Monolithic)

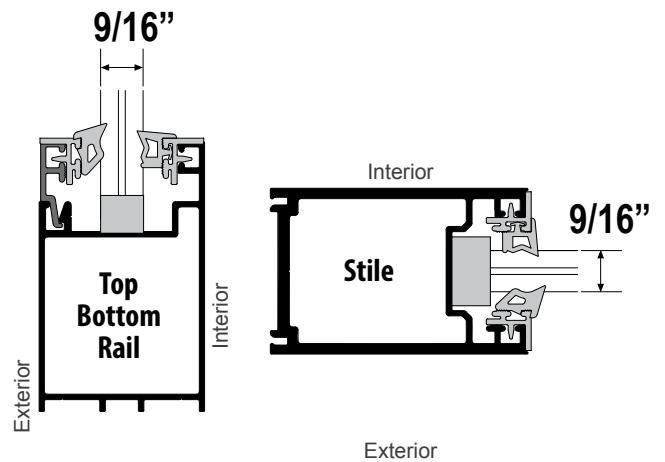

IG Impact

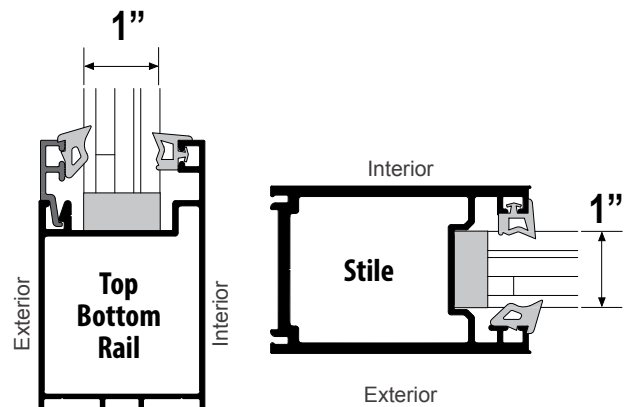

TEST PERFORMANCES

Aluminum Pivot Door

- Approved for use in Miami-Dade HVHZ Zone
- Florida Building Code Approved Product Approval FL 22410
- TAS 201 TAS 202 TAS 203
- AAMA / WDMA / CSA 101 / I.S.2 / A440-08 • NAFS-08
- Air Infiltration: A2
- Water Leakage Resistance: 60 DP
- Wind Load Resistance: 60 DP
- Wind Zone 4 (Hurricane) ASTM (cycling) E1996: DP60
- Wind Zone 4 (Hurricane) ASTM (impact) E1886: Pass
- Tested for Thermal Requirements

DESIGN PRESSURE CHART

| | | Panel Width (Inches) | | | | | | | | |
|-----------------------|---------|----------------------|------|------|------|------|------|------|------|------|
| Panel Height (Inches) | | 40 | 44 | 48 | 50 | 56 | 60 | 66 | 69.5 | 72 |
| | 72 | 60.0 | 60.0 | 60.0 | 60.0 | 60.0 | 60.0 | 60.0 | 60.0 | 60.0 |
| | 78 | 60.0 | 60.0 | 60.0 | 60.0 | 60.0 | 60.0 | 60.0 | 60.0 | 60.0 |
| | 84 | 60.0 | 60.0 | 60.0 | 60.0 | 60.0 | 60.0 | 60.0 | 60.0 | 60.0 |
| | 90 | 60.0 | 60.0 | 60.0 | 60.0 | 60.0 | 60.0 | 60.0 | 60.0 | 60.0 |
| | 96 | 60.0 | 60.0 | 60.0 | 60.0 | 60.0 | 60.0 | 60.0 | 60.0 | 60.0 |
| | 102 | 60.0 | 60.0 | 60.0 | 60.0 | 60.0 | 60.0 | 60.0 | 60.0 | 60.0 |
| | 108 | 60.0 | 60.0 | 60.0 | 60.0 | 60.0 | 60.0 | 60.0 | 60.0 | 60.0 |
| | 114 | 60.0 | 60.0 | 60.0 | 60.0 | 60.0 | 60.0 | 60.0 | 60.0 | 60.0 |
| | 118.375 | 60.0 | 60.0 | 60.0 | 60.0 | 60.0 | 60.0 | 60.0 | 60.0 | 58.5 |
| | 120 | 60.0 | 60.0 | 60.0 | 60.0 | 60.0 | 60.0 | 58.8 | | |
| | 126 | 60.0 | 60.0 | 60.0 | 60.0 | 54.6 | 51.6 | | | |
| | 132 | 60.0 | 60.0 | 51.5 | 49.7 | 45.0 | 42.5 | | | |
| | 138 | 60.0 | 50.8 | 43.0 | 41.4 | 37.5 | | | | |
| 144 | 60.0 | 42.7 | 36.1 | 34.8 | 31.4 | | | | | |

Product Approval FL 22410



EURO-WALL 10 YEAR WARRANTY

Euro-Wall warrants the products to be free from manufacturing defects for a period of 10 years from the date of purchase.

888.989.EURO (3876)
www.euro-wall.com

euro-wall®

FOLDING | SLIDING | STACKING

MANUFACTURING

2200 Murphy Court
North Port, Florida 34289
888.989.3876 • 941.979.5316

SHOWROOM

1211 Stirling Road, Unit 102,
Dania Beach, Florida 33004
954.610.2572

Proud Member of the American Architectural Manufacturers Association.



Website Resource
Euro Vista Pivot C3 1R

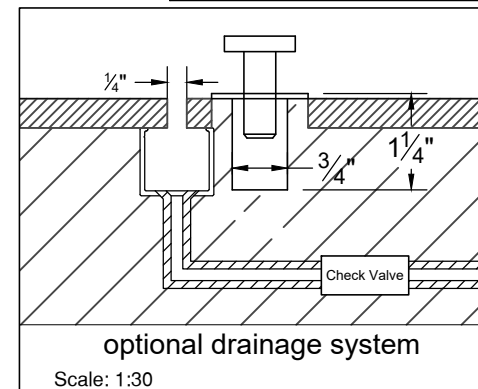
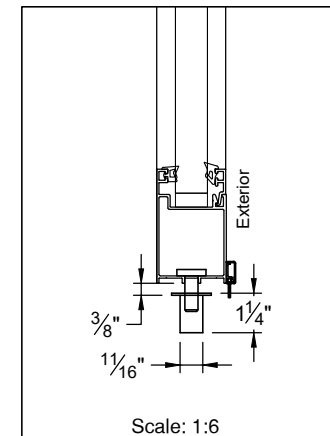
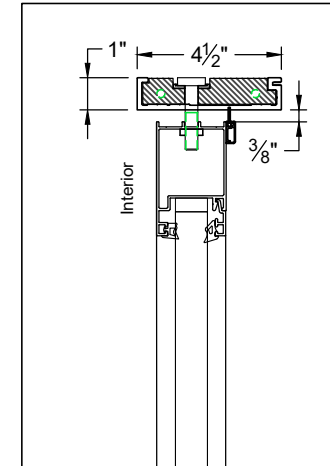
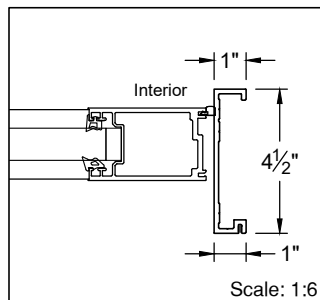
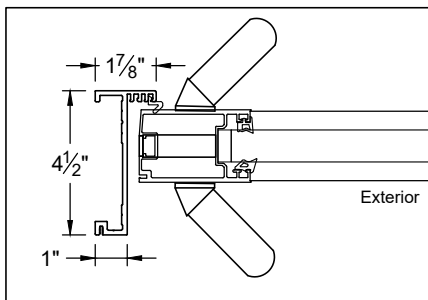
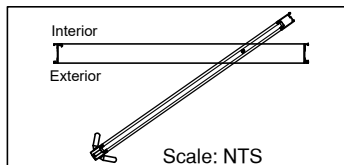
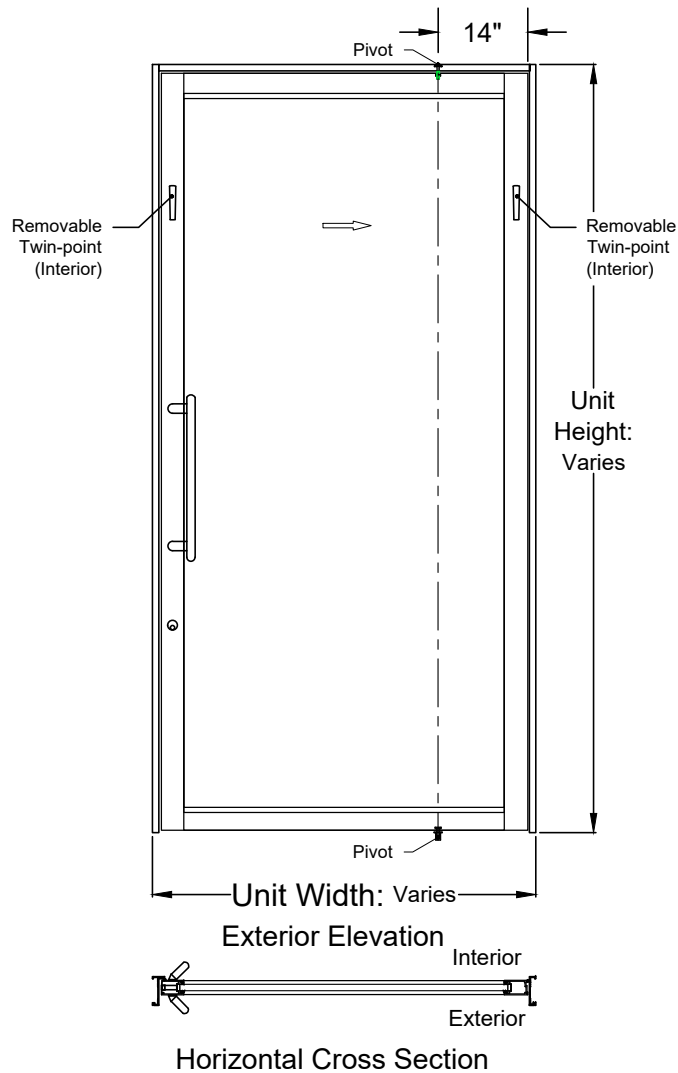

OTGS
 TECHNICAL GLAZING SOLUTIONS
 215-N Roger's Way
 Westhampton Beach, NY 11978
 O: 631.998.3611
 www.TGS.us

NOTES:
 Pivot doors

Max. Panel width: 96"
 (need to confirm height)

Max. Panel Height: 144"
 (need to confirm width)

GLAZING:
 Aluminum Pivot Door
 Options.

- IG
- IG Impact
- 9/16" Impact Monolithic

Wood Pivot Door Glass
 Options.

- 1/4" Tempered
- 1/2" Tempered
- IG
- IG Impact
- 9/16" Impact Monolithic

euro-wall
 FOLDING | SLIDING | STACKING | PIVOT

www.euro-wall.com

scale: 1:30

EURO-C3
 PIVOT DOOR SYSTEM