

# Procedure for saliva sample collection:

BLUE TOP

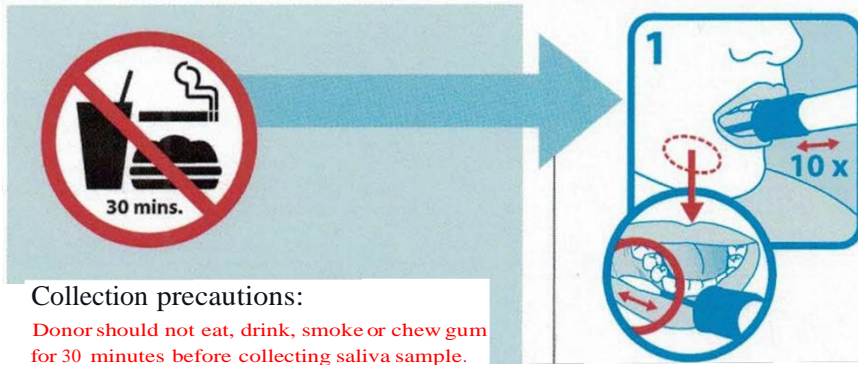

Open package and remove collector without touching sponge tip. Place sponge as far back in the mouth as comfortable and rub along the lower gums (see close up image) in a back and forth motion. Gently rub the gums 10 times. If possible, avoid rubbing the teeth.

## Collection precautions:

Donor should not eat, drink, smoke or chew gum for 30 minutes before collecting saliva sample.

Ensure the sponge tip does NOT come into contact with any surface prior to collection.

**Intended use:** ORAcollect•Dx is Intended for use in the non-invasive collection of saliva samples. Human DNA from the saliva sample is isolated, stabilized, and suitable for use in FDA cleared molecular diagnostic applications. Saliva samples collected using ORAcollect•Dx are stabilized and can be transported and/or stored long-term at ambient conditions.

**Contents:** Kit contains stabilizing liquid.

## Warning and precautions:

Rx only. For professional use.

Read all instructions carefully prior to sample collection; deviation may result in inadequate sample and impact DNA yield.

Choking hazard. Caution should be used when inserting sponge into the mouth.

Donors with xerostomia (dry mouth) may not collect adequate sample using these instructions resulting in lower DNA yield and an invalid sample for use.

Wash with water if stabilizing liquid comes in contact with eyes or skin. Do NOT ingest.

See MSDS at [www.dnagenotek.com](http://www.dnagenotek.com)



Gently repeat rubbing motion on the opposite side of the mouth along the lower gums for an additional 10 times.



Hold the tube upright to prevent the stabilizing liquid inside the tube from spilling. Unscrew the blue cap from the collection tube without touching the sponge.

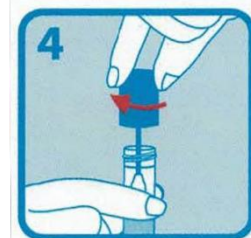

Turn the cap upside down, insert the sponge into the tube and close cap tightly.



Invert the capped tube and shake vigorously 10 times.

**Needs to fill label with full Name and DOB**

ANY QUESTIONS CALL 201-845-3467