

LEGEND

- Symbol: Ditch and direction of flow
- Symbol: Ditch with subdrain
- Symbol: Drainage easement
- Symbol: Proposed culvert (refer to 109097-ND for details)
- Symbol: Proposed well location
- Symbol: Approximate test well location
- Symbol: Approximate test well location (to be abandoned)
- Symbol: Proposed monitoring well location
- Symbol: Approximate borehole location (GEMTEC 2019)
- Symbol: Proposed septic envelope (conventional 300L/day)
- Symbol: Proposed septic envelope (type A 300L/day)
- Symbol: Top of foundation elevation
- Symbol: Underside of footing elevation
- Symbol: Top of bed elevation (conventional)
- Symbol: Top of bed elevation (type A bed)
- Symbol: Proposed terrace grade
- Symbol: Proposed terrace grade
- Symbol: Proposed grading direction and slope
- Symbol: Proposed elevation
- Symbol: Existing elevation
- Symbol: Proposed ditch elevation
- Symbol: High point
- Symbol: Low point
- Symbol: Point of vertical inflection
- Symbol: Top of berm elevation
- Symbol: Tree protection fence (City of Ottawa Detail F7)
- Symbol: Post and rail fence (City of Ottawa Detail F8)
- Symbol: Chain link fence (City of Ottawa Detail F9)
- Symbol: Butternut tree category 1
- Symbol: Butternut tree category 2 with 25m buffer
- Symbol: Butternut tree category 3 with 25m buffer
- Symbol: Butternut tree category 2 - to be removed
- Symbol: 15m setback from top of bank
- Symbol: 30m setback from normal high water mark
- Symbol: Future flood line after filling
- Symbol: Jock River normal high water mark and top of bank
- Symbol: Permanent rip rap

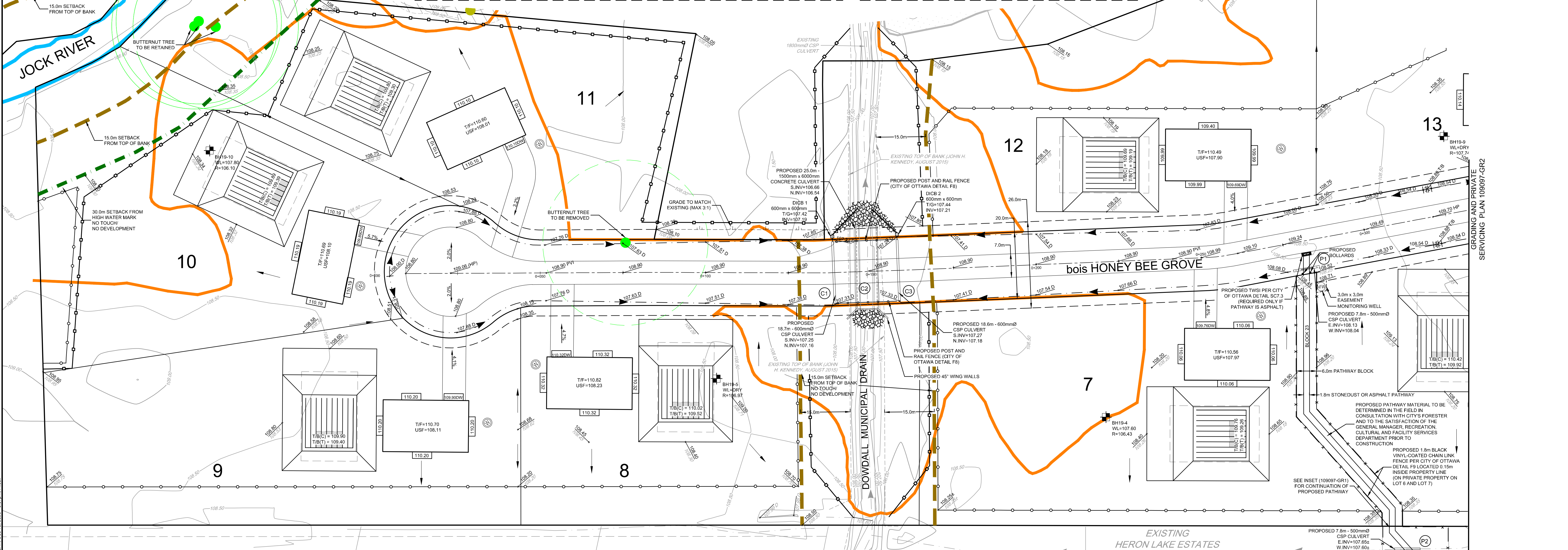

NOTE:
 THE POSITION OF ALL POLE LINES, CONDUITS, WATERMANS, SEWERS AND OTHER UNDERGROUND AND OVERGROUND UTILITIES AND STRUCTURES IS NOT NECESSARILY SHOWN ON THE CONTRACT DRAWINGS, AND WHERE SHOWN, THE ACCURACY OF THE POSITION OF SUCH UTILITIES AND STRUCTURES IS NOT GUARANTEED. BEFORE STARTING WORK, DETERMINE THE EXACT LOCATION OF ALL SUCH UTILITIES AND STRUCTURES AND ASSUME ALL LIABILITY FOR DAMAGE TO THEM.

No.	REVISION	DATE	BY
7.	REVISIONS TO PATHWAY BLOCKS	DEC 10/20	LAB
6.	ISSUED FOR REGISTRATION (MUSF REMOVED)	AUG 25/20	AAR
5.	REVISED PER CITY COMMENTS	JUN 5/20	LKC
4.	REVISED PER COMMENTS	DEC 13/19	LKC
3.	ISSUED FOR PRELIMINARY CONSTRUCTION QUOTE / SWIM MODELING	NOV 6/19	LKC
2.	REVISED PER CITY COMMENTS	JUL 18/19	LKS
1.	ISSUED FOR REVIEW	APR 11/19	LKS

SCALE	DESIGN	CHECKED	DRAWN	APPROVED
1:500	LAB	SMG	LKS	LAB
				SMG

FOR REVIEW ONLY

LOCATION	PROJECT No.
8089 AND 8165 FRANKTOWN ROAD, CITY OF OTTAWA HERON LAKE ESTATES II	109097
DRAWING NAME	REV
GRADING AND PRIVATE SERVICING PLAN	# 7
DRAWING No.	109097-GR1

NOVATECH
 Engineers, Planners & Landscape Architects
 Suite 200, 240 Michael Copeland Drive
 Ottawa, Ontario, Canada K2M 1P6
 Telephone: (613) 254-9643
 Facsimile: (613) 254-5867
 Website: www.novatech-eng.com

