



Aqua Pro Pump Systems
a Tomiko Inc. Company

VFP Pump Specification

Pump Series: Victory Fire Pro (VFP)

Description: The VFP residential and commercial fire and domestic booster series is designed for application that require fire protection and or domestic water velocities to be increased to support proper operation of fire sprinkler heads and domestic fixtures. It is also designed to meet NFPA 13D requirements and other regional governing codes.

Pump & Motor Overview

Pump Model #	VFP 40	VFP 60
Hz:	60	60
Voltage:	230v/1ph	230v/1ph
HP:	2	2
Discharge:	1-1/4"	1"
Phase:	1	1
Shutoff:	152' (65psi)	105' (46psi)
Max Flow (gpm):	57	55
Wt. (lbs.):	40	45
LRA:	35	45
FLA:	7	9
Cord:	UL (E231992-K) SJO 10'	



Aqua Pro Pump Systems
a Tomiko Inc. Company

Pump curve

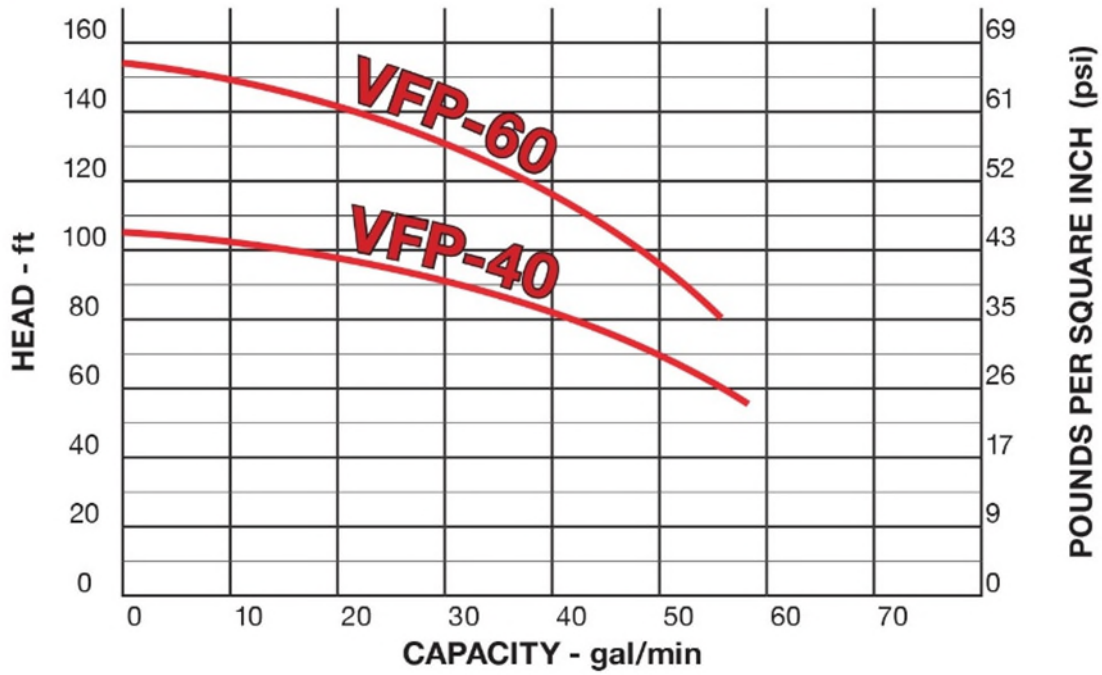



Aqua Pro Pump Systems
a Tomiko Inc. Company

Structural Drawing of Pump

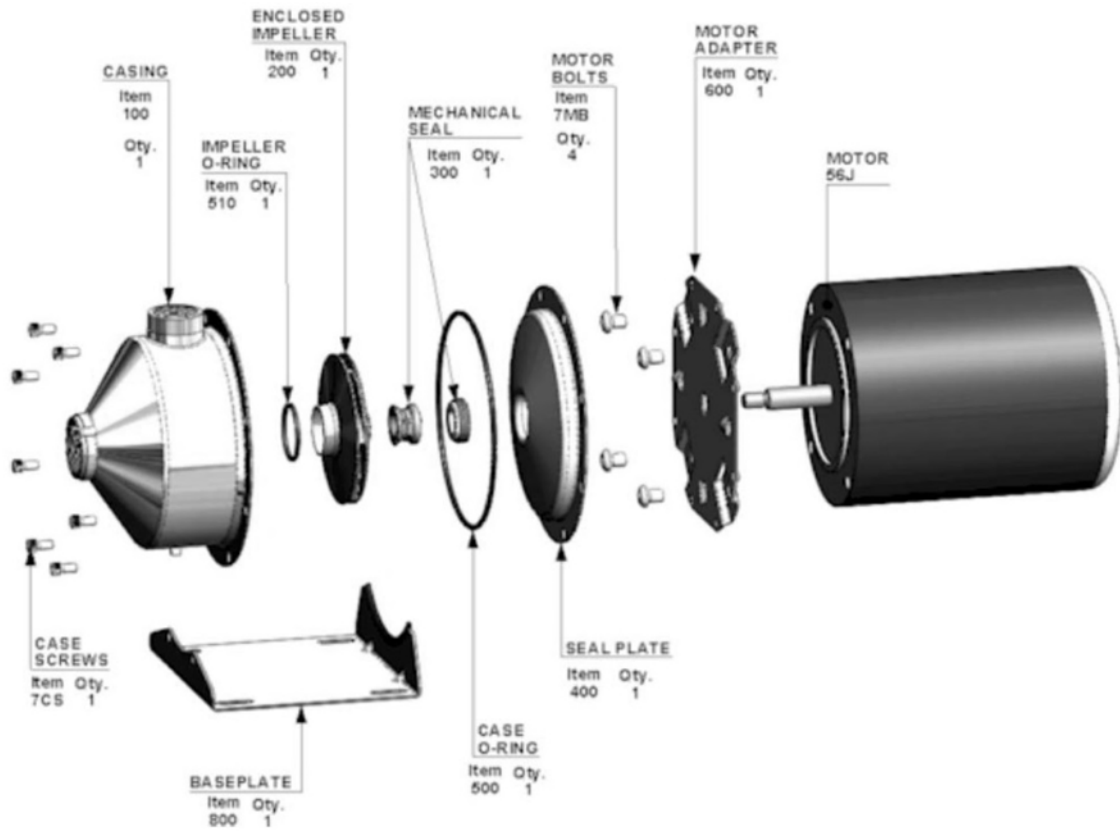



Aqua Pro Pump Systems
a Tomiko Inc. Company

Dimensional Data

VFP-40

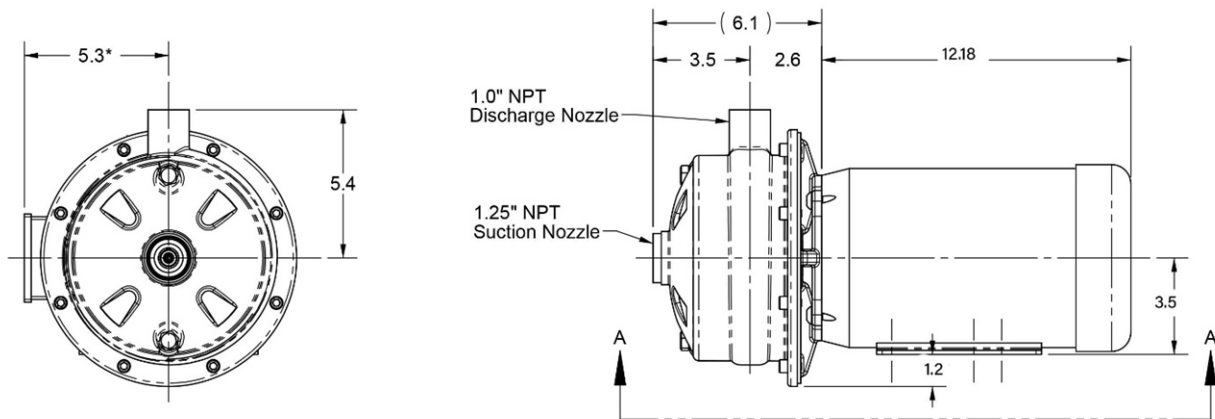

VFP-60

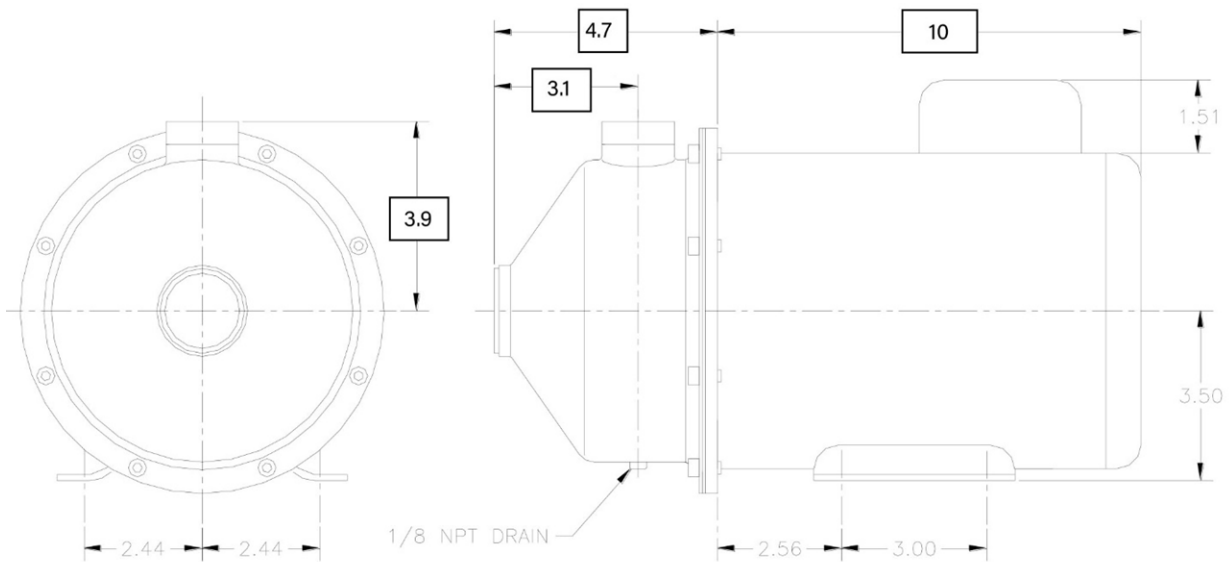



Aqua Pro Pump Systems
a Tomiko Inc. Company

Complete System Dimensions

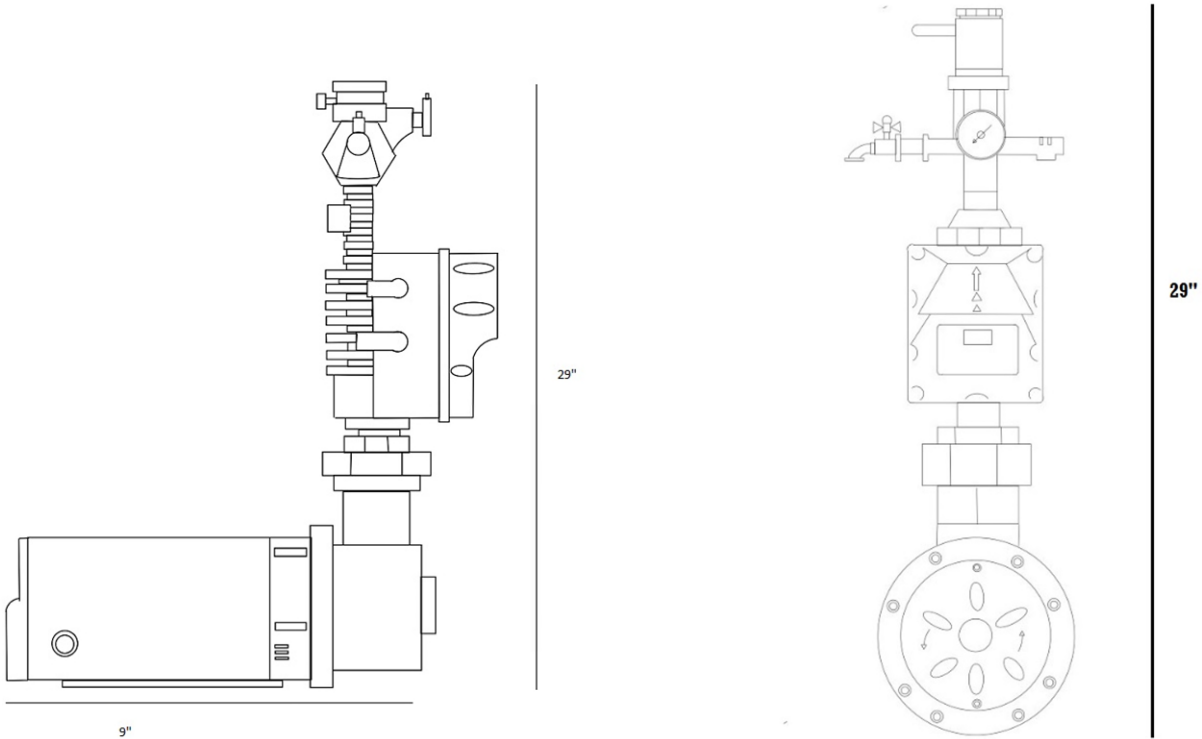



Specifications

- **Specified Operation:** Model _____ to perform at ___gpm at __ tdh, ___V/_ph.
- **Overview:** VFP series pumps are designed to be used in applications where fire sprinklers and/or domestic water needs to be boosted in pressure.
- **Operating:** VFP pumps should always be operated on/in accordance with their hydraulic performance curves and should not be operated under overload conditions (ie: too far to the right side of the respective performance curve).
- **Liquid Temp.** Max: 240^of
- **Pump Construction:** Each pump volute, impeller, backing plate, and motor cap is constructed of 304 grade, or higher, stainless steel.
- **Volute:** Constructed of 304 stainless steel.
- **Impeller:** Closed vane impeller constructed of 304 stainless steel.
- **Shaft:** Each shaft is made of 420 stainless steel and adequately sized with a 1.3 safety factor for use under maximum pumping volumes.
- **Bearings:** Each motor shaft will rotate on one heavy-duty sealed bearing at each end of the motor shaft.
- **Seals:** Each pump will be equipped with a Carbon/Ceramic/Buna seal as a standard. Specialty seals available.
- **Motor:** NEMA frame, high efficiency, three phase, ODP (TEFC available), class B insulation, thermal overload protection.
- **Stand:** Motors come standard with a footer and additional mounting channel as needed.
- **Power Cable:** Minimum 10' (3M) UL listed (E231992-K) SJO cable will be supplied with a 220v/1ph plug end that can be cut off and hard wired into a junction box or removed to be hard wired in accordance with specific local codes.
- **Controller:** APPS Ultra series inverter variable frequency drive (VFD) pump control.
- **Cover:** High density water and UV resistant composite.
- **Interface:** Simple digital readout for easy "front end" programming.
- **Check Valve:** Integrated with controller.
- **Repair:** Standard repair parts will be stocked domestically for fast shipping.
- **Testing:** Each pump system will be tested before being packaged for shipment.
- **Warranty:** Each pump has a 12-month warranty with additional months upon request.