

Pump Specification

Pump Series: ASI Heavy Duty

Description:

Pump Technical Specification			
Liquid	Temp		32°F ~ 104°F
	application		General commercial sewage
Pump	Structure	Impeller	Semi-open for (3 & 5 HP) (Vortex 7.5 & 10 HP)
		Seal	Dual Mechanical
	Material	Impeller	Cast iron Stainless steel
		Volute casing	Cast iron
		Bottom Plate	Cast iron
		Motor Bracket	Cast iron
		Mechanical seal	Cast iron
	Seal	Lubricant	SO VG#32
		Motor side	Carbon/Ceramic
		Pump side	Silicon/Carbide
	Type		Submersible air filled
	Insulation class		F Class 300°F
	Thermal protection		Internal Bimetallic
	Material	Casing	Cast iron
		Main Shaft	420 Stainless steel
		Cable	UL (E231992-K) SJO

Pump Electrical Specifications												
Model#	Hz:	Voltage:	HP:	Discharge:	Speed	Shutoff	Max Flow & Head	Wt. (lbs)	LRA	FLA	Cord	Cord length
ASI300/3	60	230v	3	3"	1750	57'	See Max Operating conditions	159	33		UL(E231992-K) SIO	50'
ASI1300/4	60	460v	3	3"		57'		150	21			50'
ASI500/3	60	230v	5	3"		73'		168	68			50'
ASI1500/4	60	460v	5	3"		73'		168	34.55			50'
ASI750/4	60	480v	7.5	4"		45'		316	52			50'
ASI10000/4	60	480v	10	4"		65'		326	80			50'



Aqua Pro Pump Systems
a Tomiko Inc. Company

Pump Curve & Max Operating Condition

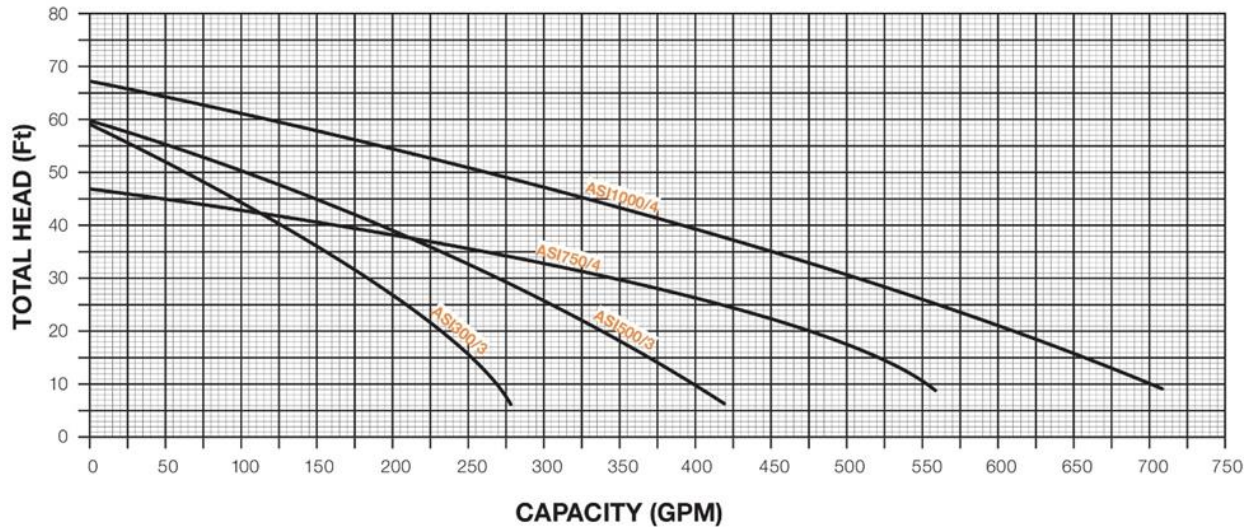

Model #	ASI 1300	ASI1500	ASI1750	ASI10000
TDH	7.5'	7.5'	8.5'	10'
GPM	266	433	566	729

Pump Dimensions

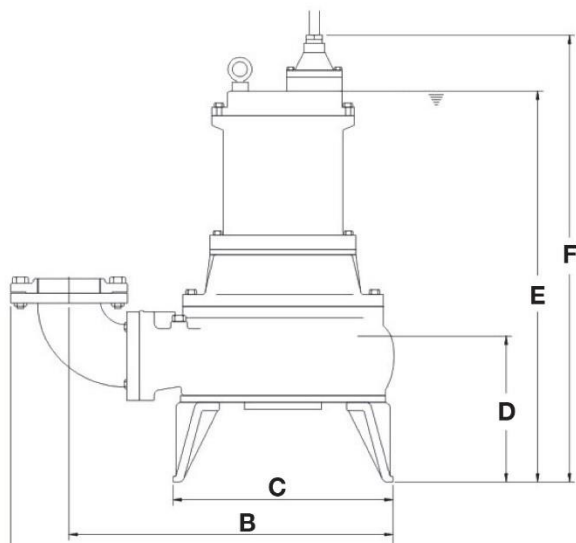

Unit: inches

Model#	A	B	C	D	E	F
ASI300	21.26	17.72	12.40	11.22	22.64	25.59
ASI500	21.26	17.72	12.40	11.22	24.41	27.56
ASI750	26.97	22.28	15.55	13.39	27.56	31.50
ASI10000	26.97	22.28	15.55	13.39	27.95	31.89

Specifications

- **Specified Operation:** Model _____ to perform at ____gpm at __ tdh, ____V/_ph.
- **Overview:** ASI series pumps are designed to be used in effluent applications where solids concentration is low and no larger than 3"-4" respectively.
- **Operating:** ASI pumps should always be operated on/in accordance with their hydraulic performance curves and should not be operated under overload conditions (ie: too far to the right side of the respective performance curve).
- **Construction:** Each pump volute, impeller, backing plate, and motor cap is constructed of FC200 (Class 30) cast iron and 304 stainless steel.
- **Motor:** Offered in single phase and three phase each motor is air filled with a dual seal oil filled chamber to protect the motor's electrical components from water intrusion at the liquid end of the pump. Motor is housed in an FC200 cast iron casing.
- **Shaft:** Each shaft is made of 420 stainless steel and adequately sized with a **1.3 or greater** safety factor for use under maximum pumping volumes.
- **Bearings:** Each motor shaft will rotate on one heavy-duty sealed bearing at the top and bottom of the motor shaft.
- **Seals:** Each pump motor will be protected by a dual seal design with Silicon Carbide /Silicon Carbide seal on the pump side and carbon/ceramic on the motor side.
- **Oil Chamber :** Each pump will come with an oil filled seal chamber with ISO VG. Number 32 hydraulic oil.
- **Power Cable:** Minimum 20' (6M) UL listed (E231992-K) SJO cable will be supplied. Longer cables will be adequately sized based upon UL standards.
- **Volute:** Constructed of FC200 (Class 30) cast iron
- **Impeller:** Non-clog vortex type impeller constructed of FC200 (Class 30) cast iron offered for 3hp & 5 hp configurations. For 7.5hp & 10hp impellers are offered in semi-open type.
- **Stand:** Tri-pod stand constructed of FC200 (Class 30) cast iron will support the entire pump.
- **Transport:** One each 304 stainless steel handle with a contoured rubber top coating will provide an easily transportable grip.
- **Paint:** Cast iron components will be painted with an epoxy paint that meets ASTM standards.
- **Repair:** Standard repair parts will be stocked domestically for fast shipping.
- **Testing:** Each pump will be tested before being packaged for shipment.
- **Warranty:** Each pump has a 12-month warranty with additional months upon request.



Aqua Pro Pump Systems
a Tomiko Inc. Company