

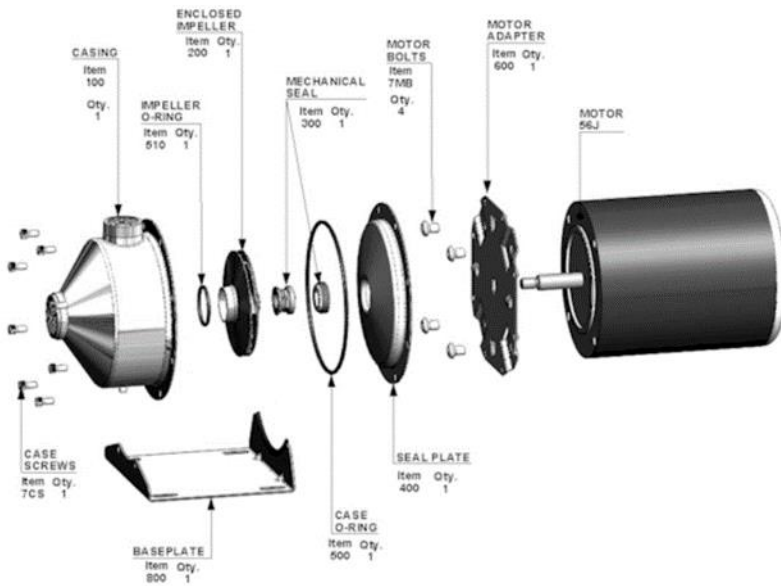

Pump Specification

Pump Series: Residential Fire Booster

Description:





Pump Technical Specification			
Liquid	Temp	250°F	
	application	Residential Fire Booster System	
Pump	Structure	Impeller	Closed (Centrifugal)
		Seal	Mechanical Seal
	Material	Impeller	Stainless steel
		Volute casing	Stainless steel
		Bottom Plate	Stainless steel
		Motor Bracket	N/A
		Mechanical seal	Car/Cer/Buna (custom: Car/Cer/EPR, Car/Cer/Viton, Car/SiC/Viton, SiC/SiC/Buna, SiC/SiC/EPR, SiC/SiC/Viton)
	Seal	Lubricant	N/A
		Motor side	N/A
		Pump side	N/A
Motor	Type	ODP or TEFC	
	Insulation class	250°F	
	Thermal protection	Thermal overload protection	
	Material	Casing	Stainless steel
		Main Shaft	Stainless steel
		Cable	Hard wired by others



Aqua Pro Pump Systems
a Tomiko Inc. Company

Pump Electrical Specifications

Model#	Hz:	Voltage:	HP:	Discharge:	Speed	Shutoff	Max Flow & Head	Wt. (lbs)	LRA	FLA	Cord	Cord length
FBS30	60	115/230	.75	1" or 1.5"		71'	See Max Operating conditions	35	47/26	9.4/5.2	UL(E231992-K) SJO	N/A
FBS40	60	115/230	1.5	1" or 1.5"		105'		40	60/33.5	12/6.7		N/A
FBS60	60	115/230	2	1" or 1.5"		115'		45	80/42.5	16/8.5		N/A
FBS70	60	230	3	1" or 1.5"		115'		75	64	12.8		N/A
FBS90	60	230	3	1" or 1.5"		110'		77	66	13.2		N/A
FBS100	60	230	5	1" or 1.5"		115'		85	82	16.4		N/A



Aqua Pro Pump Systems
a Tomiko Inc. Company

Pump Dimensions

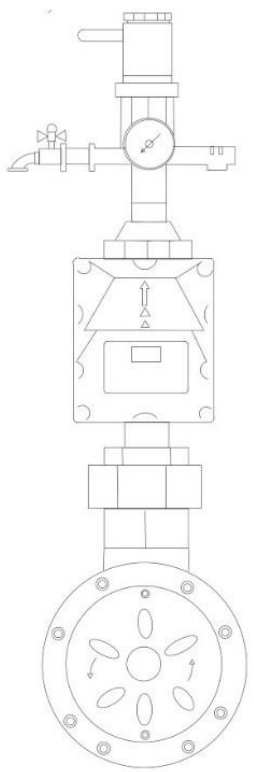
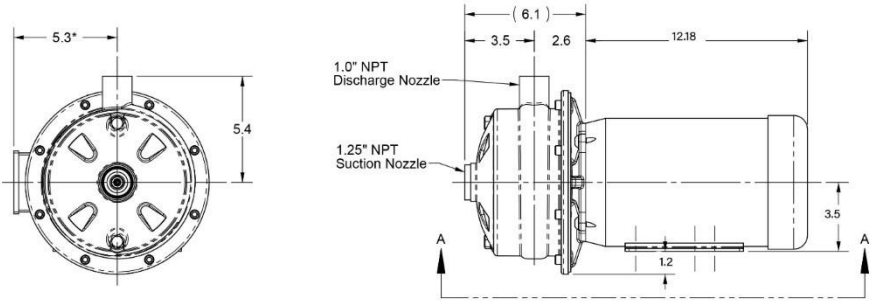

29"



Specifications

- **Specified Operation:** Model _____ to perform at ___gpm at __ tdh, ___V/_ph.
- **Overview:** __ series pumps are designed to be used in effluent applications where solids concentration is low and no larger than 1.3-1.77" respectively.
- **Operating:** __ pumps should always be operated on/in accordance with their hydraulic performance curves and should not be operated under overload conditions (ie: too far to the right side of the respective performance curve).
- **Construction:** Each pump volute, impeller, backing plate, and motor cap is constructed of FC200 (Class 30) cast iron and 304 stainless steel.
- **Motor:** Offered in single phase and three phase each motor is air filled with a dual seal oil filled chamber to protect the motor's electrical components from water intrusion at the liquid end of the pump.
- **Shaft:** Each shaft is made of 420 stainless steel and adequately sized with a 1.3 safety factor for use under maximum pumping volumes.
- **Bearings:** Each motor shaft will rotate on one heavy-duty sealed bearing at the top and bottom of the motor shaft.
- **Seals:** Each pump motor will be protected by a dual seal design with Silicon Carbide /Silicon Carbide seal on the pump side and carbon/ceramic on the motor side.
- **Seal Probe:** Each pump will come with an oil filled seal chamber with ISO VG. Number 32 hydraulic oil and a probe port for an APPS seal failure probe to be installed if required.
- **Power Cable:** Minimum 20' (6M) UL listed (E231992-K) SJO cable will be supplied. Longer cables will be adequately sized based upon UL standards.
- **Volute:** Constructed of FC200 (Class 30) cast iron
- **Impeller:** Non-clog vortex type impeller constructed of FC200 (Class 30) cast iron. 304 stainless steel impellers available upon request.
- **Stand:** Ring style or tri-pod type legs constructed of FC200 (Class 30) cast iron will support the entire pump.
- **Transport:** One each 304 stainless steel handle with a contoured rubber top coating will provide an easily transportable grip.
- **Paint:** Cast iron components will be painted with an epoxy paint that meets ASTM standards.
- **Repair:** Standard repair parts will be stocked domestically for fast shipping.
- **Testing:** Each pump will be tested before being packaged for shipment.
- **Warranty:** Each pump has a 36-month warranty with additional months upon request.



Aqua Pro Pump Systems
a Tomiko Inc. Company