

I, Kevin C. Wall, certify that this plat was drawn under my supervision from an actual survey made under my supervision (deed descriptions recorded in Book 2393, page 4); that the boundaries not surveyed are clearly indicated; that the ratio of precision as calculated is 1: 10,000+; that this plat was prepared in accordance with G.S. 47-30 as amended. Witness my original signature, license number and seal this eighteenth day of October, 2019.

PRELIMINARY PLAT
NOT FOR RECORDATION
NOT FOR CONVEYANCE
NOT FOR SALES

I hereby certify that the subdivision plat shown hereon has been found to comply with the subdivision regulations for Davidson County, North Carolina, and that such plat has been approved according to the procedure for approval of minor subdivisions.

Any development or construction on the lots shown on this plat must meet all the building and development regulations of the appropriate local government unit or agency.

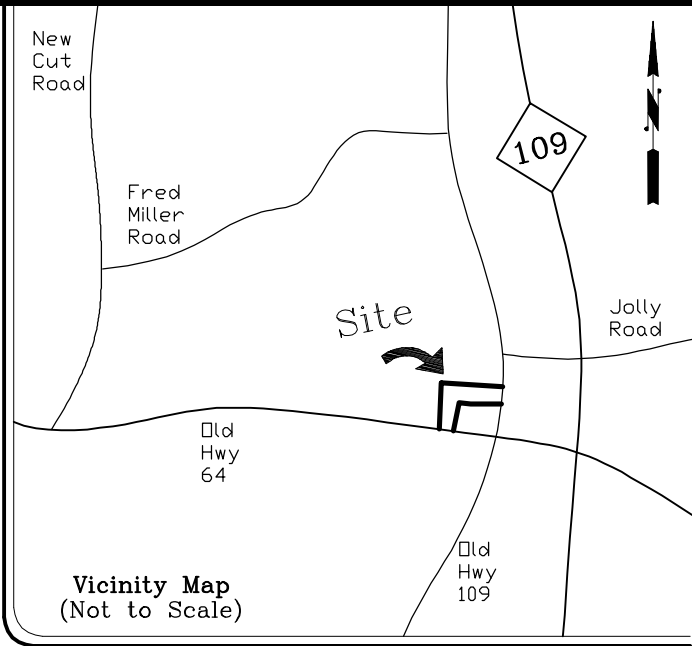
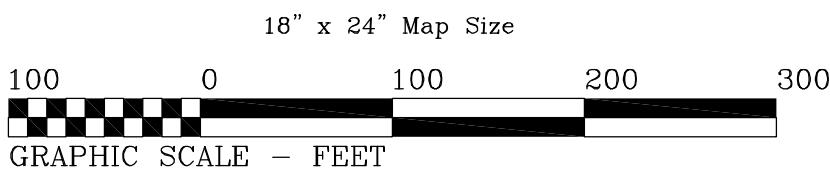

G.S. 47-30 (f)(11)(a)
That the survey creates a subdivision of land within the area of a county or municipality that has an ordinance that regulates parcels of land.

State of North Carolina, County of Davidson.

I, _____ Review Officer of Davidson County certify that the plat to which this certification is affixed meets all statutory requirements for recording.

Date Review Officer

Rebecca S. Howard
DB 2316 Pg 2389
Tax# 07-08-51A

Richard D. Trotter
DB 2283 Pg 1904
Tax# 07-08-53A

Crystal D. Ezzell
DB 2032 Pg 1740
Tax# 07-08-55

Booe Construction, LLC
Remainder of
DB 2393 Pg 4
±3.52 Acres

Clayton W. Gallimore
Amber M. Gallimore
DB 2264 Pg 48
PB 67 Pg 94
Tax# 07-13-4B

Timothy G. Glaser
Joanne D. Glaser
DB 2355 Pg 2263
Tax# 07-13-1A

Davidson County
Board of Education
Tax# 07-13-03

Randy G. McClure
DB 1656 Pg 191
Tax# 07-08-91

Randy G. McClure
DB 2081 Pg 2003
Tax# 07-08-56

Peggy H. Gallimore
DB 925 Pg 244
Tax# 07-12-11

Old NC Hwy. 64
SR 2205 (Paved)(Public)
Subject to (60') R/W per G.S. 136-51

Old NC Hwy. 109
SR 2416 (Paved)(Public)
Subject to (100') R/W per G.S. 136-51

Robert L. Black
DB 2249 Pg 1153
Tract II, First Parcel
Tax# 07-13-04
Remainder South of
Old NC Hwy. 64

Notes:

Scale: One inch equals one-hundred feet.
Area computed by coordinate method.

This survey plat is subject to any facts that may be disclosed by a full and accurate title search.

No attempt has been made as a part of this survey to obtain or show data concerning location, size, depth condition, capacity, or existence of any utility or public service facility. For information regarding utilities or facilities, contact the appropriate agency.

I, Kevin C. Wall, PLS NC-L-4228 certify that this map was drawn under my supervision from an actual GPS survey (utilized to provide a control network; 21 NCAC 56.1607) made under my supervision and the following information was used to perform the survey:
Class of survey; Class A
Positional accuracy: <0.10'
Type of GPS (or GNSS) field procedure: OPUS-RS
Date of Survey: 10/18/2019
Datum/Epoch: NAD 83 (2011)/Epoch: 2010
Published/fixed control: 9 CORS Stations
Geoid model: GEOID12A
Combined grid factor: 0.99987747
Units: US Survey Feet
Ground distances shown unless otherwise noted.

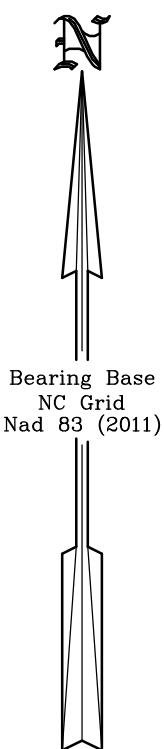

- (A) Planted Stone Found
NAD 83 (2011) Coordinates
N= 724,136.89 ftUS
E= 1,672,042.79 ftUS
- (B) 2" Iron Pipe Set
NAD 83 (2011) Coordinates
N= 724,082.86 ftUS
E= 1,672,855.93 ftUS
- (C) 2" Iron Pipe Set
NAD 83 (2011) Coordinates
N= 723,457.19 ftUS
E= 1,672,184.08 ftUS
- (D) 2" Iron Pipe Set
NAD 83 (2011) Coordinates
N= 723,462.71 ftUS
E= 1,672,006.31 ftUS

Abbreviations/Legend

DB Deed Book
EP Edge of Pavement
PB Plat Book
Pg Page
PL Property Line
R/W Right-of-Way
▲ Computed Point
⋈ Utility Pole
— Overhead Utility Lines
— zz —

[#190] 911 Address

PROFESSIONAL
LAND
SURVEYING

KEVIN C. WALL
PO BOX 697
DENTON, NC 27239
336-659-1955

Minor Subdivision for Owner

Booe Construction, LLC

Davidson County, North Carolina
Emmons Township
Tax Map 13 Parcel #4D
Deed Book 2393 Page 11534
Field Work By: KW-EW
Mapped By: KW
Date of Survey: 10/18/19
Job# D 3118.A