

# NEW! INTRODUCING

The Elite Eliminator Tub & Alley System

FALL 2021



LIVESTOCK EQUIPMENT

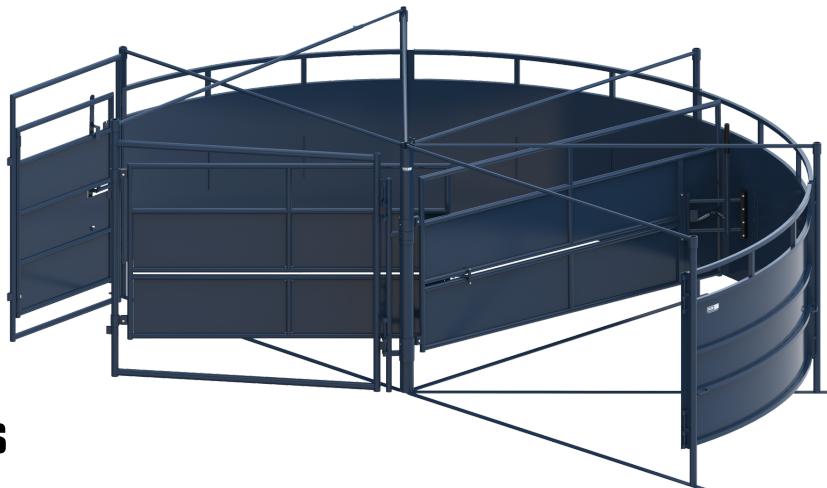
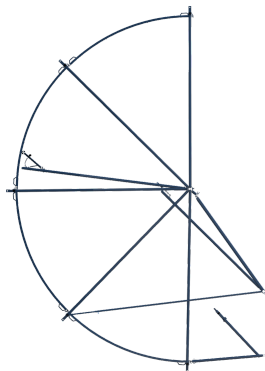

## 11' ELITE PROCESSING TUBS

### Completely Customizable!

The heavy-duty Elite series processing tub features the two-gate eliminator system, preventing cattle from circling back to the pivot post. The gate post directs the flow of the cattle to the working alley.

- Constructed from 14 gauge square tubing and sheet metal
- 2" standard wall pipe legs
- 11' radius tub and is interchangeable for left or right-hand setup
- The panels and gates are 6' tall with bottom and top supports at 7'
- Available in 2, 3, and 4 section configurations
- Comes standard with a load out gate located at the exit of the tub

## FIND THE ALLEY THAT WORKS FOR YOU

### Parallel or Wedge Adjustable Alleys

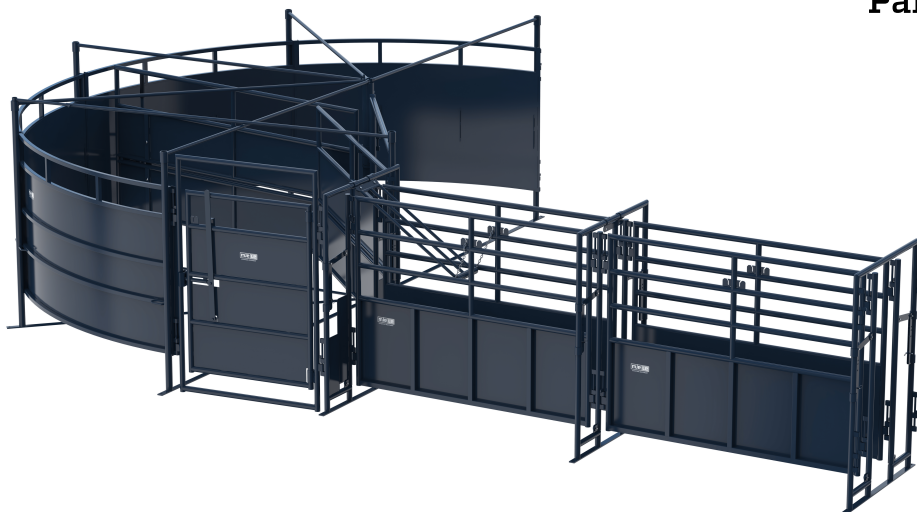

Elite Parallel sheeted alley sections are constructed from 14 gauge tubing and sheet metal.

- Each section is 8' long, & can be adjusted from 16" to 32" wide
- The panels mount 6' tall on easily adjustable frames

Elite Wedge Alley is also easily adjustable, with the bottom maintaining at 16" width.

- Sections can be infinitely added
- 2-section Alleys come standard with one no-back gate
- Adjustment latches and hinge points are specifically located to avoid manure and reduce rust and corrosion

800 W. CORTEZ ST. MONTEZUMA, KS 67867. P. (620)846-6767  
WWW.MJELIVESTOCKEQUIPMENT.COM

# ACCESSORIES & MORE

## Great Additions to Elite Working Systems



### SINGLE ALLEY BLOCK DOOR

Product Code # 022-BLOCKDOORASS

Single Alley Block Doors can be added to the Elite livestock handling equipment to stop cattle safely when using a Palpation Cage. Our solid design works well for blocking light to keep cattle in a forward direction toward the light.

- Length: 7'8"
- Width: 10"
- Height: 7'
- Made of 2-3/8" and 1.9 14-gauge round tubing and 14-gauge sheet iron
- Made from American Steel

### PALPATION CAGE

Product Code # 022-PALPATIONADJ[TYPE]

The MJE LE Palp Cage can be added to any Elite Adjustable Alley before the working chute to shut off cattle in the alley or it can be placed after a block door for a more secure system. Our unique 2-setting latch adds another layer of safety for the handler and the cattle.

- Length: 4'
- Width: 4'
- Height: 7'1"
- Made with 1.9" 14-gauge round tube & 14-gauge sheet iron
- Made from American Steel



800 W. CORTEZ ST. MONTEZUMA, KS 67867. P. (620)846-6767  
WWW.MJELIVESTOCKEQUIPMENT.COM