



Dreamy Colors Instructions & Idea Guide



CAUTION:
Contains FUNCTIONAL SHARP POINTS.
Not for children under 4 years.

Instructions & Idea Guide AGES 8+

Before You Start

SAFETY INFORMATION:

Ages 8+ Keep out of reach of children under 4 years of age. Contains functional sharp point. Product does not contain food or drink and should not be put in mouth or ingested. Non-toxic.

CLEANUP TIPS AND STAIN ADVISEMENT:

Acrylic pouring paints are made to create permanent artworks when dry. These paints may stain clothing and surfaces. Wear a smock and old clothes. Cover your work surface and any nearby furnishings with scrap paper, wax paper, or other protective material. Keep paint away from walls, carpet, vinyl, finished and unfinished wood, and other materials that cannot be laundered. Clean immediately with soap and water while paint is still wet. Wash hands with soap & water after use.

USAGE TIPS:

Before painting, gently roll the capped paint bottles on a flat surface to mix the paint. Do not shake the bottles. Unscrew the bottle cap and remove the seal ring before use. Recap bottles when not in use. To prevent color mixing, avoid touching the bottle tip to other colors while painting & always recap with the same cap—look inside the cap to see the paint color. If bottles become clogged, DO NOT SQUEEZE THE BOTTLES FORCEFULLY. Doing so may cause splattering. Poke a toothpick or paperclip into the bottle tip to unclog. Then recap and gently tap the upright bottle on a flat surface. Repeat if needed.

DRYING TIME:

Paintings need 24-26 hours to dry to the touch. For best results, do not touch or move your painting until completely dry. Drying time may vary due to temp. and humidity.

How to Paint

Remember: Wear a smock, Roll up sleeves, Cover work surface, Wipe pick w/ paper towel



1 POUR paint in a spiral. (GENTLY squeeze only.) Then, TILT & ROTATE gently until paint covers surface.



2 PAINT lines, rings, or dots with other colors to make a pattern.

How to Paint

Continued below...
(See back pages for more design ideas)



3 PULL the pick thru the paint. REPEAT around the pattern, pulling in direction shown.



4 PULL pick thru the paint as shown. Let dry at least 24 hours. Display!

Design Ideas

Follow the basic steps from "How to Paint" to create these designs or your own ideas!

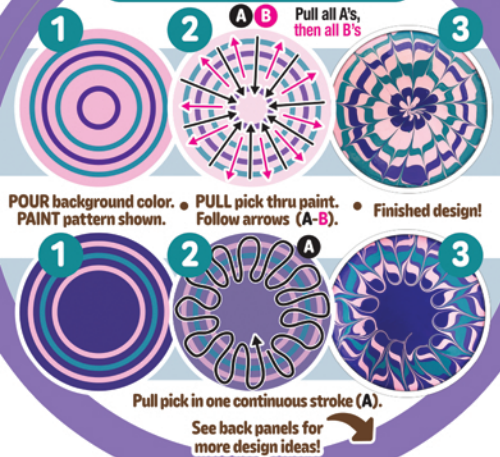

Design Ideas

Follow the basic steps from "How to Paint" to create this design or your own ideas!

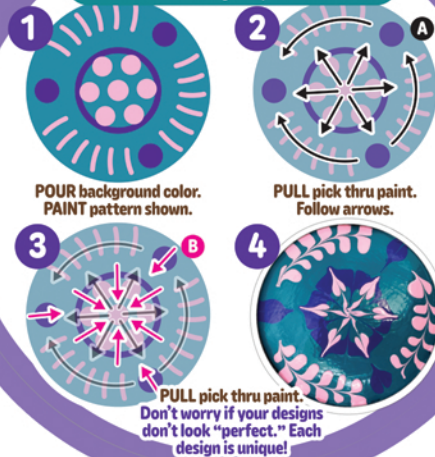

Other Ideas

There's no wrong way to paint! You can try your own ideas & free-form designs!

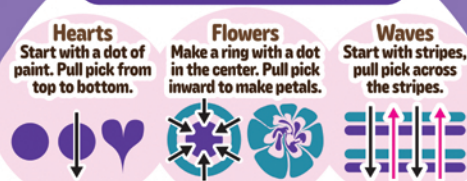

Tips & Tricks

PAINTING TIPS • If bubbles appear in your painting, gently poke them with the pick to pop before paint dries. • Use steady, gentle pressure to squeeze paint from bottles. • Keep the bottle tip lifted above the paint surface while applying paint to avoid color mixing. • Wipe the pick with paper towel between each stroke direction. If using one continuous stroke, wipe the pick before your next stroke. **AFTER YOU'RE DONE** • Display your painting on top of the cup or hang it on a hook or tack on the wall. • Use leftover paint to create more designs on discarded lids from home or on mini canvases purchased from a craft store. • You can use the cup to store leftover paints, other art supplies, or your own small items.

ArtCafé Latte-Inspired Painting Set



Contents: 4 paintable lids/frames 3 bottles acrylic paint 1 fl oz (29 mL ea) 1 wood paint pick



Collect them all!
MIX & MATCH colors!

Conforms to ASTM D-4236 • MADE IN CHINA

Tree Town Art Café™ is a trademark of Tree Town Toys. All rights reserved. © 2024 Tree Town Toys • 2531 Jackson Rd., Suite 117 Ann Arbor, MI 48103 USA • www.treetowntoys.com
Contents and colors may vary from those shown. Product duplication for illustration purposes only. Artistic results may vary based on skill level. ITEM# AC000

treetown