

GETTING STARTED

PRELIMINARY ROOM MEASUREMENTS

Before we can begin the 3-D design of your project, we will need measurements for the room in which your new cabinets will be installed.

Most of our remodels do not involve moving plumbing or utilities.

To get started, we need the length of the walls, the size of the doors and windows, the distance from a wall to a door or window, and the distance to any utilities.

If you select CabinetWorks by Oaklee for the project, one of our professional staff members will set a date and time to meet with you at the project site to precisely measure the room, using the plans agreed to. Any corrections will be made before finalization of the contract and ordering of the cabinets.

Use the following example as a guide for gathering your preliminary room measurements.

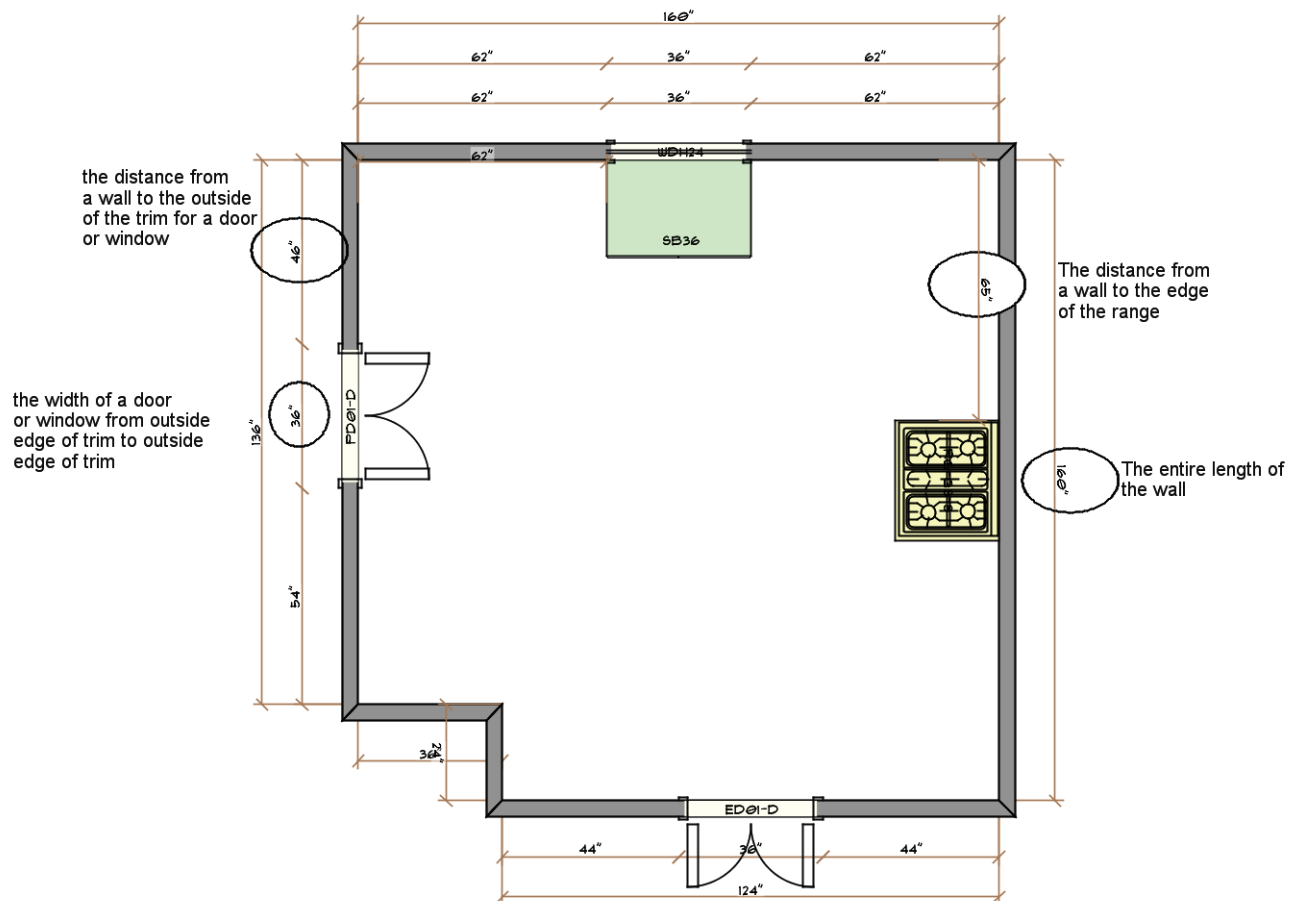



OAKLEEDESIGN.COM

Questions?

Call us at 918 . 833 . 1203
or stop by our showroom at
411 S Lincoln Ave, Suite I, Sand Springs, OK