



Features & Benefits

INNOVATIVE DESIGN AND TESTING

- The 4-cylinder 4 stroke EPA certified Engine is purpose built and designed for reliability.
- Engineered for easy installation and maintenance, with a compact. The APS-S20NG is equipped with a quiet weatherproof enclosure and cold weather kit, consisting of a Battery Heater, Oil Filter Heater, Coolant Circulation Heater, and Battery Charger. This unit will be ready when you need it.
- High-performance oil pump with large capacity oil sump provides long engine life.

RADIATOR SYSTEM

- Liquid cooled engine with large capacity radiator for continuous operating at ambient temperatures of above 50°C.

LOW NOISE LEVEL

- Quiet operation, with the critical grade muffler is mounted inside the unit to lower noise while ensuring operation of the generator throughout any outage.

GENERATOR PACKAGE SPECIFICATIONS

Rated Power (NG/LPG)	Single	18KW/20KW
	Three	22.5KVA/25KVA
Max Power (NG/LPG)	Single	19.8KW/22KW
	Three	24.7KVA/27.5KVA
Power Factor	Single	1.0
	Three	0.8
Rated Frequency) (HZ)	60	
Rated Speed (rpm)	3600	

Quiet Weatherproof Enclosure

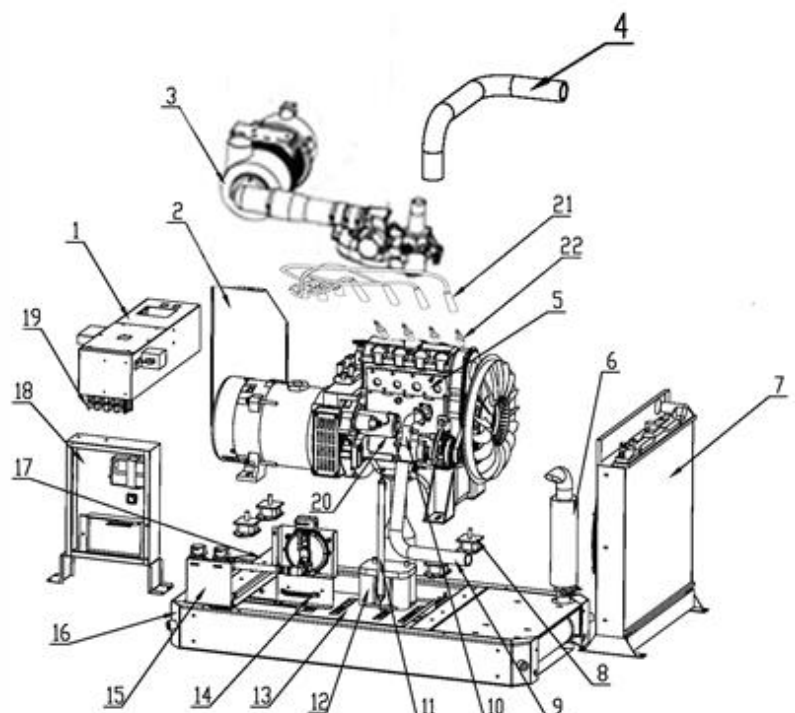
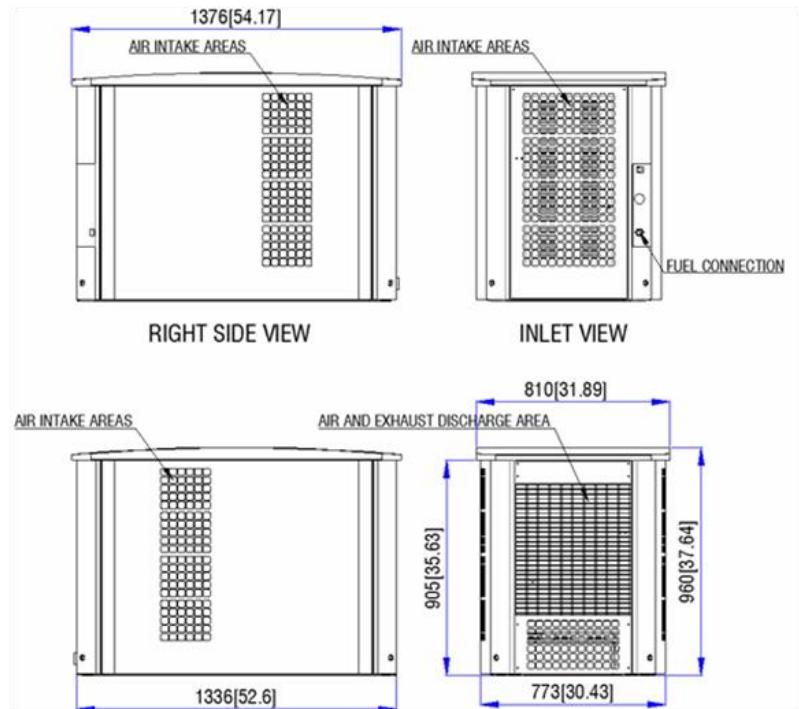

Premium 20kW Standby Generators

4-cyl Liquid-Cooled Natural Gas Engine



ALPINE POWER
SOLUTIONS INC.

ENGINE SPECIFICATIONS

Manufacturer/Model	PD/465QR
Engine Type	4 Cylinders, 4 Stoke
Displacement	0.998 liters(60.9in3)
Bore	65.5 mm (2.52 in)
Stroke	74 mm (2.91 in)
Compression Ratio	9.5:1
Ignition system	ECM
Intake Air System	Naturally Aspirated
Starter rated voltage	DC 12V/0.8KW Electrical start
Battery charging	DC 14V/70A
Oil capacity	4.0 liters
Air cleaner type	Dry with Prefilter
Recommended cold cranking amps: (CCA) rating for -18°C (0°F)	550

ENGINE COOLING SYSTEM

Cooling System	Closed Liquid Cooled
Coolant Capacity	5L
Coolant Temp Range	-25°C~106°C
Radiator Fan	7 Blade Φ380

FUEL SYSTEM

Fuel Type	Natural Gas or LPG
Fuel supply pressure, kPa (in. H2O):	NG: 1.2--2.7 (5-11) LPG: 1.7--2.7 (7-11)
Fuel pipe Size	3/4 pipe
Fuel Pipe Length	<33ft
Fuel Usage @50% (NG)	178ft ³ /h
Fuel Usage @100%(NG)	286ft ³ /h
Fuel Usage @50%(LPG)	92.6ft ³ /h
Fuel Usage @100%(LPG)	147ft ³ /h

ALTERNATOR SPECIFICATIONS

Rated Power	20KW
Alternator Type	Synchronous,
Pole	2 poles
Rotor Insulation Class	F
Stator Insulation Class	F
Protection Level	IP23
Winding Material	Copper
Sea level	≤3280ft
Coupling	Direct coupling

GENERATOR SET PERFORMANCE

Governor regulation class	ISO 8528 Part 1 Class G2
Governor type	Electronic
Voltage regulation	±1.0%
Random voltage	±1.0%
Frequency regulation	Isochronous
Frequency regulation, steady state	± 0.5% @ 60 Hz

UNIT DIMENSIONS AND WEIGHTS

Unit Weight (lbs)	772
Gross Weight (lbs)	849
Unit Size (in)	54.17×31.89×37.8
Packing size (in)	57.87×35.4×43.3

NOISE LEVEL

Sound output in dB(A) at 23 ft (7 m) with generator in exercise mode *	64
Sound output in dB(A) at 23 ft (7 m) with generator operating at normal operation*	72

Nominal fuel rating: Natural gas: 37 MJ/m (1000 Btu/ft), LPG: 93 MJ/m³(2500 Btu/ ft³)