



A Glass Apart



www.glasscolabs.com



www.danlogitech.com



**STAR PERFORMER**  
Leading manufacturing company  
in the field of scientific glassware  
**INDIA'S NO.1 EXPORTERS**  
**5 TIMES CAPEXIL AWARD WINNERS**

**QR-LabGlass™**



Known for simplicity  
& unique adaptations  
**3 DESIGN PATENT RECEIVED**



**MANPOWER**  
EMPLOYEES 950+



**INDIAN ENGINEERING**  
Affordable Technology & Software  
**Labs-Connect™ BlackDiamond™**



**IDEAS**  
which provoke competitors to think a step  
ahead inbuilt temp probe, C°/F° Selection

**CeraClick-System™**



CERTIFIED



**WORLDWIDE PRESENCE**  
in over 83 Countries  
**45% US, 35% EU, 20% OTHERS**  
**USP | DIN | ASTM | ISO**

**DAN LOGITECH INSTRUMENTS PVT. LTD.**

# Stainless Steel Ceramic Coated Top

Magnetic Stirrer with Hotplate - **Analog**



- ▶ Aluminium Moulded Body
- ▶ Easy to operate temperature & Stir controls
- ▶ Installed with double Safety PT sensor for fail safe operation
- ▶ Large top plate to assist beakers upto 2000 ml
- ▶ High magnetic strength.
- ▶ Electronic variable speed control with Knob
- ▶ Electronic variable temperature control with knob
- ▶ Temperature reached Indicator, To ensure correct temperature of plate surface.
- ▶ Stirring & temperature indicators
- ▶ Inbuilt error indicators for heat & Stir function
- ▶ Hot top warning indicator for temperature >50°C

Item Code	Volt	Hz	Watts	Top Plate
<b>710.DNAG.01</b>	230	50	650	SS Ceramic Coated
<b>610.DNAG.01</b>	230	50	650	Aluminum Ceramic Coated
<b>710.DNAG.02</b>	115	60	650	SS Ceramic Coated
<b>610.DNAG.02</b>	115	60	650	Aluminum Ceramic Coated

## Including Accessories

Item Code	Accessories
<b>850.800.02</b>	Magnetic Stirring Bar 35mmx9mm

**710.DNAG.01**

## Technical Specification

Heating Plate Material	Stainless Steel 304 Grade/ Ceramic Coated
Dimension of heating plate	150 Ø
Speed range	50-1600 RPM
Maximum Stirring bar Length	Can use upto 80 mm bar (at lower speed)
Temperature Range	Ambient to 350°C approx
Dimensions of hot plate body	273x160x102mm
Weight of body	2.8 kgs
Permissible ambient Temperature	5- 40 °C
Permissible relative moisture	80%
IP Class	22



**SS. CERAMIC COATED**

Scan to  
Watch Video &  
Download manual



# Stainless Steel Ceramic Coated Top

Magnetic Stirrer with Hotplate - **Digital**

- ▶ Aluminium Moulded Body
- ▶ Chemically resistant, Ceramic coated alloy plate
- ▶ Even heat distribution.
- ▶ Large top plate to assist beakers upto 2000 ml.
- ▶ Single multi-turn intelligent knob Operation.
- ▶ High magnetic strength.
- ▶ Digital set up with independent displays.
- ▶ Selection of Celsius or Fahrenheit.
- ▶ Selection of hot plate or probe temperature control.
- ▶ Settable safety cut-off for maximum temperature limit for top plate or probe.
- ▶ Installed with double PT sensors for safety & fail safe operating mechanism.
- ▶ Hot top indicator for temperature above 50°C even when switched off.
- ▶ Inclusive PT 100 temperature sensors probe.
- ▶ Digital setup of RPM with independent display.
- ▶ Digital setup of time with independent display.
- ▶ Count-up indication of minutes and hours
- ▶ Audible alarm at time cycle end for safety and ease of unsupervised operation.
- ▶ Error code display for failures.



Item Code	Volt	Hz	Watts	Top Plate
900.DNDG.01	230	50	650	SS Ceramic Coated
900.DNDG.02	115	60	650	SS Ceramic Coated

## 900.DNDG.01

### Including Accessories

Item Code	Accessories
850.800.01	Rod Stainless Steel length 400 mm, Ø 12 mm
850.800.02	Magnetic Stirring bar 35 mm x 9 mm
850.800.03	Moulded PT 100 sensor probe
850.800.04	Boss head

## Technical Specification

Heating Plate Material	Ceramic Coated Stainless Steel
Dimension of Heating Plate	Ø 150 mm
Three display windows for	Temp., RPM and Time
Speed Range	50-1500 RPM
Maximum Stirring bar Length	upto 80mm bar (at lower speed)
Temperature Range	Ambient to 350°C Approx.
Adjustable safety cut off	50-400°C
Control accuracy of PT 100	± 1K
Weight of body	273x160x102mm
Dimension of Hot Plate	3.3 kgs
Permissible ambient Temp.	5-40°C
Permissible relative moisture	80%
RS 232 Interface	Yes (For Programming)
IP Class	32

Scan to  
Watch Video &  
Download manual



# Aluminium Alloy/Ø145 Ceramic Coated Top

Magnetic Stirrer with Hotplate - **Digital**



- ▶ Can be operated with **Labs-connect App** over Wifi/USB Controls
- ▶ Aluminium Moulded Body
- ▶ Ceramic coated plate alloy, chemically resistant
- ▶ Even heat distribution.
- ▶ Top plate Ø 145 mm to assist beaker upto 2000 ml & **DAN Logitech** and other brand Adapters.
- ▶ Single multi-turn intelligent knob Operation.
- ▶ High magnetic strength.
- ▶ Digital set up with independent displays.
- ▶ Selection of Celsius or Fahrenheit.
- ▶ Selection of hot plate or probe temperature control.
- ▶ Settable safety cut-off for maximum temperature limit for top plate or probe.
- ▶ Installed with double PT sensors for safety & fail safe operating mechanism.
- ▶ Hot top indicator for temperature above 50°C even when switched off.
- ▶ Inclusive PT 100/PT 1000 temperature sensors probe.
- ▶ Digital setup of RPM with independent display.
- ▶ Digital setup of time with independent display.
- ▶ Count-up indication of minutes and hours
- ▶ Audible alarm at time cycle end for safety and ease of unsupervised operation.
- ▶ Error code display for failures.
- ▶ Compatible for use with all major brands top assemblies 1 Cavity, 3 Cavities or Multiple Cavities.

**610.DNDG.01**

## Technical Specification

<b>Heating Plate Material</b>	Aluminium Alloy with Ceramic Coating
<b>Dimension of Heating Plate</b>	Ø 145 mm
<b>Three display windows for</b>	Temp., RPM and Time
<b>Speed Range</b>	50-1500 RPM
<b>Maximum Stirring bar Length</b>	upto 80mm bar (at lower speed)
<b>Temperature Range</b>	Ambient to 350°C
<b>Adjustable safety cut off</b>	50-400°C
<b>Control accuracy of PT 100</b>	± 1K
<b>Weight of body</b>	3.3 kgs
<b>Dimension of Hot Plate</b>	273x160x102mm
<b>Permissible ambient Temp.</b>	5-40°C
<b>Connectivity</b>	WiFi/USB
<b>Permissible relative moisture</b>	80%
<b>RS 232 Interface</b>	Yes (For Programming)
<b>IP Class</b>	32
<b>Power Input</b>	650W

Item Code	Volt	Hz	Watts	Top Plate
<b>610.DNDG.01</b>	230	50	650	Aluminum Ceramic Coated
<b>610.DNDG.02</b>	115	60	650	Aluminum Ceramic Coated

## Including Accessories

Item Code	Accessories
<b>850.800.01</b>	Rod Stainless Steel length 400 mm, Ø 12 mm
<b>850.800.02</b>	Magnetic Stirring bar 35 mm x 9 mm
<b>850.800.03</b>	Moulded PT 100 sensor probe
<b>850.800.04</b>	Boss head

**Accessory** (Aluminum Adapter for Round Bot tom Flasks)

Item Code	Flask Capacity (ml)	Places
<b>610.ADP.00</b>	10 ml	8
<b>610.ADP.01</b>	25 ml	7
<b>610.ADP.02</b>	50 ml	4
<b>610.ADP.03</b>	100 ml	1



Scan to  
Watch Video &  
Download manual



# Glass Ceramic Coated Top-5L

Magnetic Stirrer with Hotplate - **Analog**

**CeraClick-System™**

- ▶ Aluminium Moulded Body
- ▶ Highly scratch and chemical resistant Ceramic Glass Top.
- ▶ Thermal insulation for cool body operation.
- ▶ Digital set up temperature controller with independent display.
- ▶ Inclusive PT 100 temperature sensors probe.
- ▶ Installed with double PT sensors for safety & fail safe operating mechanism.
- ▶ Hot top indicator for temperatures above 50°C even when switched off.
- ▶ Large top plate to assist beaker upto 5000 ml.
- ▶ Selection of Celsius or Fahrenheit.
- ▶ Selection of hot plate or probe temperature.
- ▶ Error code display for failure.
- ▶ Independent display for RPM and Temperature.
- ▶ High Magnetic strength.
- ▶ Single multi-turn intelligent knob operation.
- ▶ DIN connector for external temperature probe.



Item Code	Volt	Hz	Watts
<b>500.DNAG.01</b>	230	50	650
<b>500.DNAG.02</b>	115	60	650

### Including Accessories

Item Code	Accessories
<b>550.500.01</b>	Rod Stainless Steel length 500 mm, Ø 12 mm
<b>550.500.02</b>	Magnetic Stirring bar 25 mm x 8.25 mm
<b>550.500.03</b>	PT 100 sensor probe
<b>550.500.04</b>	Clamp with Boss head

### Extra Accessories

Item Code	Accessories
<b>550.500.05</b>	Glass Ceramic Top plate
<b>550.500.06</b>	Knobs

**500.DNAG.01**

## Technical Specification

Heating Plate Material	Aluminium Alloy with Ceramic Coating
Dimension of Heating Plate	175 mm x 175 mm
Two display windows for	Temperature and RPM
Speed Range	~2000 RPM
Heat Output	1300 W
Temperature Range	Ambient to 550°C
Adjustable safety cut off	580°C
Control accuracy of sensor	± 1K
Weight of body	5.8 kgs
Permissible ambient Temp.	5 - 40°C
Permissible relative moisture	80%
USB Port	Yes (For Programming)
Dimensions of Hot Plate Body	Y378x220x103
IP Class	21

### A ) Innovative Spill away (Patent Pending) :



### B ) Innovative CeraClick-System™ (Patent Pending) : Replacing of Glass Ceramic Plate



Scan to  
Watch Video &  
Download manual





# Stainless Steel Ceramic Coated Top

Hotplate - Analog

- ▶ Aluminium Moulded Construction
- ▶ Easy Temperature control
- ▶ Hot top indicator for temperatures above 50°C
- ▶ Large top plate to assist beakers upto 2000 ml
- ▶ Heat reach Indicator, To ensure you correct temperature of plate surface
- ▶ Temperature Indicator



Item Code	Volt	Hz	Watts	Top Plate
730.DNAG.01	230	50	650	Stainless Steel top with Ceramic Coating
730.DNAG.02	115	60	650	Stainless Steel top with Ceramic Coating

## Technical Specification

Heating Mantle Material	Stainless Steel 304 Grade/Ceramic Coated
Dimension of heating plate	150 Ø
Temperature Range	Ambient to 350°C approx
Dimensions of hot plate body	273x160x102mm
Weight of body	2.0 kgs
Permissible ambient Temperature	5- 40 °C
Permissible relative moisture	80%
IP Class	22

# Stainless Steel Top

Magnetic Stirrer - Analog

- ▶ Aluminium Moulded Construction
- ▶ Easy Stir controls
- ▶ Large top plate to assist beakers upto 2000 ml.
- ▶ Maximum stirring speed upto 1600 RPM.
- ▶ High magnetic strength.
- ▶ Knob for electronic variable speed control with display.
- ▶ Stirring Indicator.
- ▶ Error displays & safety for Stir function built in.



Item Code	Volt	Hz	Watts	Top Plate
720.DNAG.01	230	50	650	Stainless Steel top
720.DNAG.02	115	60	650	Stainless Steel top

## Technical Specification

Operating Voltage	230V AC, 50 Hz
Power	30 Watts $\pm$ 10%
Weight	2.6 Kgs
Dimensions of Top plate	Diameter 150mm
Over all dimensions	273X160X102mm
Fuse internal	1 Amps
Stirring Capacity	10 L
IP Class	22

Scan to  
Watch Video &  
Download manual



# Stainless Steel Hexa Top

Magnetic Stirrer - Analog



- ▶ Aluminium Moulded Construction
- ▶ Easy Stir controls
- ▶ Large top plate to assist beakers upto 5000 ml
- ▶ Maximum stirring speed upto 1600 RPM
- ▶ High magnetic strength
- ▶ Knob for electronic variable speed control with display
- ▶ Stirring Indicator
- ▶ Error displays & safety for Stir function built in

Item Code	Volt	Hz	Watts	Top Plate
725.DNAG.01	230	50	650	Stainless Steel top
725.DNAG.02	115	60	650	Stainless Steel top

## Technical Specification

Operating Voltage	230V AC, 50 Hz
Power	30 Watts $\pm$ 10%
Stirring Capacity	Upto 1600 RPM
Weight	3.0 Kgs
Dimensions of Top plate	190X25mm Octagon shape
Over all dimensions	275 mm X 190mm X 92mm
Fuse internal	1 Amps
Stirring Capacity	20000ml
IP Class	22

Scan to  
Watch Video &  
Download manual





# 3 Position

Magnetic Stirrer with Hotplate



- ▶ Three independently controlled stirring/heating positions
- ▶ Powerful magnets for strong magnetic coupling
- ▶ Easy to operate temperature & Stir controls
- ▶ Installed with double PT sensors for safety & fail safe operating mechanism.
- ▶ Hot top indicator for temperatures above 50°C for each position
- ▶ Electronic variable speed control with Knob
- ▶ Electronic variable temperature control with knob
- ▶ Temperature reached Indicator, To ensure correct temperature of plate surface
- ▶ Stirring & temperature indicators
- ▶ Inbuilt error indicators for heat & Stir function



Item Code	Volt	Hz	Watts	Top Plate
<b>716.DNAG.01</b>	230	50	(450x3) 1350	Stainless Steel
<b>716.DNAG.02</b>	115	60	(450x3) 1350	Stainless Steel

### Included Accessories

Item Code	Accessories
<b>1500.150.02</b>	(5) magnetic Stirring bar 25 mm x 9 mm

## Technical Specification

Heating plate material	SS ceramic coated
Dimension of heating plate	150 Ø RPM
Volume cap.	20 L each station
Speed range	1600 RPM
Stirring position	3
Maximum stirring range	Can use upto 80mm bar Lower speed
Maximum plate temperature	350 °C
Overall dimensions (mm)	505 x 246 x 195 (LxWxH)
Plate dimensions (mm)	504 x 175 x 30 (LxWxH)
Net weight (kg)	7.0 kg (Approx.)
Permissible ambient temp.	5-40 °C
Permissible relative humidity	80%
IP Class	21

Scan to  
Watch Video &  
Download manual



# 5 Position Digital

Magnetic Stirrer with Heating

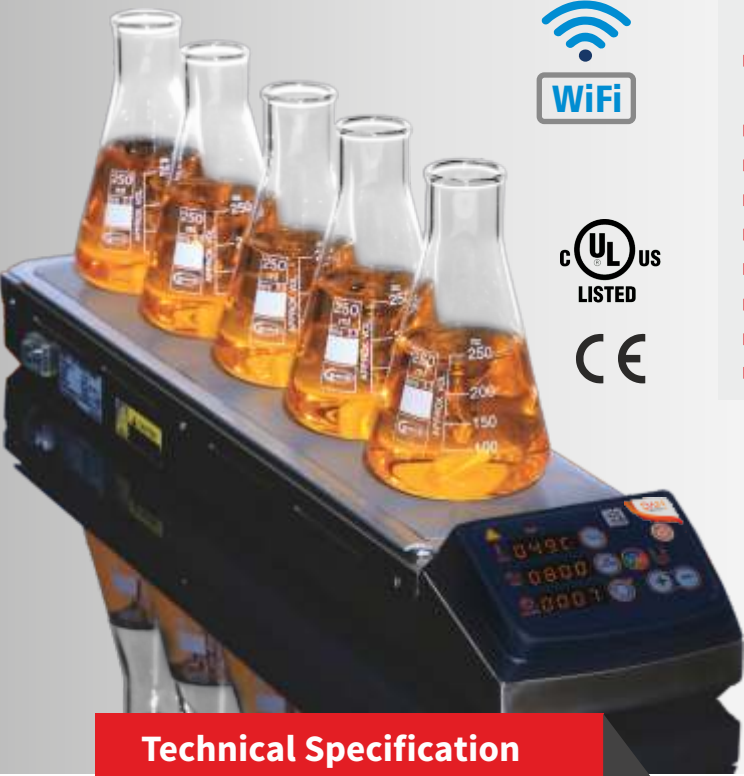

WiFi



- ▶ Metallic Construction
- ▶ Designed for synchronous heating and stirring
- ▶ Suitable for continuous operation
- ▶ Silicone surface for anti-skid.
- ▶ The magnetic coil motorless technology provides noiseless and consistent stirring on all positions
- ▶ Homogeneous temperature distribution across the heating plate
- ▶ Hot top warning indication
- ▶ Timer function
- ▶ Six mode preset selection anticlockwise, t-30, 60, 120 & 240
- ▶ Constant stirring speeds even with viscosity changes
- ▶ SPC-mode for a low self-warming of the surface
- ▶ Error code display
- ▶ Also available with WIFI (411.DNWDG)
- ▶ Power selection mode
- ▶ Can be operated with **Labs-connect App** over Wifi/USB Controls

Item Code	Volt	Hz	Watts
411.DNDG.01	230	50	220
411.DNDG.02	115	60	220

### WiFi Model

Item Code	Volt	Hz	Watts
411.DNWDG.01	230	50	220
411.DNWDG.02	115	60	220

## Technical Specification

Set-up plate material	Silicone and Aluminium
Number of stirring positions	5
Stirring position distance	90 mm
Speed range	0 - 1000 rpm
Speed control	10 RPM Steps
Stirring quantity max. per stirring position (H2O)	400 ml
Stirring bar length min.	25mm
Stirring bar length max.	30mm
Heating temperature range	Room temp. - 120°C
Control display	LED
Input Type	Touch Key
Adjustable safety circuit min.	50°C
Adjustable safety circuit max.	130°C
Timer range	00:01 to 99:59 [HH: MM]
Set-up plate dimensions	514x122mm
Dimensions (W x H x D)	600 x 120 x 80 mm
Weight	4.5 (Approx.)
Permissible ambient temperature	5 - 40 °C
Permissible relative humidity	80 %
Protection class according to DIN EN 60529	IP40

### Included Accessories

Item Code	Accessories
1500.150.02	(5) magnetic Stirring bar 25 mm x 9 mm

Scan to  
Watch Video &  
Download manual



# 5 Position

Magnetic Stirrer with Heating



- ▶ Metallic Construction
- ▶ Simultaneously operating stirrers
- ▶ Consistent heating and stirring
- ▶ Silicone surface for anti-skid
- ▶ Homogeneous temperature distribution across the heating plate
- ▶ Narrow foot print for space saving
- ▶ High magnetic strength
- ▶ Electronic variable speed control with Knob upto 1200 RPM
- ▶ Knob for electronic variable temperature adjustment
- ▶ BLDC motor for long life & maintenance free operation

Item Code	Volt	Hz	Watts
<b>410.DNAG.01</b>	230	50	220
<b>410.DNAG.02</b>	115	60	220

### Included Accessories

Item Code	Accessories
<b>1500.150.02</b>	(5) magnetic Stirring bar 25 mm x 9 mm

## Technical Specification

Set-up plate material	Silicone and Aluminium
Number of stirring positions	5
Stirring position distance	90 mm
Speed range	0 - 1000 rpm
Speed control	-
Stirring quantity max. per stirring position (H2O)	400 ml
Stirring bar length min.	25mm
Stirring bar length max.	30mm
Heating temperature range	Room temp. - 120°C
Control display	-
Input Type	Knob
Adjustable safety circuit min.	-
Adjustable safety circuit max.	-
Timer range	-
Set-up plate dimensions	470x128mm
Dimensions (W x H x D)	600 x 120 x 80 mm
Weight	4.5 (Approx.)
Permissible ambient temperature	5 - 40 °C
Permissible relative humidity	80 %
Protection class according to DIN EN 60529	IP42

Scan to  
Watch Video &  
Download manual



# 15 Position

Magnetic Stirrer with Heating - Digital



- ▶ Metallic Construction
- ▶ Designed for synchronous heating and stirring
- ▶ Suitable for continuous operation
- ▶ Silicone surface for anti-skid.
- ▶ The magnetic coil technology motorless provides noiseless and consistent stirring on all positions
- ▶ Homogeneous temperature distribution across the heating plate
- ▶ Hot top warning indication
- ▶ Timer function
- ▶ Six mode preset selection anticlockwise, t-30, 60, 120 & 240
- ▶ Also available with WIFI (415.DNWDG)
- ▶ Power selection mode
- ▶ Constant stirring speeds even with viscosity changes
- ▶ SPC-mode for a low self-warming of the surface
- ▶ Error code display
- ▶ Can be operated with **Labs-connect App** over Wifi/USB Controls

Item Code	Volt	Hz	Watts
<b>415.DNDG.01</b>	230	50	220
<b>415.DNDG.02</b>	115	60	220

### WiFi Model

Item Code	Volt	Hz	Watts
<b>415.DNWDG.01</b>	230	50	220
<b>415.DNWDG.02</b>	115	60	220

## Technical Specification

Set-up plate material	Silicone and Aluminium
Number of stirring positions	15
Stirring position distance	90 mm
Speed range	0 - 1000 rpm
Speed control	10 RPM Steps
Stirring quantity max. per stirring position (H2O)	400 ml
Stirring bar length min.	25mm
Stirring bar length max.	30mm
Heating temperature range	Room temp. - 120°C
Control display	LED
Input Type	Touch Key
Adjustable safety circuit min.	50°C
Adjustable safety circuit max.	130°C
Timer range	00:01 to 99:59 [HH: MM]
Set-up plate dimensions	274x504mm
Dimensions (W x H x D)	281 x 81 x 609 mm
Weight	11 Kg (Approx.)
Permissible ambient temperature	5 - 40 °C
Permissible relative humidity	80 %
Protection class according to DIN EN 60529	IP40

### Included Accessories

Item Code	Accessories
<b>1500.150.02</b>	(5) magnetic Stirring bar 25 mm x 9 mm

Scan to  
Watch Video &  
Download manual



# Heating Mantle

Analog

## BlackDiamond™



- ▶ Designed for advanced Laboratory usage
- ▶ SS & Aluminium Construction
- ▶ For Round Bottomed Flasks as per DIN - 12347
- ▶ Glass fibre yarn knitted mantle provides uniform heating to flask
- ▶ Predictable electronic power regulator
- ▶ Provision to attach accessories
- ▶ Innovative spill collect system enables collection of spillage in case of breakage of flasks
- ▶ Fewer parts give longer life
- ▶ Easy to use and maintain

Item Code (230V, 50Hz)	Item Code (115V, 60Hz)	Cap. (ml)	Watts	Dimension (WxDxH)
1220.DNEU.01	1220.DNUS.01	100*	200	167x240x182
1220.DNEU.02	1220.DNUS.02	250*	200	167x240x182
1220.DNEU.03	1220.DNUS.03	500*	250	217x287x203
1220.DNEU.04	1220.DNUS.04	1000*	350	217x287x203
1220.DNEU.05	1220.DNUS.05	2000*	500	309x390x262
1220.DNEU.06	1220.DNUS.06	3000*	500	309x390x262
1220.DNEU.08	1220.DNUS.08	5000	650	309x390x262
1220.DNEU.09	1220.DNUS.09	6000	650	-
1220.DNEU.10	1220.DNUS.10	10000	1250	-
1220.DNEU.11	1220.DNUS.11	20000	1850	-

### Optional Accessories

Item Code	Accessories
850.800.01	SS Rod (542mm, Ø 9mm) Bosshead



\*For lower volumes only.

The spill protect feature is provided in models upto 2000ml.

Scan to  
Watch Video &  
Download manual



## Technical Specification

Heating Mantle Body	Metallic, SS & Aluminium construction
Heating Mantle Material	Glass Fibre Yarn
Mantle Capacity	To hold standard Round Bottom Flasks upto 20000ml (as per DIN 12347)
Temperature Range	~400°C
Control Accuracy	10%
Heating Control	Variable
Weight	1.7 Kgs
Permissible Ambient Temperature	5- 40 °C
Permissible relative moisture	80%
IP Class	10



# Heating Mantle

Digital

## BlackDiamond™

**DAN**  
LOGITECH



- ▶ Designed for advanced Laboratory usage
- ▶ Control the temperature of subject in flask using probe
- ▶ Temperature control with digital display
- ▶ Celsius/Fahrenheit selection
- ▶ Mantle/Probe selection
- ▶ SS & Aluminium Construction
- ▶ For Round Bottomed Flasks as per DIN - 12347
- ▶ Glass fibre yarn knitted mantle provides uniform heating to flasks
- ▶ Innovative spill collect system enables collection of spillage in case of breakage of flasks
- ▶ Fewer parts give longer life
- ▶ Easy to use and maintains
- ▶ Provision to attach accessories

Item Code (230V, 50Hz)	Item Code (115V, 60Hz)	Cap. (ml)	Watts	Dimension (WxDxH)
1222.DNEU.01	1222.DNUS.01	100*	200	167x240x182
1222.DNEU.02	1222.DNUS.02	250*	200	167x240x182
1222.DNEU.03	1222.DNUS.03	500*	200	217x287x203
1222.DNEU.04	1222.DNUS.04	1000*	250	217x287x203
1222.DNEU.05	1222.DNUS.05	2000*	350	309x390x262
1222.DNEU.06	1222.DNUS.06	3000*	500	309x390x262
1222.DNEU.08	1222.DNUS.08	5000*	650	309x390x262
1222.DNEU.09	1222.DNUS.09	6000	650	-
1222.DNEU.10	1222.DNUS.10	10000	1250	-
1222.DNEU.11	1222.DNUS.11	20000	1850	-

### Technical Specification

Heating Mantle Body	Metallic, SS & Aluminium construction
Heating Mantle Material	Glass Fibre Yarn
Mantle Capacity	To hold standard Round Bottom Flasks upto 5000ml
Heating Control	Microprocessor based PID
Temperature Range	~400°C
Control Accuracy	10%
Weight	2.4 Kgs
Permissible Ambient Temperature	5- 40 °C
Permissible relative moisture	80%
IP Class	10



Spill collect system

\*For lower volumes only.

The spill protect feature is provided in models upto 2000ml.

Scan to  
Watch Video &  
Download manual





# Digital Heating Mantle

with Stirrer

## BlackDiamond™



- ▶ Designed for advanced Laboratory usage
- ▶ Control the temperature of subject in flask using probe
- ▶ Temperature control with digital display
- ▶ Celsius/Fahrenheit selection
- ▶ Mantle/Probe selection
- ▶ SS & Aluminium Construction
- ▶ For Round Bottomed Flasks as per DIN - 12347
- ▶ Glass fibre yarn knitted mantle provides uniform heating to flasks
- ▶ Innovative spill collect system enables collection of spillage in case of breakage of flasks
- ▶ Fewer parts give longer life
- ▶ Easy to use and maintains
- ▶ Provision to attach accessories
- ▶ Electronic stir speed control

Item Code 230 Volts/50Hz	Item Code 115 Volts/60Hz	Cap. (ml)	Watts	Dimension
<b>1221.DNEU.01</b>	<b>1221.DNUS.01</b>	100	220	167x240x182
<b>1221.DNEU.02</b>	<b>1221.DNUS.02</b>	250	220	167x240x182
<b>1221.DNEU.03</b>	<b>1221.DNUS.03</b>	500	270	217x287x203
<b>1221.DNEU.04</b>	<b>1221.DNUS.04</b>	1000	370	217x287x203
<b>1221.DNEU.05</b>	<b>1221.DNUS.05</b>	2000	520	309x390x262
<b>1221.DNEU.06</b>	<b>1221.DNUS.06</b>	3000	520	309x390x262
<b>1221.DNEU.08</b>	<b>1221.DNUS.08</b>	5000	670	309x390x262

## Technical Specification

<b>Heating Mantle Body</b>	Made of SS & Aluminium
<b>Heating Mantle Material</b>	Glass Fibre Yarn
<b>Mantle Capacity</b>	To hold standard Round Bottom Flasks upto 5000ml
<b>Variable Speed Range</b>	Approx. upto 800 RPM
<b>Temperature Range</b>	400°C
<b>Control Accuracy</b>	10%
<b>Heating Control</b>	Digital
<b>Stir Control</b>	Electronic
<b>Dimension</b>	168x240x182 (WxDxH)
<b>Permissible Ambient Temperature</b>	5- 40 °C
<b>Permissible relative moisture</b>	80%
<b>IP Class</b>	10

### Included Accessories

Item Code	Accessories
<b>1500.150.02</b>	Magnetic Stirring bar 25 mm x 9 mm
<b>850.800.01</b>	SS Rod (400mm, Ø 12mm)
<b>850.800.03</b>	Moulded PT 100 Sensor probe Bosshead



\*For lower volumes only.

The spill protect feature is provided in models upto 2000ml.

Scan to  
Watch Video &  
Download manual



# Heating Mantle

with Stirrer Analog

## BlackDiamond™

With  
**STIRRER**



- ▶ Designed for advanced Laboratory usage
- ▶ SS & Aluminium Construction
- ▶ For Round Bottomed Flasks as per DIN - 12347
- ▶ Glass fibre yarn knitted mantle provides uniform heating to flasks
- ▶ Predictable electronic power regulator
- ▶ Knob for stir speed control upto 800 RPM
- ▶ Innovative spill collect system enables collection of spillage in case of breakage of flasks
- ▶ Fewer parts give longer life
- ▶ Easy to use and maintain
- ▶ Provision to attach accessories

Item Code 230 Volts/50Hz	Item Code 115 Volts/60Hz	Cap. (ml)	Watts	Dimension
<b>1223.DNEU.01</b>	<b>1223.DNUS.01</b>	100	220	167x240x182
<b>1223.DNEU.02</b>	<b>1223.DNUS.02</b>	250	220	167x240x182
<b>1223.DNEU.03</b>	<b>1223.DNUS.03</b>	500	270	217x287x203
<b>1223.DNEU.04</b>	<b>1223.DNUS.04</b>	1000	370	217x287x203
<b>1223.DNEU.05</b>	<b>1223.DNUS.05</b>	2000	520	309x390x262
<b>1223.DNEU.06</b>	<b>1223.DNUS.06</b>	3000	520	309x390x262
<b>1223.DNEU.08</b>	<b>1223.DNUS.08</b>	5000	670	309x390x262

### Technical Specification

<b>Heating Mantle Body</b>	Metallic, SS & Aluminium construction
<b>Heating Mantle Material</b>	Glass Fibre Yarn
<b>Mantle Capacity</b>	To hold standard Round Bottom Flasks upto 20000ml
<b>Temperature Range</b>	~400°C
<b>Control Accuracy</b>	10%
<b>Variable speed range</b>	~800 RPM
<b>Weight</b>	2.5 Kgs
<b>Permissible Ambient Temperature</b>	5- 40 °C
<b>Permissible relative moisture</b>	80%
<b>IP Class</b>	10

### Included Accessories

Item Code	Accessories
<b>1500.150.02</b>	Magnetic Stirring bar 25 mm x 9 mm
<b>850.800.01</b>	SS Rod (400mm, Ø 12mm)
<b>850.800.03</b>	Moulded PT 100 Sensor probe Bosshead



**Spill collect system**

\*For lower volumes only.

**The spill protect feature is provided  
in models upto 2000ml.**

Scan to  
Watch Video &  
Download manual



# Advanced Heating Mantle

with Stirrer - Digital

## BlackDiamond™ PRO



With  
**STIRRER**



- ▶ Designed for advanced Laboratory usage
- ▶ SS & Aluminium Construction
- ▶ For Round Bottomed Flasks as per DIN - 12347
- ▶ Single shuffle knob to set temperature, stir speed & time of activity
- ▶ Independent keys for C/F selection & mantle/probe selection
- ▶ Accurately Control liquid temp. with included PT 100 sensor probe
- ▶ Glass fibre yarn knitted mantle provides uniform heating to flasks
- ▶ Innovative spill collect system enables collection of spillage in cases of breakage of flasks

Item Code 230 Volts/50Hz	Item Code 115 Volts/60Hz	Cap. (ml)	Watts	Dimension
<b>1225.DNEU.01</b>	<b>1225.DNUS.01</b>	100	220	240x315x203
<b>1225.DNEU.02</b>	<b>1225.DNUS.02</b>	250	220	240x315x203
<b>1225.DNEU.03</b>	<b>1225.DNUS.03</b>	500	270	240x315x203
<b>1225.DNEU.04</b>	<b>1225.DNUS.04</b>	1000	370	240x315x203
<b>1225.DNEU.05</b>	<b>1225.DNUS.05</b>	2000	520	309x390x262
<b>1225.DNEU.06</b>	<b>1225.DNUS.06</b>	3000	520	309x390x262
<b>1225.DNEU.08</b>	<b>1225.DNUS.08</b>	5000	670	309x390x262

### Included Accessories

Item Code	Accessories
<b>1500.150.01</b>	Magnetic Stirring bar 20mmx8mm (For 100-1000ml)
<b>1500.150.02</b>	Magnetic Stirring bar 25mmx9mm (For 2000-5000ml)
<b>850.800.01</b>	SS Rod (542mm, Ø 9mm)
<b>850.800.03</b>	Moulded PT 100 Sensor probe Bosshead

### Technical Specification

<b>Operating voltage</b>	230VAC/50Hz
<b>Display type</b>	LED segment
<b>Temperature range</b>	~400 °C
<b>Temperature step size</b>	1°C
<b>Temperature resolution</b>	±1°C
<b>Stir range</b>	50 to 800RPM
<b>Stir step size</b>	50RPM
<b>Weight</b>	3.2 Kgs
<b>Timer range</b>	00:01 to 99:59
<b>Timer step size</b>	00:01
<b>External probe connection</b>	DIN Port
<b>IP Class</b>	10



Spill collect system

The spill protect feature is provided in models up to 2000ml.

Scan to  
Watch Video &  
Download manual



# Heating Mantle Combined Unit

with Stirrer 3 Position - Analog

## BlackDiamond™



- ▶ Heating Mantle Combined unit made of steel
- ▶ Variable knob for heat power control with on/off.
- ▶ Variable Knob for stir speed control with on/off.
- ▶ Mantle knitted with glass fibre yarn
- ▶ Provides uniform heating to flasks
- ▶ For Round Bottomed Flasks as per DIN - 12347
- ▶ Easy maintenance
- ▶ Single position also available with Metallic Stand 1600.EU

Item Code	Capacity (ml)	Volts	Watts	No. of Position of Regulator
<b>2300.DNEU.01</b>	100	230	510	3/3
<b>2300.DNEU.02</b>	250	230	510	3/3
<b>2300.DNEU.03</b>	500	230	660	3/3

Item Code	Capacity (ml)	Volts	Watts	No. of Position of Regulator
<b>2300.DNUS.01</b>	100	115	510	3/3
<b>2300.DNUS.02</b>	250	115	510	3/3
<b>2300.DNUS.03</b>	500	115	660	3/3

### Included Accessories

Item Code	Accessories
<b>2000.200.01</b>	Vertical Rod Stainless Steel length 542mm, Ø 9.8 mm
<b>2000.200.02</b>	Horizontal Rod Stainless Steel length 972mm, Ø 9.8 mm
<b>2000.200.03</b>	Boss Head
<b>2000.200.04</b>	Clamp

## Technical Specification

<b>Heating Mantle Body</b>	Made of Mild Steel
<b>Heating Mantle Material</b>	Glass Fibre Yarn
<b>Mantle Capacity</b>	To hold standard Round Bottom Flasks upto 500ml
<b>Valuable Stirring speed</b>	750 RPM
<b>Temperature Range</b>	Approx. 400°C
<b>Heating Control</b>	Electronic power regulator
<b>Stir Control</b>	Electric regulator
<b>Dimension</b>	495 x 246 x 200
<b>Permissible Ambient Temperature</b>	5- 40 °C
<b>Permissible relative moisture</b>	80%
<b>IP Class</b>	10

## Single Soxhlet Extraction with Stirrer

Extraction unit metal stand with heating mantle stirrer

Model No. (230V, 50 Hz)	Model No. (115V, 60 Hz)	Capacity ml (A)	Extractor Socket (B)	Extractor Cone (C)	Flask Cap.	Condenser Type	Watts	No. of Position of regulator
<b>1600.DNEU.01</b>	<b>1600.DNUS.01</b>	100	40/38, 45/40	24/29, 29/32	150 & 250	Allihin	170	1/1
<b>1600.DNEU.02</b>	<b>1600.DNUS.02</b>	250	45/40	29/32	500	Allihin	170	1/1
<b>1600.DNEU.03</b>	<b>1600.DNUS.03</b>	500	60/46	29/32	1000	Allihin	220	1/1

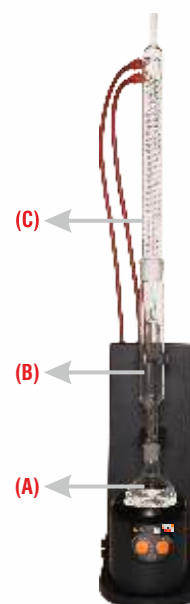

Scan to Watch Video & Download manual



# Heating Mantle Combined Unit

with Stirrer 6 Position - Analog

## BlackDiamond™

**New Design**



- ▶ Heating Mantle Combined unit made of M. steel
- ▶ Variable knob for heat power control with on/off.
- ▶ Variable Knob for stir speed control with on/off.
- ▶ Mantle knitted with glass fibre yarn
- ▶ Provides uniform heating to flasks
- ▶ For Round Bottomed Flasks as per DIN - 12347
- ▶ Easy maintenance
- ▶ Single position also available with Metallic Stand 1100.EU

Item Code 230 Volts/50Hz	Item Code 115 Volts/60Hz	Capacity (ml)	Watts	No. of Position of Regulator
<b>2600.DNEU.01</b>	<b>2600.DNUS.01</b>	100	180	3/3
<b>2600.DNEU.02</b>	<b>2600.DNUS.02</b>	250	450	3/3
<b>2600.DNEU.03</b>	<b>2600.DNUS.03</b>	500	600	3/3
<b>2600.DNEU.06</b>	<b>2600.DNUS.06</b>	100	360	6/6
<b>2600.DNEU.07</b>	<b>2600.DNUS.07</b>	250	900	6/6
<b>2600.DNEU.08</b>	<b>2600.DNUS.08</b>	500	1200	6/6

### Included Accessories

Item Code	Accessories
<b>2000.200.01</b>	Vertical Rod Stainless Steel length 542mm, Ø 9.8 mm
<b>2000.200.02</b>	Horizontal Rod Stainless Steel length 972mm, Ø 9.8 mm
<b>2000.200.03</b>	Boss Head
<b>2000.200.04</b>	Clamp

## Technical Specification

<b>Heating Mantle Body</b>	Made of Mild Steel
<b>Heating Mantle Material</b>	Glass Fibre Yarn
<b>Mantle Capacity</b>	To hold standard Round Bottom Flasks upto 500ml
<b>Valuable Stirring speed</b>	750 RPM
<b>Temperature Range</b>	Approx. 400°C
<b>Heating Control</b>	Electronic power regulator
<b>Stir Control</b>	Electric regulator
<b>Dimension</b>	495 x 246 x 200
<b>Permissible Ambient Temperature</b>	5- 40 °C
<b>Permissible relative moisture</b>	80%
<b>IP Class</b>	10

## Single Soxhlet Extraction with Stirrer

Extraction unit metal stand with heating mantle stirrer

Model No. (230V, 50 Hz)	Model No. (115V, 60 Hz)	Capacity ml (A)	Extractor Socket (B)	Extractor Cone (C)	Flask Cap.	Condenser Type	Watts	No. of Position of regulator
<b>1600.DNEU.01</b>	<b>1600.DNUS.01</b>	100	40/38, 45/40	24/29, 29/32	150 & 250	Allihin	170	1/1
<b>1600.DNEU.02</b>	<b>1600.DNUS.02</b>	250	45/40	29/32	500	Allihin	170	1/1
<b>1600.DNEU.03</b>	<b>1600.DNUS.03</b>	500	60/46	29/32	1000	Allihin	220	1/1

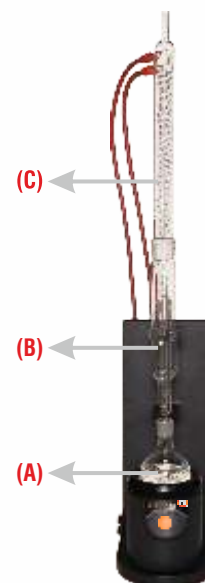

Scan to  
Watch Video &  
Download manual





# Digital Overhead Stirrer-60L

(With WiFi)



- ▶ Independent LED display for RPM, Timer & Temperature
- ▶ User Friendly
- ▶ Brushless DC motor
- ▶ Liquid cannot reach internal components due to front safeguard
- ▶ Audible alarm for error conditions
- ▶ Effective stirring provides clock wise & anti clock wise stirring modes
- ▶ Prominent used in chemical synthesis, pharmaceuticals, physical & chemical analysis, petrochemical, cosmetics, health products, foods, biotechnology & so on
- ▶ Can be operated with **Labs-connect App** over Wifi/USB Controls

**CAPACITY :**  
10-40 Ltr.  
& 40-60 Ltr.

## Technical Specification

Model No.	6050T.DNEU.01	6100T.DNEU.01
Speed Range	50-1500RPM	50-3000RPM
Max. Torque	80N.cm	65N.cm
Max. Viscosity	10000 mPass	6000 mPass
Max. Stirring	40-60L	10-40L
Timing Range	1min - 99:59min	1min - 99:59min
T-On Time	5 - 999 Sec	5 - 999 Sec
T-Off Time	0, 5 - 999 Sec	0, 5 - 999 Sec
Wifi Control	Yes	Yes
Temperature Measurement	Yes	Yes
Stirring Shaft Extension Feature	Yes	Yes
Stirring Modes	Yes	Yes
Motor Type	BLDC	BLDC
Operating Voltage	24VDC	24VDC
Supply Voltage	100 - 240Vac, 50/60Hz	100 - 240Vac, 50/60Hz
Power	130	130
Dimension	90x240x220mm	90x240x220mm
Net Weight	12kg	12kg

## Optional Accessories

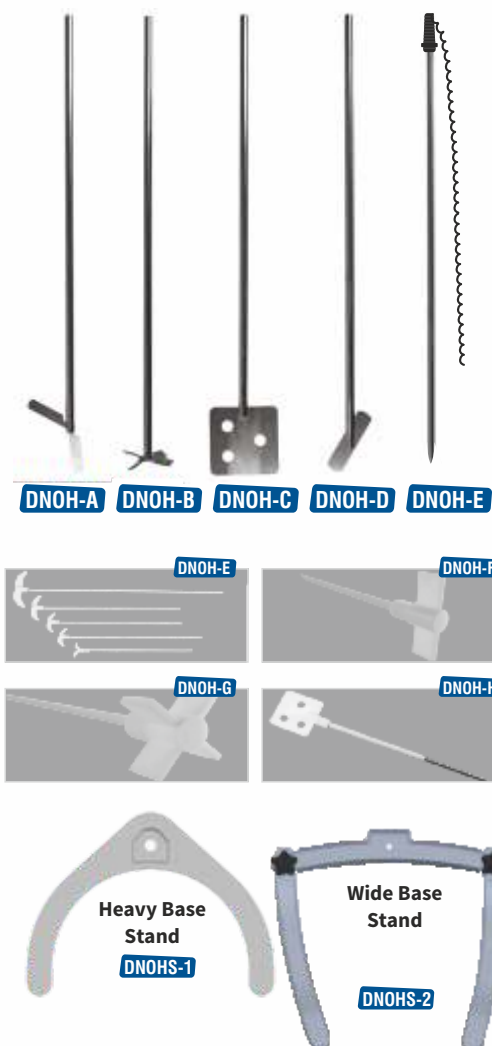

Scan to  
Watch Video &  
Download manual





# Digital Overhead Stirrer-40L

(Without WiFi)



- ▶ Independent LED display for RPM & Timer
- ▶ User Friendly
- ▶ Brushless DC motor
- ▶ Liquid cannot reach internal components due to front safeguard
- ▶ Audible alarm for error conditions
- ▶ Effective stirring provides clock wise & anti clock wise stirring modes
- ▶ Prominent used in chemical synthesis, pharmaceuticals, physical & chemical analysis, petrochemical, cosmetics, health products, foods, biotechnology & so on

## CAPACITY :

10-40 Ltr.  
& 40-60 Ltr.

## Technical Specification

Model No.	6050.DNEU.01	6100.DNEU.01
Speed Range	50-1500RPM	50-3000RPM
Max. Torque	80N.cm	65N.cm
Max. Viscosity	10000 mPass	6000 mPass
Max. Stirring	40-60L	10-40L
Timing Range	1min - 99:59min	1min - 99:59min
T-On Time	5 - 999 Sec	5 - 999 Sec
T-Off Time	0, 5 - 999 Sec	0, 5 - 999 Sec
Wifi Control	No	No
Temperatue Measurement	No	No
Stirring Shaft Extension Feature	Yes	Yes
Stirring Modes	Yes	Yes
Motor Type	BLDC	BLDC
Operating Voltage	24VDC	24VDC
Supply Voltage	100 - 240Vac, 50/60Hz	100 - 240Vac, 50/60Hz
Power	130	130
Dimension	90x240x220mm	90x240x220mm
Net Weight	12kg	12kg

### Optional Accessories



Scan to  
Watch Video &  
Download manual





- ▶ High IP protection class (IP 65)
- ▶ Set-up plate and casing made from chemically resistant materials
- ▶ Slip-proof, safe stand
- ▶ Max. stirring quantity (H<sub>2</sub>O): 800 ml
- ▶ Speed range: 15 - 1500 rpm

Item Code	Volt	Hz	Watts	Price
<b>430.DNDG.01</b>	230	50	130	11500
<b>430.DNDG.02</b>	115	60	130	11500

Ultra-flat compact magnetic stirrer, guaranteed with modern magnet coil technology. Wear-free drive with no moving parts. To ensure better mixing, the lab disc can reverse direction of rotation automatically every 30 seconds.

### Technical Specification

<b>Number of stirring positions</b>	1
<b>Stirring quantity max. per stirring position (H<sub>2</sub>O)</b>	0.8 l
<b>Motor Rating output</b>	3 W
<b>Speed Range</b>	15 - 1500 rpm
<b>Stirring Bar Length Max.</b>	25 mm
<b>Set-up Plate Material</b>	Polyester
<b>Set-up plate dimensions</b>	Ø 100 mm
<b>Dimensions (W x H x D)</b>	117 x 12 x 180 mm
<b>Weight</b>	0.3 kg
<b>Permissible Ambient Temperature</b>	5 - 40 °C
<b>Permissible Relative Humidity</b>	0 %
<b>Voltage</b>	100 - 240 V
<b>Frequency</b>	50/60 Hz
<b>Power input</b>	5 W
<b>IP Class</b>	65

Scan to  
Watch Video &  
Download manual



# Magnetic Stirrer-50L

Digital



- ▶ SS 304 construction
- ▶ Easy Stir controls
- ▶ Large surface to assist large vessels upto 20, 30 40 & 50L
- ▶ High magnetic strength
- ▶ Electronic variable speed control
- ▶ Independent display for RPM & Time
- ▶ Choice of 7 modes of rotation
- ▶ Power adjust feature
- ▶ Optional remote

Item Code	Volt	Hz	Watts	Cap. (Ltr.)	Grade
420.DNDG.01	230	50	650	20	SS 304
440.DNDG.01	230	50	650	40	SS 304
450.DNDG.01	230	50	650	50	SS 304
4100.DNDG.01	230	50	650	100	SS 304
4200.DNDG.01	230	50	650	200	SS 304

## Technical Specification

<b>Plate Material</b>	Stainless Steel 304 Grade
<b>Speed range</b>	2000 RPM
<b>Maximum stirring bar Length</b>	Can use upto 100 mm bar
<b>Dimensions of body</b>	370X420X110mm
<b>Permissible ambient Temperature</b>	5- 40 °C
<b>Permissible relative moisture</b>	80%
<b>IP Class</b>	62



STIR  
2000 RPM



STIR MODES  
SELECTION



INFRARED  
SENSOR



OPTIONAL  
REMOTE



7 MODE  
SELECTION



POWER  
SELECT



# Roller Mixer

Rolling & Mixing

- ▶ Efficient Rolling and swinging motion for mixing blood samples, Liquid solid suspension & various substance
- ▶ Digital set-up for RPM & time with independent LED display
- ▶ Maximum stirring speed upto 80RPM
- ▶ Seven rollers with small foot print & easy cleaning
- ▶ Brushless DC motor
- ▶ Compatible for use with wide range of tubes
- ▶ Used for prevention of blood coagulation and immune precipitation etc



Item Code	Volt	Hz	Watts
<b>4000.DNEU.01</b>	230	50	50
<b>4000.DNUS.01</b>	115	60	50

## Technical Specification

<b>Mixer Body Material</b>	Plastic
<b>Operation Mode</b>	Rolling & Swinging
<b>Amplitude</b>	24mm
<b>Roller Quantity</b>	7
<b>Speed Range</b>	10-80RPM
<b>Speed Unit</b>	1RPM
<b>Roller Length</b>	280mm
<b>Motor</b>	Brushless DC motor
<b>Dimension (DxWxH)</b>	500 x 280 x 120mm
<b>Max. Capacity</b>	4kgs
<b>Weight of Body</b>	6kg
<b>Voltage</b>	AC100-240 50-60Hz
<b>Power</b>	50W



**SPEED RANGE**  
**10 to 80 RPM**



**BRUSHLESS**  
**DC motor**



**TIMER (WITH COUNTDOWN)**  
**upto 99:59min**



**POWER**  
**50W**

Scan to  
Watch Video &  
Download manual



# Mini Centrifuge

## Dual Speed



- ▶ High tech motor causes low working noise
- ▶ Produces low vibration with advanced shock absorber
- ▶ Compact design and can carry higher volume of 2 ml x 8 places
- ▶ Easy replacement of rotor
- ▶ Maximum relative centrifugal force upto 3260G
- ▶ Fast Stopping in 15 seconds with cover breaking time of 3 seconds.
- ▶ Spatial rotation for 360° are shape, low windage resistance with slow temperature increase
- ▶ Filtration & voltage regulation function makes smooth running of unit & causes low rotation difference.

Item Code	Volt	Hz	Watts
<b>5000.DNEU.01</b>	230	50	130
<b>5000.DNEU.02</b>	115	60	130

### Included Accessories

Item Code	Accessories
<b>5000.303.01</b>	2ml x 8, 0.5ml, 0.2ml adapter each 8 pcs
<b>5000.303.02</b>	2ml x 8, 8 x 0.2ml tubes strip x 2 rows

## Technical Specification

<b>Body Material</b>	Main Frame : ABS, Cover : PC, Adapter : PP, Absorber : NBR, Roller : ABS
<b>Speed Range</b>	4000 TO 7200 RPM ( $\pm 20\%$ )
<b>RCF</b>	810~3260xg
<b>Rotor types</b>	Rotor, 2ml x 8 and 0.2ml x 8, 0.2ml x 8 tubes strip x 2 rows
<b>Max. Capacity</b>	2ml x 8
<b>Dimension (WxDxH)</b>	174x157x130mm
<b>Speed Control type</b>	Constant speed
<b>Driving Speed</b>	Direct drive
<b>Brake System</b>	Dynamic
<b>Acceleration Time</b>	90% speed in 5 seconds
<b>Deceleration Time</b>	Cover closed within 15 seconds, cover opens within 6 seconds



**SPEED BUTTON**  
4000 to 7200 RPM



**CONSTANT SPEED**  
90% in 5 sec



**BODY DESIGN**  
Shockfree



**CENTRIFUGAL FORCE**  
3260 G



**DYNAMIC**  
Brake System

Scan to  
Watch Video &  
Download manual





- ▶ Compact design
- ▶ Application in molecular biology, immunology, chemistry lab
- ▶ Built in DC brushless motor
- ▶ Microprocessor controlled
- ▶ User-Friendly
- ▶ Silent and stable operation
- ▶ Digital set up of RPM and time with independent LED display
- ▶ Maximum stirring speed upto 300RPM
- ▶ Audible alarm at time cycle end for safety and ease of unsupervised operation
- ▶ Compatible for use with various capacity conical flasks and different sample containers.
- ▶ Available with Flat platform (Cat. No. 3500.303.01)

Item Code	Volt	Hz	Comes with
<b>3500.DNEU.01</b>	230	50	Platform, Flat, Non-Slip Mat
<b>3500.DNUS.02</b>	115	60	Platform, Flat, Non-Slip Mat

## Technical Specification

<b>Shaker Body Material</b>	Plastic
<b>Speed Range</b>	50-300 RPM
<b>Orbit</b>	20 MM
<b>Dimensions of Body</b>	284 x 264 x 108 mm
<b>Max. Loading Capacity</b>	2.0kgs
<b>Permissible ambient Temp.</b>	5 - 45°C
<b>Voltage</b>	AC 100 - 230V (50/60 Hz)
<b>Timing Range</b>	1min - 99Hrs 59Min

Scan to  
Watch Video &  
Download manual



## General Optional Accessories

Platform, Flat, Non-Slip Mat



**INCLUDED**

3500.303.01

Platform, Double



3500.303.02

Platform, Universal, with 3 secured bars



3500.303.03

Platform with clamps, 6 Places (250ml)



3500.303.04

Platform with clamps, 12 Places (100ml)



3500.303.05

Platform universal for tubes



3500.303.06



# Incubator Shaker-Inbuilt Cooling

With Heating & Cooling - Digital



- ▶ Compact design
- ▶ Available with Flat platform
- ▶ BLDC motor driven
- ▶ Microprocessor controlled
- ▶ User-Friendly
- ▶ Application in molecular biology, immunology, chemistry lab
- ▶ Low power consumption
- ▶ Maximum stirring speed upto 300RPM
- ▶ Digital set up of RPM and time with independent LED display
- ▶ Audible alarm at time cycle end for safety and ease of unsupervised operation
- ▶ Silent and stable operation
- ▶ Compatible for use with various capacity conical flasks and different sample containers

Item Code	Volt	Hz
<b>3900.DNEU.01</b>	230	50
<b>3900.DNEU.01</b>	115	60

## Technical Specification

<b>Shaker Body Material</b>	Metal
<b>Speed Range</b>	50~300 rpm
<b>Fan Speed</b>	1200~3200 rpm
<b>Orbit (Horizontal)</b>	20 mm
<b>Dimensions of Body</b>	609x770x515 (WxDxH)
<b>Platform Size</b>	480x315x80 (WxDxH)
<b>Permissible ambient Temp.</b>	4 - 45°C (Approx.)
<b>Temp. Control Range</b>	4-60°C
<b>Power</b>	AC 100 - 230V, 600 W
<b>Timer</b>	1min - 99Hrs 59Min
<b>Temp. Control Accuracy</b>	± 0 ± 0.3°C
<b>IP Class</b>	30



**STIR**  
**300 RPM**



**CELSIUS TO  
FAHRENHEIT**



**TIMER**  
**00:01-99:59**



**HEAT/STIR/TIME  
BUTTON**



**TEMPERATURE**  
**Upto 60°C**



**HEAT/STIR/TIME  
DISPLAY**



**INBIULT**  
**6 Modes**



**FAN/UV LIGHT/LAMP**

Scan to  
Watch Video &  
Download manual





- ▶ Outer shell and touch concave are made of plastic & silicone which has resistance to chemical attacks.
- ▶ The thick base makes it very steady and reliable.
- ▶ The maximum diameter of the mixed tube is up to 30mm.
- ▶ Suitable for mixing tubes / centrifugal tubes with prominent mixing effect.
- ▶ 12V low voltage power adapter driven, very smart and portable. Various speed adjustment with indicator.

Item Code	Volt	Hz	Watts
<b>3700.DNEU.01</b>	230	50	130
<b>3700.DNUS.02</b>	115	60	130

## Technical Specification

Body Material	Base : Steel Alloy, Main Frame : ABS, Cap : Silicone
Speed Range	0~4000 RPM
Max. Capacity	50ml tube (Ø 30 mm)
Dimension (WxDxH)	114 x 114 x 93mm
Shaking Orbit	4.5mm
Power Input/Output	1.2W/0.8W
Voltage	DC 12V 1A
Power	12W
Net Weight	850 gms

Scan to  
Watch Video &  
Download manual





- ▶ Cost-effective and user-friendly apparatus for hot extraction.
- ▶ Energy individually adjustable for every sample position.
- ▶ Cooling water distribution, distribution strip ensures uniform cooling at sample positions.
- ▶ Practical condenser ledge to safely deposit the condenser between hot extractions
- ▶ Brackets for safely holding the intermediate extraction pieces after removing the sample container

Item Code	Volt	Hz	Watts
<b>1900.DNEU.01</b>	230	50	130
<b>1900.DNUS.01</b>	115	60	130



## Technical Specification

Voltage	230 VAC
Frequency	50/60 Hz
Power consumption	1500 W
Power consumption	7 A
Weight (without glass)	approx. 15 kg
Dimensions in cm (W x D x H) (without glass)	approx. 53 x 32 x 74

*Also Available*

## 4 Position Soxhlet Extraction (Digital)

Item Code	Volt	Hz	Watts
<b>1950.DNEU.01</b>	230	50	130
<b>1950.DNUS.01</b>	115	60	130



Scan to  
Watch Video &  
Download manual





Compact, universal small shaker suitable for shaking tasks with all small vessels with adaptors and microtiter plates

- ▶ Wide range of attachments available
- ▶ Timer with countdown function
- ▶ Stable in all speed ranges
- ▶ Sturdy Aluminum die cast casing
- ▶ Continuous or touch/shot operation (with standard attachment)

### Two operating modes:

The maximum speed of 3,000 rpm is for the standard attachment in touch mode. When using other attachments the speed should be limited to 1,300 rpm.

Item Code	Volt	Hz
<b>3800.DNEU.01</b>	230	50
<b>3800.DNUS.01</b>	115	60

## Technical Specification

Type of movement	Orbital
Shaker Diameter	3 mm
Permissible orbit weight (incl. attachment)	0.5 kg
Permissible ON time	100%
Speed min (adjustable)	100 rpm
Speed range	100 - 3000 rpm
Speed display	LED
Speed deviation	1%
Timer	yes
Timer display	LED
Time setting min.	1 s
Time setting max.	100 Hrs
Operating mode	Timer and Continuous Operation
Touch/ shot function	yes
Working with microtiter plates	yes
Number of microtiter plates	1
Permissible ambient temperature	5 - 40 °C
Permissible relative humidity	80%
Protection class according to DIN EN 60529	IP 21
Adaptors	Available
Voltage	100 - 240 V
Frequency	50/60 Hz
Power input	7 W
DC Voltage	24 V

### Optional Foam Adaptors



### Optional Accessories



Scan to Watch Video & Download manual





### Uses:

- ▶ This apparatus is designed for use in distilling, drying, concentrating and heat soaking chemicals or biological products.
- ▶ Temperature control by means of PID controller.
- ▶ Inner chamber with SS 304

### MODELS:

The water baths are available in two models - 6 & 12

### POSITIONS :

6 & 12 Position

Item Code 230 Volts/50Hz	Item Code 115 Volts/60Hz	Positions
<b>1800.DNEU.01</b>	<b>1800.DNUS.01</b>	6
<b>1800.DNEU.02</b>	<b>1800.DNUS.02</b>	12

## Technical Specification

### 6 Position

Power	1500 W
No. of Opening	6
Temperature-control range	RT-99.9°C
Temperature-fluctuation	±0.5°C
Dimension	120 (D) x 110 (H)
Working Room (cm)	50x30x15
Weight	8.9 Kgs
IP Class	34

### 12 Position

Power	2000 W
No. of Opening	12
Temperature-control range	RT-95°C
Temperature-fluctuation	±2°C
Dimension	120 (D) x 90 (H)
Working Room (cm)	92x32x12
Weight	21 Kgs
IP Class	34



**POWER**  
1500 W



**TEMPERATURE**  
Upto 99.9 °C



**POWER**  
2000 W



**TEMPERATURE**  
Upto 99.9 °C

Scan to  
Watch Video &  
Download manual





High quality stainless steel material, heat resisting and anticorrosion, Digital controller digital display, durable.

- ▶ This heated bath is used in the laboratory to allow a chemical reaction to occur at an elevated temperature.
- ▶ This heated bath is a fluid placed in an open (metal) pot. Water and silicone oil are the most commonly used fluids. A water bath is used for temperatures up to 100 °C. An oil bath is employed for temperatures over 100°C.
- ▶ This heated bath is heated on a hot plate, or with a bunsen burner. The reaction chamber (Florence flask, Erlenmeyer flask, beaker) is immersed in the heated bath. A thermometer is usually kept in the fluid to monitor the temperature.

Item Code	Volt	Hz
<b>1850.DNEU.01</b>	230	50
<b>1850.DNUS.01</b>	115	60

### Technical Specification

Heating Power	800W
Temperature control range	RT~100°C
Temperature fluctuation	± 0.5 Celsius
Working size(mm <sup>3</sup> )	Ø26× 16
Display	Digital
Weight	7.4 Kgs
IP Class	34



**POWER**  
800 W



**TEMP./TIME**  
**BUTTON**



**TEMPERATURE**  
Upto **100°C**



**TEMP./TIME**  
**DISPLAY**



**SET**  
**ALARM**

Scan to  
Watch Video &  
Download manual







The tester features a unique metal surface electrode that provides fast and easy on the spot EC(mS/cm) measurements for soil and hydroponics nutrient etc.

### Operating Instruction

1. Take off the protective cap from metal probe
2. Press OFF/ON button Tester display "0".
3. Quick testing : Water the soil with distilled water before testing. Make sure the water can go 10 cm deep the least. Best humidity is 60%-80%. Insert the metal probe into soil vertically and clockwise, to about 6-8 cm deep. Make sure the soil have thorough contact with metal probe. After about 6 seconds, the tester will display the measured value. Tightness of soil will affect measuring result. Multiple tests at the same and different points should be performed and take the average as final result.  
Accurate testing : Use a container, mixdried soil with distilled water at the rate of 10:1. Stir and make it into a mud form. Put the metal probe into the mud about 6-8CM deep. About 6 seconds, the tester will display the measured value.
4. Wipe the metal probe with towel or tissue paper after each test. Make it clean and dry. till the display show "0".

Item Code	Pack of
GLIEC	2

## Technical Specification

Range	: 0-1999 EC(mS/cm);
Resolution	: 0.10 EC(mS/cm)
Accuracy	: ±0.1EC (00-100 EC)
Operating Temp	: 5-45°C (41 - 113°FVATC)
Calibration	: 1 point (6.7EC /Factory calibrated -No more calibration)
Powersupply	: DC 9V(L1022 battery)
Display	: LCD with illumination
Dimension	: $\varnothing$ 50.5 x 250 mm
Probe length	: 140mm
Features	: Automatic switch-off function : After about 5 minutes without pushing buttons, the meter will be switched off automatically (or manual shutdown)
Weight	: 110 Gms (Approx)
IP Class	: 64

Scan to  
Watch Video &  
Download manual



# Digital Instant N-P-K Tester

for Soil Testing



The electro-chemical method uses innovative technology of ionization reduction

## Operating Instruction

1. Take off the protective cap from metal probe
2. Press OFF/ON button Tester display "0".
3. **Quick testing** : Water the soil with distilled water before testing. Make sure the water can go 10 cm deep the least. Best humidity is 60%-80%. Insert the metal probe into soil vertically and clockwise, to about 6-8 cm deep. Make sure the soil have thorough contact with metal probe. After about 6 seconds, the tester will display the measured value. Tightness of soil will affect measuring result. Multiple tests at the same and different points should be performed and take the average as final result.  
**Accurate testing** : use a container, mix dried water at the rate of 3:1. Stir and make in into a mud form. Put the metal probe into the mud about 6-8 cm deep. About 6 seconds, the tester will display the measured value.
4. Wipe the metal probe with towel or tissue paper after each test. Make it clean and dry. till the display show "0".



Item Code

Pack of

GLINPK

2

## Technical Specification

Range	0-1999 mg/Kg(mg/l)
Resolution	1mg/kg(mg/l)
Accuracy	±0.2 F.S.
Operating Temp	5-45 °C (41-113°F)/ATC
Calibration	Factory calibrated
Power supply	DC 9V (9V580/6F22Ni-MH rechargeable battery)
Display	LCD with back light
Dimension	Æ50.5 x 250 mm
Probe length	140mm
Features	Auto switch off in about 5 minutes
Weight	390 Gms (Approx)
IP Class	64

Scan to  
Watch Video &  
Download manual



# Digital pH Tester

for **Soil Testing**

The tester features with innovative nanotechnology metal material sensor, for fast and easy test of pH value of soil, fruit, meat, cheese and other semi-solid media.

## Operating Instruction

1. Take off the protective cap from metal probe
2. Press OFF/ON button. Tester displays "7.00".
3. Insert the metal probe vertically into the sample that requires testing, at least 6-8cm deep. Make sure there is close contact (Soil need to humid~60%-80%). The tester will start testing automatically. After about 1 minute the test is over. Indication light will be on for about 10 seconds. The displayed number is locked, which is the value of pH.
4. After each test, take out the tester, wipe the metal probe clean with towel or tissue paper. Display will be unlocked, and show "7.00". It is ready for a new test.
5. After use, wipe the metal probe clean until it displays "7.00". Switch off the tester.

**Item Code**

**Pack of**

**GLIPH**

**2**

## Technical Specification

Range	pH: 3.0-14.0 pH
Resolution	0.10 pH
Accuracy	± 0.2 pH (3.0-12.0 pH)
Operating Temp	5-45 °C
Calibration	1 point (Factory calibrated - No more calibration)
Power supply	DC 9V (L1022 battery)
Display	LCD
Dimension	∅50.5 x 250 mm
Probe length	140mm
Features	Automatic detection of data and lock to keep, automatic switch to OFF in 5 minutes (or manual shutdown).
Weight	110 Gms (Approx)
IP Class	64

Scan to  
Watch Video &  
Download manual

