



Radon Inspection Report

Test Location:

John Smith
124 Sample St
Campton Hills, IL 60175
tom@localradontesting.com
555.555.1212
Bldg. Type: Residential Single Family

Test For:

Home Owner

Home Inspector

Realtor/Buyer

Type: Real Estate Transaction

Inspected By:

Tom Friedheim
40W540 Winchester Way
St. Charles, IL 60175
6308812430
Lic/Cert. # RNI2019218



Test Result: Fail

Overall Average:

6.3 pCi/l

EPA Average:

6.4 pCi/l

Test Device Details:

Serial Number: 246216006
Model Number: 1030
Last Calibration: 08/01/2020
Next Calibration: 08/01/2021
Cal-Factors: 2.77,2.70,2.75,2.65,2.66,2.71
Motion Error: Yes

Test Site Condition:

Structure Type: 2 Story Home

Test Summary:

<u>CRM Location:</u>	<u>Start:</u>	<u>Stop:</u>	<u>Interval:</u>	<u>Duration:</u>
Finished Basement	10/19/2020 09:50 AM	10/21/2020 09:50 AM	1 hr	48 hr
 *First 4 hrs of data excluded	<u>Min:</u>	<u>Max:</u>	<u>Average:</u>	<u>Measurement Units:</u>
Radon Concentration:	5.2	7.8	6.4	pCi/l
Temperature	66.9	67.6	67.4	F
Humidity	32	35	33	%
Pressure	29.29	29.64	29.50	inHg

Comments:

Radon Measurement Professional License # RNI2019218

Tom Friedheim

Lic/Cert Signature

Inspection Report Date: 01/19/2021

Test device manufactured by SunRADON, LLC

Section 422.APPENDIX E Diagram of Room Worksheet for Radon Measurements

This worksheet may be used in accordance with Section 422.130(o)(1)(L)(ii). Complete all areas of the worksheet and include a separate worksheet for each foundation type measured. A copy of each worksheet shall be retained as a permanent record and included as part of a measurement report in accordance with Section 422.130(o).

Placement of Measurement Devices Short-term or long-term measurements shall be made in each lowest structural area suitable for occupancy. For example, a split-level building with a basement, a slab-on-grade room and a room over crawlspace shall have measurements made in each of the foundation types: the basement, a slab-on-grade room and a room over the crawlspace. Measurement devices shall (check all that apply):

- ☒ Made in rooms that can be regularly occupied, such as family rooms, living rooms, dens, playrooms and bedrooms
- ☐ Charcoal canisters shall not be placed in bathrooms, kitchens, laundry rooms, spa rooms or other areas of high humidity
- ☒ Undisturbed during the measurement period.
- ☒ At least 3 feet from doors, windows to the outside, or ventilation ducts and out of the direct flow of air from the ventilation duct.
- ☒ At least 1 foot from exterior walls.
- ☒ 20 inches to 6 feet from the floor.
- ☒ At least 4 inches away from other objects horizontally or vertically above the detector.

Diagram of Room Measured The following information shall be included:

- 1) All windows and doors. Annotate exterior walls and the direction of north or the front of the building.
- 2) Factors that may affect the measurement, including but not limited to crawlspace vents, fireplaces, combustible appliances, floor drains, furnaces, dryers, water heaters and mitigation systems.
- 3) Include measurements (to the nearest inch) from the testing device to two separate walls.
- 4) Current room use (ex.: family room, bedroom, unfinished basement, playroom).
- 5) Address: 124 Sample St. Naperville, IL 60563
- 6) Device Serial Number: 24616006 7) Foundation Type: Finished Basement

KEY: D=Door, F=Furnace, EW=Exterior Wall, IW=Interior Wall, FD=floor drain, HW= Hot Water Heater

SP=Sump Pump, M= Monitor, SS=security sealed, EP Ejector Pit V= Ventilation, W= Window

Height from Floor 36" X= 18'1" Y= 6'10"

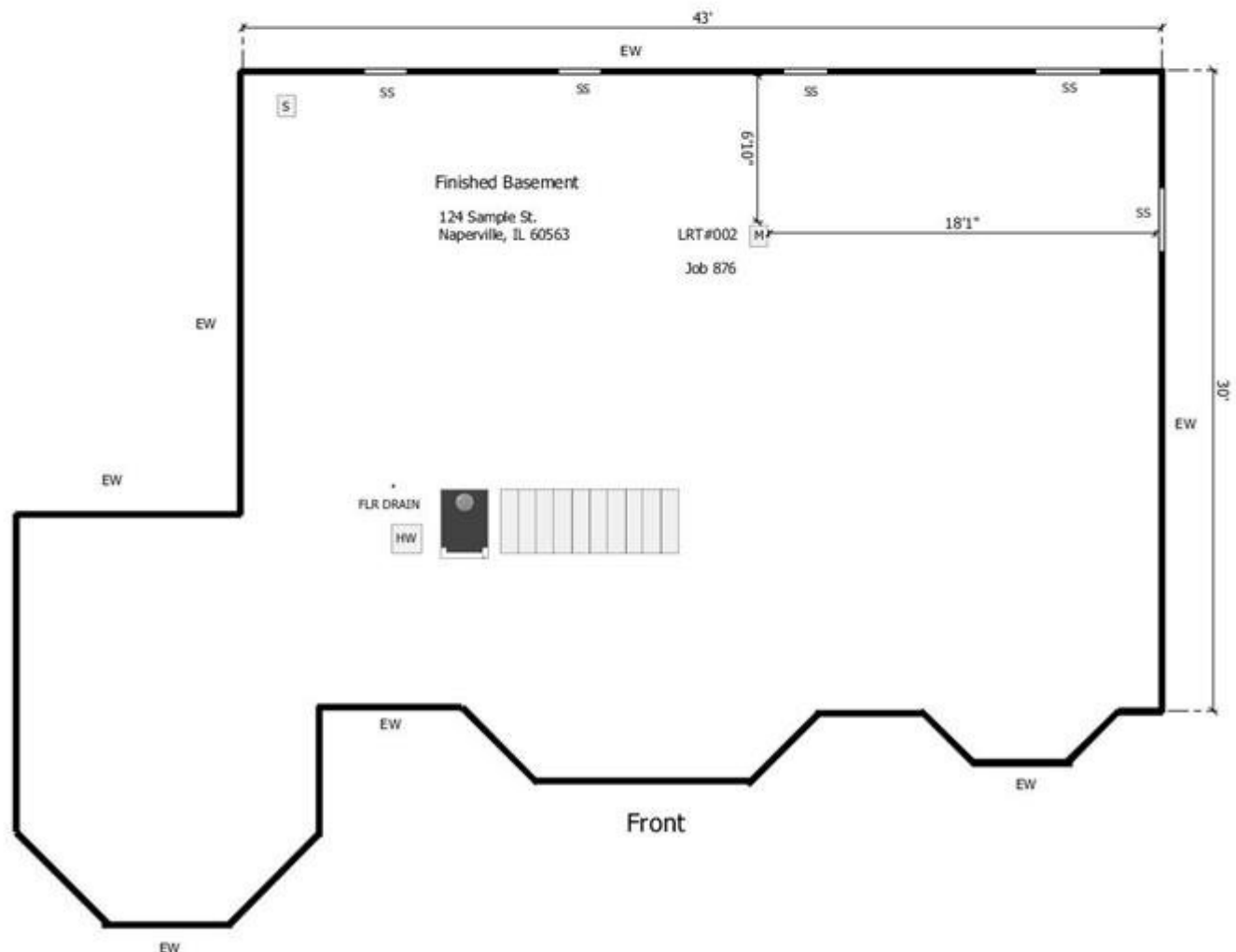



Radon Inspection Chart

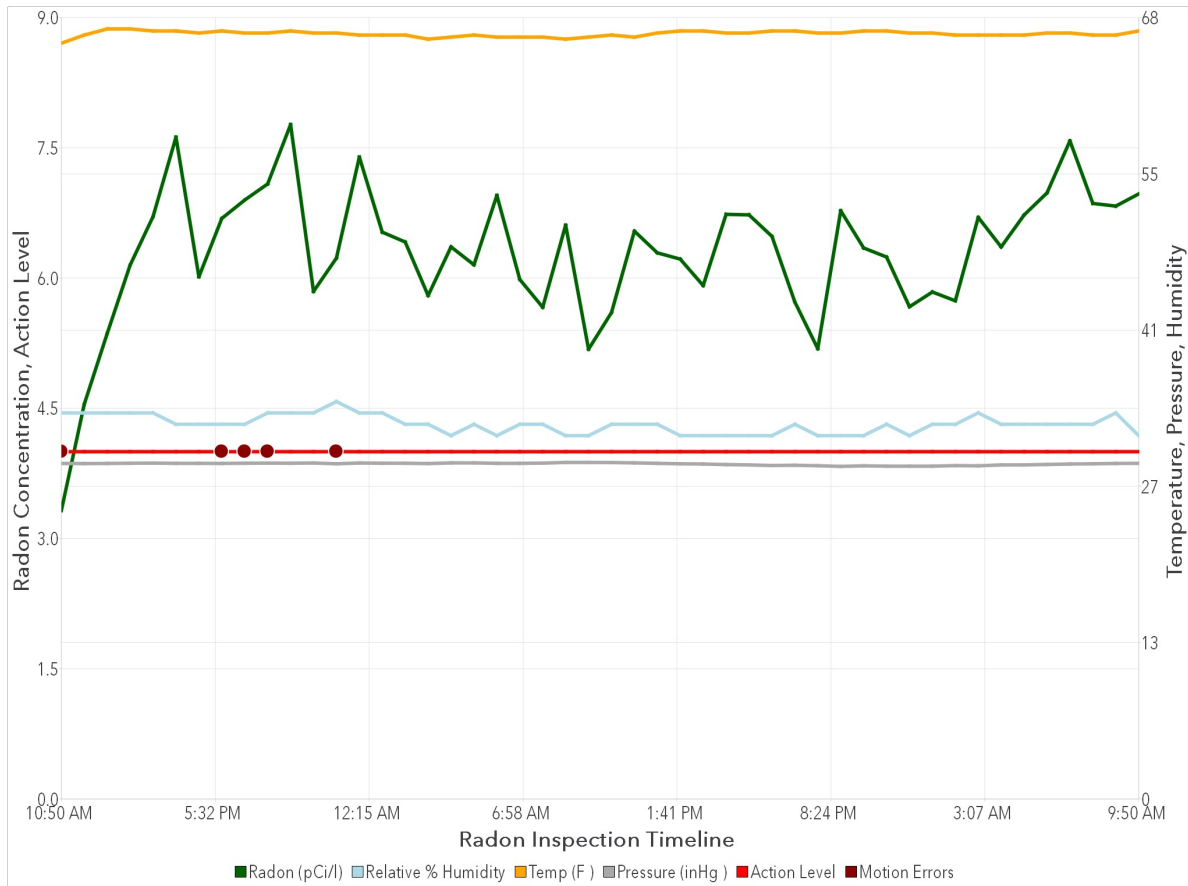

Test Result: Fail

Test Location: 124 Sample St Campton Hills, IL 60175

Inspection Report Date: 01/19/2021

Test device manufactured by SunRADON, LLC



Test Table

* Data from first 4 hours excluded from EPA calculations

<u>Date/Time</u>	<u>Radon(pCi/l)</u>	<u>Temp(F)</u>	<u>Pres(inHg)</u>	<u>Humidity(%)</u>	<u>Flags</u>
10/19/20 10:50 AM	3.3	66.6	29.55	34	M
10/19/20 11:50 AM	4.5	67.3	29.54	34	-
10/19/20 12:50 PM	5.4	67.8	29.55	34	-
10/19/20 01:50 PM	6.1	67.8	29.57	34	-
10/19/20 02:50 PM	6.7	67.6	29.58	34	-
10/19/20 03:50 PM	7.6	67.6	29.56	33	-
10/19/20 04:50 PM	6.0	67.5	29.56	33	-
10/19/20 05:50 PM	6.7	67.6	29.55	33	M
10/19/20 06:50 PM	6.9	67.5	29.57	33	M
10/19/20 07:50 PM	7.1	67.5	29.58	34	M
10/19/20 08:50 PM	7.8	67.6	29.57	34	-
10/19/20 09:50 PM	5.8	67.5	29.59	34	-
10/19/20 10:50 PM	6.2	67.5	29.52	35	M
10/19/20 11:50 PM	7.4	67.3	29.59	34	-
10/20/20 12:50 AM	6.5	67.3	29.57	34	-
10/20/20 01:50 AM	6.4	67.3	29.57	33	-
10/20/20 02:50 AM	5.8	66.9	29.54	33	-
10/20/20 03:50 AM	6.4	67.1	29.60	32	-
10/20/20 04:50 AM	6.2	67.3	29.60	33	-
10/20/20 05:50 AM	7.0	67.1	29.56	32	-
10/20/20 06:50 AM	6.0	67.1	29.56	33	-
10/20/20 07:50 AM	5.7	67.1	29.58	33	-
10/20/20 08:50 AM	6.6	66.9	29.64	32	-
10/20/20 09:50 AM	5.2	67.1	29.64	32	-
10/20/20 10:50 AM	5.6	67.3	29.63	33	-
10/20/20 11:50 AM	6.5	67.1	29.60	33	-
10/20/20 12:50 PM	6.3	67.5	29.56	33	-
10/20/20 01:50 PM	6.2	67.6	29.52	32	-
10/20/20 02:50 PM	5.9	67.6	29.50	32	-
10/20/20 03:50 PM	6.7	67.5	29.45	32	-
10/20/20 04:50 PM	6.7	67.5	29.42	32	-
10/20/20 05:50 PM	6.5	67.6	29.37	32	-
10/20/20 06:50 PM	5.7	67.6	29.39	33	-
10/20/20 07:50 PM	5.2	67.5	29.35	32	-
10/20/20 08:50 PM	6.8	67.5	29.29	32	-
10/20/20 09:50 PM	6.3	67.6	29.34	32	-
10/20/20 10:50 PM	6.2	67.6	29.31	33	-
10/20/20 11:50 PM	5.7	67.5	29.31	32	-
10/21/20 12:50 AM	5.8	67.5	29.31	33	-
10/21/20 01:50 AM	5.7	67.3	29.36	33	-
10/21/20 02:50 AM	6.7	67.3	29.34	34	-
10/21/20 03:50 AM	6.4	67.3	29.42	33	-
10/21/20 04:50 AM	6.7	67.3	29.42	33	-
10/21/20 05:50 AM	7.0	67.5	29.46	33	-

Test Result: Fail

Test Location: 124 Sample St Campton Hills, IL 60175

Inspection Report Date: 01/19/2021

Test device manufactured by SunRADON, LLC



Test Table

* Data from first 4 hours excluded from EPA calculations

<u>Date/Time</u>	<u>Radon(pCi/l)</u>	<u>Temp(F)</u>	<u>Pres(inHg)</u>	<u>Humidity(%)</u>	<u>Flags</u>
10/21/20 06:50 AM	7.6	67.5	29.50	33	-
10/21/20 07:50 AM	6.9	67.3	29.52	33	-
10/21/20 08:50 AM	6.8	67.3	29.55	34	-
10/21/20 09:50 AM	7.0	67.6	29.56	32	-

Test Result: Fail

Test Location: 124 Sample St Campton Hills, IL 60175

Inspection Report Date: 01/19/2021

Test device manufactured by SunRADON, LLC



Radon Test Information

Radon Risk Information

Radon causes lung cancer by means of the decay of its daughter products after breathing in air contaminated with higher levels of Radon. The World Health Organization (WHO) estimates that 15% of lung cancers worldwide are caused by exposure to elevated indoor levels of Radon. Overall, radon is the second leading cause of lung cancer responsible for about 21,000 lung cancer deaths every year in the US alone. Radon gas is the number one cause of lung cancer among non-smokers. The U.S. Environmental Protection Agency (EPA), the U.S. Surgeon General, and the Center for Disease Control and Prevention (CDC) strongly recommend that ALL homebuyers have an indoor radon test performed prior to purchase or taking occupancy and recommend having the radon levels professionally mitigated if elevated radon concentrations are found.

Understanding Radon Test Results

Recommended Action Levels vary by country and typically range from 3 pCi/l (100 Bq/m³) to 8 pCi/l (300 Bq/m³). Recommendations below are based on test results by a Continuous Radon Monitor (CRM) Test of at least 48h duration and are based on recommendations by the EPA.

Measured Average Radon Level:

- At or above 4.0 pCi/l (148 Bq/m³): Corrective measures to reduce exposure to radon gas is strongly recommended (ANSI MAH2014)
- Between 2-4 pCi/l (74-148 Bq/m³): Consider mitigation or periodic retest as indoor Radon levels vary by season and weather conditions
- Below 2 pCi/l (74 Bq/m³): Consider bi-annual retest or whenever significant changes to the home structure or mechanical systems occurred

Test Result: Fail

Test Location: 124 Sample St Campton Hills, IL 60175

Inspection Report Date: 01/19/2021

Test device manufactured by SunRADON, LLC